

REVISIONS					
P	LTR	DESCRIPTION	DATE	DWN	APVD
	A	RELEASED PER ECO-17-008656	15JUN2017	CJV	EDB
	B	REVISED PER ECO-17-014247	21SEP2017	MS	MP
	C	REVISED PER ECO-19-011393	23JUL2019	TX	DZ

D

C

B

A

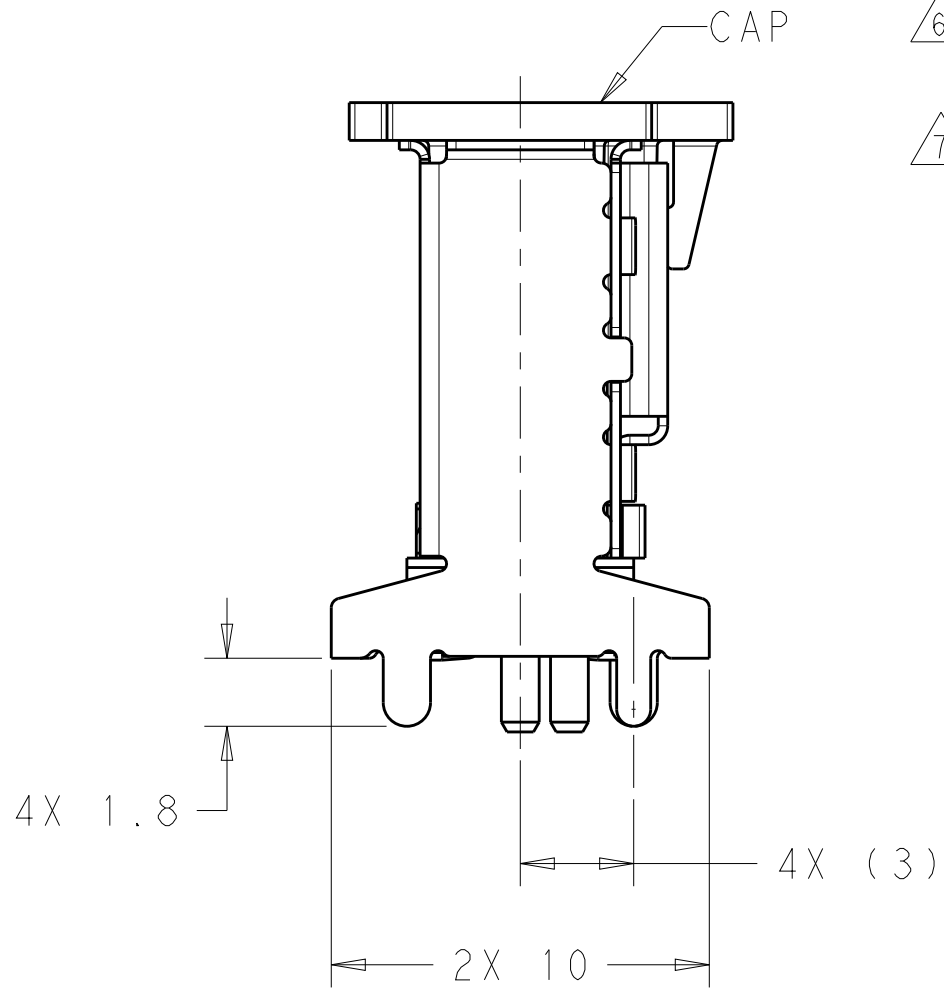
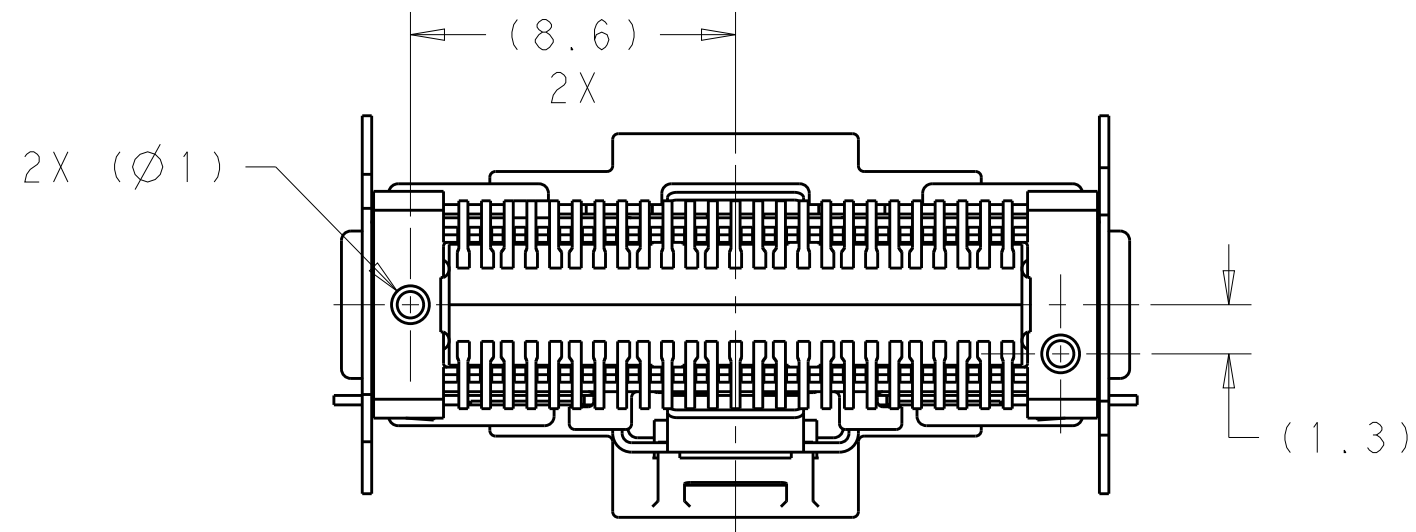
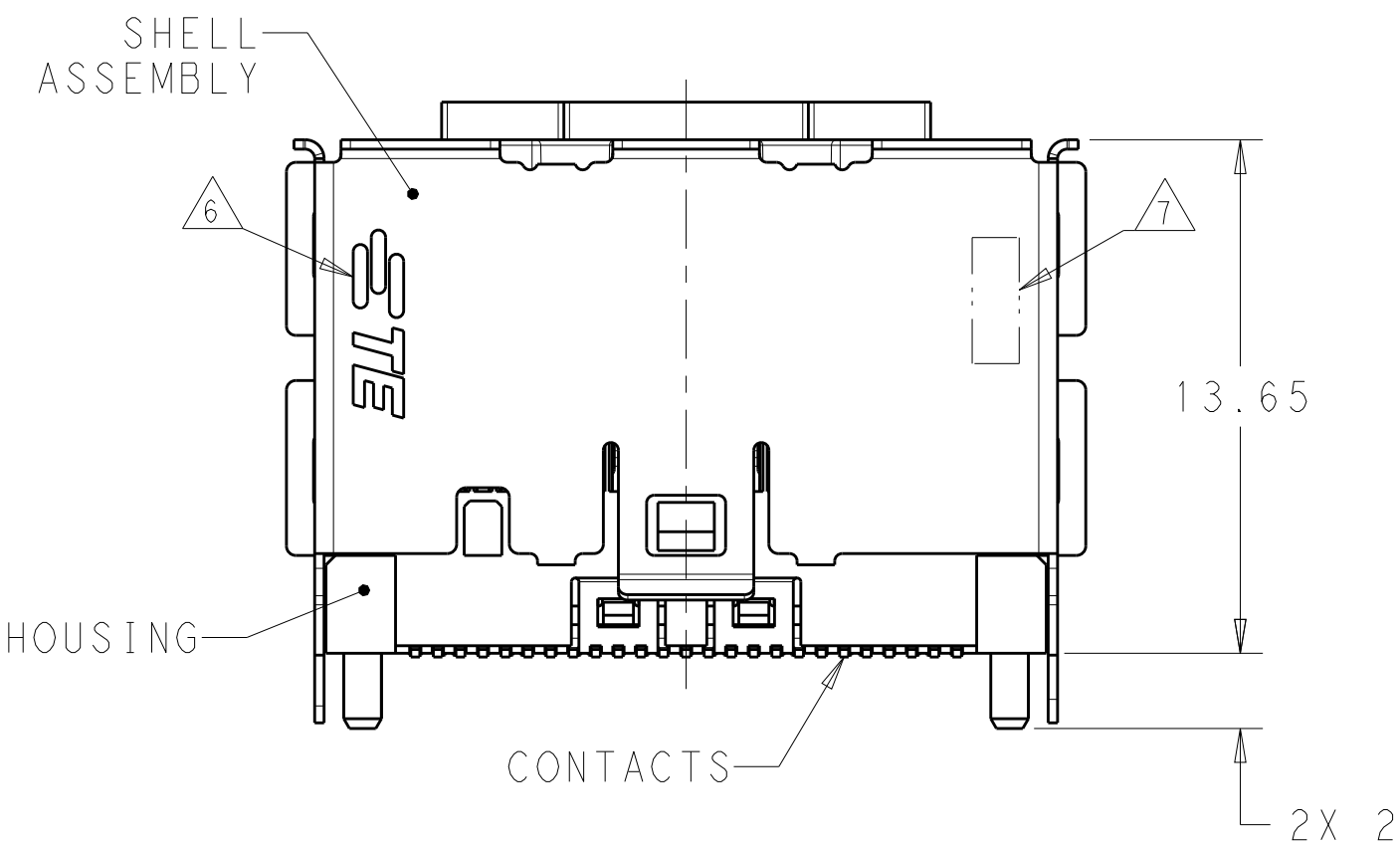
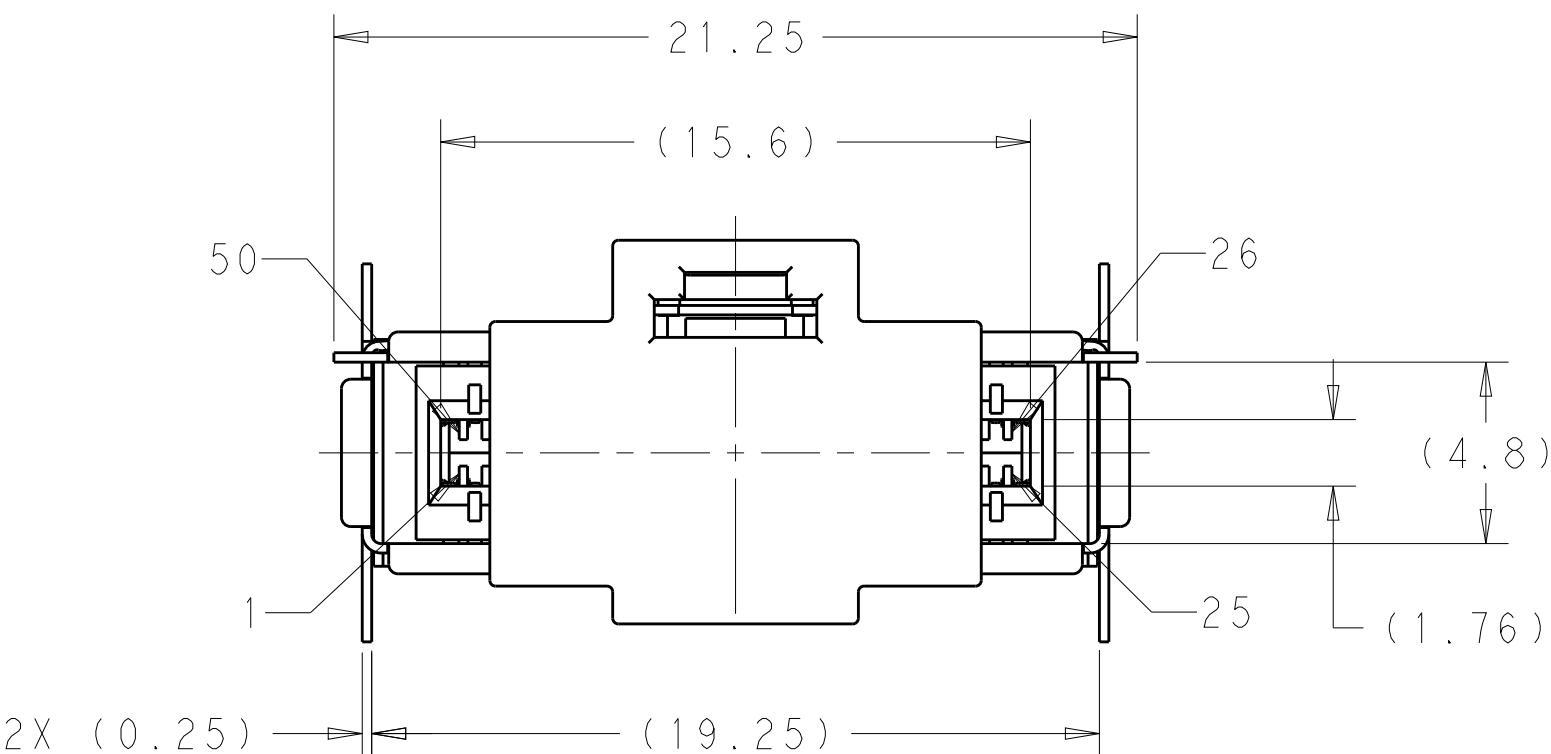

- ① HOUSING AND CONTACT OVERMOLD: LCP, BLACK.  
CAP: LCP, BLACK.  
CONTACTS: COPPER ALLOY.  
SHELL ASSEMBLY: COPPER ALLOY, NICKEL PLATED.  
TIN PLATED ON HOLD DOWNS.
- ② 0.76µm MIN. GOLD PLATED ON MATING INTERFACE.  
2.54µm MIN. MATTE TIN PLATED ON SOLDER TAILS.  
BOTH OVER 1.27µm MIN. NICKEL ALL OVER.
- ③ DATUM AND BASIC DIMENSION ESTABLISHED BY CUSTOMER.
- 4. DESIGNED FOR A 1.42 MIN THICK PC BOARD.
- ⑤ RECOMMENDED COMPONENT KEEP OUT AREA.
- ⑥ TE CONNECTIVITY LOGO MARKED IN APPROXIMATE AREA SHOWN.
- ⑦ PART NUMBER AND DATE CODE MARKED IN APPROXIMATE AREA SHOWN.

WITHOUT CAP	2292096-2
WITH CAP	2292096-1
REMARKS	PART NUMBER

THIS DRAWING IS A CONTROLLED DOCUMENT.		DWN M. SHIRK 06APR2015	<div><div>TE</div>TE Connectivity</div>			
DIMENSIONS:		CHK M. PHILLIPS 06APR2015				
mm		APVD -	NAME RECEPTACLE CONNECTOR, VERTICAL, 50 POSITION, SLIVER			
		PRODUCT SPEC -	SIZE A2			
		APPLICATION SPEC -	CAGE CODE -			
MATERIAL		WEIGHT -	DRAWING NO C-2292096			
-1		-2	RESTRICTED TO			
CUSTOMER DRAWING			SCALE 5:1	SHEET 1	OF 2	REV C

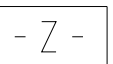

# Mouser Electronics

Authorized Distributor

Click to View Pricing, Inventory, Delivery & Lifecycle Information:

[TE Connectivity:](#)

[2292096-1](#)