



4

3

2

1

THIS DRAWING IS UNPUBLISHED.

RELEASED FOR PUBLICATION

- , - .



COPYRIGHT

-

BY TYCO ELECTRONICS CORPORATION.

ALL INTERNATIONAL RIGHTS RESERVED.

LOC

DIST

REVISIONS

P

LTR

DESCRIPTION

DATE

DWN

APVD

GP

00

SEE SHEET 1

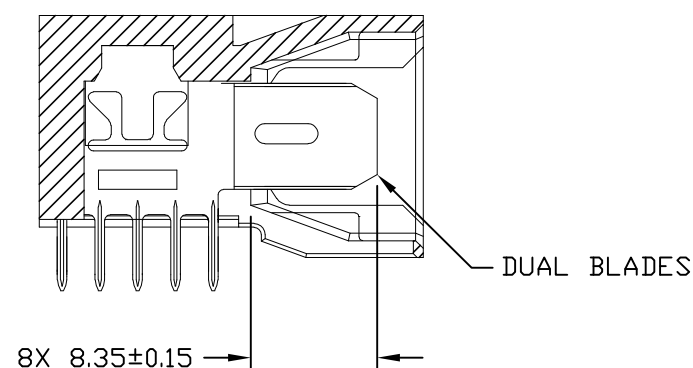

SECTION J-J

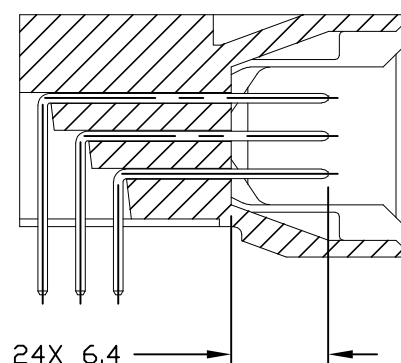
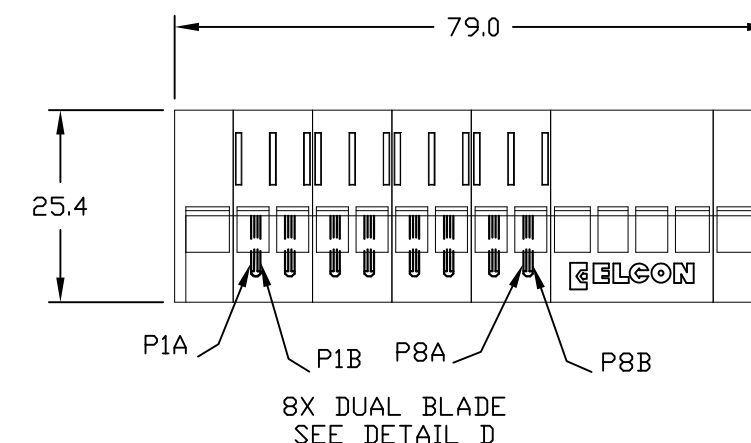
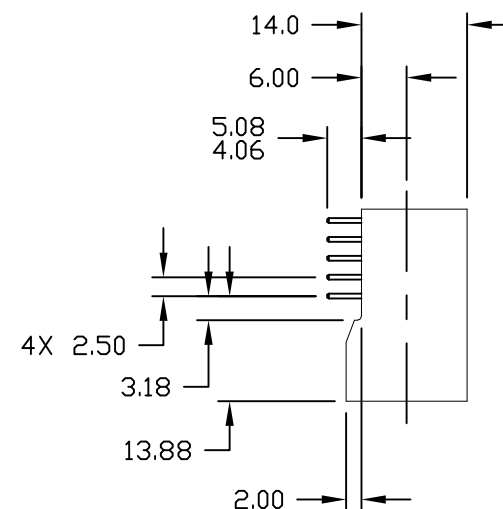

SECTION C-C

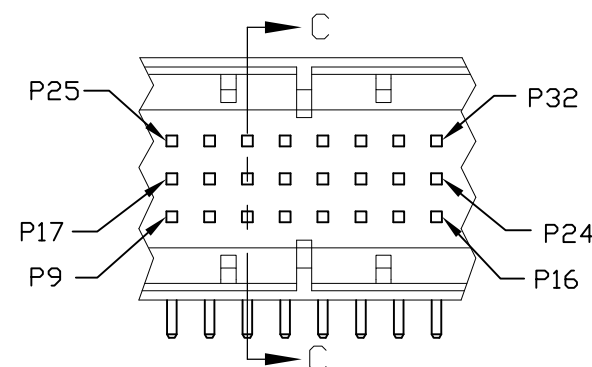

DETAIL B

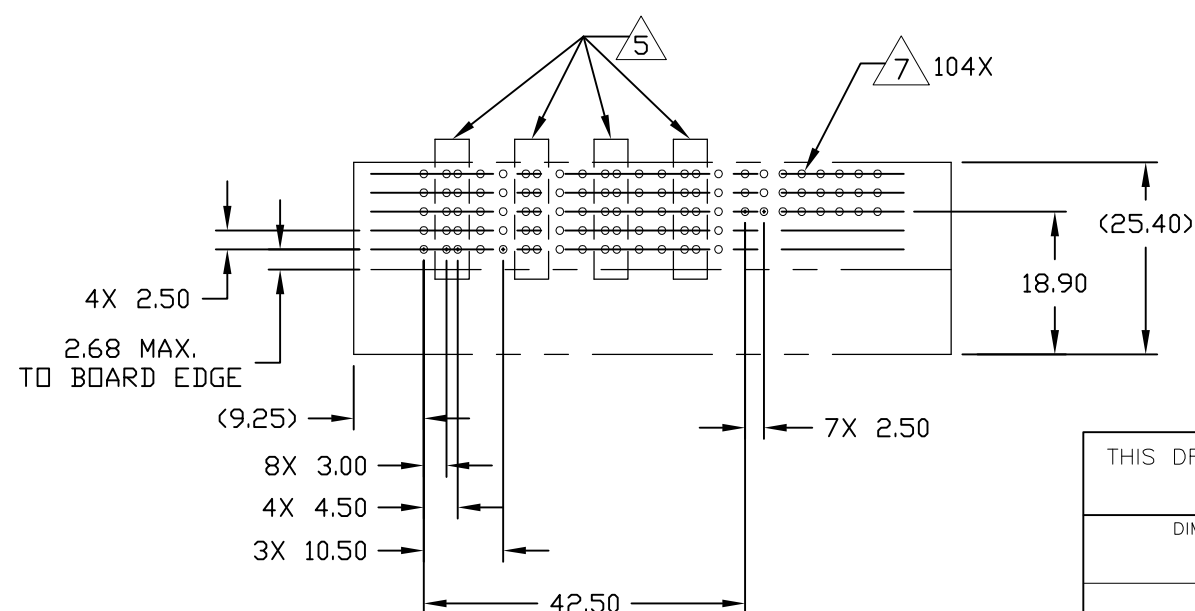
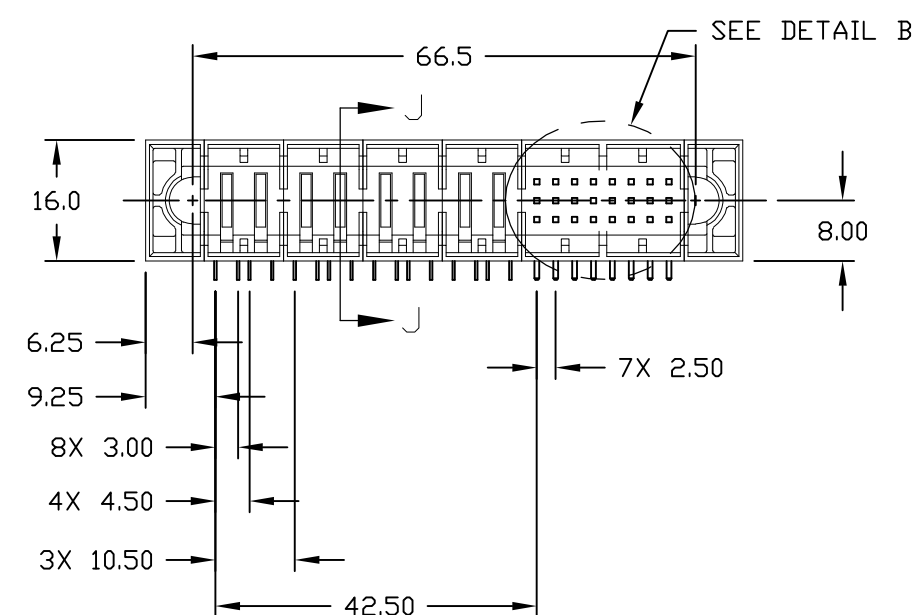

RECOMMENDED PC LAYOUT

THIS DRAWING IS A CONTROLLED DOCUMENT.

DIMENSIONS:

mm

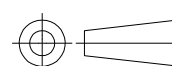

MATERIAL

TOLERANCES UNLESS OTHERWISE SPECIFIED:

0 PLC ± -  
1 PLC ± .5  
2 PLC ± .25  
3 PLC ± -  
4 PLC ± -  
ANGLES ± .5

FINISH

DWN 12/23/05  
RFA/GRZYBOWSKI

CHK

P.DAMATO

APVD 12/23/05

CHAU/PERCHERKE

PRODUCT SPEC

APPLICATION SPEC

WEIGHT

CUSTOMER DRAWING



Tyco Electronics Corporation

Harrisburg, PA 17105-3608

NAME

PIN CONNECTOR ASSEMBLY  
RIGHT ANGLE, SOLDER TAIL  
MINIPAK

SIZE

CAGE CODE

DRAWING NO

RESTRICTED TO

A3 00779

C-1926017

SCALE 1:1

SHEET 2 OF 3

REV C

THIS DRAWING IS UNPUBLISHED.

RELEASED FOR PUBLICATION

- , - .



COPYRIGHT

-

BY TYCO ELECTRONICS CORPORATION.

ALL INTERNATIONAL RIGHTS RESERVED.

LOC

DIST

REVISIONS

GP

00

P

LTR

DESCRIPTION

DATE

DWN

APVD

-

SEE SHEET 1

-

-

-

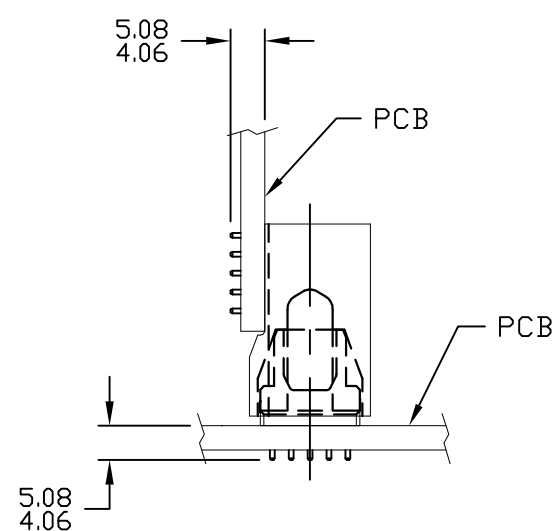

MATED CONDITION

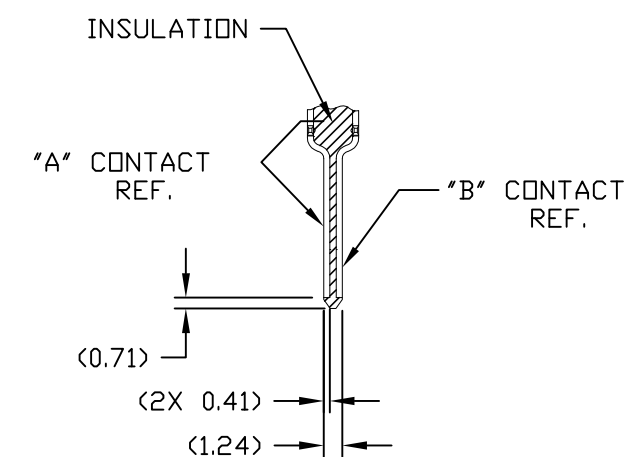
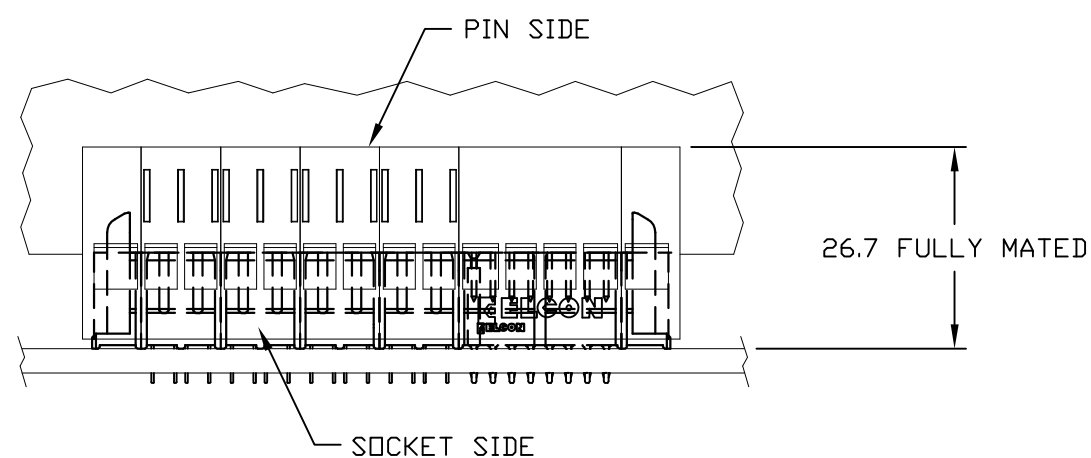

DETAIL D

DETAIL A



SOLDER TERMINATION AREA  
RECOMMENDED PRINTED CIRCUIT HOLE

FINISHED HOLE:  $\phi 1.02 \pm 0.08$ DRILLED HOLE:  $\phi 1.15 \pm 0.13$ 

COPPER PLATE: .025-.050 MINIMUM (PER SURFACE)

TIN PLATE: .0005 MINIMUM (PER SURFACE)

THIS DRAWING IS A CONTROLLED DOCUMENT.

DWN 12/23/05  
RFA/GRZYBOWSKICHK -  
P.DAMATOAPVD 12/23/05  
CHAU/PERCHERKE

PRODUCT SPEC

APPLICATION SPEC

WEIGHT

-

Tyco Electronics Corporation  
Harrisburg, PA 17105-3608

NAME

PIN CONNECTOR ASSEMBLY  
RIGHT ANGLE, SOLDER TAIL  
MINIPAK

SIZE

CAGE CODE

DRAWING NO

RESTRICTED TO

A3

00779

C-1926017

REV C

CUSTOMER DRAWING

SCALE 1:1

SHEET 3 OF 3

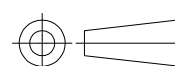
DIMENSIONS:  
mmTOLERANCES UNLESS  
OTHERWISE SPECIFIED:0 PLC  $\pm -$   
1 PLC  $\pm .5$   
2 PLC  $\pm .25$   
3 PLC  $\pm -$   
4 PLC  $\pm -$   
ANGLES  $\pm .5$ 

MATERIAL

FINISH

-

# Mouser Electronics

Authorized Distributor

Click to View Pricing, Inventory, Delivery & Lifecycle Information:

[TE Connectivity:](#)

[1926017-1](#)