

THIS DRAWING IS UNPUBLISHED.										RELEASED FOR PUBLICATION										REVISIONS									
© COPYRIGHT - By -										ALL RIGHTS RESERVED.										P LTR DESCRIPTION DATE DWN APVD									
																				- - SEE SHEET 1 - - -									

[.89]	[.052]	A	15	19.1[.750]	23	UNPL	12	0.20[.008]	01248	9	192013	9	OBSOLETE	
[.92]	[.050]	A	15	19.1[.750]	24	UNPL	13	0.15[.006]	01203	9	192013	8		
[.92]	[.050]	A	15	19.1[.750]	24	6-2	12	0.15[.006]	01234	9	192013	7		
[.92]	[.050]	A	15	19.1[.750]	24	7-2	12	0.15[.006]	01154	9	192013	6		
[.92]	[.050]	A	15	19.1[.750]	24	UNPL	12	0.15[.006]	01152	9	192013	5		
									--	9	192013	4	OBSOLETE	
[.89]	[.050]	A	15	19.1[.750]	23	7-2	12	0.15[.006]	01255	9	192013	3	OBSOLETE	
[1.75]	[.050]	A	15	19.1[.750]	23	7-2	12	0.10[.004]	01279	9	192013	2		
[.92]	[.046]	A	15	19.1[.750]	24	7-2	12	0.08[.003]	01151	9	192013	1		
[.92]	[.046]	A	15	19.1[.750]	24	UNPL	12	0.08[.003]	01297	9	192013	0		
[.85]	[.050]	A	15	17.4[.685]	22	7-2	12	0.15[.006]	01223	8	192013	9		
[.80]	[.052]	A	15	15.88[.625]	20	7-2	12	0.20[.008]	01245	8	192013	8	OBSOLETE	
[.80]	[.052]	A	15	15.88[.625]	20	UNPL	12	0.20[.008]	01289	8	192013	7		
[.76]	[.052]	A	15	15.88[.625]	19	7-2	12	0.20[.008]	01259	8	192013	6		
[.76]	[.052]	A	15	15.88[.625]	19	UNPL	12	0.20[.008]	01258	8	192013	5		
[.83]	[.050]	A	15	15.88[.625]	21	7-2	12	0.15[.006]	01207	8	192013	4		
[.80]	[.050]	A	15	15.88[.625]	20	6-2	12	0.15[.006]	01317	8	192013	3	OBSOLETE	
[.80]	[.050]	A	15	15.88[.625]	20	7-2	12	0.15[.006]	01148	8	192013	2		
[.76]	[.050]	A	15	15.88[.625]	19	7-2	12	0.15[.006]	01311	8	192013	1		
[1.50]	[.050]	A	15	15.88[.625]	20	7-2	12	0.10[.004]	01273	8	192013	0		
[.80]	[.050]	A	15	15.57[.613]	20	7-2	12	0.15[.006]	01202	7	192013	9		
[.73]	[.052]	A	15	14.27[.562]	18	7-2	12	0.20[.008]	01143	7	192013	8	OBSOLETE	
[.45]	[.050]	A	15	9.01[.355]	11	UNPL	12	0.15[.006]		7	192013	7		
[.73]	[.050]	A	15	14.0[.551]	18	7-2	12	0.15[.006]	01264	7	192013	6		
[.70]	[.050]	A	15	14.0[.551]	17	7-2	12	0.15[.006]	01141	7	192013	5		
[.69]	[.052]	A	15	12.7[.500]	16	7-2	12	0.20[.008]	01137	7	192013	4		
[.69]	[.052]	A	15	12.7[.500]	16	UNPL	12	0.20[.008]	01247	7	192013	3	OBSOLETE	
[.69]	[.050]	A	15	12.7[.500]	16	UNPL	13	0.15[.006]	01244	7	192013	2		
[.69]	[.050]	A	15	12.7[.500]	16	7-2	12	0.15[.006]	01206	7	192013	1		
[.69]	[.046]	A	15	12.7[.500]	16	7-2	12	0.08[.003]	01275	7	192013	0		
[.64]	[.052]	A	15	11.99[.472]	15	7-2	12	0.20[.008]	01304	6	192013	9		
[.55]	[.050]	A	15	11.99[.472]	14	UNPL	13	0.15[.006]	01073	6	192013	8	OBSOLETE	
[.64]	[.050]	A	15	11.99[.472]	15	7-2	12	0.15[.006]	01135	6	192013	7		
[.64]	[.050]	A	15	11.99[.472]	15	UNPL	12	0.15[.006]	01134	6	192013	6		
[1.25]	[.050]	A	15	11.99[.472]	15	7-2	12	0.10[.004]	01286	6	192013	5		
[.80]	[.050]	A	15	15.88[.625]	20	UNPL	--	0.15[.006]		6	192013	4		
[.67]	[.046]	A	15	12.7[.500]	16	UNPL	--	0.08[.003]		6	192013	3	OBSOLETE	
[.53]	[.050]	A	15	10.0[.394]	13	UNPL	--	0.15[.006]		6	192013	2		
[.55]	[.052]	A	15	11.1[.437]	14	7-2	12	0.20[.008]	01131	6	192013	1		
[.55]	[.050]	A	15	11.1[.437]	14	UNPL	13	0.15[.006]	01246	6	192013	0		
[.55]	[.050]	A	15	11.1[.437]	14	7-2	12	0.15[.006]	01211	5	192013	9		
[.55]	[.050]	A	15	11.02[.434]	14	6-2	12	0.15[.006]	01128	5	192013	8	OBSOLETE	
[.55]	[.050]	A	15	11.02[.434]	14	UNPL	12	0.15[.006]	01216	5	192013	7		
[.52]	[.050]	A	15	10.0[.394]	13	6-2	12	0.15[.006]	01272	5	192013	6		
[.52]	[.050]	A	15	10.0[.394]	13	7-2	12	0.15[.006]	01205	5	192013	5		
[.50]	[.050]	A	15	9.53[.375]	12	7-2	12	0.15[.006]	01124	5	192013	4		
[.48]	[.050]	A		9.53[.375]	12	7-2	12	0.10[.004]	01268	5	192013	3	OBSOLETE	
[.48]	[.052]	A	15	9.07[.357]	12	7-2	12	0.20[.008]	01122	5	192013	2		
[.45]	[.050]	A	15	9.01[.355]	11	6-2	12	0.15[.006]	01121	5	192013	1		
(FREE DIA)	LH	STYLE	T \$	MATING PIN	t	REF	NUM LOUV	PLATING	MAT'L NOTE	MAT'L THK	REF	PART NUMBER		

LENGTH

17.5±0.5
[.69±.02]

STYLE C
(STRIP)

17.5±0.5
[.69±.02]

STYLE A
(FEMALE)

LH
(LOUVER HEIGHT)

T

(FREE DIA)

192013

B

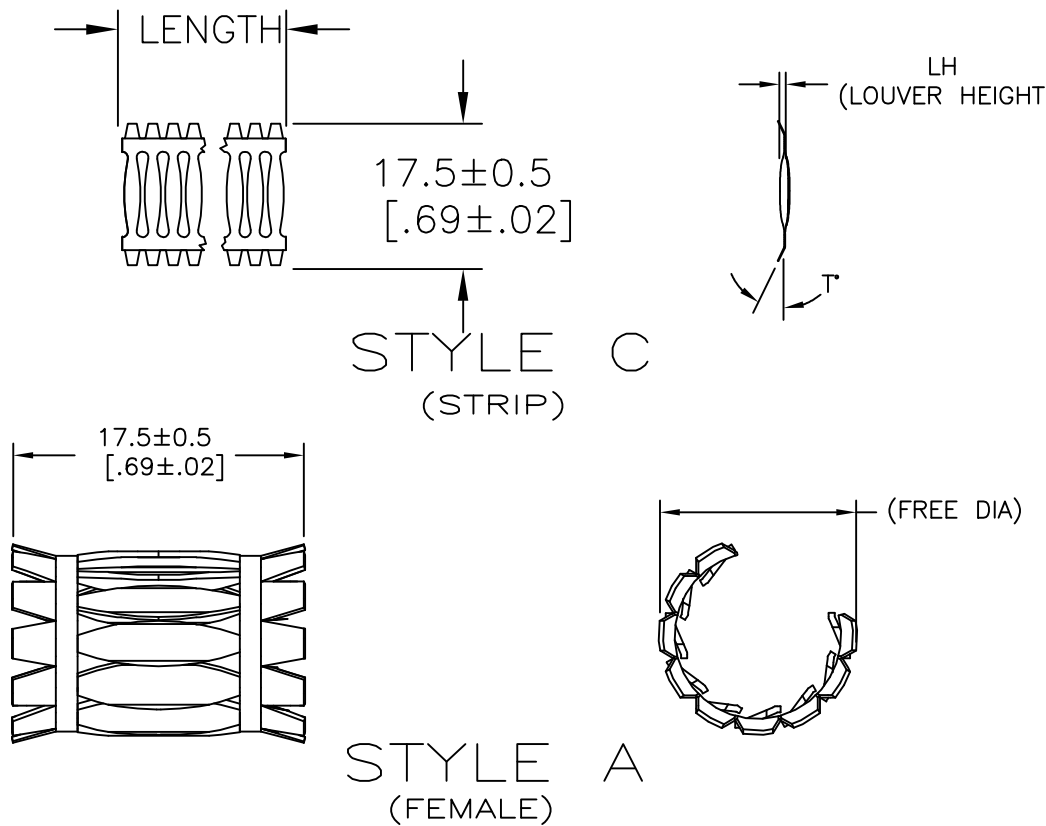

THIS DRAWING IS A CONTROLLED DOCUMENT.		DWN RA JAYNE 07-01-91		TE Connectivity	
DIMENSIONS: mm [INCHES]		CHK G.STEINHAUER 07-01-91			
		TOLERANCES UNLESS OTHERWISE SPECIFIED:		NAME	
		0 PLC ± - 1 PLC ± - 2 PLC ± 0.5 [.02] 3 PLC ± 0.25 [.010] 4 PLC ± - ANGLES ± - FINISH		PRODUCT SPEC	
MATERIAL SEE TABLE		APPLICATION SPEC		SIZE A2	
		WEIGHT -		CAGE CODE 00779	
		CUSTOMER DRAWING		DRAWING NO C=192013	
		SCALE NTS		SHEET 2 of 2	
		REV K			

Mouser Electronics

Authorized Distributor

Click to View Pricing, Inventory, Delivery & Lifecycle Information:

[TE Connectivity:](#)

[5-192013-4](#)