

SIZE	B DIM	C DIM ±.0050	(L DIM)
09	.229	.3085	(.100)
15	.304	.3835	(.175)
25	.429	.5085	(.300)
37	.579	.6585	(.450)
51	.754	.8335	(.625)
65	.929	1.0085	(.800)

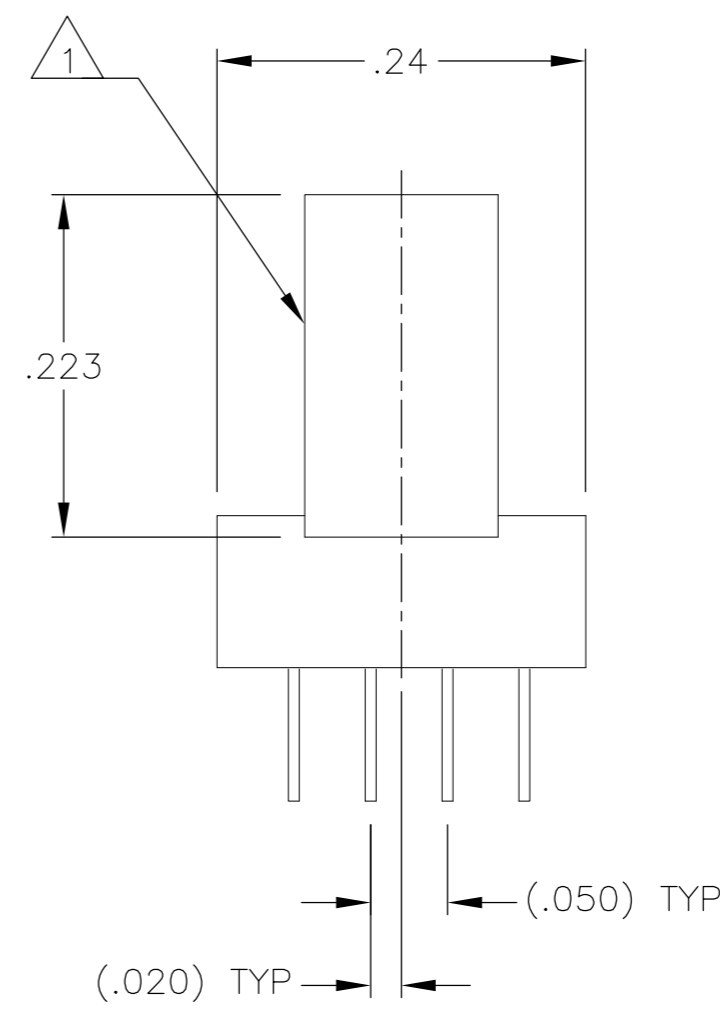

1. SHELL OPTIONS (TO BE SPECIFIED IN NANONICS PART NUMBER):
METAL: 6061-T6 ALUMINUM, ELECTROLESS NICKEL PLATED PER SAE-AMS-C-26074 OR SAE-AMS-2404 (STANDARD) OR GOLD PLATED PER ASTM B488
303 STAINLESS STEEL, PASSIVATED PER SAE-AMS-2700
INSULATOR MATERIAL FOR ALL METAL SHELLS IS LIQUID CRYSTAL POLYMER (LCP) PER MIL-M-24519 OR PER ASTM D5138
PLASTIC: LIQUID CRYSTAL POLYMER (LCP) PER MIL-M-24519 OR PER ASTM D5138
2. STANDARD 1.0 X 0.25mm MOUNTING AND JACKSCREW THREADS ARE SHOWN FOR REFERENCE ONLY AND MUST BE SPECIFIED IN THE NANONICS PART NUMBER WHEN REQUIRED. 1.2 X 0.25mm THREADS ALSO AVAILABLE.
3. MOUNTING HARDWARE IS AVAILABLE WITH THIS CONFIGURATION (NOT SHOWN). HARDWARE MUST BE SPECIFIED IN THE NANONICS PART NUMBER. CONSULT TYCO ELECTRONICS FOR DETAILS.
4. LEAD MATERIAL: HH BRASS, GOLD PLATED PER ASTM B488
5. LEAD ORGANIZER MATERIAL IS LIQUID CRYSTAL POLYMER PER ASTM D5138
6. THROUGH HOLE LEADS ARE EPOXY ENCAPSULATED WITHIN THE LEAD ORGANIZER
7. NANONICS TERMINATION CODE: W5
8. THIS DRAWING PREVIOUSLY IDENTIFIED AS NANONICS N10138/253

THIS DRAWING IS A CONTROLLED DOCUMENT.

DIMENSIONS:	TOLERANCES UNLESS OTHERWISE SPECIFIED:
INCHES	0 PLC ± -
	1 PLC ± -
	2 PLC ± .010
	3 PLC ± .005
	4 PLC ± -
	ANGLES ± 1

MATERIAL	FINISH
SEE NOTES	SEE NOTES

DWN C. SCHOLL 8 AUG 03	CHK M. STORRY 8 AUG 03	APVD —	PRODUCT SPEC —	APPLICATION SPEC —	WEIGHT —	CUSTOMER DRAWING
------------------------------	------------------------------	-----------	-------------------	-----------------------	-------------	------------------

TE Connectivity

RECEPTACLE ASSEMBLY, VERTICAL MOUNT, THROUGH HOLE, 2 TO 4 ROW, .050 SPACING, GOLD PLATED LEADS, PLASTIC OR METAL

SIZE	CAGE CODE	DRAWING NO	RESTRICTED TO
A2	0JPN9	C=1589818	—

SCALE	SHEET	REV
8:1	1 of 2	C1

D

C

B

A

D

C

B

A

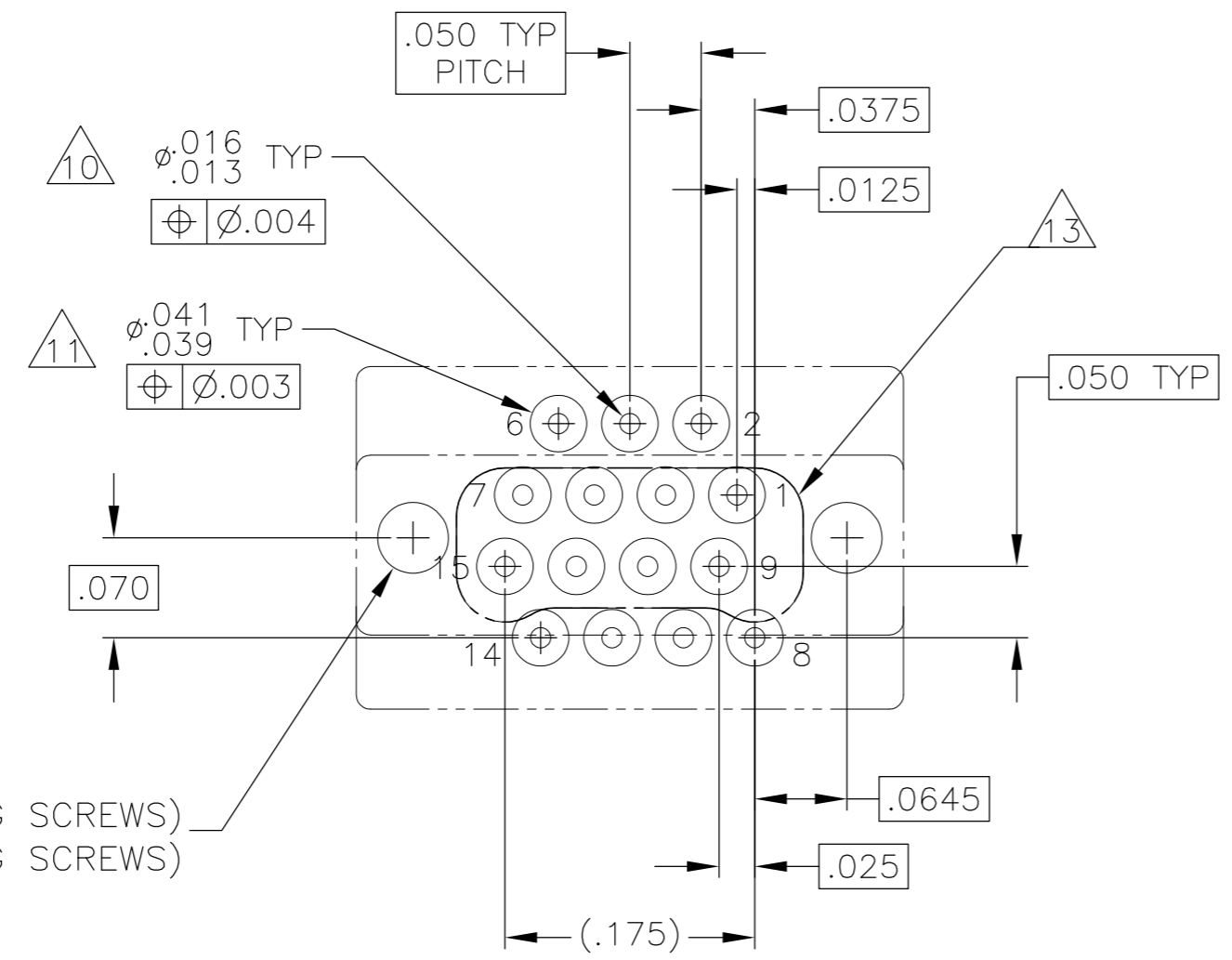
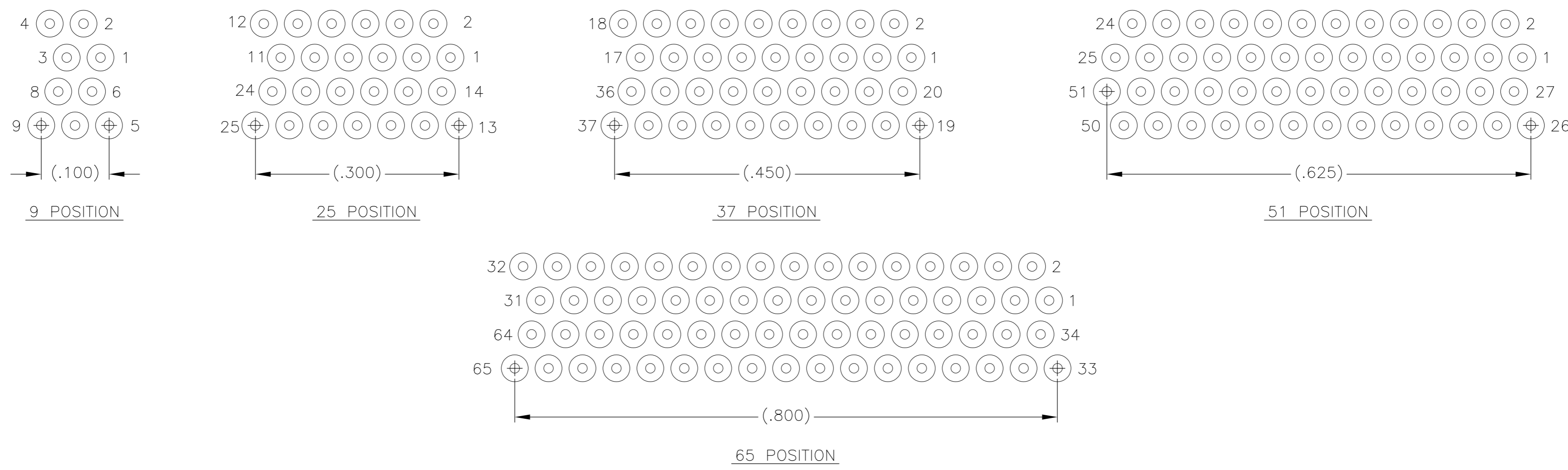

TYPICAL PCB LAYOUT
SIZE 15 SHOWN FOR REFERENCE

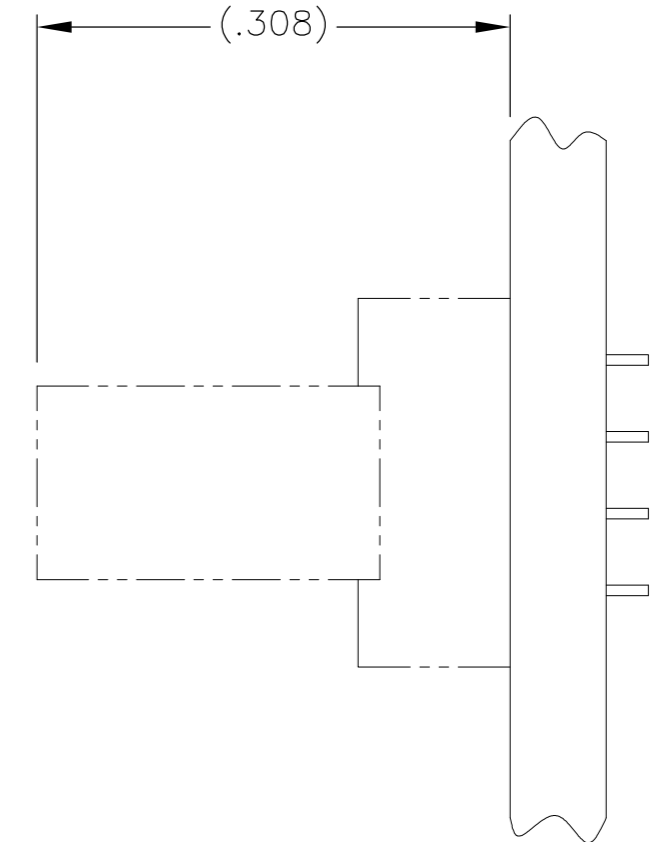

9.

POSITIONAL TOLERANCES FOR BASIC DIMENSIONED FEATURES ARE RELATIVE TO FIDUCIALS OR SOME SIMILAR DATUM REFERENCES DEFINED BY PCB DESIGNER.
10.

PLATED THROUGH HOLES
11.

SOLDER PADS
12.

ALL THROUGH HOLE LAYOUTS ARE AS VIEWED FROM TOP OF PCB.
13.

CONNECTOR ORIENTATION

THIS DRAWING IS A CONTROLLED DOCUMENT.

DIMENSIONS:
INCHES

MATERIAL
SEE NOTES

SEE NOTES

DWN
C. SCHOLL
8 AUG 03

CHK
M. STORRY
8 AUG 03

APVD
—

PRODUCT SPEC
—

APPLICATION SPEC
—

WEIGHT
—

CUSTOMER DRAWING

TOLERANCES UNLESS OTHERWISE SPECIFIED:
0 PLC ± —
1 PLC ± —
2 PLC ± .010
3 PLC ± .005
4 PLC ± —
ANGLES ± 1

FINISH
SEE NOTES

NAME
—

SIZE
A2

CAGE CODE
0JPN9

DRAWING NO
C=1589818

RESTRICTED TO
—

SCALE
8:1

SHEET
2 of 2

REV
C1

TE Connectivity

RECEPTACLE ASSEMBLY, VERTICAL MOUNT, THROUGH HOLE, 2 TO 4 ROW, .050 SPACING, GOLD PLATED LEADS, PLASTIC OR METAL

Mouser Electronics

Authorized Distributor

Click to View Pricing, Inventory, Delivery & Lifecycle Information:

[TE Connectivity:](#)

[1589818-1](#)