

PART NUMBER	REV	FIRST USED	SIZE	TYPE	A	B	C	D	E	F	G	R1
1490357-1	□	1490599-1	4	II	.626	.441	.734	.760	.597	.960	.039	.220
1490357-2	□	1490598-1	6	I	.629	.431	.674	.719	.627	.919	.039	.185
1490357-3	□	1490597-1	8	I	.626	.418	.630	.688	.627	.888	.020	.165

USED ON —

- NOTES:
1. IDENTIFY PART PER 115-67-2 IN APPROXIMATE AREA SHOWN.
 2. HOLES PER 106-4007.
 3. BLANKED EDGE PERMISSIBLE THIS SIDE ONLY.
 4. ALL RADII TO BE BLEND RADII UNLESS OTHERWISE SPECIFIED.

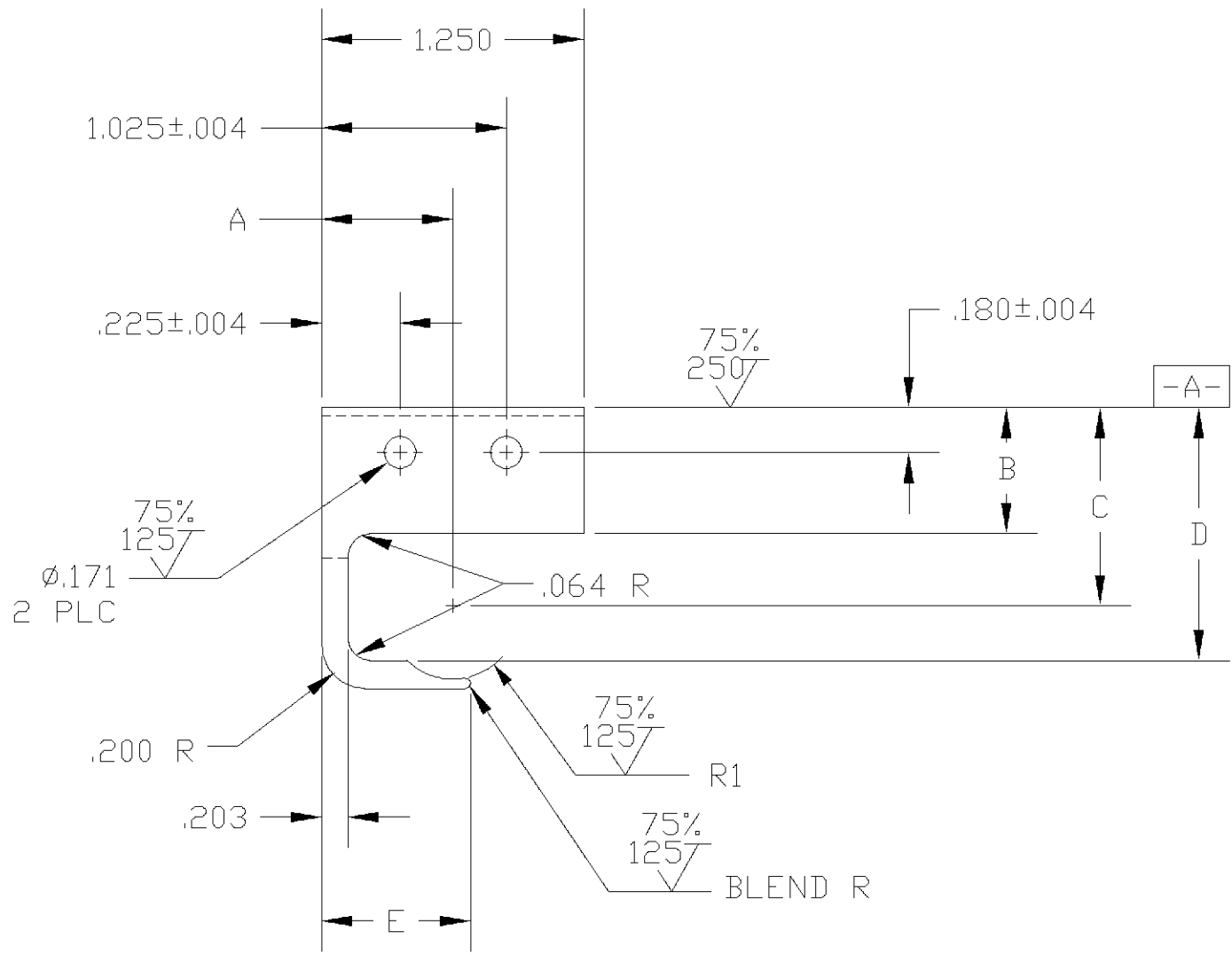

TYPE I

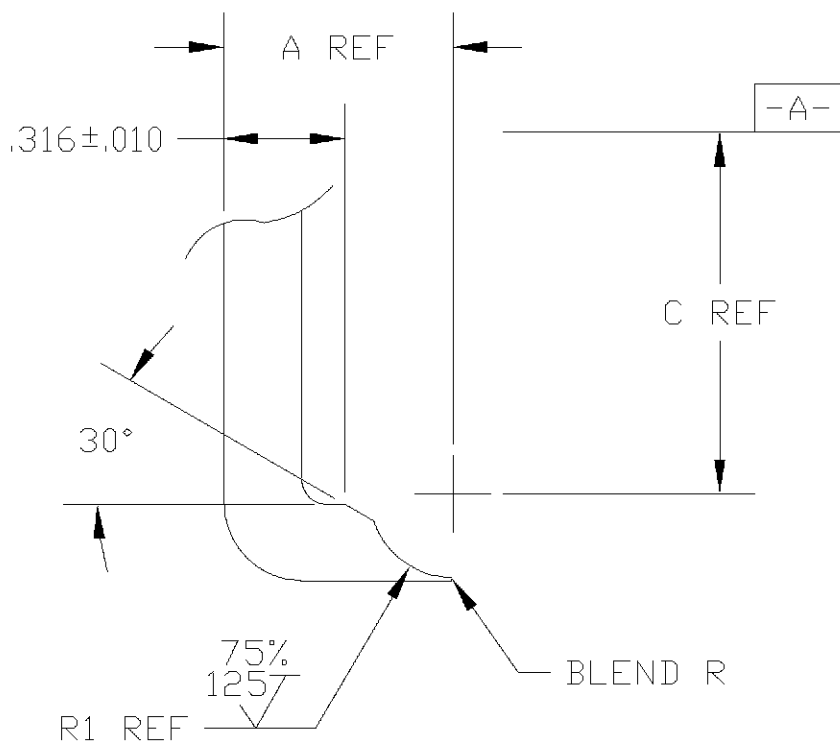

TYPE II
SCALE 2:1

P	LTR	REVISION RECORD	DATE	DWN	APVD
—	—	—	—	—	—

FINISH	112-157-1 BLACKEN
DIMENSIONS:	TOLERANCES UNLESS OTHERWISE SPECIFIED:
INCHES	0 PLC ± — 1 PLC ± — 2 PLC ± .02 3 PLC ± .005 4 PLC ± .0005
ANGLES±	5°
SURFACE TEXTURE	300

DWN	26DEC00	MATERIAL	100-30 CARBON STEEL	HEAT TREAT	111-30-6 RC 45-50
CHK	29NOV01	C. GAVLAK			
APVD	03MAY02	R. SCHAEFFER			
NAME					
LOCATOR					
SCALE	1:1	SIZE	A2	DRAWING NO	1490357
SHEET	1	OF	1	REV	03

THIS INFORMATION IS CONFIDENTIAL AND PROPRIETARY TO TYCO ELECTRONICS CORPORATION AND ITS WORLDWIDE SUBSIDIARIES AND AFFILIATES. IT MAY NOT BE DISCLOSED TO ANYONE, OTHER THAN TYCO ELECTRONICS PERSONNEL, WITHOUT WRITTEN AUTHORIZATION FROM TYCO ELECTRONICS CORPORATION, HARRISBURG, PENNSYLVANIA USA.

LOC
A
DIST
40

Mouser Electronics

Authorized Distributor

Click to View Pricing, Inventory, Delivery & Lifecycle Information:

[TE Connectivity:](#)

[1490357-3](#)