

REVISION			
REV	DESCRIPTION	DATE	APPROVED
B	REVISED RELEASE PER DCR# C050426	May/12/05	M.HIGGY
E	REVISED PER ECO-19-012533	Aug/13/19	A.SOLIS

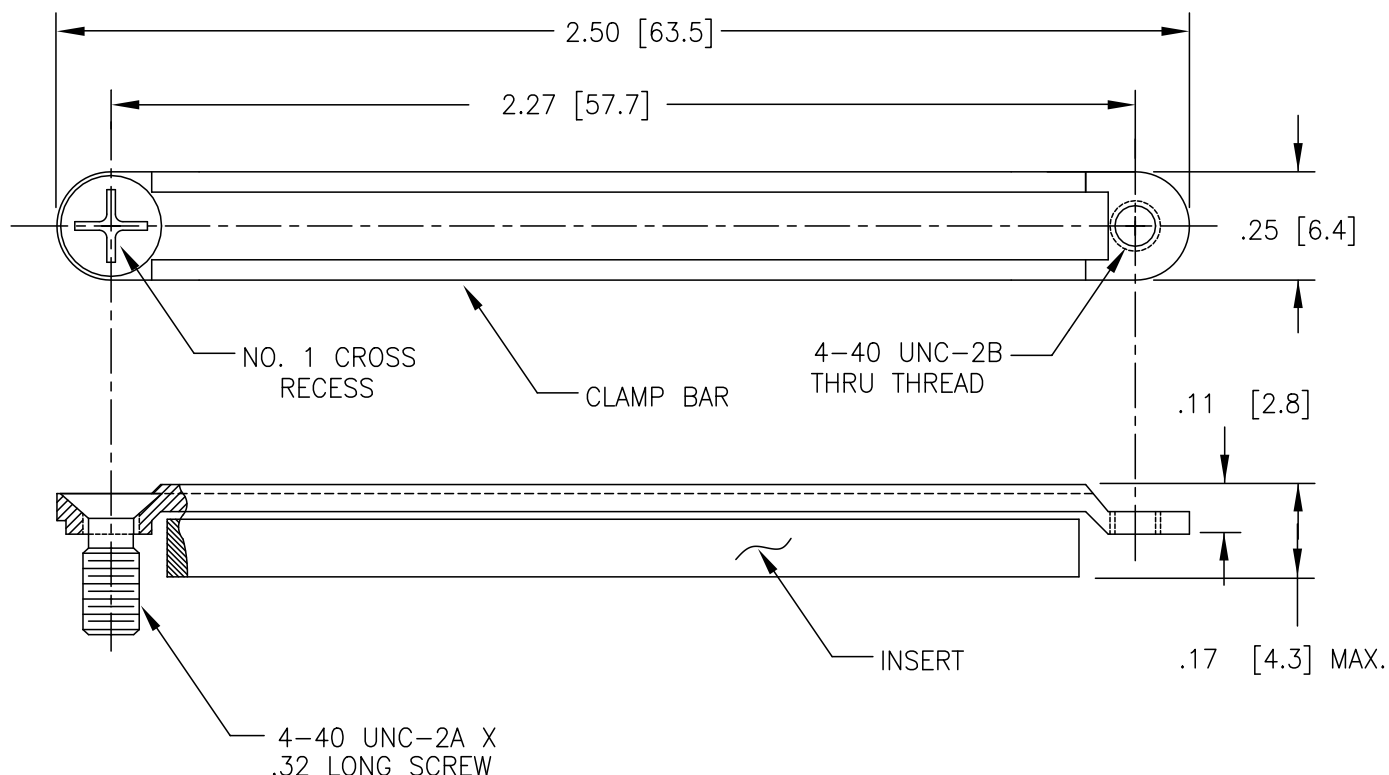

NOTES:

1. THIS PART IS USED WITH MTC PLUG AND RECEPTACLE SHELLS.
(TWO REQUIRED PER CONNECTOR ASSEMBLY)
2. MATERIALS: CLAMP BAR: STAINLESS STEEL, CADMIUM PLATED
INSERT: FLUROSILICONE ELASTOMER
SCREW: STAINLESS STEEL, CADMIUM PLATED

3 WEIGHT: 0.029 Lbs. [13.00 grm.] MAXIMUM/PAIRS.

SPECIFICATION CONTROL DRAWING

© 2005 Tyco Electronics Corporation.
All rights reserved

ITEM	QTY.	PART NO	DWG OR SPEC NO	DESCRIPTION		
PARTS LIST						
UNLESS OTHERWISE SPECIFIED DIMENSIONS ARE INCHES. METRIC DIMENSIONS ARE IN BRACKETS. DECIMAL TOLERANCES .XXX ± .005 .XX ± .01 .X ± ANGLE TOLERANCE .X ± WEIGHT <div><div>3</div></div> CAD FILE C050426.DWG	DRAWN ZS.ORBAN	DATE May/6/05	<div><div>tyco</div><div>Electronics</div></div> <div>TYCO ELECTRONICS 300 Constitution Drive Menlo Park, CA. 94025 USA</div> <div>Raychem</div>		TITLE ASSEMBLY, 2 INCH CLAMP, CABLE CADMIUM PLATED MTC SERIES	
	APPROVED M.HIGGY	DATE May/6/05				
	MATERIAL					
	FINISH					
THIRD ANGLE PROJECTION			<div><div>SIZE A</div><div>CAGE CODE: 06090</div><div>DWG. NO. CHA-0092</div></div>		E	
<div><div></div></div>			DO NOT SCALE THIS DRAWING		SHEET 1 OF 1	

CAD FILE C050426.DWG

Mouser Electronics

Authorized Distributor

Click to View Pricing, Inventory, Delivery & Lifecycle Information:

[TE Connectivity:](#)

[CHA-0092-30](#)