

4  
DRAWING MADE IN THIRD ANGLE PROJECTION

© COPYRIGHT 19 BY AMP INCORPORATED, HARRISBURG, PA.  
ALL INTERNATIONAL RIGHTS RESERVED. AMP INCORPORATED PRODUCTS  
COVERED BY U. S. AND FOREIGN PATENTS AND/OR PATENTS PENDING.

3 2

1 LOC AB DIST 39

REVISIONS					
	F	ZONE	LTR	DESCRIPTION	DATE
			A	REVISED 7086	12/23/80
A1	✓		A1	REVISED & ADDED - 2	4/18/84
✓	✓		A2	ADD - 3: AB-1690	7-86
✓	✓		A3	ECN AB1865	10/15/86
			B	ECO-11-023008	12-11
			C	ECO-12-019992	11-12

D

C

B

A

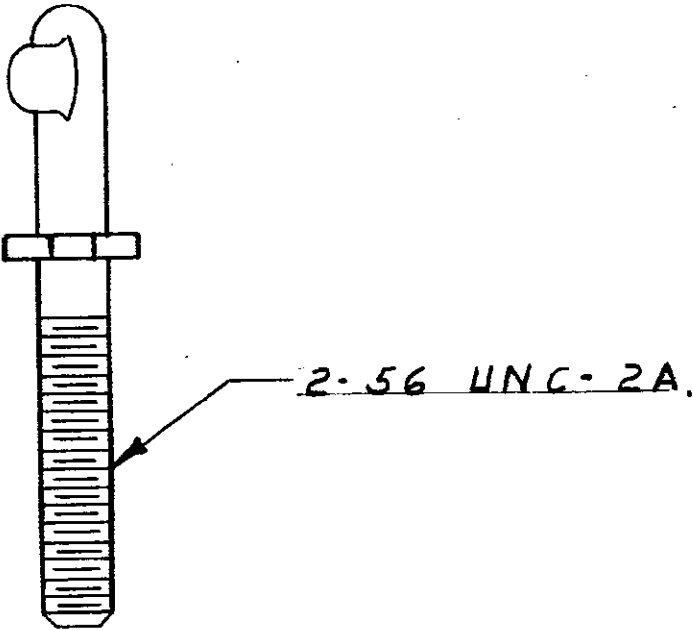
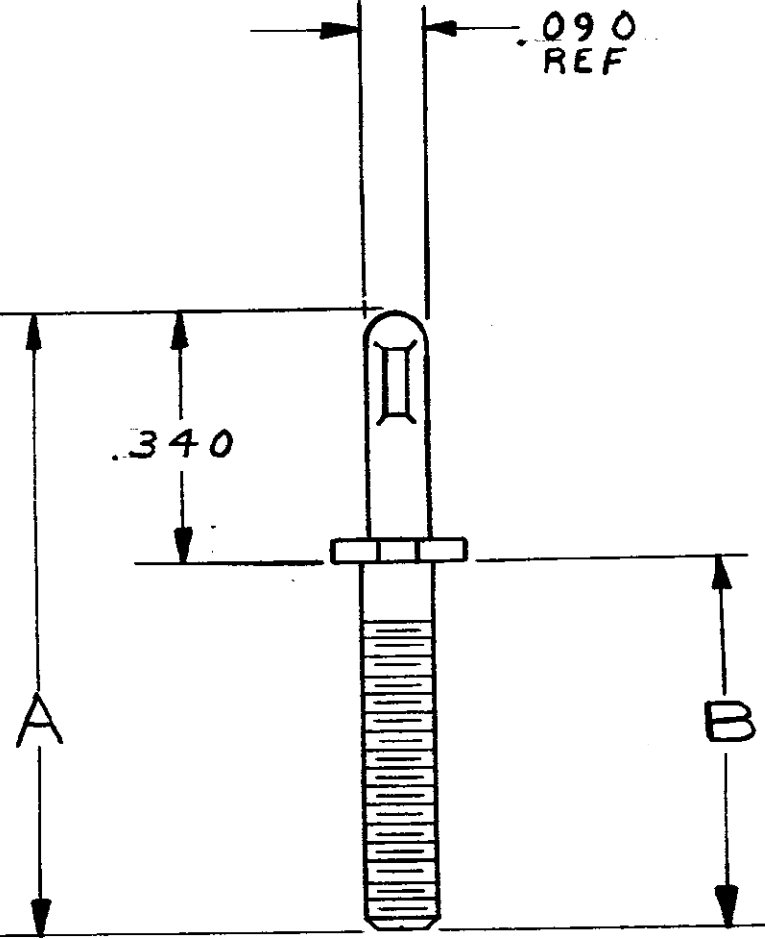

D

C

B

A

1. TO BE USED WITH INSERT P/N 531714-1  
OR 532782-1 OR -2.

.375 REF	.715	531713-5
.0875	.4275	531713-4
.280 REF	.620	531713-3
.410 REF	.750	531713-2
.500 REF	.840	531713-1

B	A	PART NO
---	---	---------

UNLESS OTHERWISE SPECIFIED DIMENSIONS ARE IN INCHES. TOLERANCES ON: DECIMALS ±.005 ANGLES ±	CONTRACT NO 5-29-80	AMP INCORPORATED Harrisburg, Pa.	
	DR. M. Smyth	NAME COMBINATION GUIDE, KEYING PIN	
	CHK. M. Pritchard	SIZE B	CODE IDENT NO 00779
	APPD. M. Pritchard	DRAWING NO 531713	REV C
MATERIAL STAINLESS STEEL	APPD. J. Parsons	SCALE 4:1	SHEET
FINISH PASSIVATED	OTHER APPD		

CUSTOMER DRAWING

# Mouser Electronics

Authorized Distributor

Click to View Pricing, Inventory, Delivery & Lifecycle Information:

[TE Connectivity:](#)

[531713-4](#)