

REVISIONS					
P	LTR	DESCRIPTION	DATE	DWN	APVD
	A	INITIAL RELEASE	04SEP2017	AP	DG
	B	REVISED PER ECO-17-016472	21NOV2017	AP	DG
	C	REVISED PER ECO-18-011822	26JUL2018	AP	DG

Recommended P.C.B Layout
(PCB BOARD TOLERANCE±0.05)

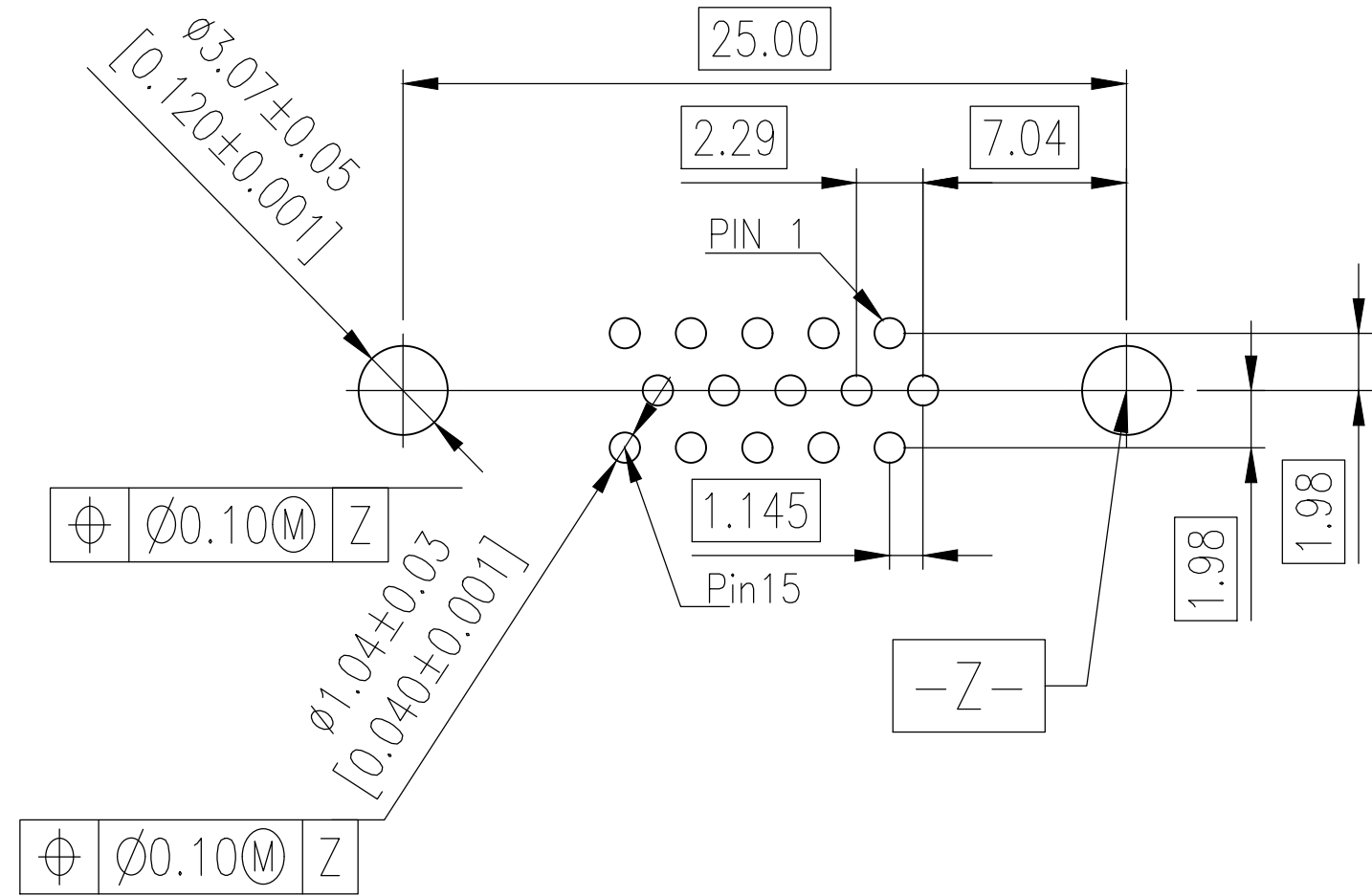
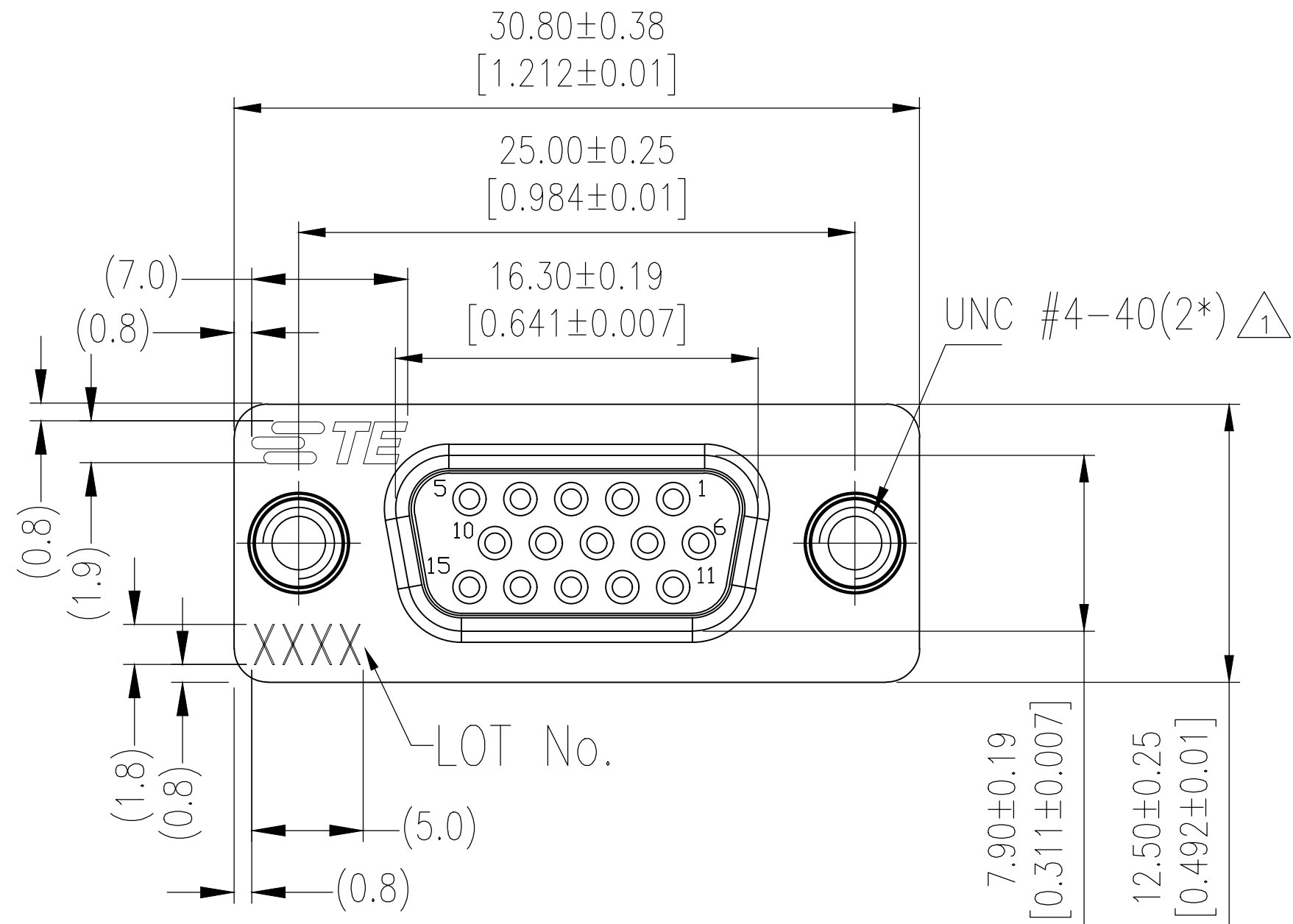

NOTES:
Rated Current:3.0AMP
Contact Resistance:35mΩ max
Withstand Voltage:500V AC
Insulation Resistance:1000MΩ min
Operation Temperature:-40℃ to +85℃

Insulator:PBT UL94V-0 BLACK
Contact:Phosphor Bronze
" GOLD PLATING ON CONTACT AREA
100u" MATTE TIN PLATING ON SOLDER TAIL
50u" NICKEL UNDERPLATED OVERALL
Holdowns:Brass,100u" TIN OVER 50u" NICKEL
Sheet:SPCC,50u" NICKEL PLATING OVERALL

LOT NUMBER "XXXX"
—Stands For Calendar Year
—Stands For Week Number

△ ACCEPTS MAXIMUM 4.70 [.185] LONG MALE THREAD.

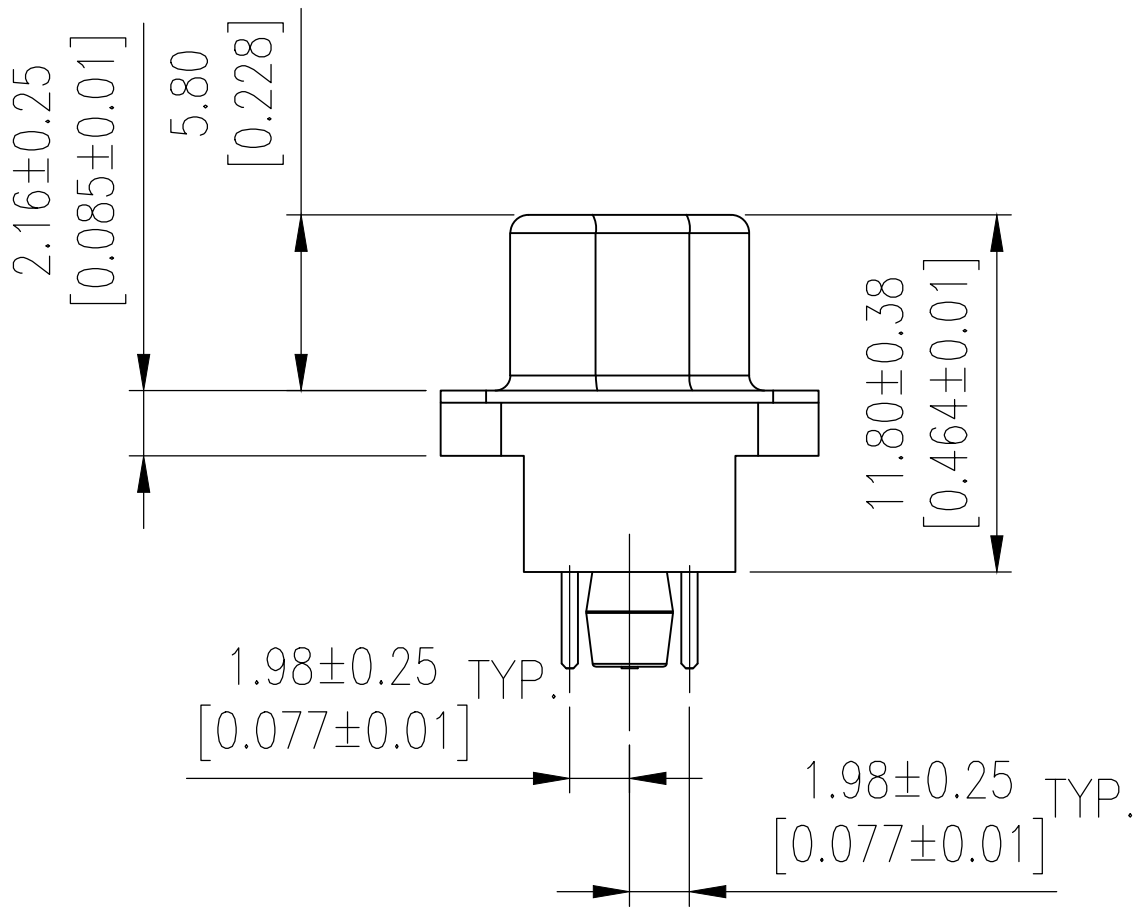
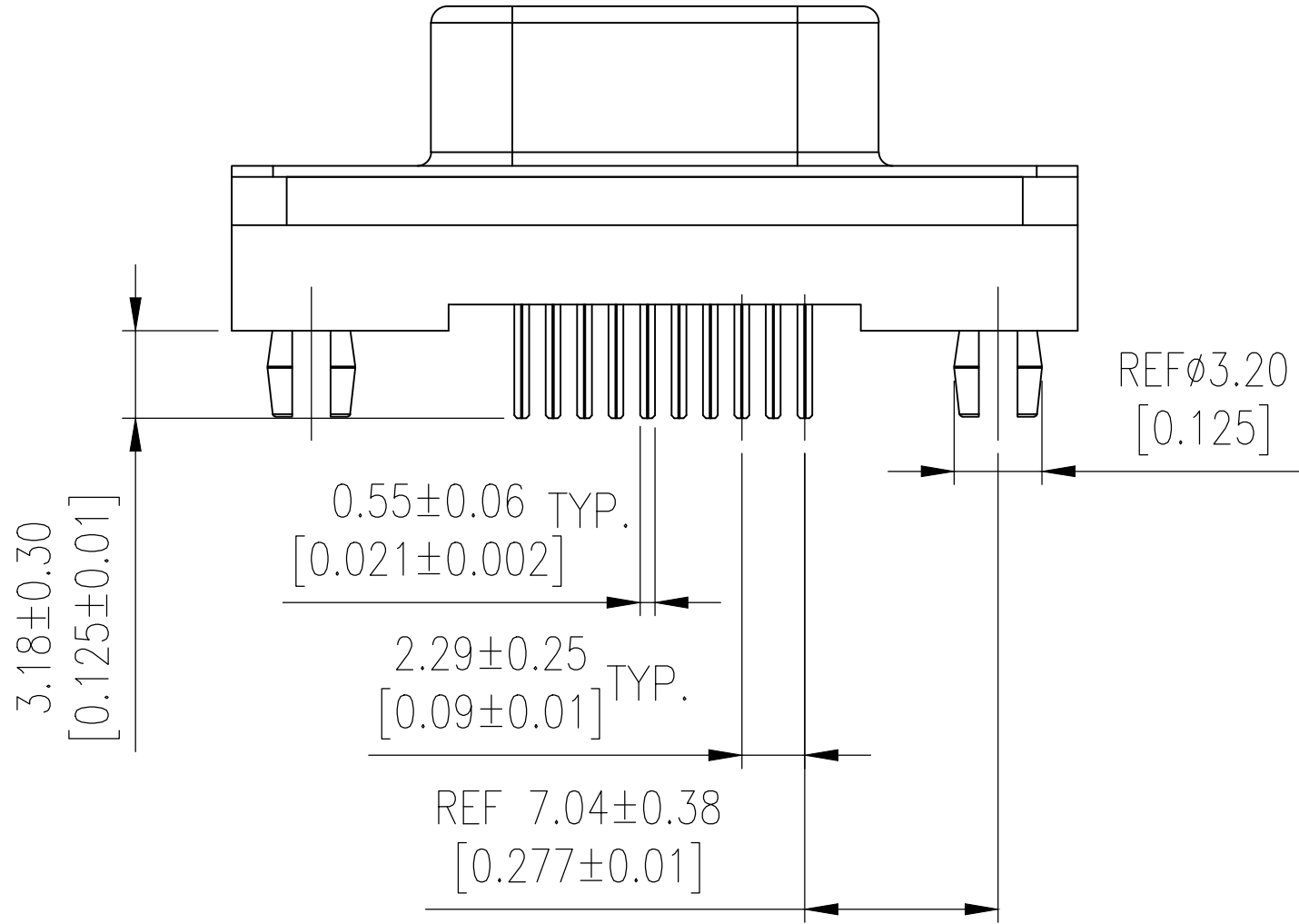

THREADED INSRET	30μ" Au	2317171-1
TYPE	Contact Area	P/N
	Plating	

THIS DRAWING IS A CONTROLLED DOCUMENT.		DWN AJITH PAI 14MAR2017	TE Connectivity		
DIMENSIONS: mm		CHK DANIEL GORENC 14MAR2017			
TOLERANCES UNLESS OTHERWISE SPECIFIED:		APVD DANIEL GORENC 14MAR2017	NAME AMPLIMITE RECEPTACLE, HD22, 15P, VERTICAL THREADED		
0 PLC ± - 1 PLC ± - 2 PLC ± 0.25 3 PLC ± - 4 PLC ± - ANGLES ± -		PRODUCT SPEC			
MATERIAL		FINISH	SIZE A2		
			CAGE CODE 00779		
			DRAWING NO C=2317171		
			RESTRICTED TO		
			SCALE 1:1		
			SHEET 1 OF 1		
			REV C		

Mouser Electronics

Authorized Distributor

Click to View Pricing, Inventory, Delivery & Lifecycle Information:

[TE Connectivity:](#)

[2317171-1](#)