

| LOC | DIST | REVISIONS | | | | | |
|-----|------|-----------|-----|-------------|--|-----------|------|
| | | P | LTR | DESCRIPTION | | DATE | APVD |
| - | - | | BA | NEW DRAWING | | 24APR2012 | ST.P |

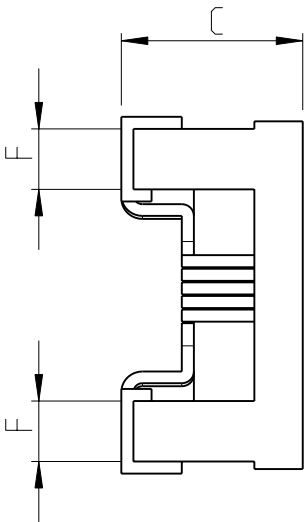

FOR FURTHER INFORMATION SEE DATA SHEET FOR
3650 SERIES-LOW INDUCTANCE,HIGH FREQUENCY CHIP INDUCTOR

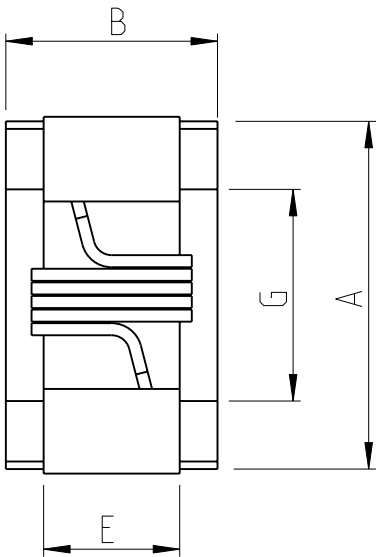
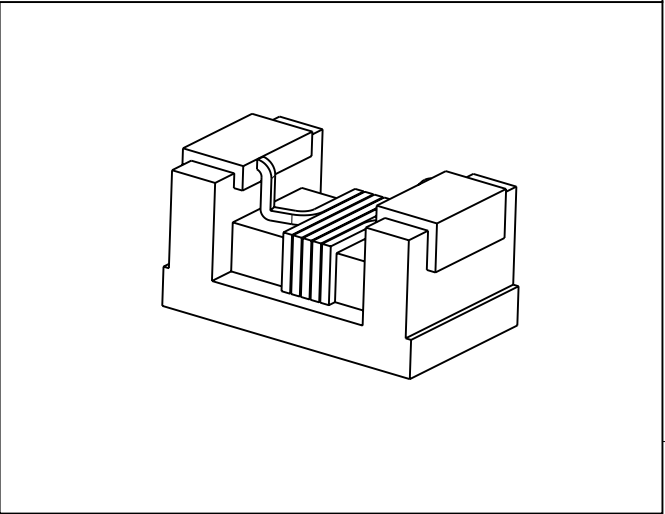
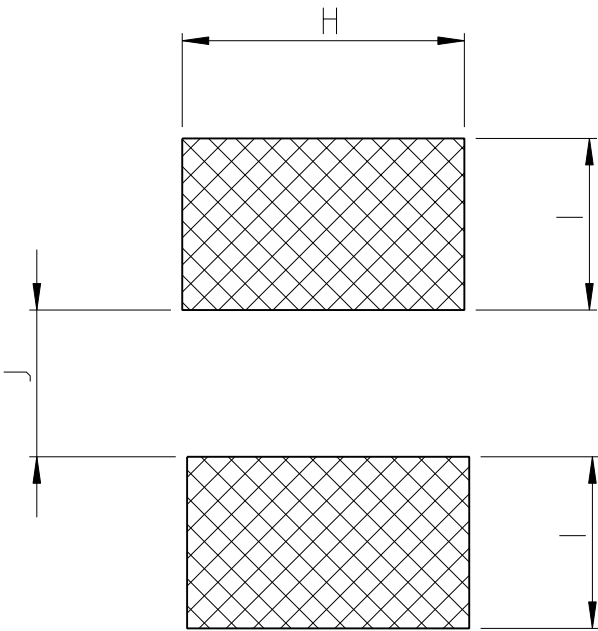

| SERIES | A Max. | B Max. | C Max. | E | F | G | H | I | J |
|---------|--------|--------|--------|------|------|------|------|------|------|
| 3654 1E | 1.15 | 0.70 | 0.60 | 0.45 | 0.20 | 0.60 | 0.65 | 0.35 | 0.50 |

THIS DRAWING IS A CONTROLLED DOCUMENT.

DIMENSIONS:
mm

MATERIAL -

TOLERANCES UNLESS OTHERWISE SPECIFIED:

0 PLC ±-

1 PLC ±0.5

2 PLC ±0.2

3 PLC ±0.1

4 PLC ±0.0001

ANGLES ±

FINISH -

DWN 24APR2012
RAGHAVENDRA K

CHK 24APR2012
ALLAN P

APVD 24APR2012
STEPHEN.P

PRODUCT SPEC -

APPLICATION SPEC -

WEIGHT 0.001 GRAM

CUSTOMER DRAWING

TE Connectivity

NAME -

CHIP INDUCTOR TYPE 3654 0201 SERIES

SIZE A3CAGE CODE 00779DRAWING NO C=2176086

RESTRICTED TO -

SCALE 32:1SHEET 1 OF 1REV BA

Mouser Electronics

Authorized Distributor

Click to View Pricing, Inventory, Delivery & Lifecycle Information:

[TE Connectivity:](#)

[3-2176086-6](#)