

THIS DRAWING IS UNPUBLISHED.

RELEASED FOR PUBLICATION

ALL RIGHTS RESERVED.

© COPYRIGHT BY TYCO ELECTRONICS CORPORATION.

LOC	DIST	REVISIONS				
P	LTR	DESCRIPTION		DATE	DWN	APVD
		REVISED PER ECO-09-004812		04MAY10	HMR	CR

MATERIALS:
HOUSING: THERMOPLASTIC, UL94V-0, BLACK.
TERMINAL: BRIGHT TIN OVER COPPER ALLOY.
SCREWS: 8-32, ZINC PLATED STEEL.

ELECTRICAL:
CURRENT RATING: 30A
VOLTAGE RATING: 600V
WIRE RANGE: 10-18 AWG (UL)
10-22 AWG (CSA)

MECHANICAL:
RECOMMENDED TORQUE: 20 IN-LB.
OPERATING TEMP.: -40°C TO +120°C MAX.

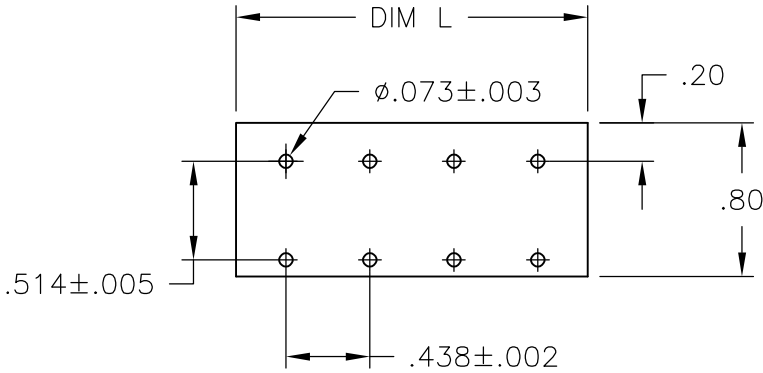
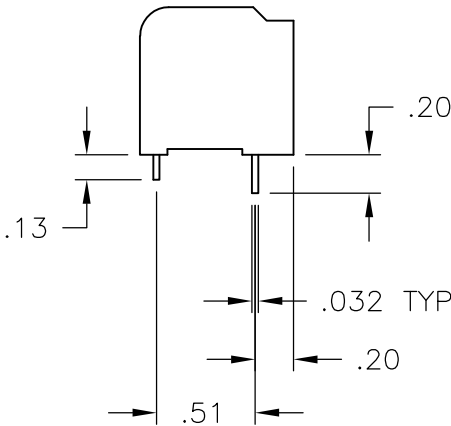
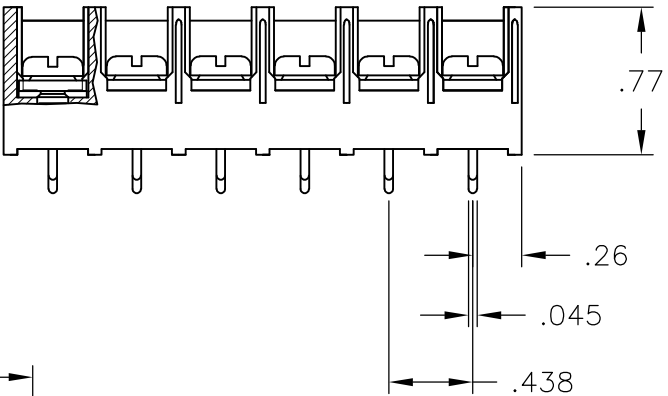
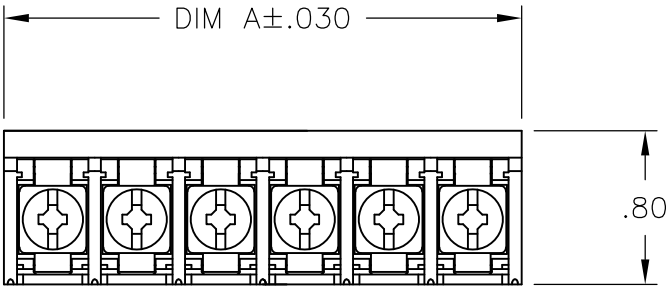

RECOMMENDED PCB LAYOUT

- 1 PRELIMINARY PART NUMBER.
- 2 TERMINAL TAPPED TO M4 WITH NO SCREWS

OBSOLETE	-9.698	22	8DBL-22-006	2-796709-2
OBSOLETE	-9.260	21	8DBL-21-006	2-796709-1
1	8.823	20	8DBL-20-006	2-796709-0
1	8.385	19	8DBL-19-006	1-796709-9
1	7.948	18	8DBL-18-006	1-796709-8
1	7.510	17	8DBL-17-006	1-796709-7
1	7.073	16	8DBL-16-006	1-796709-6
1	6.635	15	8DBL-15-006	1-796709-5
1	6.198	14	8DBL-14-006	1-796709-4
1	5.760	13	8DBL-13-006	1-796709-3
1	5.323	12	8DBL-12-006	1-796709-2
1	4.885	11	8DBL-11-006	1-796709-1
1	4.448	10	8DBL-10-006	1-796709-0
1	4.010	9	8DBL-09-006	796709-9
1	3.573	8	8DBL-08-006	796709-8
	3.135	7	8DBL-07-002	796709-2
	3.135	7	8DBL-07-006	4-1546159-7
	2.698	6	8DBL-06-006	1-1437657-7
	2.260	5	8DBL-05-006	4-1546159-6
	1.823	4	8DBL-04-006	1-1437657-3
2 OBSOLETE	-1.385	3	8DBL-03-649	1986428-1
	1.385	3	8DBL-03-006	1-1437657-1
1	.948	2	8DBL-02-656	2-796709-3
	.948	2	8DBL-02-006	1437657-8
DIM A		NO OF POS	CATALOG NUMBER	TE PART NO.

THIS DRAWING IS A CONTROLLED DOCUMENT.		DWN S SCHLEGEL 6/20/03	Tyco Electronics Corporation Harrisburg, PA 17105-3608	
		CHK S YODER 6/20/03		
		APVD S YODER 6/20/03	NAME	
DIMENSIONS: INCHES		PRODUCT SPEC	8DBL-XX-006 ASSEMBLY	
		APPLICATION SPEC		
		WEIGHT	SIZE A3	CAGE CODE 00779
MATERIAL		FINISH	DRAWING NO C-1-1437657-1	RESTRICTED TO
			SCALE 1:1	SHEET 1 OF 1
CUSTOMER DRAWING			REV F	

Mouser Electronics

Authorized Distributor

Click to View Pricing, Inventory, Delivery & Lifecycle Information:

[TE Connectivity:](#)

[1437657-8](#)