

- 1

MATERIAL: HOUSING: POLYESTER, COLOR, GRAY, UL 94V-O.
CONTACT: HIGH CURRENT COPPER ALLOY.
- 2

FINISH:
IN ACCORDANCE WITH PRODUCT SPECIFICATION 108-1651,
GOLD PLATING OR EQUIVALENT PLATING ON PRODUCT CONTACT MATING AREA,
AND MATTE TIN PLATING ON COMPLIANT PIN AREA, ALL OVER MATTE NICKEL
UNDERPLATED. DETAIL PLEASE REFER TO PRODUCT SPECIFICATION 108-1651.
- 3

TOLERANCE TO BE ± 0.25 BEFORE CONNECTOR IS APPLIED TO PC BOARD.
- 4

REFERENCE APPLICATION SPEC 114-1103 FOR
RECOMENDED PLATED THRU HOLE DIAMETER AND
PLATING THICKNESS.

5. CURRENT RATING 16A/CONTACT PER PRODUCT SPEC 108-1651.

| LOC | DIST | REVISIONS | | | | | |
|-----|------|-----------|-----|-----------------------|-----------|-----|------|
| AD | 00 | P | LTR | DESCRIPTION | DATE | DWN | APVD |
| | | | B1 | REV PER ECO-20-004668 | 21APR2020 | ML | SZ |
| | | | | | | | |
| | | | | | | | |

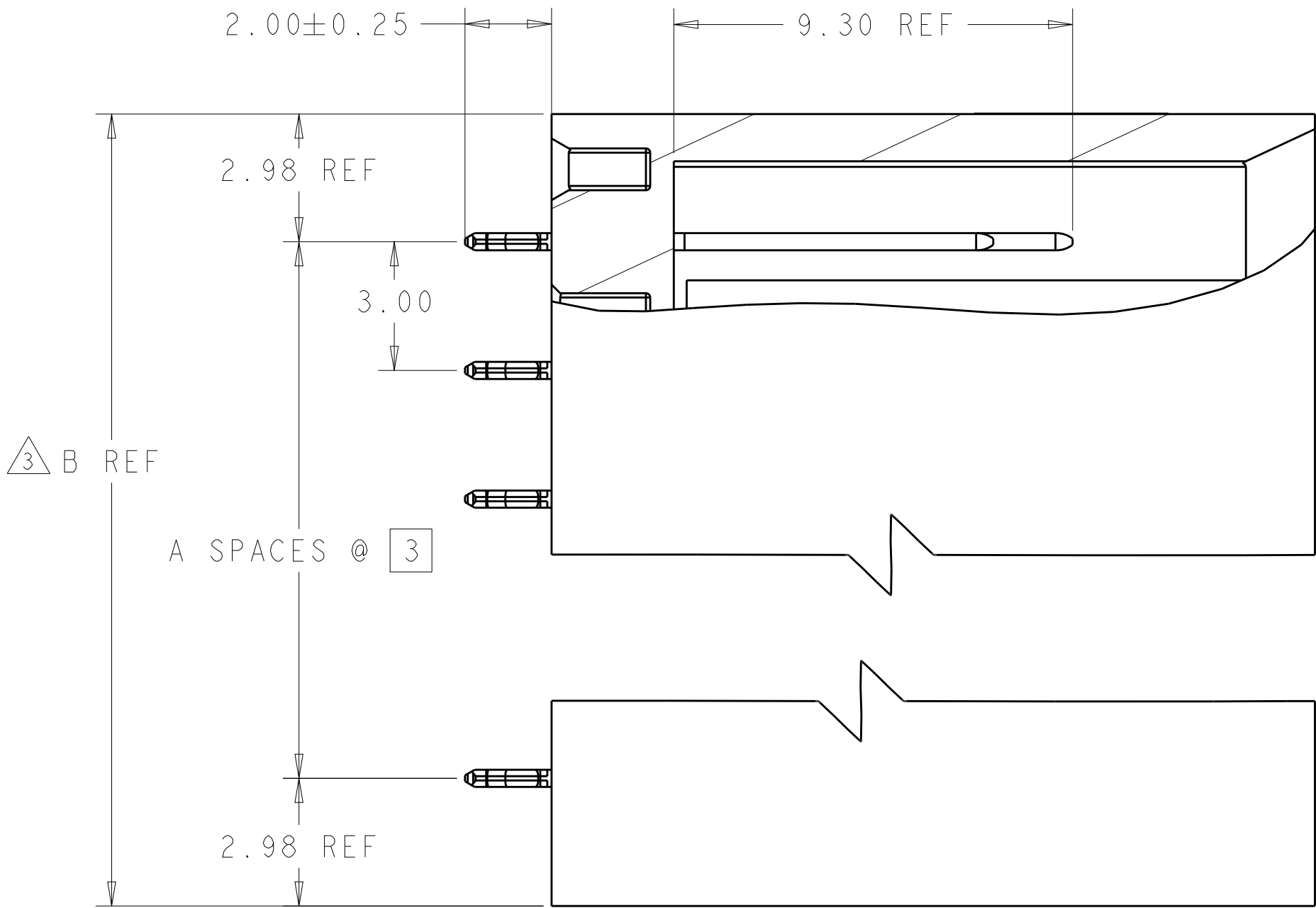
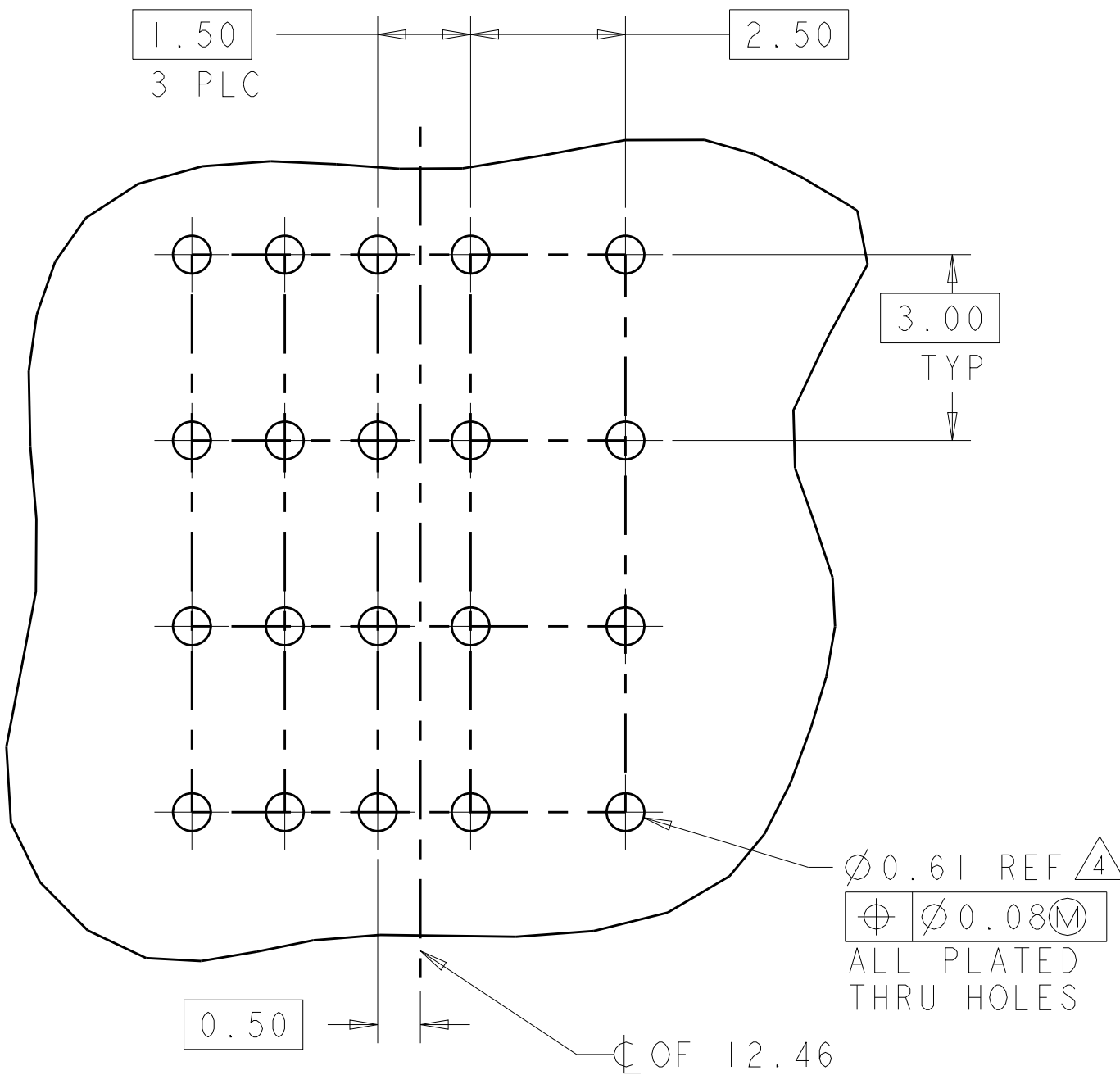
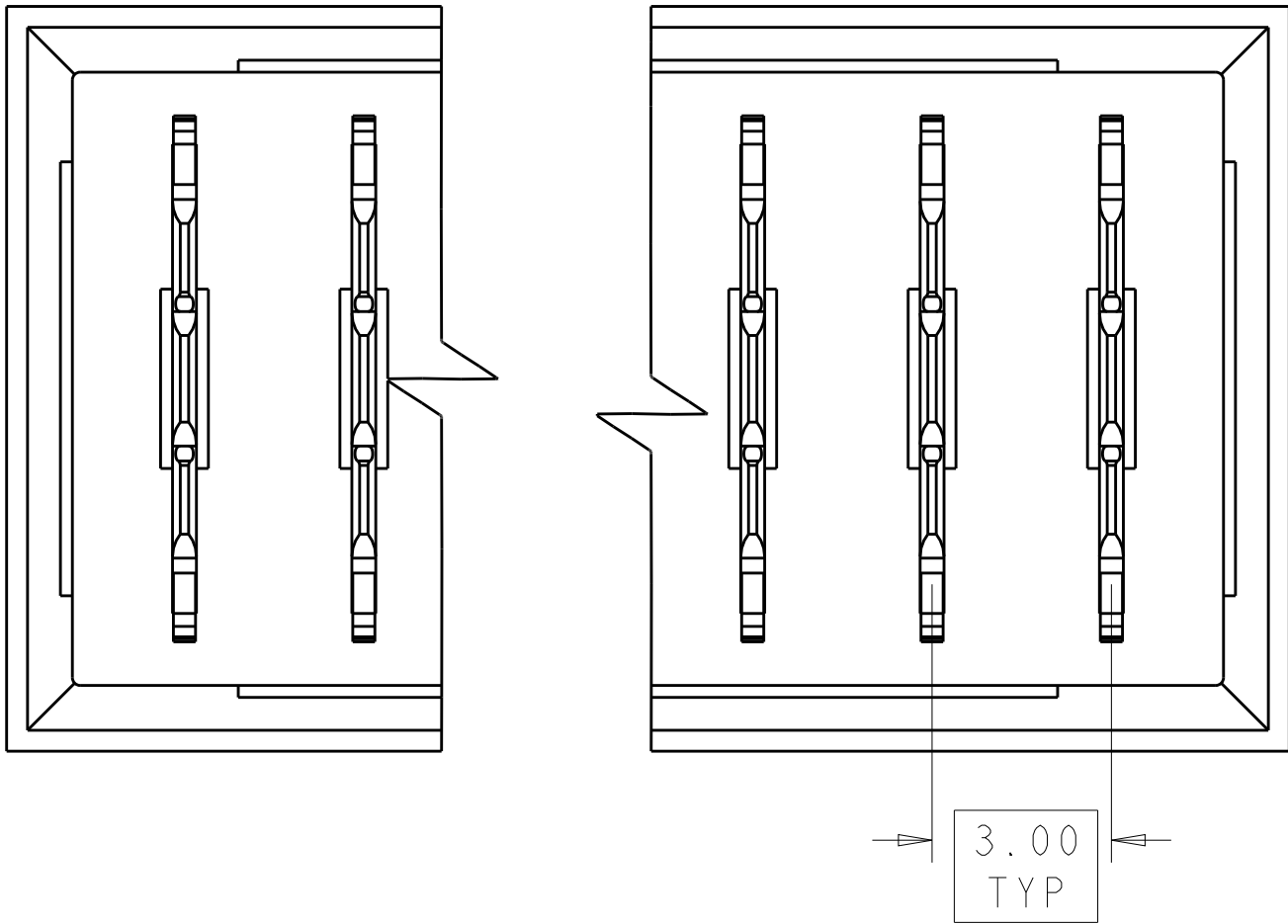
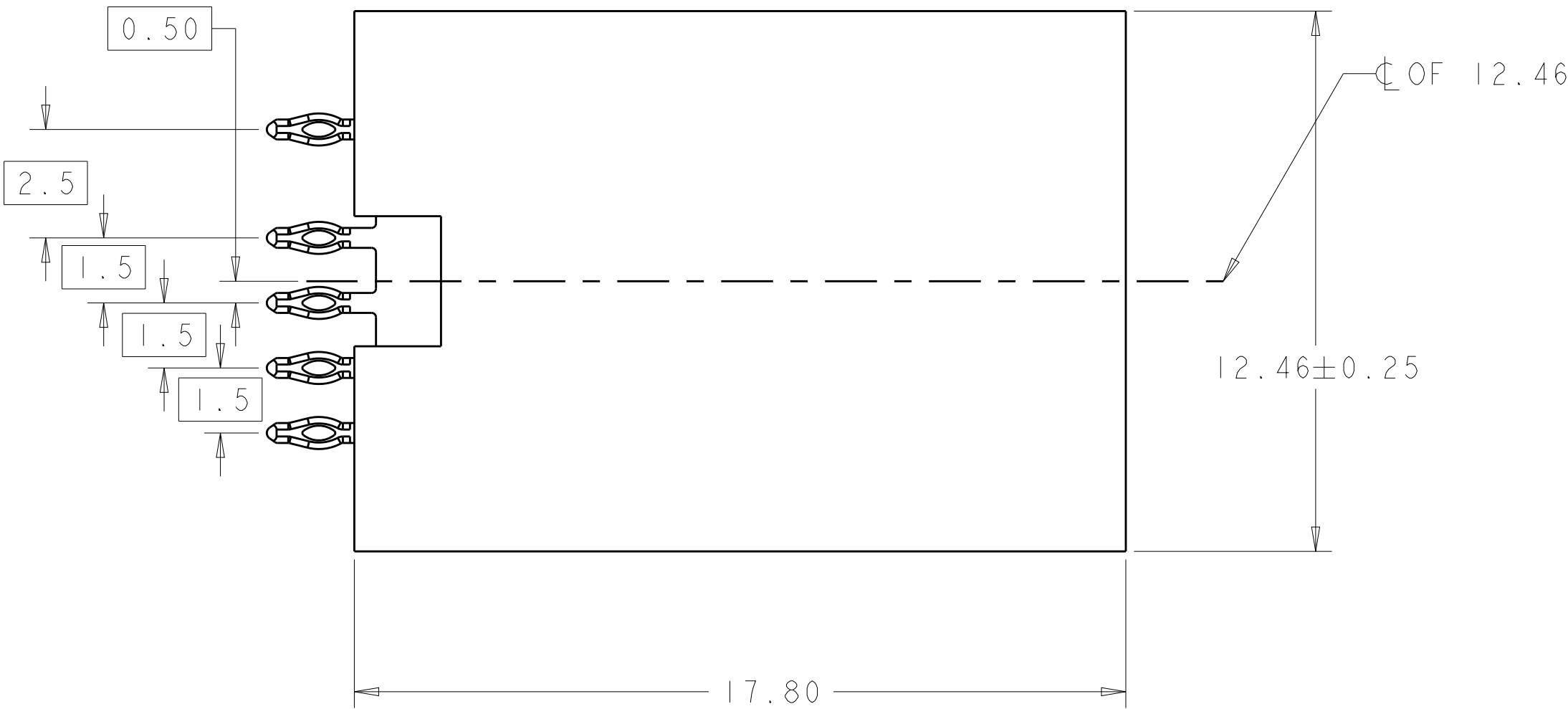

SECTION B-B

RECOMMENDED PCB HOLE LAYOUT
SCALE 10:1

| | | | |
|----------|-------|-------|---------------|
| 9 | 29.95 | 8 | 1645499-7 |
| 8 | 26.95 | 7 | 1645499-6 |
| 7 | 23.95 | 6 | 1645499-5 |
| 6 | 20.95 | 5 | 1645499-4 |
| 5 | 17.95 | 4 | 1645499-3 |
| 4 | 14.95 | 3 | 1645499-2 |
| 3 | 11.95 | 2 | 1645499-1 |
| POSITION | | B REF | A PART NUMBER |

| | | | | |
|---|--|----------------------------------|---|--|
| THIS DRAWING IS UNPUBLISHED. IT IS SUBJECT TO CHANGE WITHOUT NOTICE. ANY CHANGES TO THIS DRAWING SHOULD BE CONTACTED FOR THE LATEST REVISION. | | DWN D. HUMBERT 02MAR2009 | Tyco Electronics Harrisburg, PA 17105-3608 | |
| DIMENSIONS: mm | | CHK G. GRIFFITH 02MAR2009 | NAME G. GRIFFITH | |
| TOLERANCES UNLESS OTHERWISE SPECIFIED: 0 PLC ± 1 PLC ±0.13 2 PLC ± 3 PLC ± 4 PLC ± ANGLES ± | | APVD G. GRIFFITH 02MAR2009 | PRODUCT SPEC 108-1651 | |
| MATERIAL | | FINISH | APPLICATION SPEC 114-1103 | |
| | | | WEIGHT | |
| | | | CUSTOMER DRAWING | |
| | | | SCALE 8:1 | |
| | | | SHEET 1 OF 1 | |
| | | | REV B1 | |

Mouser Electronics

Authorized Distributor

Click to View Pricing, Inventory, Delivery & Lifecycle Information:

[TE Connectivity:](#)

[1645499-4](#)