

Power Latching Relay EW80

- 1 pole 80A, 1 form A (NO) contact
- Polarized bistable (latching), single coil version
- Shunt implementation optional
- Various terminal configurations



Typical applications
Electricity meters, pre-paid power meters



Approvals

UL E58304; CQC 09002031473

Contact Data

Contact arrangement	1 form A (NO)
Rated voltage	250VAC
Max. switching voltage	440VAC
Rated current	80A
Breaking capacity max.	20kVA
Contact material	AgSnO ₂
Initial voltage drop	≤80mV @ 80A
Frequency of operation with/without load	360/3600h ⁻¹

Contact ratings - UL508

Load	Cycles
80A, 250VAC, resistive, 70°C	10 ³
TV-20, 120VAC, 70°C	25x10 ³
Mechanical endurance	10 ⁶

Coil Data

Magnetic system	polarized, bistable (latching)
Coil voltage range	5 to 24VDC
Min./Max. energization duration	100ms/1min at <10% duty factor

Coil versions, bistable 1 coil

Coil code	Rated voltage VDC	Set voltage VDC	Reset voltage VDC	Coil resistance Ω±10%	Rated coil power W
B005	5	4	4	25	1
B006	6	4.8	4.8	36	1
B009	9	7.2	7.2	81	1
B012	12	9.6	9.6	144	1
B024	24	19.2	19.2	576	1

All figures are given for coil without preenergization, at ambient temperature +23°C
Max. coil power: 130% of rated coil power
Other coil voltages on request

Coil operation

coil terminals	A1	A2
Pull-in	-	+
Reset	+	-

Contact position not defined at delivery

Insulation Data

Initial dielectric strength	
between open contacts	1500V _{rms}
between contact and coil	4000V _{rms}
Initial surge withstand voltage	
between contact and coil	10000V (1.2/50μs)
Clearance/creepage	
between contact and coil	≥6/9mm
Material group of insulation parts	IIIa
Tracking index of relay base	PTI 175V

Other Data

Material compliance: EU RoHS/ELV, China RoHS, REACH, Halogen content refer to the Product Compliance Support Center at www.te.com/customer-support/rohssupportcenter

Ambient temperature	-40 to 70°C
Category of environmental protection	
IEC 61810	RTI (dust protected)
Vibration resistance (functional)	1.5mm double amplitude ¹⁾
Shock resistance (functional)	50g
Shock resistance (destructive)	100g
Terminal type	Lugs and PC terminals
Weight	40g
Packaging/unit	tray/25 pcs., box/100 pcs.

¹⁾ 10...55Hz

Power Latching Relay EW80 (Continued)

Dimensions

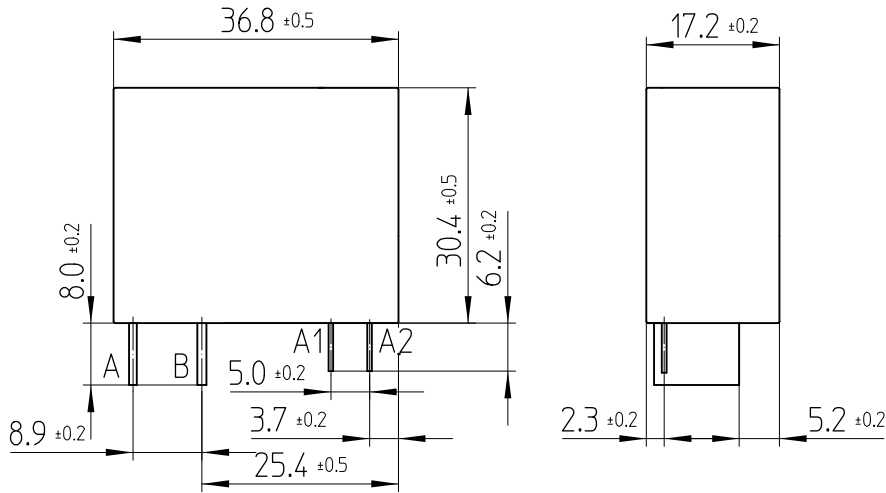

Vertical version, straight terminals

Contact terminals:
A: 11x1.0mm
B: 11x1.2mm

Coil terminals:
0.6 x0.6mm

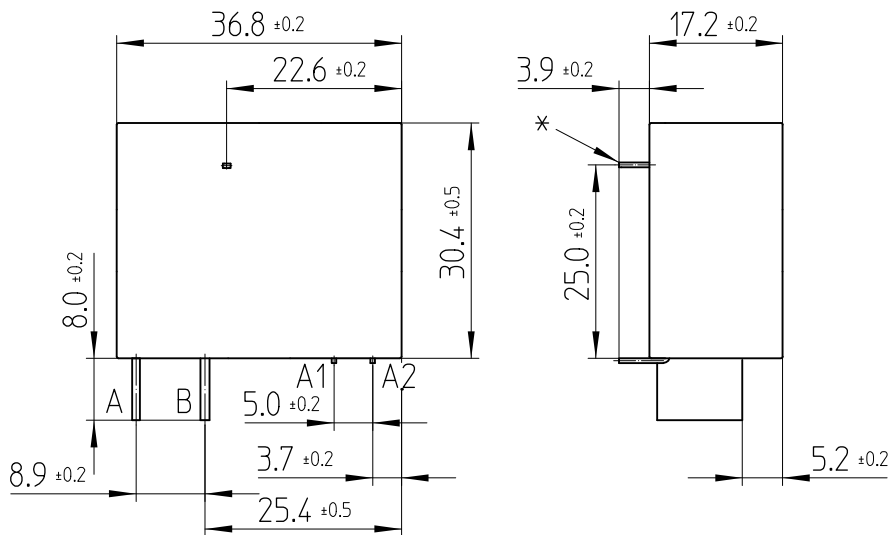

Horizontal version, straight terminals

Contact terminals:
A: 11x1.0mm
B: 11x1.2mm

Coil terminals:
0.6 x0.6mm

* auxiliary solder point 0.6 x1.0

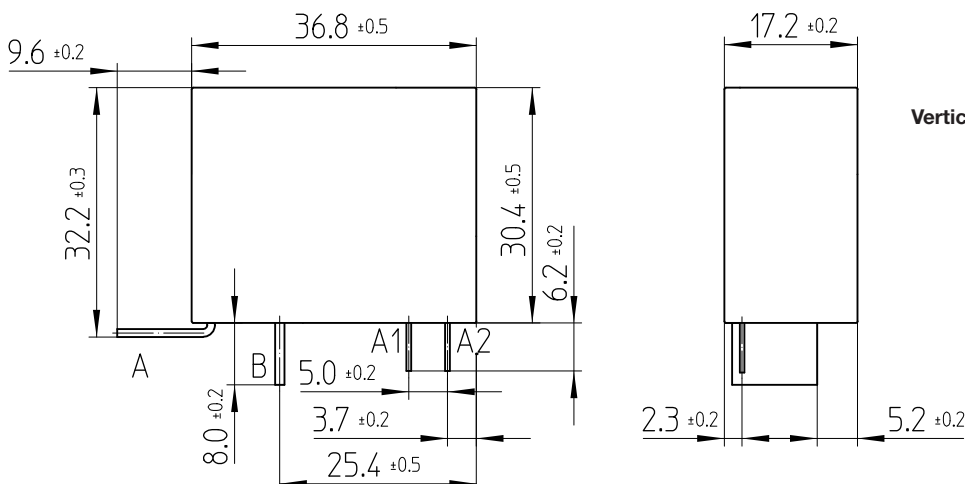

Vertical version, angled terminals

Contact terminals:
A: 11x1.0mm
B: 11x1.2mm

Coil terminals:
0.6 x0.6mm



Power Latching Relay EW80 (Continued)

Dimensions

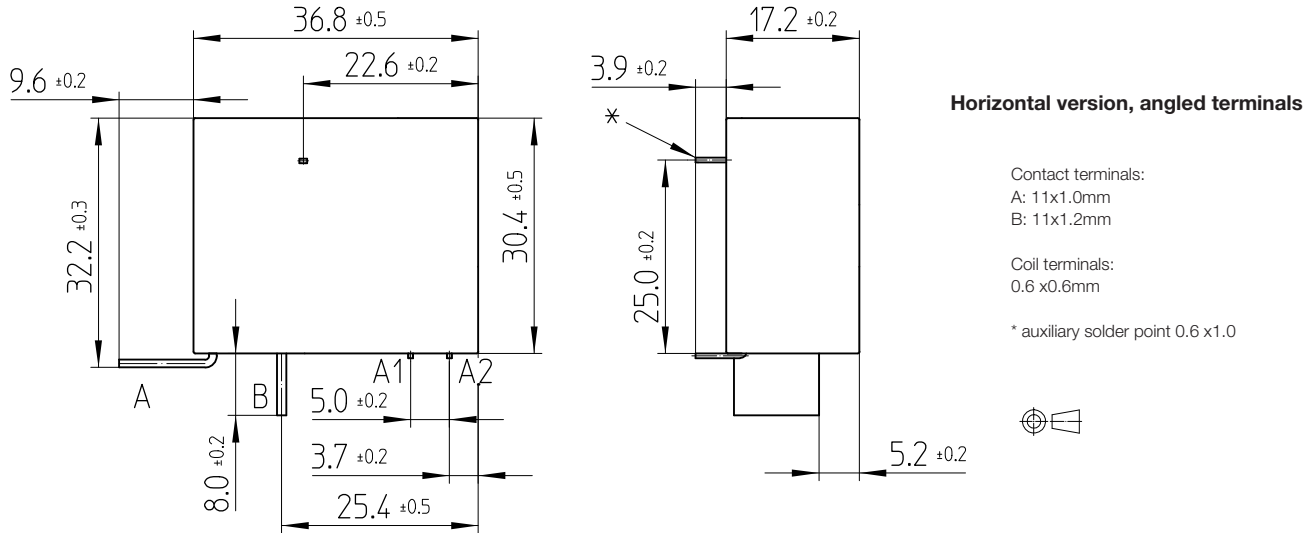

Product code structure

Typical product code

EW 80 -1A 3 -B012 D 0 0

Type	EW Power Latching Relay EW
Version	80 80A, vertical version 81 80A, horizontal version
Contact arrangement	1A 1 form A (NO) contact
Contact material	3 AgSnO ₂
Coil	Coil code: please refer to coil versions table
Category of environmental protection	D Standard version (dust protected)
Shunt option	0 Standard (no shunt) 1 with 175μΩ shunt 2 with 250μΩ shunt 3 with 300μΩ shunt
Contact terminal configuration	0 Angled terminals 1 Angled terminals with holes 2 Straight terminals 3 Straight terminals with holes

Product code	Version	Design	Coil	Contact terminals	Part Number
EW80-1A3-B012D02	80A, 1 form A contact, dust protected	vertical	12V bistable	straight, no holes	2071239-4
EW80-1A3-B024D02			24V bistable		2071239-5
EW80-1A3-B005D00			5V bistable	angled, no holes	2071224-1
EW80-1A3-B006D00			6V bistable		2071224-2
EW80-1A3-B009D00			9V bistable		2071224-3
EW80-1A3-B012D00			12V bistable		2071224-4
EW80-1A3-B024D00			24V bistable		2071224-5

Other types on request

This list represents the most common types and does not show all variants covered by this data sheet.

Mouser Electronics

Authorized Distributor

Click to View Pricing, Inventory, Delivery & Lifecycle Information:

TE Connectivity:

[EW80-1A3-B005D00](#) [EW80-1A3-B006D00](#) [EW80-1A3-B009D00](#) [EW80-1A3-B012D00](#) [EW80-1A3-B012D02](#) [EW80-1A3-B024D00](#) [EW80-1A3-B024D02](#) [EW80-1A3-B009D00,00000](#)