

Technical drawing of a circular component. The overall diameter is 21.7 ± 0.3 . The inner circular feature has a diameter of $\phi 19.5 \pm 0.3$. The central hole has a diameter of $\phi 13 \pm 0.2$. The distance from the center of the hole to the inner edge is 6.5 . The distance from the center of the hole to the outer edge is 1.5 . The distance from the center of the hole to the center of the circular feature is 3.2 . The distance from the center of the hole to the center of the circular feature is 1.5 .

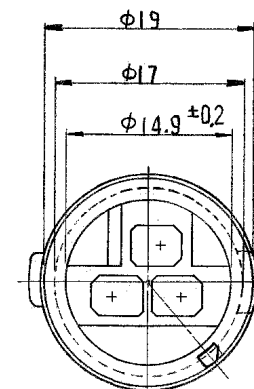

1. 嵌合相手ハウジング型番 172201
2. 使用端子型番 170279
3. 型番 172201 と嵌合時に干渉なく所定の機能を満足する。
- ④

A

 面から 22mm の所で測定。
5. 適用製品規格番号 108-5136.

NOTE:

1. THE MATING COUNTERPART PART NUMBER : 172201
2. APPLIED CONTACT : Φ 170279
3. TO BE MATE WITH PLUG HOUSING (Φ 172201) SMOOTHLY
4. TO BE MEASURED AT 22mm FROM $\boxed{-A-}$
5. APPLICABLE PRODUCT SPEC. NUMBER : 108-5136

C-172202

单位: 耗 尺寸在毫米, 不要按比例打印

Mouser Electronics

Authorized Distributor

Click to View Pricing, Inventory, Delivery & Lifecycle Information:

[TE Connectivity:](#)

[172202-1](#)