

PART NUMBER	REV	FIRST USED	TERMINATOR	FEED TYPE	DESCRIPTION
1426451-1	C	-	LEADMAKER	MECH POST FEED	CUTS CARRIER
1426451-2	C	-	BENCH	MECH PRE FEED	CUTS CARRIER
1426451-6	C	-	LEADMAKER	MECH POST FEED	CONTINUOUS CARRIER
7-1426451-1	C	-	LEADMAKER	MECH POST FEED	-1 AND SPARE PARTS
7-1426451-2	C	-	BENCH	MECH PRE FEED	-2 AND SPARE PARTS
7-1426451-6	C	-	LEADMAKER	MECH POST FEED	-6 AND SPARE PARTS
7-1426451-7	C	-	-	-	SPARE PARTS KIT

[illegible]

- 2. GREASE RAM, CAM, CAM FOLLOWER AND FEED ROD LIGHTLY.
 - 3. LUBRICATE DAILY PER THE APPLICATOR INSTRUCTION SHEET SUPPLIED WITH THE APPLICATOR.
 - 4. INSULATION RANGE OF TERMINAL 927879 IS 2.70—4.00 [.106—.157 IN].

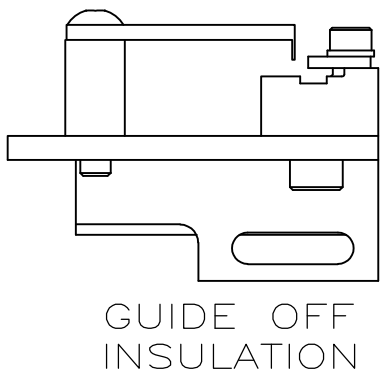
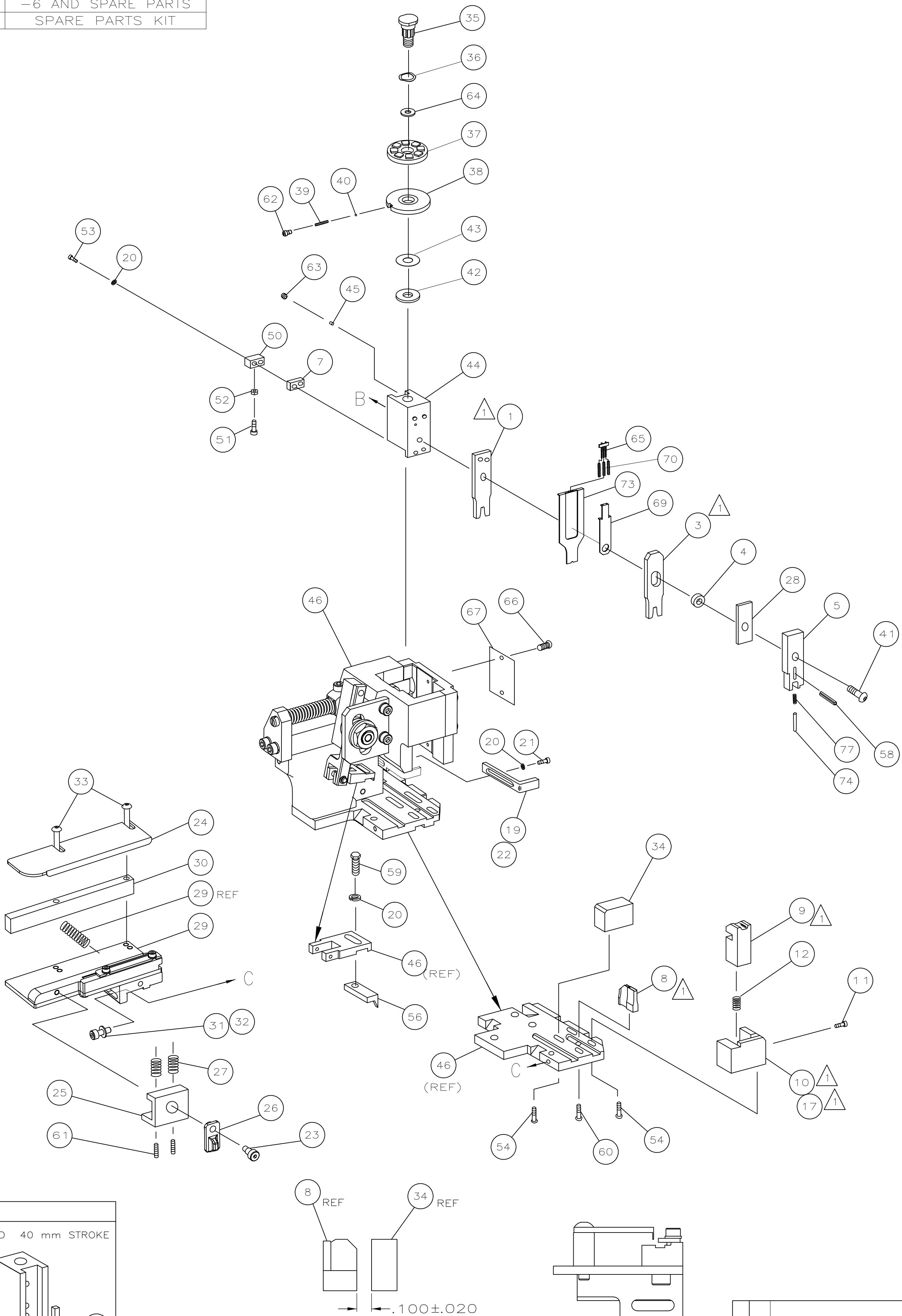
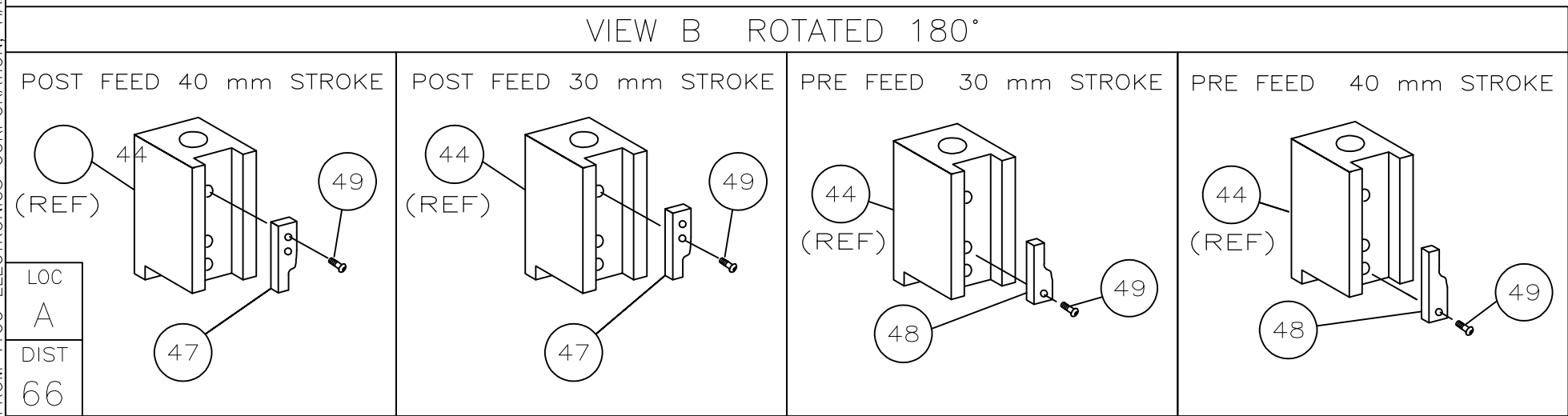

	-	1	1	1	1	1	1	1-22278-0	SPRING, COMPRESSION	77
	-	1	1	1	1	1	1	854769-1	HOLDER INSULATION	74
	-	1	1	1	1	1	1	1490525-3	DEPRESSOR, WIRE	73
	-	1	1	1	1	1	1	1426451	PRINT, APPLICATOR LOG SHEET	72
	-	1	1	1	1	1	1	1338705-1	DOCUMENTATION PACKAGE	71
	-	3	3	3	3	3	3	1-23147-4	SPRING, DEPRESSOR	70
	-	1	1	1	1	1	1	1490524-1	SPACER, DEPRESSOR	69
										68
	-	1	1	1	1	1	1	461264-1	PLATE, IDENTIFICATION	67
	-	2	2	2	2	2	2	21017-2	SCR,DRIVE(#2x.19)ID PLATE	66
	-	1	1	1	1	1	1	1424350-1	HOLDER, PIN, WIRED	65
	-	1	1	1	1	1	1	986950-1	WASHER, FLAT PRECISION	64
	-	1	1	1	1	1	1	3-18031-0	SCR,SKT SET(M6X6)RAM	63
	-	1	1	1	1	1	1	18023-9	SCR,SHC(M4X6)INS DISC	62
	-	2	2	2	2	2	2	2-18032-5	SCR,BHC(M5X20)DRAG	61
	-	1	1	1	1	1	1	18024-7	SCR,BHC(M4X10)ANVIL	60
	-	1	1	1	1	1	1	5-18022-2	SCR,HEX(M4X8)FEED FINGER	59
	-	1	1	1	1	1	1	21028-2	PIN,SLOTTED,SPRING	58
										57
	-	1	1	1	1	1	1	1338685-1	PAWL, FEED	56
										55
	-	4	4	4	4	4	4	18024-8	SCR,BHC(M4x12)SHEAR HOLDER	54
	-	2	2	2	2	2	2	9-18023-6	SCR,SHC(M4x14)TERM HLD DWN	53
	-	1	1	1	1	1	1	18030-1	NUT,HEX(M3)HOLD_DOWN	52
	-	1	1	1	1	1	1	811242-5	BUMPER, HOLDDOWN	51
	-	1	1	1	1	1	1	690753-2	SPACER, TONKER	50
	-	1	1	1	1	1	1	18024-3	SCR,BHC(M3X10)CAM	49
	-	-	1	-	-	1	-	1338675-1	CAM, PRE FEED 30 & 40 mm ST	48
	-	1	-	1	1	-	1	1338676-1	CAM, POST FEED 30 & 40 mm ST	47
	-	1	1	1	1	1	1	1320999-3	APPLICATOR BASIC SUBASSY	46
	-	1	1	1	1	1	1	690191-1	PLUG, NYLON	45
	-	1	1	1	1	1	1	1338660-1	RAM	44
	-	1	1	1	1	1	1	690125-1	WASHER, LAMINATED	43
	-	1	1	1	1	1	1	690124-1	WASHER, RAM	42
	-	1	1	1	1	1	1	2-18024-6	SCR,BHC(M8X25)RAM	41
	-	1	1	1	1	1	1	23241-1	BALL, STEEL	40
	-	1	1	1	1	1	1	2-22278-7	SPRING, COMPRESSION	39
	-	1	1	1	1	1	1	1320922-1	DISC, INSULATION	38
	-	1	1	1	1	1	1	354777-1	WIRE DISC, PLASTIC	37
	-	1	1	1	1	1	1	22480-5	WASHER, SPRING	36
	-	1	1	1	1	1	1	690212-1	POST, RAM	35
	-	1	1	1	1	1	1	1320934-1	SUPPORT, TERMINAL	34
	-	2	2	2	2	2	2	1-18024-0	SCR,BHC(M4X20)STRIP GUIDE	33
	-	1	1	1	1	1	1	18027-2	WASHER, FLAT(M4)	32
	-	1	1	1	1	1	1	1-18023-2	SCR,SKT CAP(M4X12)MOUNT BLOCK	31
	-	1	1	1	1	1	1	1320908-6	SPACER, STRIP GUIDE	30
	-	1	1	1	1	1	1	1633073-1	STRIP GUIDE PLATE ASSY	29
	-	1	1	1	1	1	1	455888-6	SPACER, FRONT SHEAR DEP	28
	-	2	2	2	2	2	2	1-22284-0	SPRING, DRAG	27
	-	1	1	1	1	1	1	356835-1	LEVER, DRAG RELEASE	26
	-	1	1	1	1	1	1	240792-1	DRAG, TERMINAL	25
	-	1	1	1	1	1	1	1320928-1	PLATE, STRIP GUIDE	24
	-	1	1	1	1	1	1	980371-4	SCR,SHC SHLD	23
	-	1	-	1	1	-	1	690472-2	STRIPPER	22
	-	1	1	1	1	1	1	1-18023-1	SCR,SHC(M4X10)STRIPPER	21
	-	4	4	4	4	4	4	18025-2	WASHER,LOCK(M4)STRIPPER	20
	-	-	1	-	-	1	-	690472-1	STRIPPER	19
										18
1	-	1	-	-	1	-	-	1338684-1	HOLDER, SHEAR, FRONT (NO-CUT)	17
										16
										15
										14
										13
	-	1	1	1	1	1	1	3-22280-3	SPRING, SHEAR	12
	-	1	1	1	1	1	1	356885-4	STOP, SHEAR	11
1	-	-	1	1	-	1	1	1320921-1	HOLDER, SHEAR, FRONT (CUT)	10
	-	1	1	1	1	1	1	454276-1	SHEAR, FLOAT (FRONT)	9
	1	2	2	2	1	1	1	3-1333207-6	ANVIL	8
	-	1	1	1	1	1	1	3-240641-3	SPACER, DEPRESSOR (REAR)	7
										6
	-	1	1	1	1	1	1	1-854772-4	DEPRESSOR, SHEAR (FRONT)	5
1	-	1	1	1	1	1	1	1-238011-0	SPACER, BLOCK CRIMPER	4
	1	2	2	2	1	1	1	8-683453-2	CRIMPER, INSULATION	3
										2
1	1	2	2	2	1	1	1	1-456408-3	CRIMPER, WIRE	1
	-77	-76	-72	-71	-6	-2	-1	PART NO	DESCRIPTION	ITEM NO
								PARTS LIST		
								DWN M.CLIFFORD	05AUG03	MATERIAL -
								CHK -		HEAT TREAT -
								APVD F.BACKHURST	05AUG03	Tyco Electronics
								NAME	Tyco Electronics Corporation Harrisburg, PA 17105-3608	
								SIDE FEED HD-I APPLICATOR		
	11-10	MY	GB	DIMENSIONS: INCHES		TOLERANCES UNLESS OTHERWISE SPECIFIED:		SCALE -	SIZE A1	DRAWING NO 1426451
	DATE	DWN	APVD	ANGLES±		0 PLC ± - 1 PLC ± - 2 PLC ± - 3 PLC ± - 4 PLC ± -		SHEET 1		OF 1
				SURFACE TEXTURE		√		REV C		

Mouser Electronics

Authorized Distributor

Click to View Pricing, Inventory, Delivery & Lifecycle Information:

[TE Connectivity:](#)

[1426451-6](#)