

PROD	LOC	DIST	P	F	REVISIONS				
4092	DF	SO			ZONE	LTR	DESCRIPTION	DATE	APPD
CODE						G	REDRAWN & ADDED 1-865765-1 & 1-865765-2 T.S. PER NPR'S 89-0342 & 89-0343	8-18-89	WS
				✓		H	ADD -9 PER 0600-1422-93 CT	11-93	SG
			✓	✓		J	REV PER 0600-6810-97 JB	03-98	DE

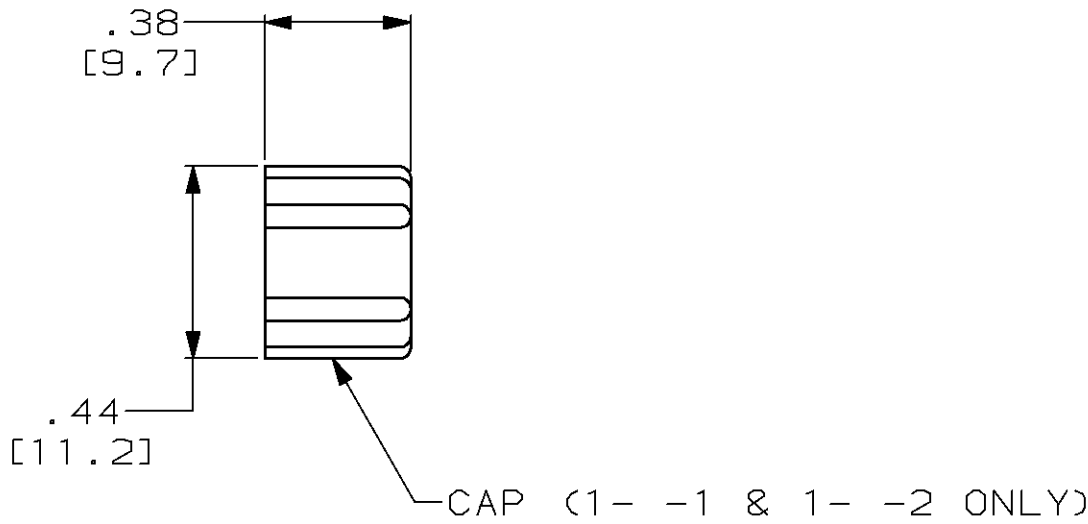
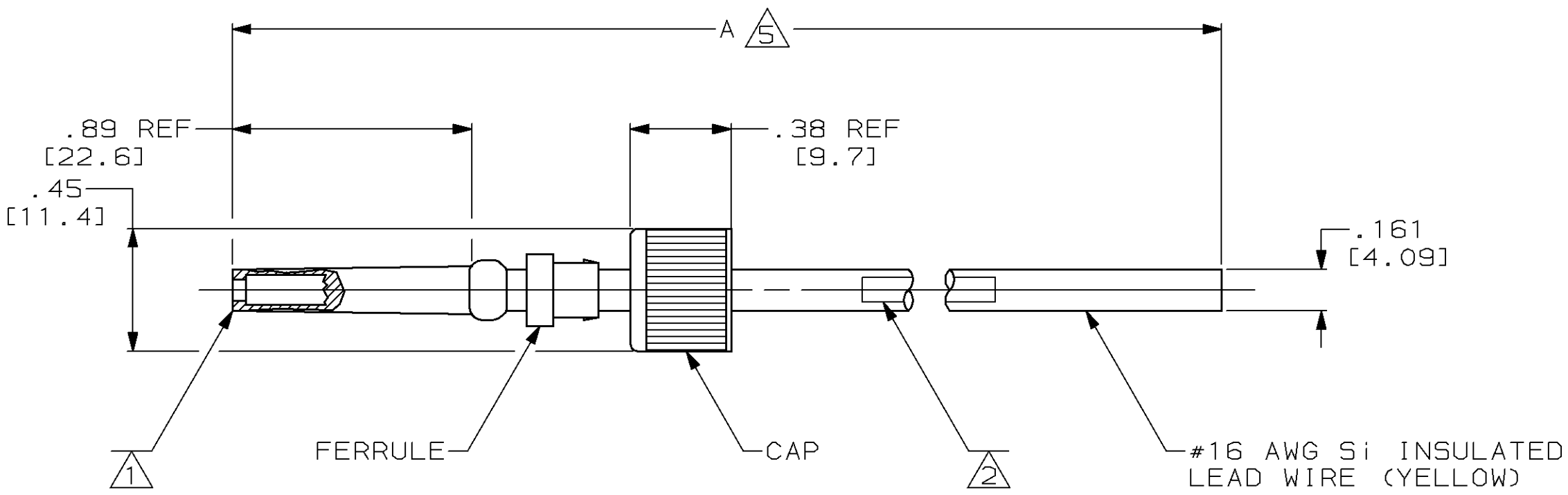

- 1 TO MATE WITH AMP LGH 1/2L RECEPTACLE WITH A .89 BARREL LENGTH.
- 2 MARK PER MIL-STD-130.
3. OPERATING CONDITIONS: 15KVDC TO 70,000 FEET AT -55°C TO +125°C.
4. DIMENSIONS IN BRACKETS ARE IN MILLIMETERS. METRIC EQUIVALENTS ARE BASED UPON 1.00 inch = 25.4 mm.
- 5 TOLERANCE OF LEAD LENGTH:
UP TO 24 INCHES ±.12
24 INCHES AND UP ±1%

	12.00 [304.8]	1-865765-2
	18.00 [457.2]	1-865765-1
NOT RELEASED	_____	1-865765-0
	36.00±.36 [914.4±9.1]	865765-9
NOT RELEASED	_____	865765-8
	24.00 [609.6]	865765-7
OBsolete	336.00±3.36 [8534.4±85.3]	865765-6
	72.00±.72 [182.8±18.3]	865765-5
	12.00 [304.8]	865765-4
OBsolete	11.00 [279.4]	865765-3
OBsolete	240.00±2.40 [6096.±61.0]	865765-2
	48.00±.46 [1219.2±12.2]	865765-1

DO NOT SCALE PRINT. UNLESS SPECIFIED DIMENSIONS IN INCHES [mm] TOLERANCES ON : 2 PLC DEC ± .12 [3.0] 3 PLC DEC ± .005 [0.13] ANGLES ± _____		DR 8-18-89 T. SHUEY	AMP AMP INCORPORATED Harrisburg, Pa. 17105	
MATERIAL _____		CHK 9-5-89 W.SHATTO		
FINISH _____		APPD 9-5-89 W.SHATTO	NAME	
		APPD 9-5-89 T.SHUEY	LEAD ASSEMBLY, LGH 1/2L POSITIVE STOP	
		PRODUCT SPEC _____		
		APPLICATION SPEC _____	SIZE C	CAGE CODE 00779
		WEIGHT _____	SCALE 2:1	DRAWING NO 865765
				SHEET 1 OF 1

Mouser Electronics

Authorized Distributor

Click to View Pricing, Inventory, Delivery & Lifecycle Information:

[TE Connectivity:](#)

[865765-4](#)