

LOC		DIST		REVISIONS				
P	LTR	DESCRIPTION			DATE	DWN	APVD	
	C	REVISED PER ECO-10-012730			20SEP10	HMR	MG	

D

C

B

A

D

C

B

A

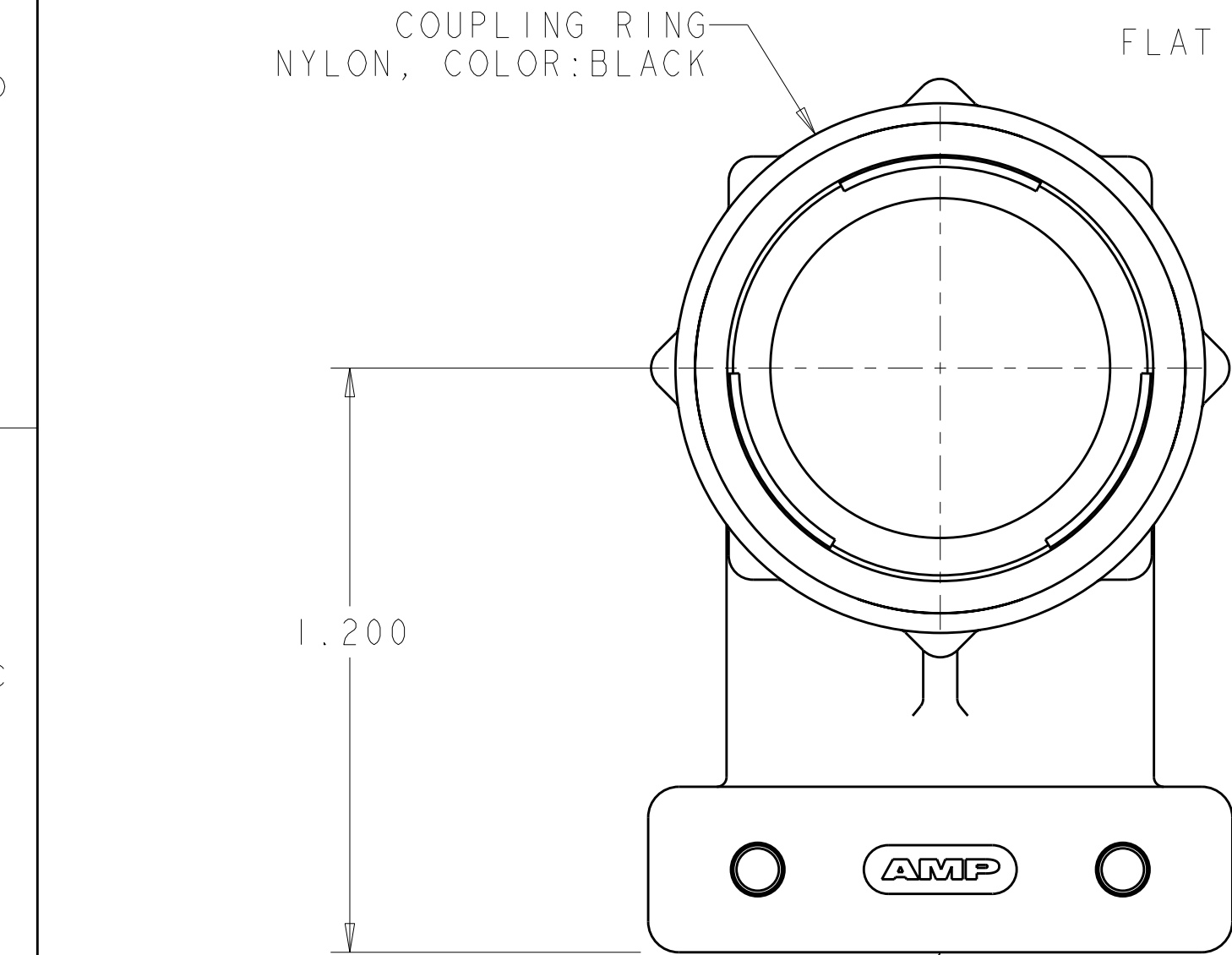

CABLE CLAMP BODY  
NYLON, COLOR:BLACK

FLAT RING

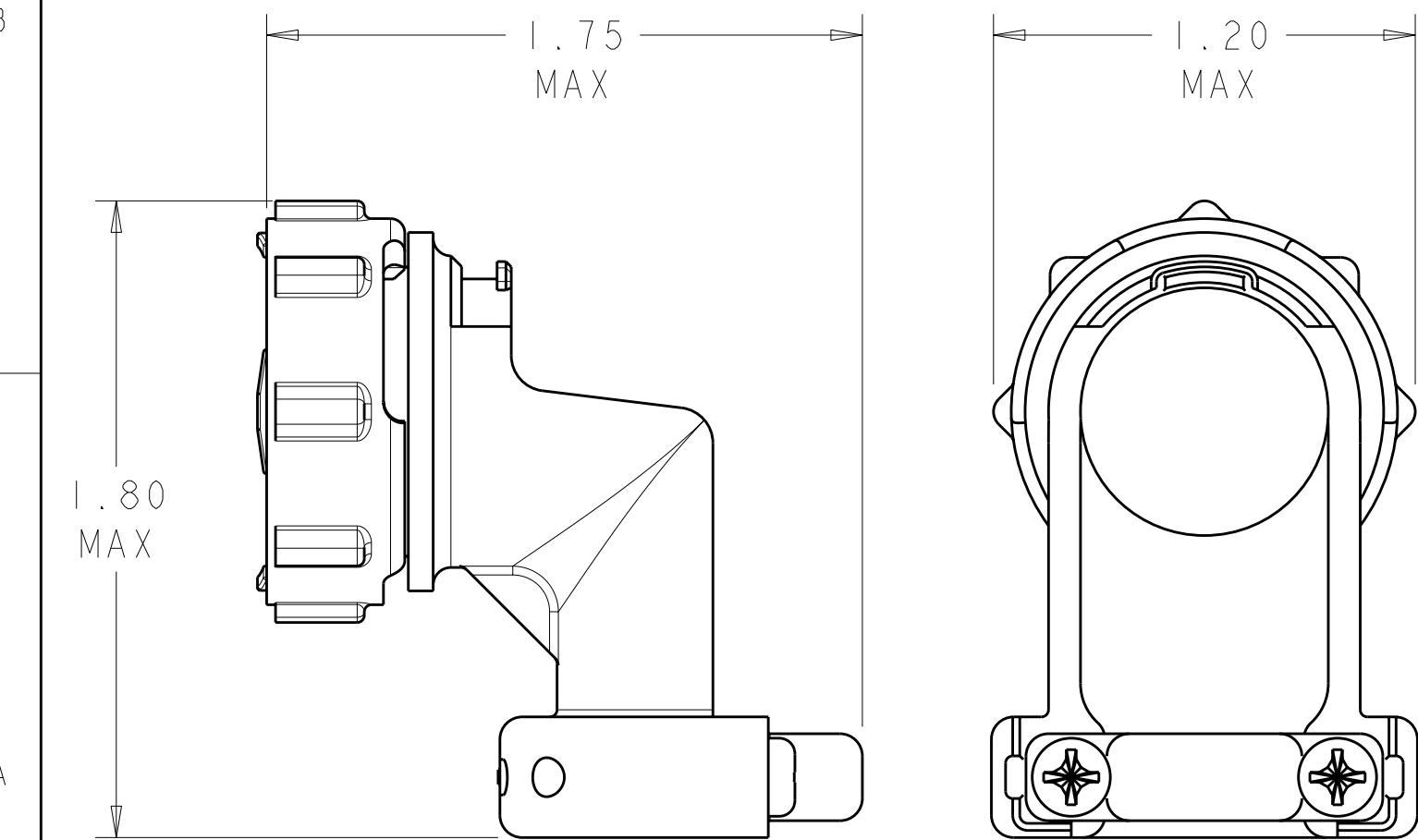

ASSEMBLED VIEW  
SCALE 2:1

- 1 SELF TAPPING SCREWS AND CABLE CLAMP INSERTS  
PACKAGED UNASSEMBLED.
- 2 CLAMPING AREA ADJUSTABLE TO .453 O.D. MAX CABLE.  
CABLE CLAMP INSERTS CAN BE ADJUSTED BY INVERTING  
OR CHANGING CABLE CLAMP INSERT.

1 5-20 SELF TAPPING SCREW  
MATERIAL: STEEL  
QTY:2  
LENGTH: .50<sup>+</sup>.00  
          .05<sup>-</sup>

1 2 CABLE CLAMP INSERT  
NYLON, COLOR:BLACK  
QTY:2

796381-2  
796381-1  
PART  
NUMBER

Tyco Electronics		AMP Incorporated Harrisburg, PA 17105-3608	
NAME		CABLE CLAMP KIT, UNASSEMBLED, RIGHT ANGLE, SIZE 17, CPC	
SIZE	CAGE CODE	DRAWING NO	RESTRICTED TO
A2	00779	C-796381	-
CUSTOMER DRAWING		SCALE 3:1	SHEET 1 OF 1 REV C

THIS DRAWING IS A CONTROLLED DOCUMENT FOR TYCO ELECTRONICS CORPORATION IT IS SUBJECT TO CHANGE AND THE CONTROLLING ENGINEERING ORGANIZATION SHOULD BE CONTACTED FOR THE LATEST REVISION.		DWN S.WELDON	11FEB2000
		CHK M.CHACKO	11FEB2000
		APVD M.CHACKO	11FEB2000
DIMENSIONS: INCHES		PRODUCT SPEC	
		APPLICATION SPEC	
MATERIAL		WEIGHT	
		CUSTOMER DRAWING	

# Mouser Electronics

Authorized Distributor

Click to View Pricing, Inventory, Delivery & Lifecycle Information:

[TE Connectivity:](#)

[796381-2](#)