

8

7

6

5

4

3

2

1

THIS DRAWING IS UNPUBLISHED.

RELEASED FOR PUBLICATION

ALL RIGHTS RESERVED.

Materials

No.	Component name	Base material	Finish
1	Housing	High Temp., UL 94V-0, green	
2	End terminal	silver clad copper alloy	5 microinches min. gold
3	Center terminal	copper alloy	5 microinches min. gold
4	Rocker contact	silver clad copper alloy	5 microinches min. gold
5	Actuator	Phenol resin, UL94 HB, black	
6	Plunger	stainless steel	
7	Spring	music wire	
8	Toggle	brass	chrome or Nickel
9	Retainer	Polyamide, UL94 HB, black	
10	Frame	cold rolled steel	zinc or Nickel
11	Bushing	brass	100 microinches min. nickel over 10 microinches min. copper
12	Mounting nut (1)	brass	200 microinches min. bright nickel
14	Internal tooth lockwasher	steel	zinc or Nickel
15	O-Ring, toggle seal		
16	O-Ring, panel seal		

Diagram

Specifications-see note 3

Current rating UL & CSA	6A @ 125 VAC (resistive)			
	3A @ 250 VAC (resistive)			
	4A @ 28 VDC (resistive)			
Termination resistance	20 milliohms max @ 2-4 VDC, 1A			
Insulation resistance	1,000 megohms min.			
Withstanding voltage	1,000 VAC			
Travel	24 +/-6 degrees			
Actuation force	.05 to 1.5 kgf			
Operating temperature	-20C to +85C			
Storage temperature	-40C to +85C			
Contact timing	break before make			
Terminal seal	epoxy or Insert molded			
Durability	Parameter	2 Position	3 Position	Momentary
	mechanical (no load)	150,000	100,000	80,000
	250 VAC (3A resistive)	80,000	60,000	60,000
	125 VAC (6A resistive)	80,000	60,000	60,000
	28 VDC (4A resistive)	60,000	50,000	40,000

RECOMMENDED PANEL LAYOUT

TO PREVENT ROTATION

PC BOARD LAYOUT

PC TERMINAL ONLY

NOTES:

1. TERMINAL NUMBERS ARE FOR REFERENCE ONLY AND DO NOT APPEAR ON THE SWITCHES.

2. EACH SWITCH SUPPLIED WITH THE FOLLOWING MOUNTING HARDWARE:

(1) 1/4-40 UNS-2B HEX NUTS

(1) INTERNAL TOOTH LOCKWASHER

(1) LOCATING RING

5. WIRE LUG CONTACTS WILL ACCEPT 2 #20 AWG SOLID OR STRANDED WIRES.

6. CUSTOMER INSTALLED EXTERNAL JUMPER BETWEEN TERMINALS 2 AND 4 REQUIRED FOR 1 POLE 3 THROW FUNCTION.

7

OBsolete

8. LASER MARKING USED FOR PARTS.

Part Number	Alco Model	Poles	Throws	Function	Terminal				Comments
<div>7</div> 8-1437558-1	MTE406P	4	2	ON OFF ON	Wire lug	2-3, 5-6, 8-9, 11-12	Off	2-1, 5-4, 8-7, 11-10	
<div>7</div> 8-1437558-0	MTE406N	4	2	ON ON	Wire lug	2-3, 5-6, 8-9, 11-12	---	2-1, 5-4, 8-7, 11-10	
<div>7</div> 7-1437558-9	MTE306E	3	2	ON OFF ON	Wire lug	2-3, 5-6, 8-9	Off	2-1, 5-4, 8-7	
<div>7</div> 7-1437558-8	MTE306D	3	2	ON ON	Wire lug	2-3, 5-6, 8-9	---	2-1, 5-4, 8-7	
<div>7</div> 7-1437558-7	MTE206T	2	2	ON OFF(ON)	Wire lug	2-3, 5-6	OFF	2-1, 5-4	
<div>7</div> 7-1437558-6	MTE206S	2	2	(ON) OFF (ON)	Wire lug	2-3, 5-6	OFF	2-1, 5-4	
<div>7</div> 7-1437558-5	MTE206R	2	2	ON (ON)	Wire lug	2-3, 5-6	---	2-1, 5-4	
<div>7</div> 7-1437558-4	MTE206PA	1	3	ON ON ON	Wire lug	5-6	5-3	5-1	note 6
7-1437558-3	MTE206P	2	2	ON OFF ON	Wire lug	2-3, 5-6	OFF	2-1, 5-4	
7-1437558-2	MTE206N	2	2	ON ON	Wire lug	2-3, 5-6	---	2-1, 5-4	
<div>7</div> 7-1437558-1	MTE106G	1	2	(ON) OFF (ON)	Wire lug	2-3	OFF	2-1	
7-1437558-0	MTE106F	1	2	ON (ON)	Wire lug	2-3	---	2-1	
6-1437558-9	MTE106E	1	2	ON OFF ON	Wire lug	2-3	Off	2-1	
6-1437558-8	MTE106D	1	2	ON ON	Wire lug	2-3	---	2-1	

THIS DRAWING IS A CONTROLLED DOCUMENT.

DIMENSIONS: INCHES

MATERIAL -

TOLERANCES UNLESS OTHERWISE SPECIFIED:

0 PLC +/-

1 PLC +/-

2 PLC +/-

3 PLC +/- .005

4 PLC +/-

ANGLES +/-

FINISH -

DWN M. BINNER

CHK M. ZITTO

APVD M. ZITTO

PRODUCT SPEC

APPLICATION SPEC

WEIGHT 0

CUSTOMER DRAWING

OBAPR04

OBAPR04

OBAPR04

NAME

SIZE A1

CAGE CODE

DRAWING NO 00779

RESTRICTED TO

TE Connectivity Ltd.

TOGGLE SWITCH, MTE SERIES VERTICAL MOUNT

6-1437558-8

SCALE 2:1

SHEET 1 OF 3

REV C6

4805 (1/15)

REVISIONS					
P	LTR	DESCRIPTION	DATE	DWN	APVD
—	—	SEE SHEET 1	—	—	—

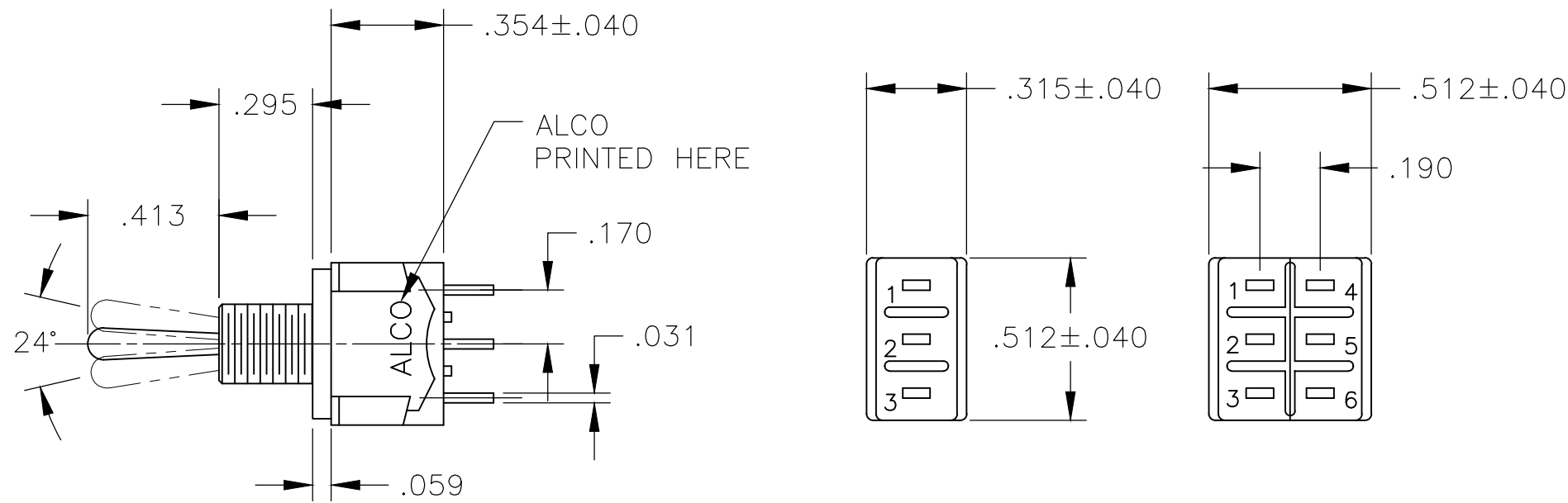

MTE-106

MTE-206

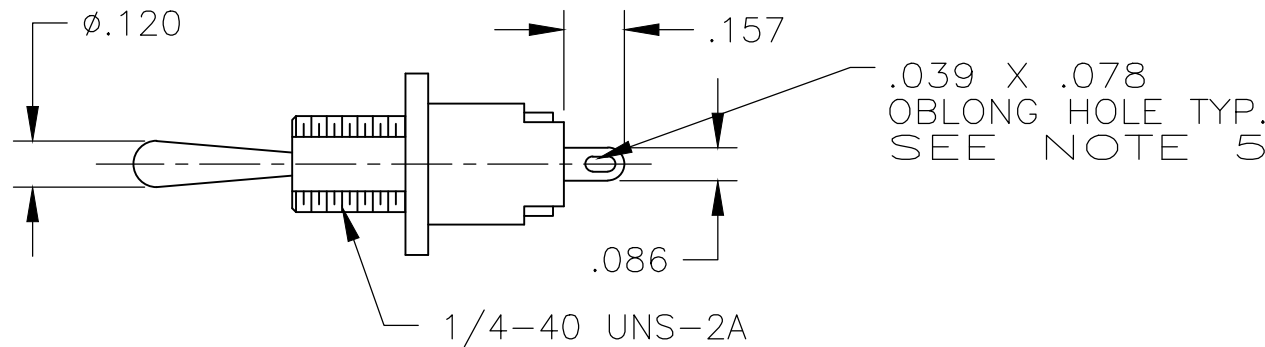
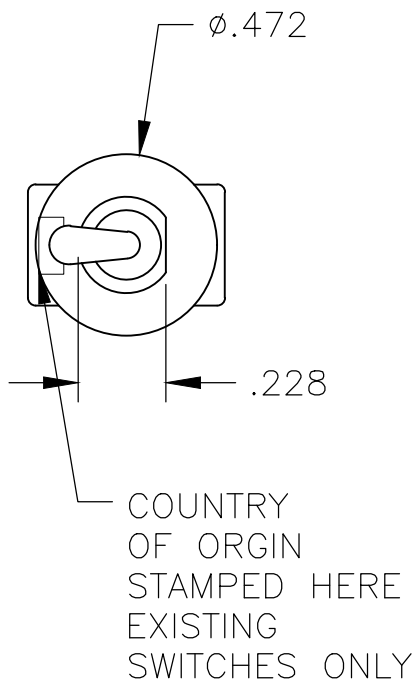

WIRE LUG TERMINAL

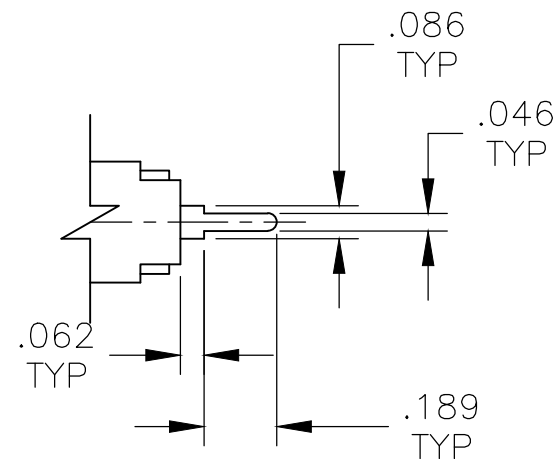
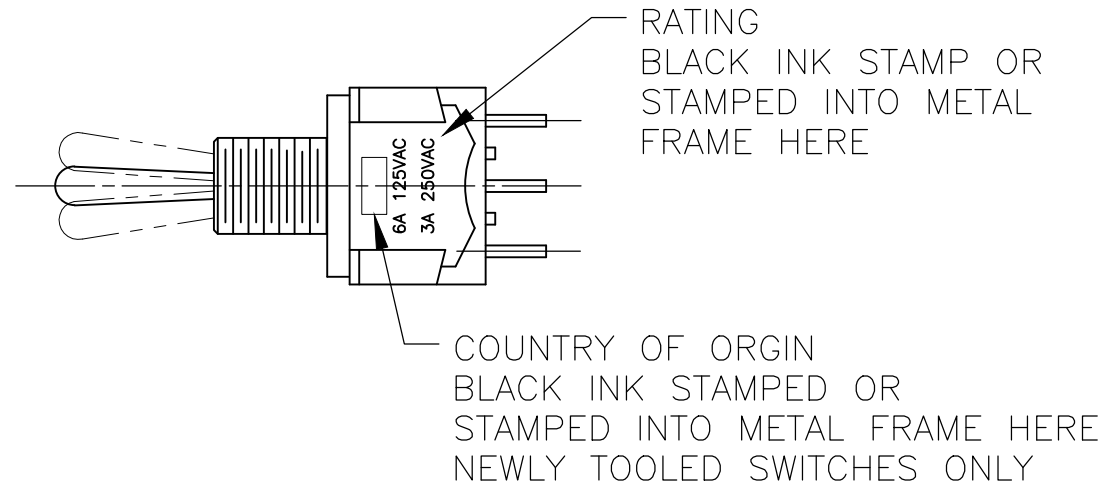

PC TERMINAL

THIS DRAWING IS A CONTROLLED DOCUMENT.		DWN M. BINNER 08APR04	TE Connectivity Ltd.	
		CHK M. ZITTO 08APR04		
DIMENSIONS: INCHES		APVD M. ZITTO 08APR04	NAME TOGGLE SWITCH, MTE SERIES VERTICAL MOUNT	
		PRODUCT SPEC		
		APPLICATION SPEC		
		WEIGHT		
MATERIAL —		FINISH —		
		CUSTOMER DRAWING		
		SCALE 2:1		
		SHEET 2		
		OF 3		
		REV C6		

REVISIONS					
P	LTR	DESCRIPTION	DATE	DWN	APVD
—	—	SEE SHEET 1	—	—	—

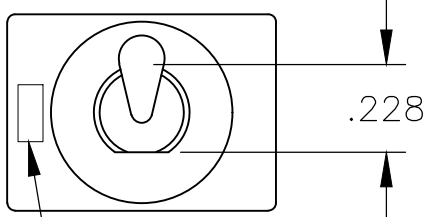

COUNTRY OF ORGIN
STAMPED HERE
EXISTING
SWITCHES ONLY

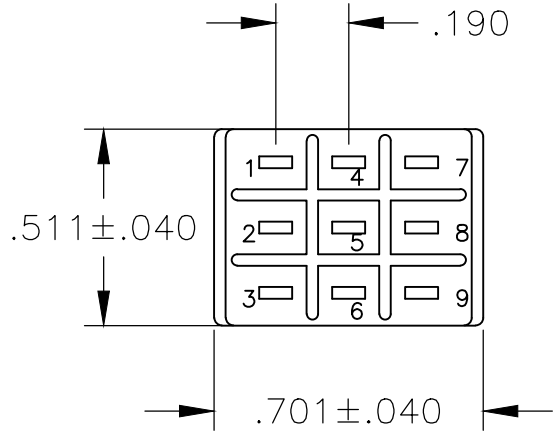
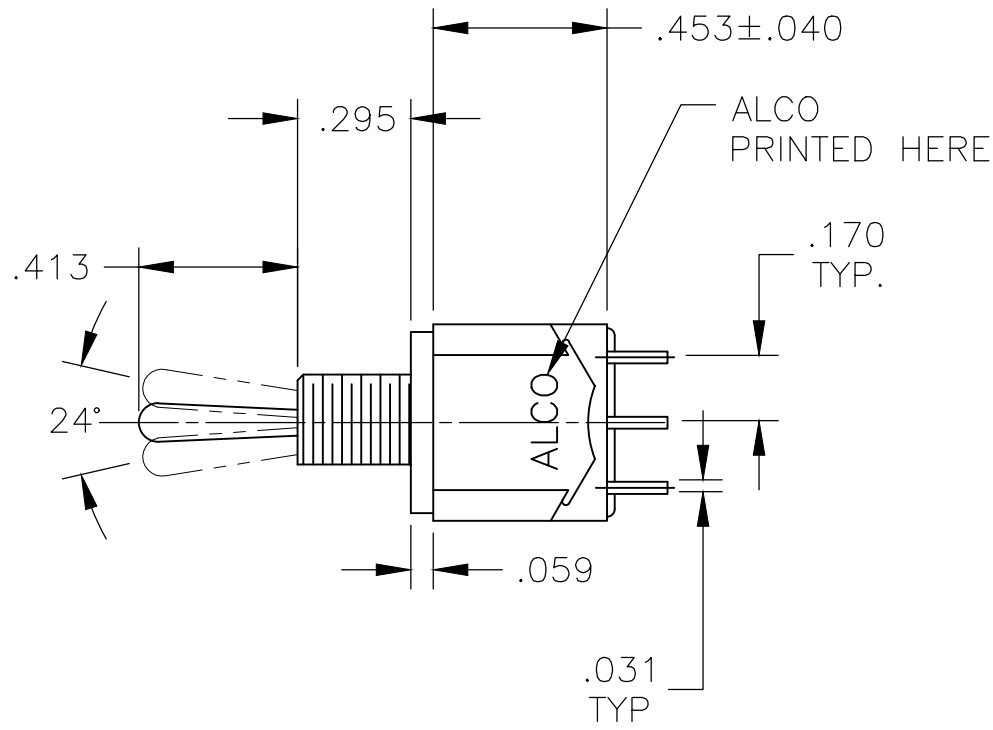

MTE-306

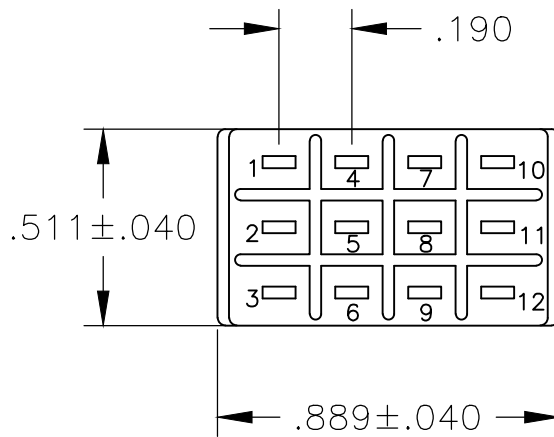

MTE-406

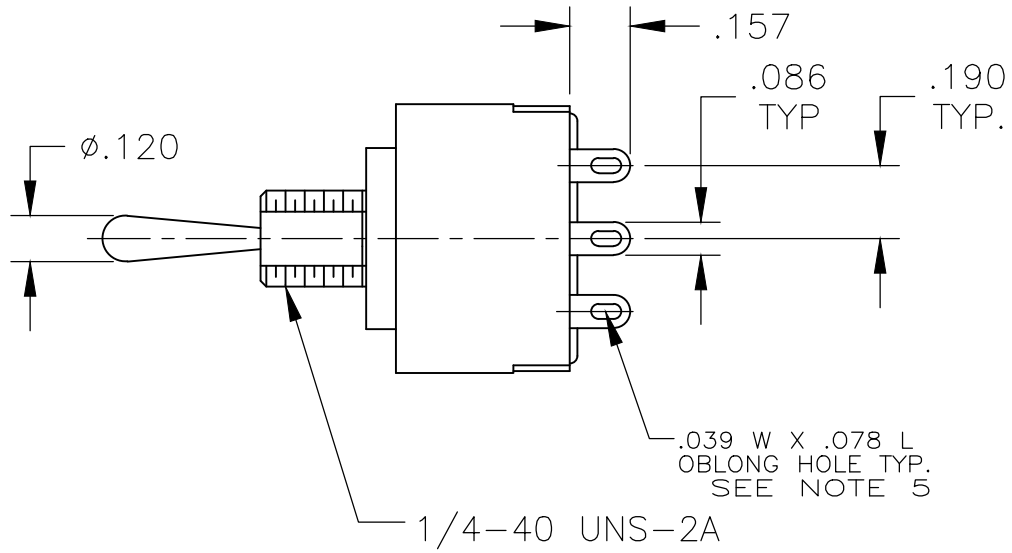

WIRE LUG TERMINAL

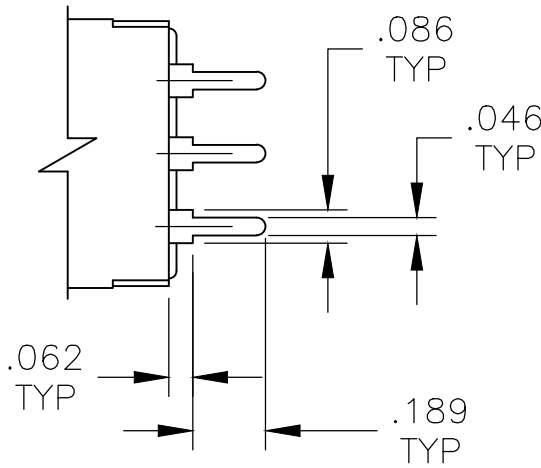

PC TERMINAL

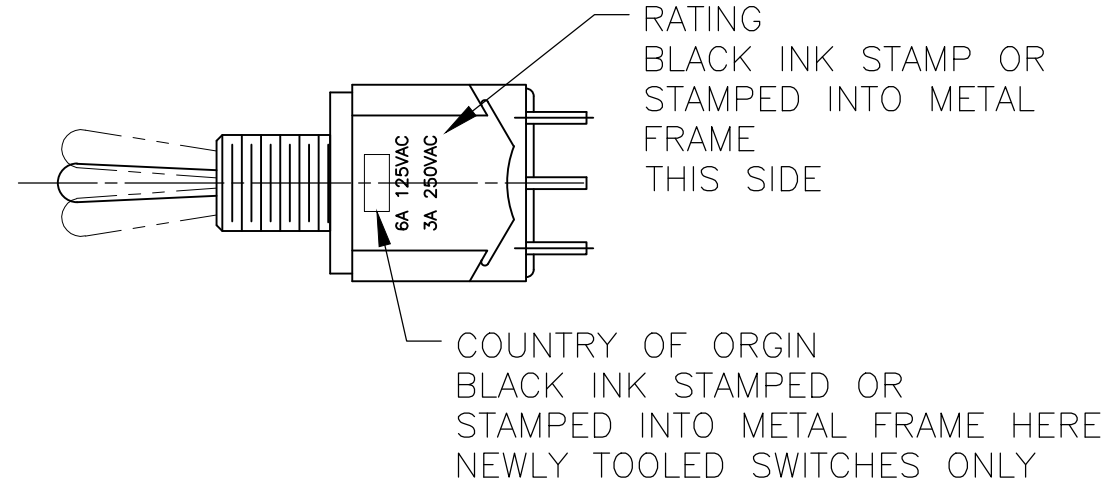

THIS DRAWING IS A CONTROLLED DOCUMENT.		DWN M. BINNER 08APR04	TE Connectivity Ltd.	
		CHK M. ZITTO 08APR04		
DIMENSIONS: INCHES	TOLERANCES UNLESS OTHERWISE SPECIFIED:	APVD M. ZITTO 08APR04	NAME TOGGLE SWITCH, MTE SERIES VERTICAL MOUNT	
	0. PLC ± .005	PRODUCT SPEC	SIZE A1	
	1. PLC ± .005	APPLICATION SPEC	CAGE CODE 6-1437558-8	
MATERIAL —	FINISH —	WEIGHT —	RESTRICTED TO —	
CUSTOMER DRAWING		SCALE 2:1	SHEET 3	OF 3

Mouser Electronics

Authorized Distributor

Click to View Pricing, Inventory, Delivery & Lifecycle Information:

[TE Connectivity:](#)

[MTE306D](#)