

C.A.D. FILE CODE  
C344008

DO NOT SCALE

DIMENSIONS IN MM.

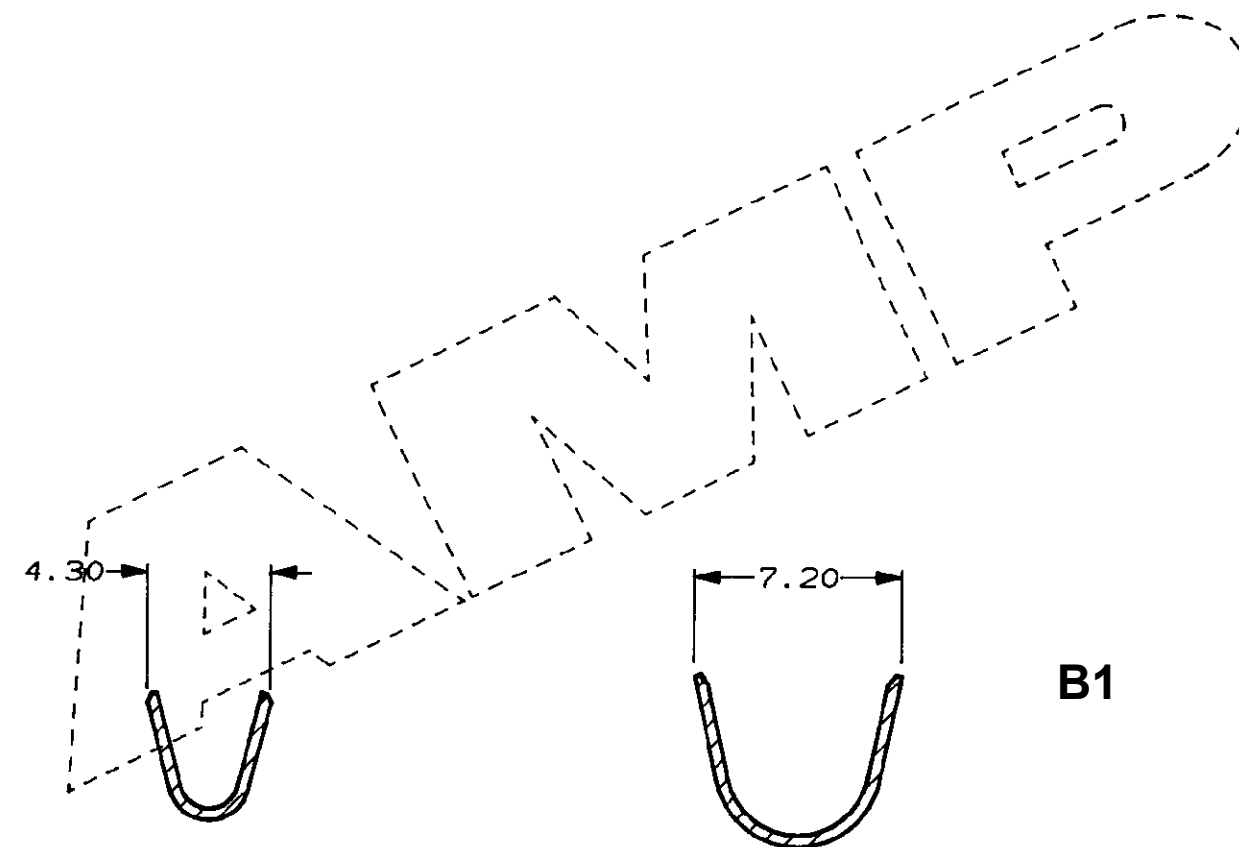
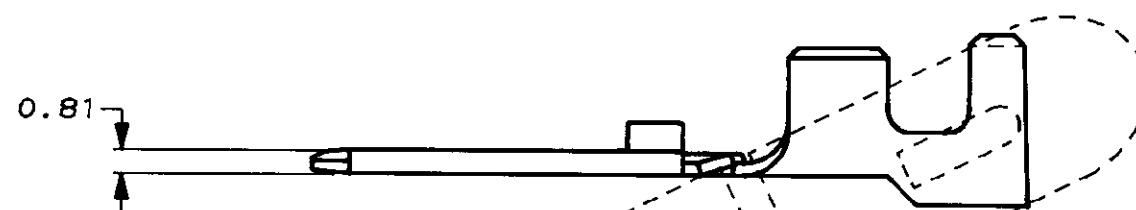
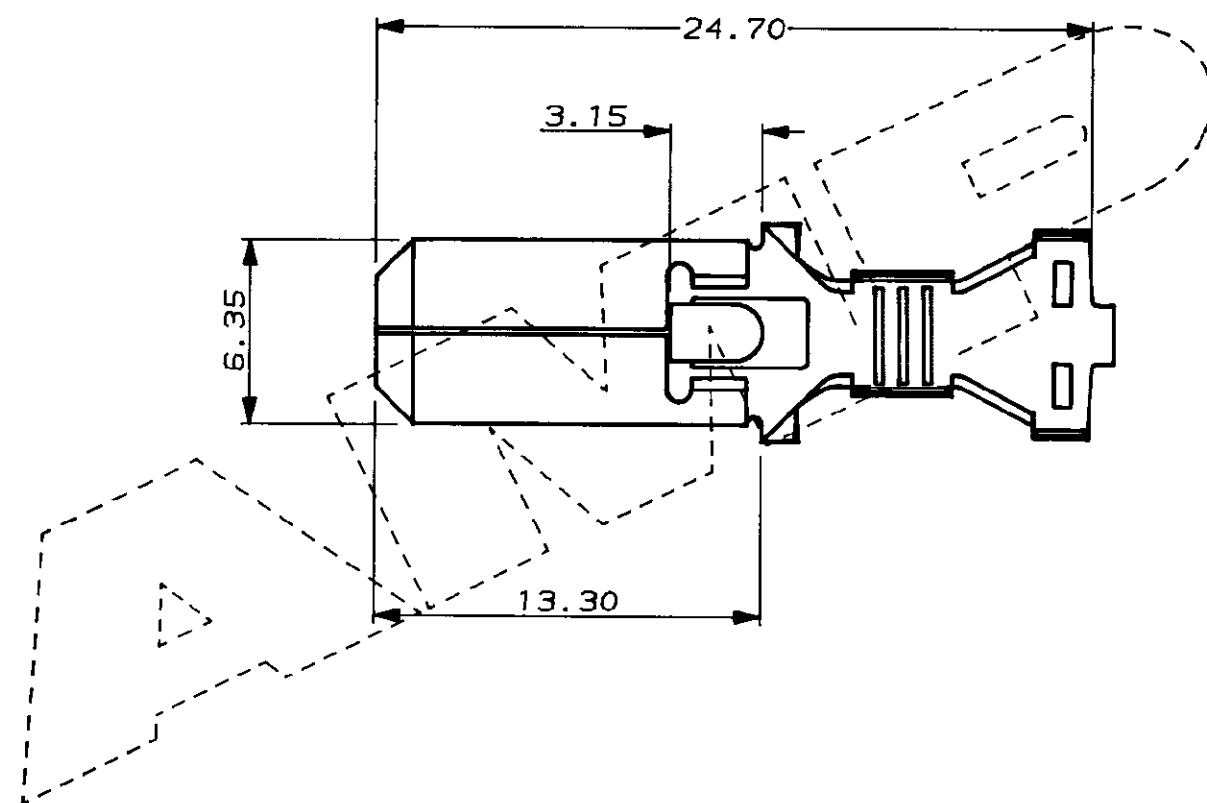

WIRE RANGE 2.00 TO 3.00 MM<sup>2</sup>

INS. RANGE 4.10 TO 5.50 MM DIA. INC. SEAL  
(ONLY THIN WALLED CABLE 2.20 TO 3.40 MM DIA. IS SUITABLE)

TIN PLATED

BRASS

344008-1

FINISH

MATERIAL

PART NUMBER

CUSTOMER DWG  
FOR REFERENCE ONLY

©COPYRIGHT 1987 BY AMP OF GREAT BRITAIN LTD.  
ALL INTERNATIONAL RIGHTS RESERVED. ALL PRODUCTS  
MAY BE COVERED BY BRITISH AND FOREIGN PATENTS AND/OR PATENTS PENDING.

RELEASED FOR PUBLICATION  
23/06/87

-	-	-	-
-	-	-	-
-	-	-	-
B1	ECR-20-001446	SCK	30JAN2020

TOLERANCES  
UNLESS OTHERWISE  
STATED:  
DEC  $\pm$  0.5  
ANGLES  $\pm$  1°

DR. R. RUNAGALL 23/06/87

CH. R. J. S. APP. B. J.

**TE** TE Connectivity

B	EBA0-0001-05	RS/MG	20.1.05
A	UPDATED	CS241	18.5.88
O	REL. FOR PROD.	C4887	8.3.88
REV	APPROVED	ECN	DATE

NAME .250 SERIES TAB HIGH CURRENT  
ECONOSEAL 3 (SEALED APPLICATIONS)

SCALE	LOC	SIZE	DWG. No.	REV	SHEET
4/1	E	A3	C344008	B1	1/1

# Mouser Electronics

Authorized Distributor

Click to View Pricing, Inventory, Delivery & Lifecycle Information:

[TE Connectivity:](#)

[344008-1 \(Loose Piece\)](#)