

| REVISIONS | | | | | |
|-----------|-----|---------------------------|-----------|-----|------|
| P | LTR | DESCRIPTION | DATE | DWN | APVD |
| B | | REVISED PER ECO-15-007763 | 24AUG2015 | DLD | WTW |
| C | | REVISED PER ECO-16-007495 | 17MAY2016 | DLD | WTW |
| | | | | | |
| | | | | | |

- 1 MATERIAL: COPPER ALLOY
- 2 FINISH: PRE-PLATED WITH 1.00 μ m MIN SPECIAL TIN-SILVER PLATE (APPLIES TO CONTACT ALL OVER)
- 3 SYMBOL "T" INDICATES SPECIAL TIN-SILVER PLATE. SYMBOL "S" INDICATES SILVER PLATE.
- 4 MARK CRIMP CODE "B"
- 5. DIE FEED IS 8.00mm
- 6 OPTIMOL (UNDILUTED) LUBRICATION IN THIS AREA
- 7 FINISH: PRE-PLATED SILVER, 3 - 5 μ m SILVER PLATE (CONTACT AREA ONLY), SILVER FLASH REMAINDER OF PART.
- 8. FOR SILVER PLATING ON P/N 1924879-2, TARNISH IS ACCEPTABLE. ELECTRICAL PERFORMANCE IS NOT AFFECTED BY TARNISH ON ANY OF THE SILVER PLATED SURFACES OF THE TERMINAL.

VIEW SHOWING ACCESS AREA FOR POGO PIN

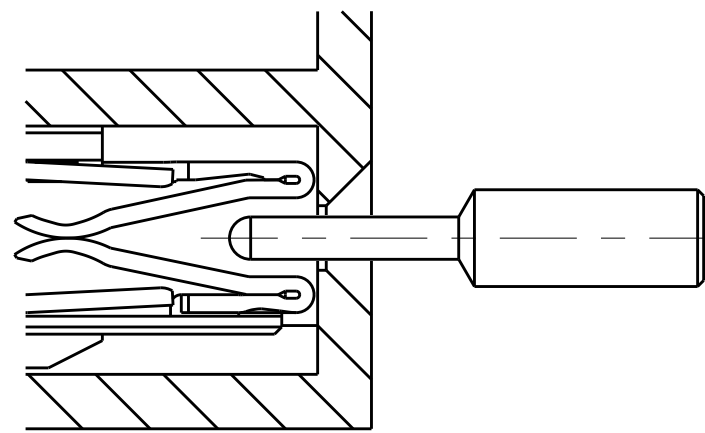

Dimensions of pogo pin:

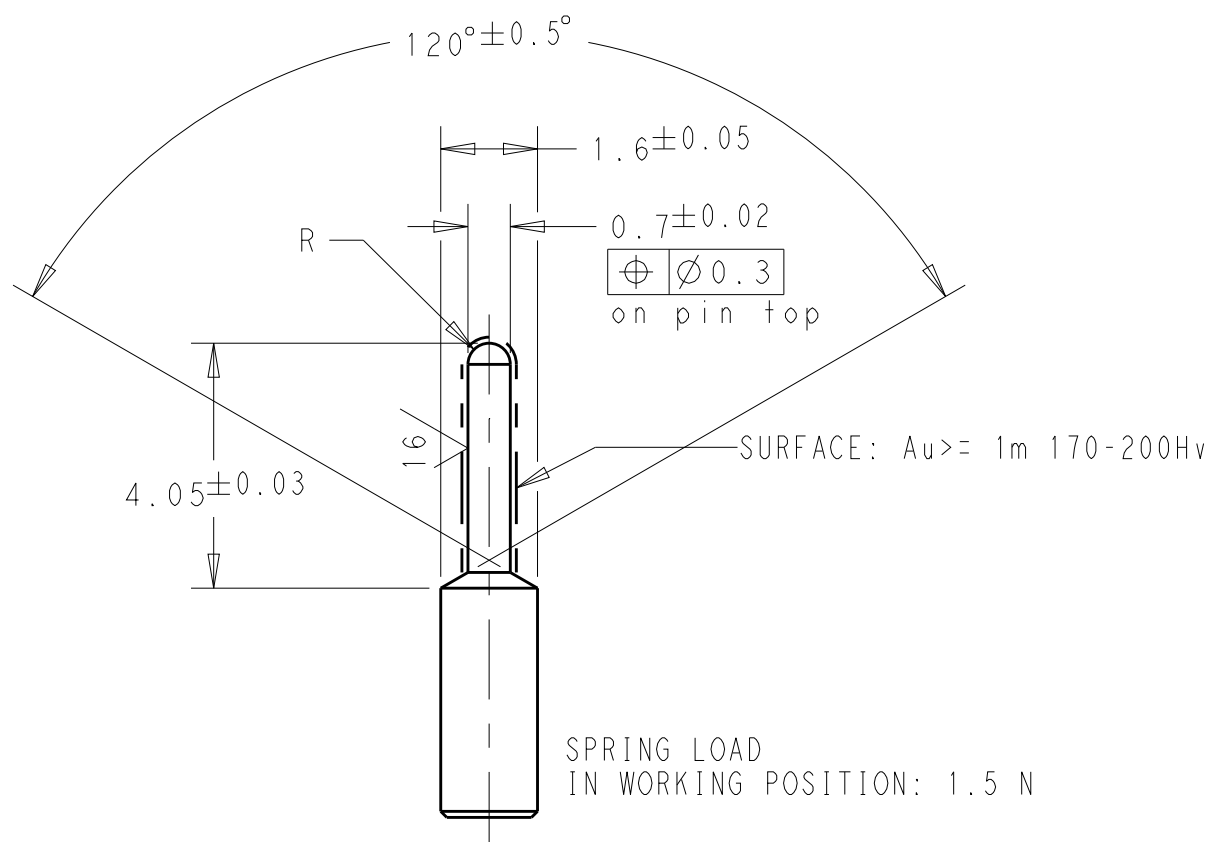

For reference only

| | | | | | |
|--|--|-----------------------------|---|-----------|------------|
| THIS DRAWING IS A CONTROLLED DOCUMENT. | | DWN F. KINSEY 27APR2009 | <div>TE Connectivity</div> <div>GET FEMALE TERMINAL, 1.20mm, THIN 18/20 AWG</div> | | |
| DIMENSIONS: mm | | CHK F. KINSEY 27APR2009 | | | |
| | | APVD W. WELLINSKY 27APR2009 | | | |
| | | PRODUCT SPEC | | | |
| | TOLERANCES UNLESS OTHERWISE SPECIFIED: | APPLICATION SPEC | SIZE | CAGE CODE | DRAWING NO |
| | | 114-13236 | A1 | 00779 | C=1924879 |
| MATERIAL | FINISH | WEIGHT | RESTRICTED TO | | |
| - | - | 0.17g | - | | |
| CUSTOMER DRAWING | | SCALE 10:1 | SHEET 1 | OF 1 | REV C |

Mouser Electronics

Authorized Distributor

Click to View Pricing, Inventory, Delivery & Lifecycle Information:

[TE Connectivity:](#)

[1924879-1](#)