

8

7

6

5

4

3

2

1

THIS DRAWING IS UNPUBLISHED.

RELEASED FOR PUBLICATION

ALL RIGHTS RESERVED.

REVISIONS

P	LTR	DESCRIPTION	DATE	OWN	APVD
B1		REVISED PER ECO-11-004587	11MAR11	RK	HMR
B2		REVISED PER ECO-16-018096	25MAY2017	RK	PO

5

T & R

0.105 [2.67]

0.200 [5.08]

0.260 [6.60]

0.400 [10.16]

SILVER

SMT

TOP

DPDT

ASF7126004

8-1825011-1

T & R

0.230 [5.82]

0.800 [20.32]

0.260 [6.60]

1.000 [25.40]

SILVER

SMT

SIDE

6PDT

ASF62RSTR04

8-1825011-0

TUBE

0.230 [5.82]

0.800 [20.32]

0.260 [6.60]

1.000 [25.40]

SILVER

SMT

SIDE

6PDT

ASF62RS04

7-1825011-9

T & R

0.230 [5.82]

0.800 [20.32]

0.260 [6.60]

1.000 [25.40]

GOLD

SMT

SIDE

6PDT

ASF62RGSTR04

7-1825011-8

TUBE

0.230 [5.82]

0.800 [20.32]

0.260 [6.60]

1.000 [25.40]

GOLD

SMT

SIDE

6PDT

ASF62RGS04

7-1825011-7

T & R

0.230 [5.82]

0.800 [20.32]

0.260 [6.60]

1.000 [25.40]

SILVER

SMT

SIDE

6PDT

ASF62RLTR04

7-1825011-6

TUBE

0.230 [5.82]

0.800 [20.32]

0.260 [6.60]

1.000 [25.40]

SILVER

SMT

SIDE

6PDT

ASF62RL04

7-1825011-5

T & R

0.230 [5.82]

0.800 [20.32]

0.260 [6.60]

1.000 [25.40]

GOLD

SMT

SIDE

6PDT

ASF62RGLTR04

7-1825011-4

TUBE

0.230 [5.82]

0.800 [20.32]

0.260 [6.60]

1.000 [25.40]

GOLD

SMT

SIDE

6PDT

ASF62RGL04

7-1825011-3

T & R

0.230 [5.82]

0.800 [20.32]

0.260 [6.60]

1.000 [25.40]

SILVER

SMT

TOP

6PDT

ASF62STR04

7-1825011-2

TUBE

0.230 [5.82]

0.800 [20.32]

0.260 [6.60]

1.000 [25.40]

SILVER

SMT

TOP

6PDT

ASF62S04

7-1825011-1

T & R

0.230 [5.82]

0.800 [20.32]

0.260 [6.60]

1.000 [25.40]

GOLD

SMT

TOP

6PDT

ASF62GSTR04

7-1825011-0

TUBE

0.230 [5.82]

0.800 [20.32]

0.260 [6.60]

1.000 [25.40]

GOLD

SMT

TOP

6PDT

ASF62GS04

6-1825011-9

T & R

0.230 [5.82]

0.800 [20.32]

0.260 [6.60]

1.000 [25.40]

SILVER

SMT

TOP

6PDT

ASF62LTR04

6-1825011-8

TUBE

0.230 [5.82]

0.800 [20.32]

0.260 [6.60]

1.000 [25.40]

SILVER

SMT

TOP

6PDT

ASF62L04

6-1825011-7

T & R

0.230 [5.82]

0.800 [20.32]

0.260 [6.60]

1.000 [25.40]

GOLD

SMT

TOP

6PDT

ASF62GLTR04

6-1825011-6

TUBE

0.230 [5.82]

0.800 [20.32]

0.260 [6.60]

1.000 [25.40]

GOLD

SMT

TOP

6PDT

ASF62GL04

6-1825011-5

T & R

0.230 [5.82]

0.800 [20.32]

0.260 [6.60]

1.000 [25.40]

GOLD

THRU-HOLE

SIDE

6PDT

ASF62RG04

6-1825011-4

TUBE

0.230 [5.82]

0.800 [20.32]

0.260 [6.60]

1.000 [25.40]

SILVER

THRU-HOLE

SIDE

6PDT

ASF62R04

6-1825011-3

TUBE

0.230 [5.82]

0.800 [20.32]

0.260 [6.60]

1.000 [25.40]

GOLD

THRU-HOLE

TOP

6PDT

ASF62G04

6-1825011-2

TUBE

0.230 [5.82]

0.800 [20.32]

0.260 [6.60]

1.000 [25.40]

SILVER

THRU-HOLE

TOP

6PDT

ASF6204

6-1825011-1

T & R

0.230 [5.82]

0.900 [22.86]

0.360 [9.14]

1.100 [27.94]

SILVER

SMT

SIDE

4P3T

ASF43RSTR04

6-1825011-0

TUBE

0.230 [5.82]

0.900 [22.86]

0.360 [9.14]

1.100 [27.94]

SILVER

SMT

SIDE

4P3T

ASF43RS04

5-1825011-9

T & R

0.230 [5.82]

0.900 [22.86]

0.360 [9.14]

1.100 [27.94]

GOLD

SMT

SIDE

4P3T

ASF43RGSTR04

5-1825011-8

TUBE

0.230 [5.82]

0.900 [22.86]

0.360 [9.14]

1.100 [27.94]

GOLD

SMT

SIDE

4P3T

ASF43RGS04

5-1825011-7

T & R

0.230 [5.82]

0.900 [22.86]

0.360 [9.14]

1.100 [27.94]

SILVER

SMT

SIDE

4P3T

ASF43RLTR04

5-1825011-6

TUBE

0.230 [5.82]

0.900 [22.86]

0.360 [9.14]

1.100 [27.94]

SILVER

SMT

SIDE

4P3T

ASF43RL04

5-1825011-5

T & R

0.230 [5.82]

0.900 [22.86]

0.360 [9.14]

1.100 [27.94]

GOLD

SMT

SIDE

4P3T

ASF43RGLTR04

5-1825011-4

TUBE

0.230 [5.82]

0.900 [22.86]

0.360 [9.14]

1.100 [27.94]

GOLD

SMT

SIDE

4P3T

ASF43RGL04

5-1825011-3

T & R

0.230 [5.82]

0.900 [22.86]

0.360 [9.14]

1.100 [27.94]

SILVER

SMT

TOP

4P3T

ASF43STR04

5-1825011-2

TUBE

0.230 [5.82]

0.900 [22.86]

0.360 [9.14]

1.100 [27.94]

SILVER

SMT

TOP

4P3T

ASF43S04

5-1825011-1

T & R

0.230 [5.82]

0.900 [22.86]

0.360 [9.14]

1.100 [27.94]

GOLD

SMT

TOP

4P3T

ASF43GSTR04

5-1825011-0

TUBE

0.230 [5.82]

0.900 [22.86]

0.360 [9.14]

1.100 [27.94]

GOLD

SMT

TOP

4P3T

ASF43GS04

4-1825011-9

T & R

0.230 [5.82]

0.900 [22.86]

0.360 [9.14]

1.100 [27.94]

SILVER

SMT

TOP

4P3T

ASF43LTR04

4-1825011-8

TUBE

0.230 [5.82]

0.900 [22.86]

0.360 [9.14]

1.100 [27.94]

SILVER

SMT

TOP

4P3T

ASF43L04

4-1825011-7

T & R

0.230 [5.82]

0.900 [22.86]

0.360 [9.14]

1.100 [27.94]

GOLD

SMT

TOP

4P3T

ASF43GL04

4-1825011-6

TUBE

0.230 [5.82]

0.900 [22.86]

0.360 [9.14]

1.100 [27.94]

GOLD

SMT

TOP

4P3T

ASF43GL04

4-1825011-5

T & R

0.230 [5.82]

0.900 [22.86]

0.360 [9.14]

1.100 [27.94]

GOLD

THRU-HOLE

SIDE

4P3T

ASF43RG04

4-1825011-4

TUBE

0.230 [5.82]

0.900 [22.86]

0.360 [9.14]

1.100 [27.94]

SILVER

THRU-HOLE

SIDE

4P3T

ASF43R04

4-1825011-3

T & R

0.230 [5.82]

0.900 [22.86]

0.360 [9.14]

1.100 [27.94]

GOLD

THRU-HOLE

TOP

4P3T

ASF43G04

4-1825011-2

TUBE

0.230 [5.82]

0.900 [22.86]

0.360 [9.14]

1.100 [27.94]

SILVER

THRU-HOLE

TOP

4P3T

ASF4304

4-1825011-1

T & R

0.230 [5.82]

0.500 [12.70]

0.260 [6.60]

0.700 [17.78]

SILVER

SMT

SIDE

4PDT

ASF42RSTR04

4-1825011-0

TUBE

0.230 [5.82]

0.500 [12.70]

0.260 [6.60]

0.700 [17.78]

SILVER

SMT

SIDE

4PDT

ASF42RS04

3-1825011-9

T & R

0.230 [5.82]

0.500 [12.70]

0.260 [6.60]

0.700 [17.78]

GOLD

SMT

SIDE

4PDT

ASF42RGSTR04

3-1825011-8

TUBE

0.230 [5.82]

0.500 [12.70]

0.260 [6.60]

0.700 [17.78]

GOLD

SMT

SIDE

4PDT

ASF42RGS04

3-1825011-7

T & R

0.230 [5.82]

0.500 [12.70]

0.260 [6.60]

0.700 [17.78]

SILVER

SMT

SIDE

4PDT

ASF42RLTR04

3-1825011-6

TUBE

0.230 [5.82]

0.500 [12.70]

0.260 [6.60]

0.700 [17.78]

SILVER

SMT

SIDE

4PDT

ASF42RL04

3-1825011-5

T & R

0.230 [5.82]

0.500 [12.70]

0.260 [6.60]

0.700 [17.78]

GOLD

SMT

SIDE

4PDT

ASF42RCLTR04

3-1825011-4

TUBE

0.230 [5.82]

0.500 [12.70]

0.260 [6.60]

0.700 [17.78]

GOLD

SMT

SIDE

4PDT

ASF42RCL04

3-1825011-3

T & R

0.230 [5.82]

0.500 [12.70]

0.260 [6.60]

0.700 [17.78]

SILVER

SMT

TOP

4PDT

ASF42STR04

3-1825011-2

TUBE

0.230 [5.82]

0.500 [12.70]

0.260 [6.60]

0.700 [17.78]

SILVER

SMT

TOP

4PDT

ASF42S04

3-1825011-1

T & R

0.230 [5.82]

0.500 [12.70]

0.260 [6.60]

0.700 [17.78]

GOLD

SMT

TOP

4PDT

ASF42GSTR04

3-1825011-0

TUBE

0.230 [5.82]

0.500 [12.70]

0.260 [6.60]

0.700 [17.78]

GOLD

SMT

TOP

4PDT

ASF42GS04

2-1825011-9

T & R

0.230 [5.82]

0.500 [12.70]

0.260 [6.60]

0.700 [17.78]

SILVER

SMT

TOP

4PDT

ASF42LTR04

2-1825011-8

TUBE

0.230 [5.82]

0.500 [12.70]

0.260 [6.60]

0.700 [17.78]

SILVER

SMT

TOP

4PDT

ASF42L04

2-1825011-7

T & R

0.230 [5.82]

0.500 [12.70]

0.260 [6.60]

0.700 [17.78]

GOLD

SMT

TOP

4PDT

ASF42GLTR04

2-1825011-6

TUBE

0.230 [5.82]

0.500 [12.70]

0.260 [6.60]

0.700 [17.78]

GOLD

SMT

TOP

4PDT

ASF42GL04

2-1825011-5

T & R

0.230 [5.82]

0.500 [12.70]

0.260 [6.60]

0.700 [17.78]

GOLD

THRU-HOLE

SIDE

4PDT

ASF42RG04

2-1825011-4

TUBE

0.230 [5.82]

0.500 [12.70]

0.260 [6.60]

0.700 [17.78]

SILVER

THRU-HOLE

SIDE

4PDT

ASF42R04

2-1825011-3

T & R

0.230 [5.82]

0.500 [12.70]

0.260 [6.60]

0.700 [17.78]

GOLD

THRU-HOLE

TOP

4PDT

ASF42G04

2-1825011-2

TUBE

0.230 [5.82]

0.500 [12.70]

0.260 [6.60]

0.700 [17.78]

SILVER

THRU-HOLE

TOP

4PDT

ASF4204

2-1825011-1

T & R

0.105 [2.67]

0.200 [5.08]

0.260 [6.60]

0.400 [10.16]

SILVER

SMT

SIDE

DPDT

ASF22RSTR04

2-1825011-0

TUBE

0.105 [2.67]

0.200 [5.08]

0.260 [6.60]

0.400 [10.16]

SILVER

SMT

SIDE

DPDT

ASF22RS04

1-1825011-9

T & R

0.105 [2.67]

0.200 [5.08]

0.260 [6.60]

0.400 [10.16]

GOLD

SMT

SIDE

DPDT

ASF22RGSTR04

1-1825011-8

TUBE

0.105 [2.67]

0.200 [5.08]

0.260 [6.60]

0.400 [10.16]

GOLD

SMT

SIDE

DPDT

ASF22RGS04

1-1825011-7

T & R

0.105 [2.67]

0.200 [5.08]

0.260 [6.60]

0.400 [10.16]

SILVER

SMT

SIDE

DPDT

ASF22RLTR04

1-1825011-6

TUBE

0.105 [2.67]

0.200 [5.08]

0.260 [6.60]

0.400 [10.16]

SILVER

SMT

SIDE

DPDT

ASF22RL04

1-1825011-5

T & R

0.105 [2.67]

0.200 [5.08]

0.260 [6.60]

0.400 [10.16]

GOLD

SMT

SIDE

DPDT

ASF22RGLTR04

1-1825011-4

TUBE

0.105 [2.67]

0.200 [5.08]

0.260 [6.60]

0.400 [10.16]

GOLD

SMT

SIDE

DPDT

ASF22RGL04

1-1825011-3

T & R

0.105 [2.67]

0.200 [5.08]

0.260 [6.60]

0.400 [10.16]

SILVER

SMT

TOP

DPDT

ASF22STR04

1-1825011-2

TUBE

0.105 [2.67]

0.200 [5.08]

0.260 [6.60]

0.400 [10.16]

SILVER

SMT

TOP

DPDT

ASF22S04

1-1825011-1

T & R

0.105 [2.67]

0.200 [5.08]

0.260 [6.60]

0.400 [10.16]

GOLD

SMT

TOP

DPDT

ASF22GSTR04

1-1825011-0

TUBE

0.105 [2.67]

0.200 [5.08]

0.260 [6.60]

0.400 [10.16]

GOLD

SMT

TOP

DPDT

ASF22GS04

1825011-9

T & R

0.105 [2.67]

0.200 [5.08]

0.260 [6.60]

0.400 [10.16]

SILVER

SMT

TOP

DPDT

ASF22LTR04

1825011-8

TUBE

0.105 [2.67]

0.200 [5.08]

0.260 [6.60]

0.400 [10.16]

SILVER

SMT

TOP

DPDT

ASF22L04

1825011-7

T & R

0.105 [2.67]

0.200 [5.08]

0.260 [6.60]

0.400 [10.16]

GOLD

SMT

TOP

DPDT

ASF22GLTR04

1825011-6

TUBE

0.105 [2.67]

0.200 [5.08]

0.260 [6.60]

0.400 [10.16]

GOLD

SMT

TOP

DPDT

ASF22GL04

1825011-5

T & R

0.105 [2.67]

0.200 [5.08]

0.260 [6.60]

0.400 [10.16]

GOLD

THRU-HOLE

SIDE

DPDT

ASF22RG04

1825011-4

TUBE

0.105 [2.67]

0.200 [5.08]

0.260 [6.60]

0.400 [10.16]

SILVER

THRU-HOLE

SIDE

DPDT

ASF22R04

1825011-3

T & R

0.105 [2.67]

0.200 [5.08]

0.260 [6.60]

0.400 [10.16]

GOLD

THRU-HOLE

TOP

DPDT

ASF22G04

1825011-2

TUBE

0.105 [2.67]

0.200 [5.08]

0.260 [6.60]

0.400 [10.16]

SILVER

THRU-HOLE

TOP

DPDT

ASF2204

1825011-1

NOTES

PACKAGING

Dim D

Dim C

Dim B

Dim A

FINISH (ABCD)

MTG STYLE

ACTUA TION

FUNCTION

ALCO P/N

P/N

THIS DRAWING IS A CONTROLLED DOCUMENT.

DIMENSIONS: INCHES [mm]

TOLERANCES UNLESS OTHERWISE SPECIFIED: 0 PLC ± — 1 PLC ± — 2 PLC ± — 3 PLC ± .010[0.25] 4 PLC ± ± .1° ANGLES FINISH

MATERIAL SEE SPECIFICATIONS

OWN: S.SIVSWESWARA 20FEB05 CHK: M.S.SARVER 20FEB05 APVD: M.S.SARVER 20FEB05 PRODUCT SPEC APPLICATION SPEC WEIGHT

NAME SIZE CAGE CODE DRAWING NO RESTRICTED TO

CUSTOMER DRAWING SCALE 5:1 SHEET 1 OF 2 REV B2

TE Connectivity

SLIDE SWITCH ASF, AUTO-INSERTABLE, THRU-HOLE AND SURFACE MOUNT

1825011-1

8

7

6

5

4

3

2

1

THIS DRAWING IS UNPUBLISHED.

RELEASED FOR PUBLICATION

ALL RIGHTS RESERVED.

REVISIONS

P	LTR	DESCRIPTION	DATE	OWN	APVD
B1		REVISED PER ECO-11-004587	11MAR11	RK	HMR
B2		REVISED PER ECO-16-018096	25MAY2017	RK	PO

5

T & R

0.105 [2.67]

0.200 [5.08]

0.260 [6.60]

0.400 [10.16]

SILVER

SMT

TOP

DPDT

ASF7126004

8-1825011-1

T & R

0.230 [5.82]

0.800 [20.32]

0.260 [6.60]

1.000 [25.40]

SILVER

SMT

SIDE

6PDT

ASF62RSTR04

8-1825011-0

TUBE

0.230 [5.82]

0.800 [20.32]

0.260 [6.60]

1.000 [25.40]

SILVER

SMT

SIDE

6PDT

ASF62RS04

7-1825011-9

T & R

0.230 [5.82]

0.800 [20.32]

0.260 [6.60]

1.000 [25.40]

GOLD

SMT

SIDE

6PDT

ASF62RGSTR04

7-1825011-8

TUBE

0.230 [5.82]

0.800 [20.32]

0.260 [6.60]

1.000 [25.40]

GOLD

SMT

SIDE

6PDT

ASF62RGS04

7-1825011-7

T & R

0.230 [5.82]

0.800 [20.32]

0.260 [6.60]

1.000 [25.40]

SILVER

SMT

SIDE

6PDT

ASF62RLTR04

7-1825011-6

TUBE

0.230 [5.82]

0.800 [20.32]

0.260 [6.60]

1.000 [25.40]

SILVER

SMT

SIDE

6PDT

ASF62RL04

7-1825011-5

T & R

0.230 [5.82]

0.800 [20.32]

0.260 [6.60]

1.000 [25.40]

GOLD

SMT

SIDE

6PDT

ASF62RGLTR04

7-1825011-4

TUBE

0.230 [5.82]

0.800 [20.32]

0.260 [6.60]

1.000 [25.40]

GOLD

SMT

REVISIONS					
P	LTR	DESCRIPTION	DATE	DWN	APVD
-	-	SEE SHEET 1	-	-	-

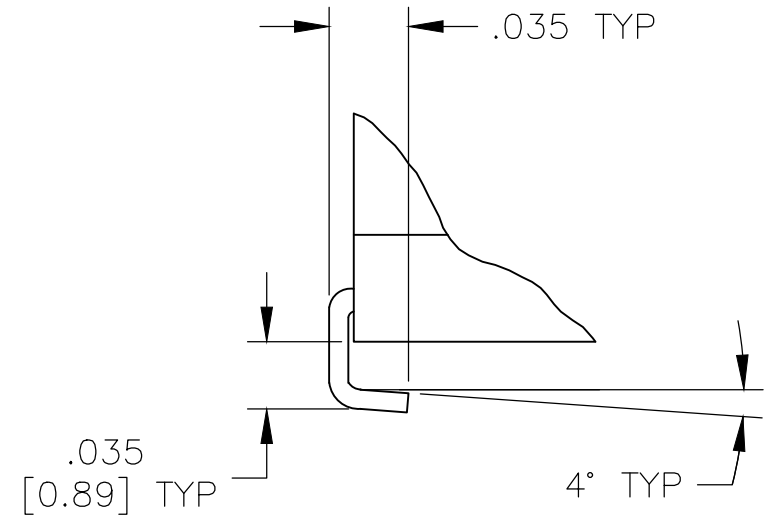
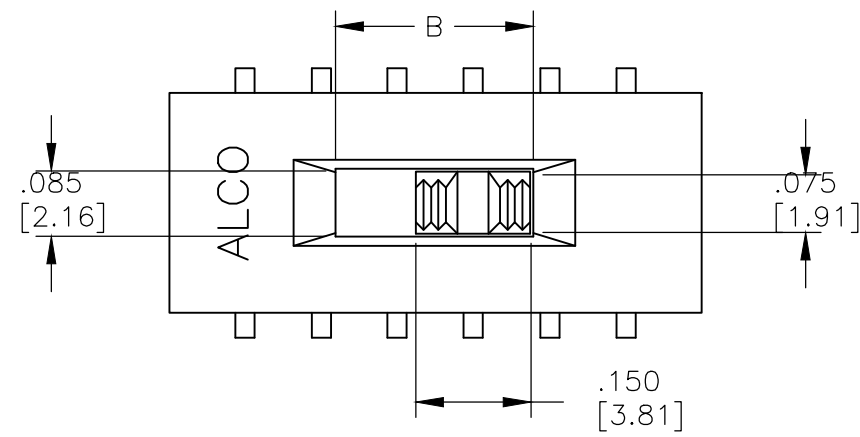

DETAIL A  
SCALE 10:1

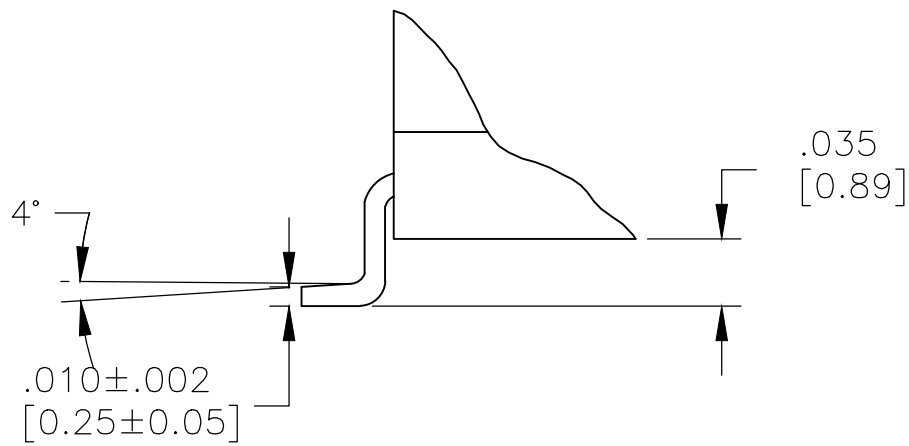

DETAIL B  
SCALE 10:1

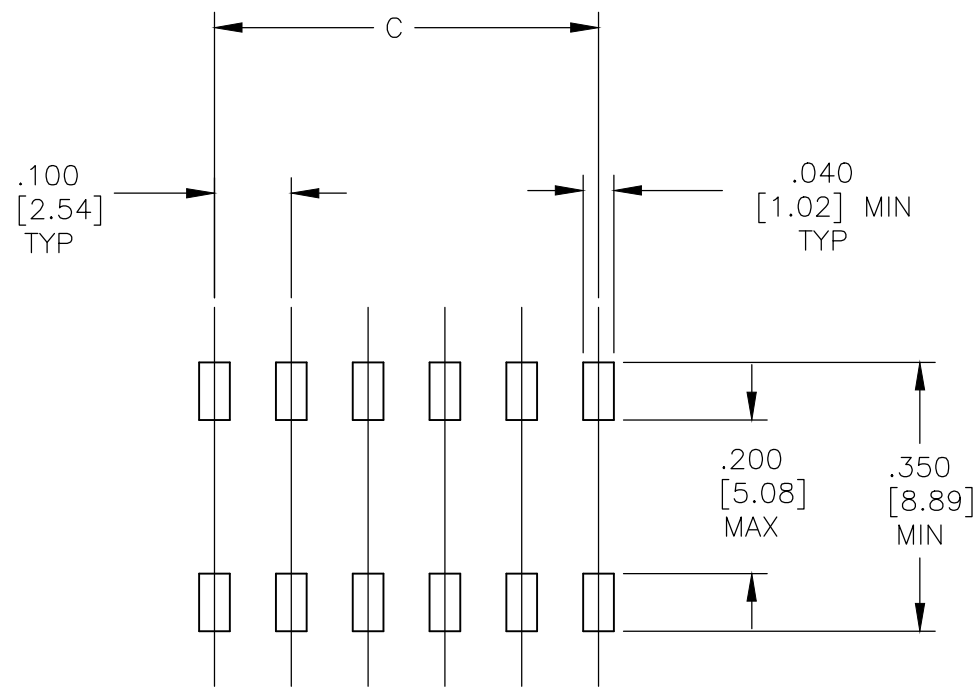
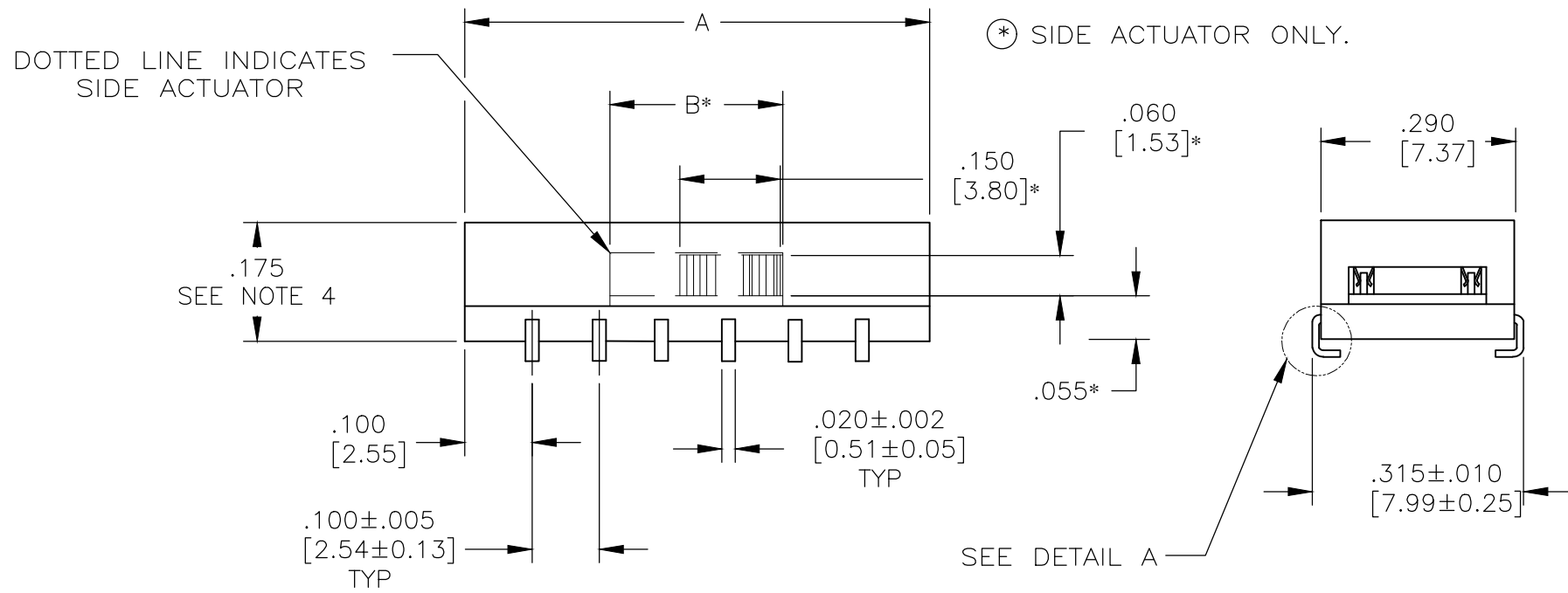

PRINTED CIRCUIT BOARD  
PAD LAYOUT

"S" J-LEAD TYPE SURFACE MOUNT

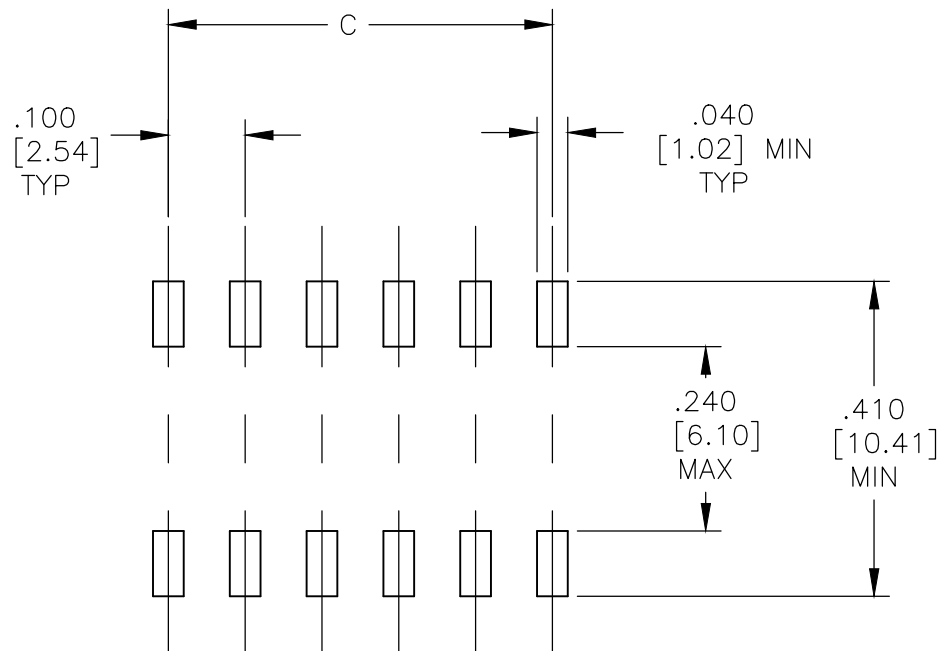
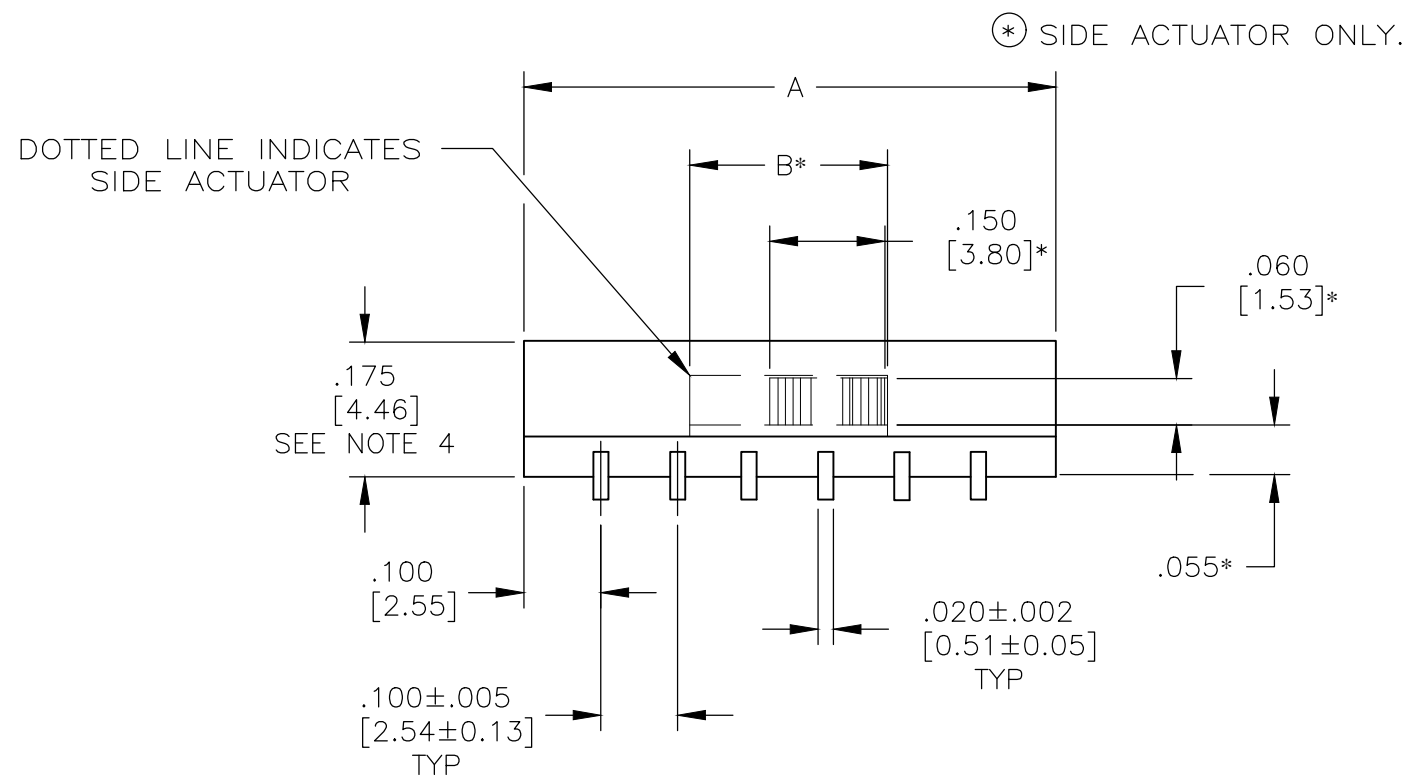

PRINTED CIRCUIT BOARD  
PAD LAYOUT

"L" GULL WING TYPE SURFACE MOUNT

THIS DRAWING IS A CONTROLLED DOCUMENT.		DWN B.S.VISWESWARA 20FEB05	TE Connectivity		
DIMENSIONS: INCHES [mm]		CHK M.S.SARVER 20FEB05			
		APVD M.S.SARVER 20FEB05	NAME SLIDE SWITCH ASF, AUTO-INSERTABLE, THRU-HOLE AND SURFACE MOUNT -		
		PRODUCT SPEC			
TOLERANCES UNLESS OTHERWISE SPECIFIED:		APPLICATION SPEC	SIZE A1 CAGE CODE 00779 DRAWING NO 1825011		
0 PLC ± - 1 PLC ± - 2 PLC ± - 3 PLC ± .01[0.25] 4 PLC ± - ANGLES ± 1°		WEIGHT -			
MATERIAL SEE SHEET 1	FINISH SEE SHEET 1	CUSTOMER DRAWING		SCALE 5:1	SHEET 2 OF 2 REV B2

# Mouser Electronics

Authorized Distributor

Click to View Pricing, Inventory, Delivery & Lifecycle Information:

[TE Connectivity:](#)

[ASF22GL04](#)