

REVISIONS					
P	LTR	DESCRIPTION	DATE	DWN	APVD
L		REVISED PER ECO-20-001912	03JUN2020	SB	JO

D

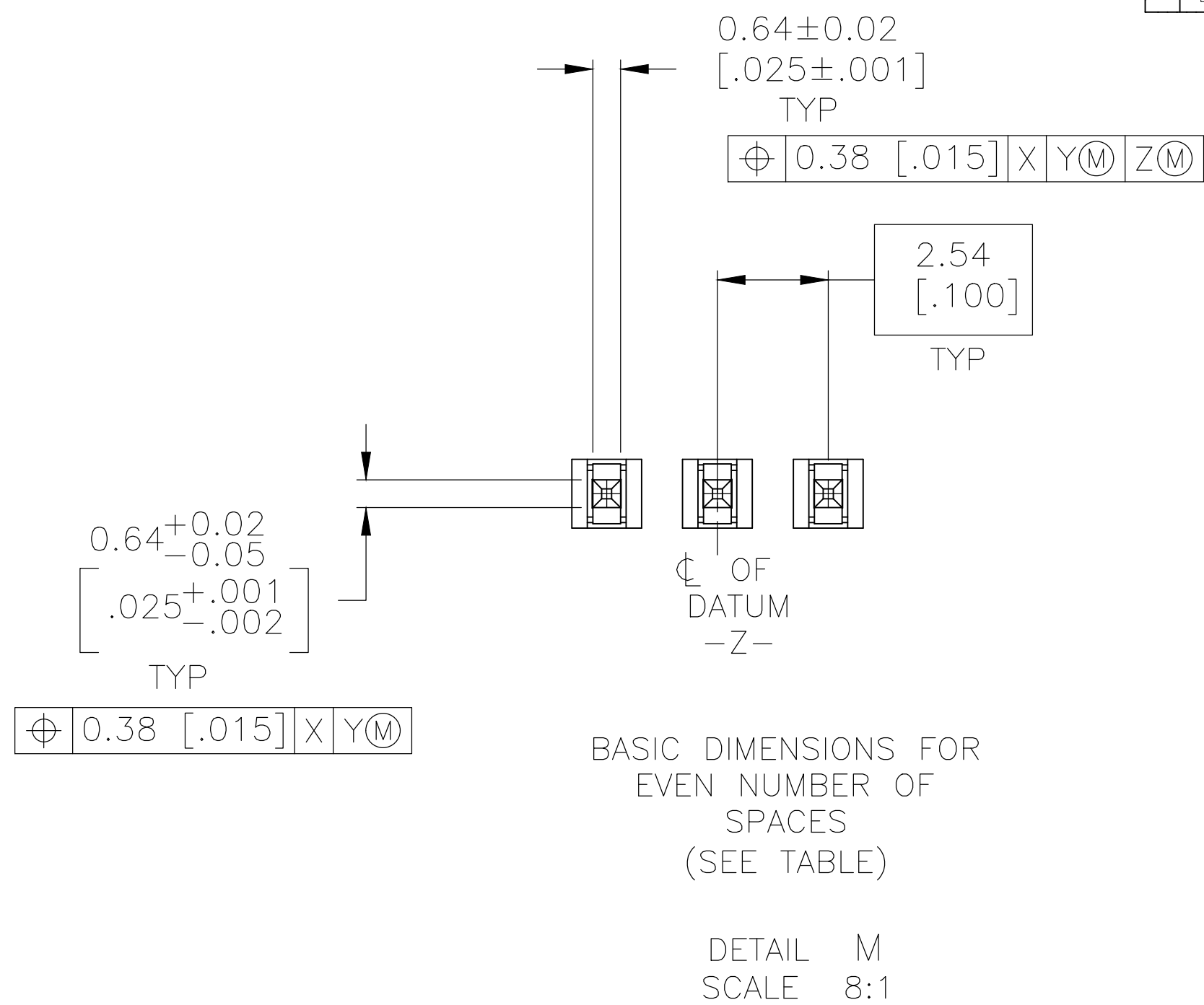

C

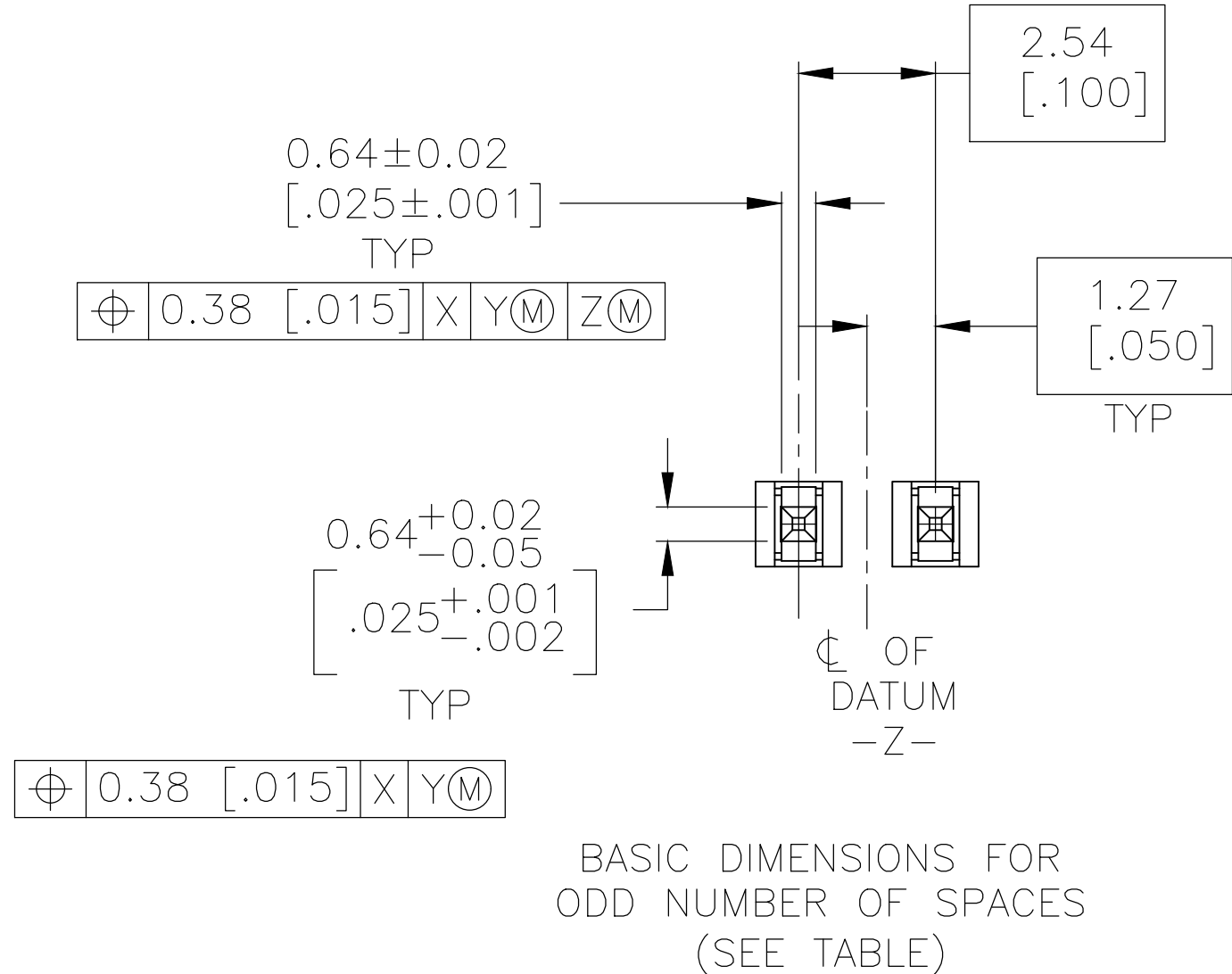
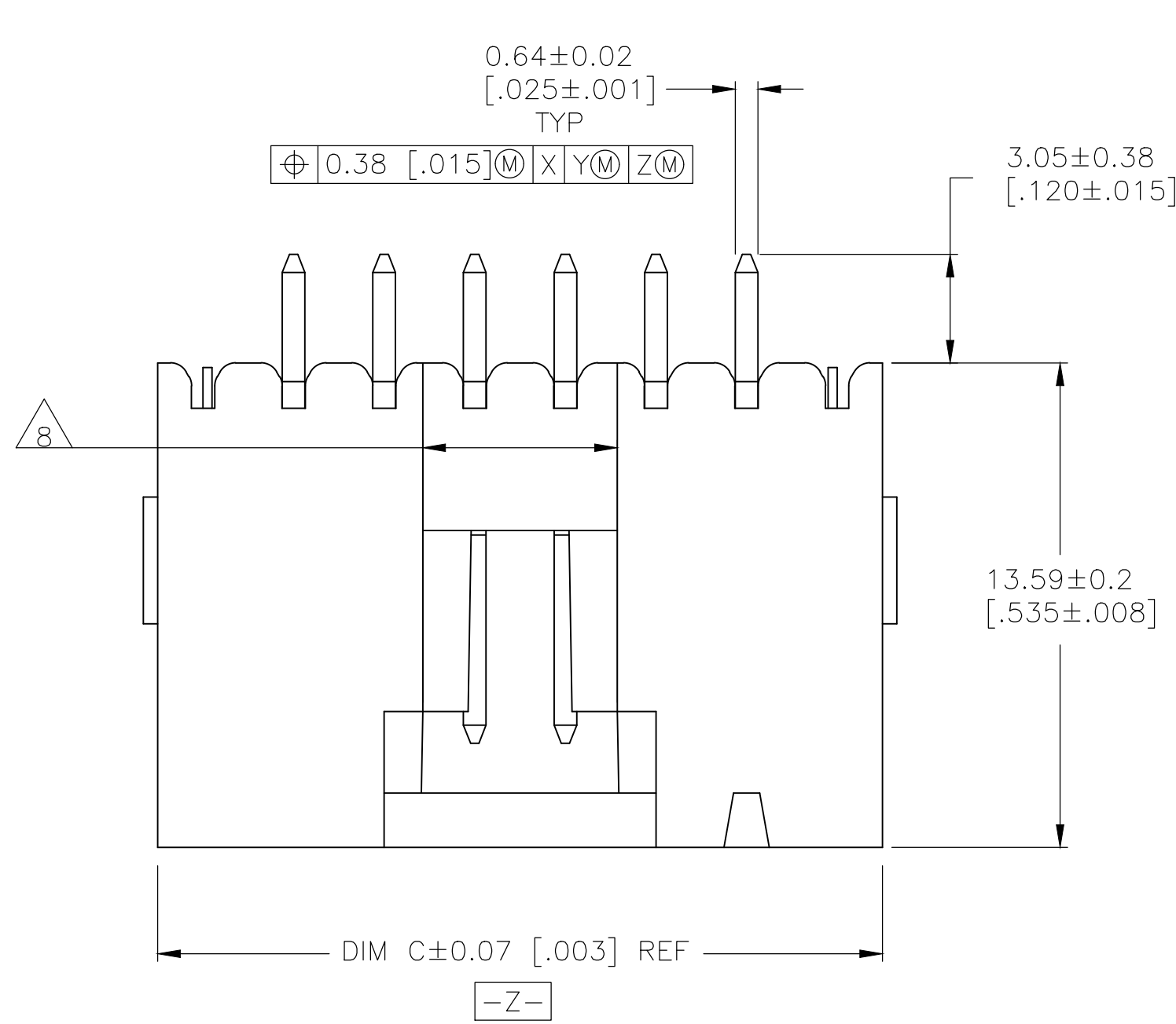
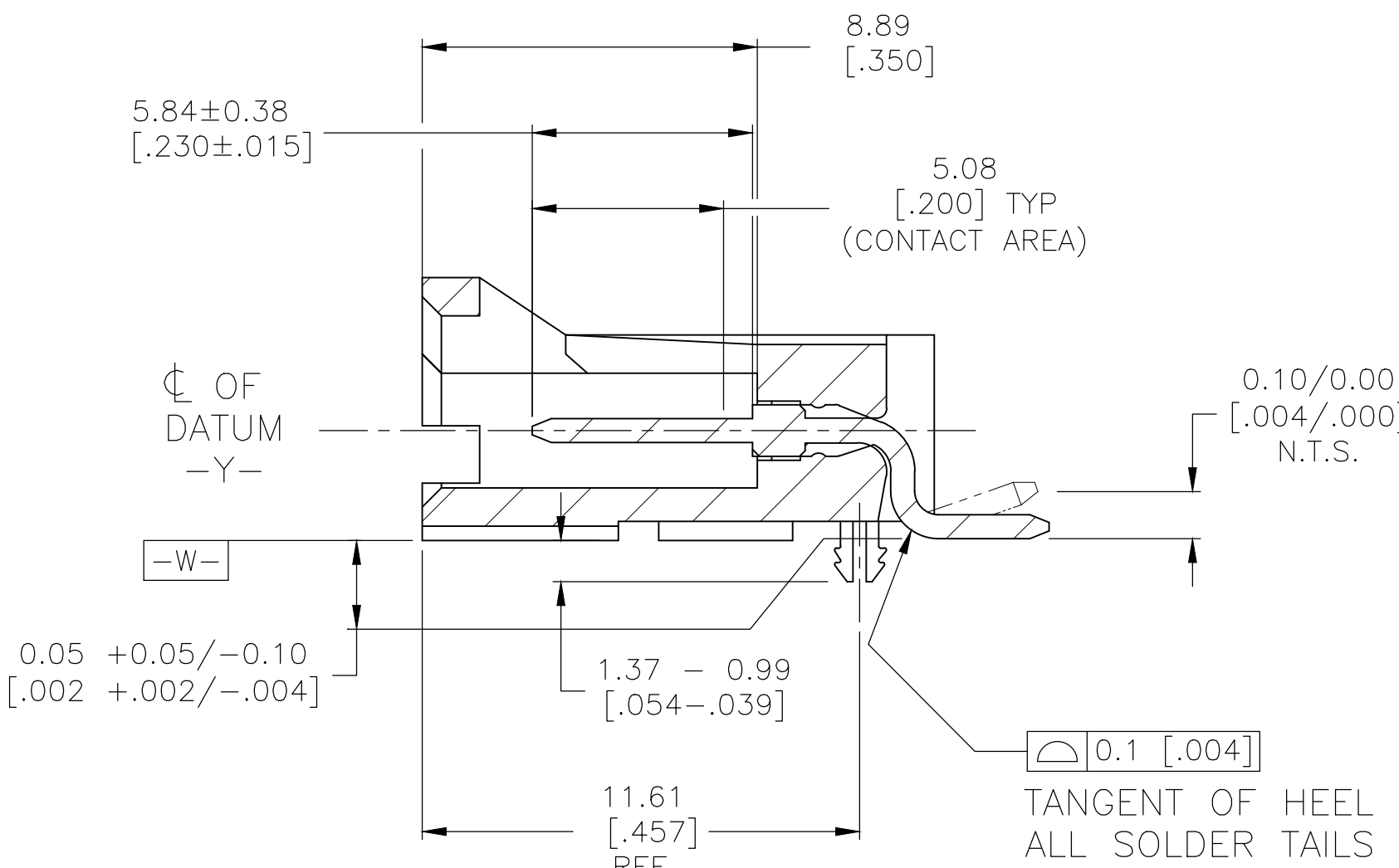
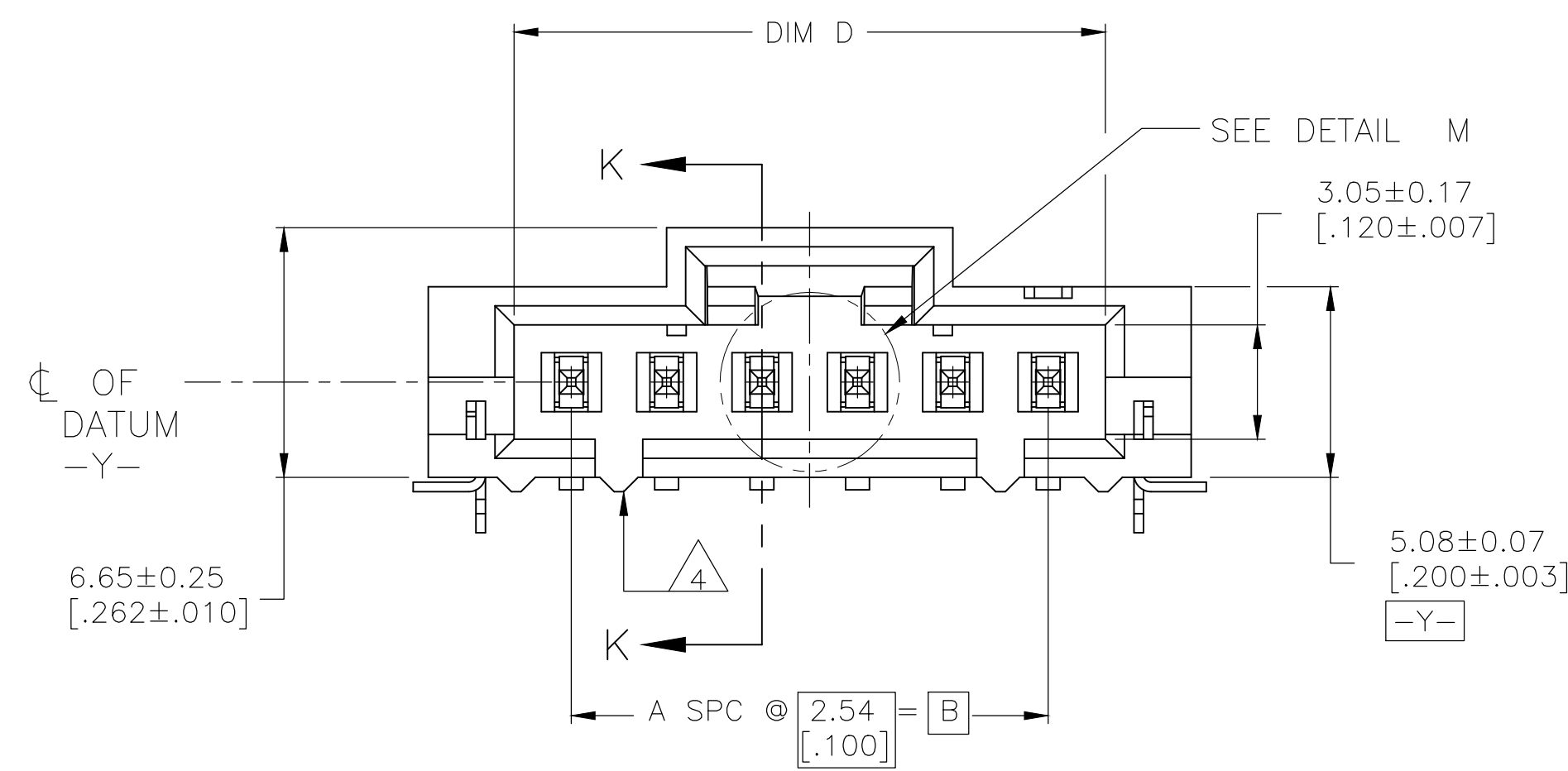

- 1 HOUSING: LCP, COLOR-BLACK. POST: BRASS.
- 2 POST: 0.00254-0.00508 [0.000100-0.00200] BRIGHT TIN-LEAD OVER 0.00127-0.00254 [0.000050-0.000100] NICKEL.
- 3 DATUMS AND BASIC DIMENSIONS ESTABLISHED BY THE CUSTOMER.
- 4 TWO POLARIZATION SLOTS ON ASSEMBLIES WITH FOUR OR MORE POSITIONS.
- 5 0.00254-0.00508 [0.000100-0.00200] BRIGHT TIN OVER 0.00127-0.00254 [0.000050-0.000100] NICKEL.
- 6 PRELIMINARY PART - NOT RELEASED FOR PRODUCTION.
- 7 0.00254-0.00508 [0.000100-0.00200] MATTE TIN OVER 0.00127-0.00254 [0.000050-0.000100] NICKEL.
- 8 0.25 [0.010] RECESS PERMISSIBLE IN THIS AREA FOR MOLD SHUT OFF

B

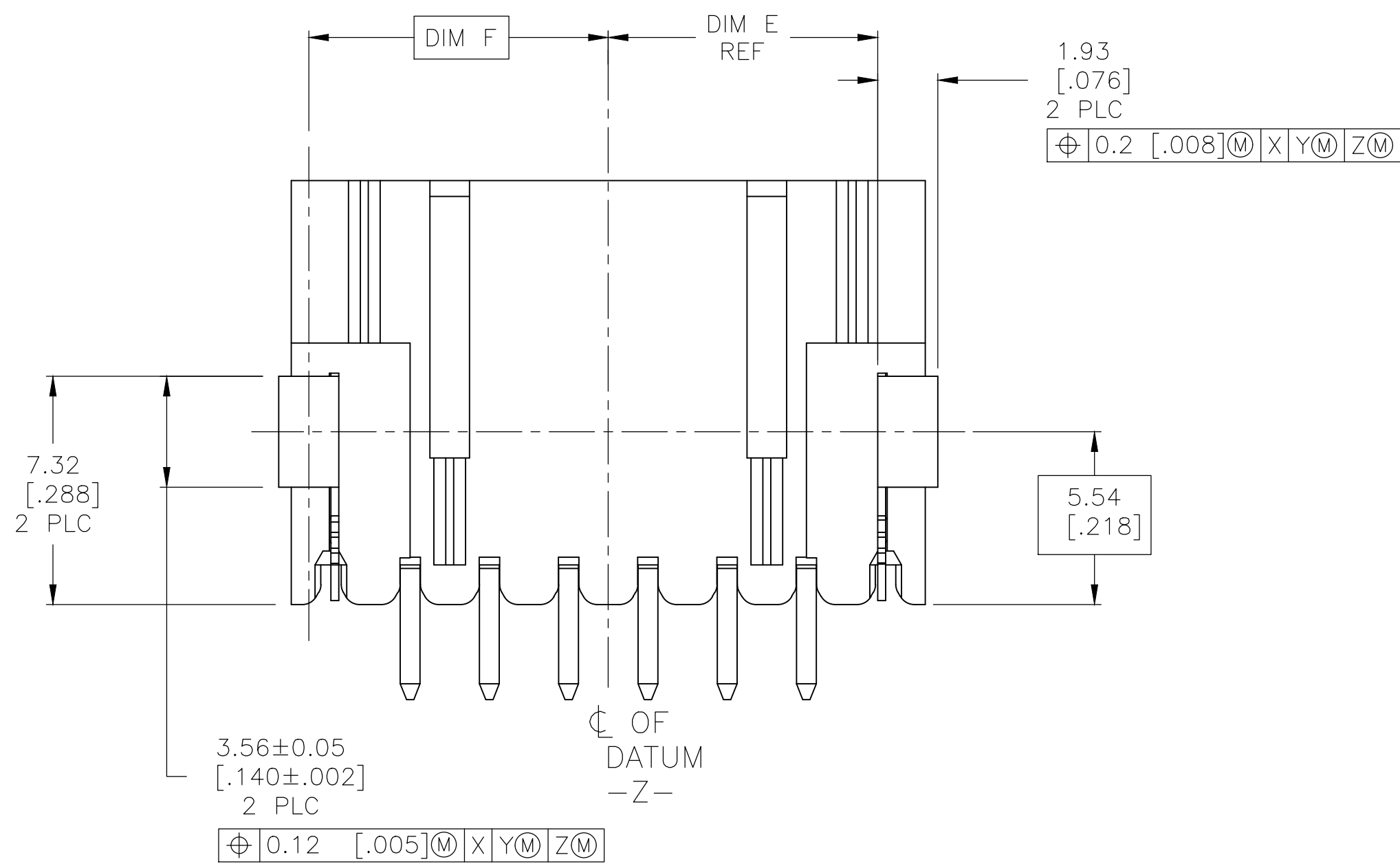

SEE TABLE ON SHEET #3

A

THIS DRAWING IS A CONTROLLED DOCUMENT.		DWN B. HAYMAKER 02DEC99	TE Connectivity Ltd.	
DIMENSIONS: mm [INCHES]		CHK J. MOSIER 02DEC99		
	TOLERANCES UNLESS OTHERWISE SPECIFIED:	APVD J. MOSIER 02DEC99	NAME	
		PRODUCT SPEC	108-25034	
		APPLICATION SPEC	—	
		ANGLES	—	
MATERIAL	FINISH	WEIGHT	A1 00779 147324	
1	SEE TABLE	CUSTOMER DRAWING	SCALE 6:1	SHEET 1 OF 4 REV L

8		7		6		5		4		3		2		1				
© — TE Connectivity. All Rights Reserved.														REVISIONS				
P		LTR		DESCRIPTION								DATE		DWN		APVD		
		—		SEE SHEET 1								—		—		—		

8		7		6		5		4		3		2		1																																																																																																																																																																																																																																																																																							
© — TE Connectivity. All Rights Reserved.														REVISIONS																																																																																																																																																																																																																																																																																							
P		LTR		DESCRIPTION								DATE		DWN		APVD																																																																																																																																																																																																																																																																																					
		—		SEE SHEET 1								—		—		—																																																																																																																																																																																																																																																																																					
<table><tr><td></td><td>88</td><td>65.79 [2.590]</td><td>33.73 [1.328]</td><td>32.77 [1.290]</td><td>64.01 [2.520]</td><td>68.45 [2.695]</td><td>60.96 [2.400]</td><td>24</td><td>25</td><td>7-147324-4</td></tr><tr><td></td><td>88</td><td>63.25 [2.490]</td><td>32.46 [1.278]</td><td>31.50 [1.240]</td><td>61.47 [2.420]</td><td>65.91 [2.595]</td><td>58.42 [2.300]</td><td>23</td><td>24</td><td>7-147324-3</td></tr><tr><td></td><td>88</td><td>60.71 [2.390]</td><td>31.19 [1.228]</td><td>30.23 [1.190]</td><td>58.93 [2.320]</td><td>63.37 [2.495]</td><td>55.88 [2.200]</td><td>22</td><td>23</td><td>7-147324-2</td></tr><tr><td></td><td>88</td><td>58.17 [2.290]</td><td>29.92 [1.178]</td><td>28.96 [1.140]</td><td>56.39 [2.220]</td><td>60.83 [2.395]</td><td>53.34 [2.100]</td><td>21</td><td>22</td><td>7-147324-1</td></tr><tr><td></td><td>88</td><td>55.63 [2.190]</td><td>28.65 [1.128]</td><td>27.69 [1.090]</td><td>53.85 [2.120]</td><td>58.29 [2.295]</td><td>50.80 [2.000]</td><td>20</td><td>21</td><td>7-147324-0</td></tr><tr><td></td><td>72</td><td>53.09 [2.090]</td><td>27.38 [1.078]</td><td>26.42 [1.040]</td><td>51.31 [2.020]</td><td>55.75 [2.195]</td><td>48.26 [1.900]</td><td>19</td><td>20</td><td>6-147324-9</td></tr><tr><td></td><td>72</td><td>50.55 [1.990]</td><td>26.11 [1.028]</td><td>25.15 [.990]</td><td>48.77 [1.920]</td><td>53.21 [2.095]</td><td>45.72 [1.800]</td><td>18</td><td>19</td><td>6-147324-8</td></tr><tr><td></td><td>72</td><td>48.01 [1.890]</td><td>24.84 [.978]</td><td>23.88 [.940]</td><td>46.23 [1.820]</td><td>50.67 [1.995]</td><td>43.18 [1.700]</td><td>17</td><td>18</td><td>6-147324-7</td></tr><tr><td></td><td>72</td><td>45.47 [1.790]</td><td>23.57 [.928]</td><td>22.61 [.890]</td><td>43.69 [1.720]</td><td>48.13 [1.895]</td><td>40.64 [1.600]</td><td>16</td><td>17</td><td>6-147324-6</td></tr><tr><td></td><td>72</td><td>42.93 [1.690]</td><td>22.30 [.878]</td><td>21.34 [.840]</td><td>41.15 [1.620]</td><td>45.59 [1.795]</td><td>38.10 [1.500]</td><td>15</td><td>16</td><td>6-147324-5</td></tr><tr><td></td><td>72</td><td>40.39 [1.590]</td><td>21.03 [.828]</td><td>20.07 [.790]</td><td>38.61 [1.520]</td><td>43.05 [1.695]</td><td>35.56 [1.400]</td><td>14</td><td>15</td><td>6-147324-4</td></tr><tr><td></td><td>56</td><td>37.85 [1.490]</td><td>19.76 [.778]</td><td>18.80 [.740]</td><td>36.07 [1.420]</td><td>40.51 [1.595]</td><td>33.02 [1.300]</td><td>13</td><td>14</td><td>6-147324-3</td></tr><tr><td></td><td>56</td><td>35.31 [1.390]</td><td>18.49 [.728]</td><td>17.53 [.690]</td><td>33.53 [1.320]</td><td>37.97 [1.495]</td><td>30.48 [1.200]</td><td>12</td><td>13</td><td>6-147324-2</td></tr><tr><td></td><td>56</td><td>32.77 [1.290]</td><td>17.22 [.678]</td><td>16.26 [.640]</td><td>30.99 [1.220]</td><td>35.43 [1.395]</td><td>27.94 [1.100]</td><td>11</td><td>12</td><td>6-147324-1</td></tr><tr><td></td><td>56</td><td>30.23 [1.190]</td><td>15.95 [.628]</td><td>14.99 [.590]</td><td>28.45 [1.120]</td><td>32.89 [1.295]</td><td>25.40 [1.000]</td><td>10</td><td>11</td><td>6-147324-0</td></tr><tr><td></td><td>44</td><td>27.69 [1.090]</td><td>14.68 [.578]</td><td>13.72 [.540]</td><td>25.91 [1.020]</td><td>30.35 [1.195]</td><td>22.86 [.900]</td><td>9</td><td>10</td><td>5-147324-9</td></tr><tr><td></td><td>44</td><td>25.15 [.990]</td><td>13.41 [.528]</td><td>12.45 [.490]</td><td>23.37 [.920]</td><td>27.81 [1.095]</td><td>20.32 [.800]</td><td>8</td><td>9</td><td>5-147324-8</td></tr><tr><td></td><td>44</td><td>22.61 [.890]</td><td>12.14 [.478]</td><td>11.18 [.440]</td><td>20.83 [.820]</td><td>25.27 [.995]</td><td>17.78 [.700]</td><td>7</td><td>8</td><td>5-147324-7</td></tr><tr><td></td><td>44</td><td>20.07 [.790]</td><td>10.87 [.428]</td><td>9.91 [.390]</td><td>18.29 [720]</td><td>22.73 [.895]</td><td>15.24 [.600]</td><td>6</td><td>7</td><td>5-147324-6</td></tr><tr><td></td><td>44</td><td>17.53 [.690]</td><td>9.60 [.378]</td><td>8.64 [.340]</td><td>15.75 [.620]</td><td>20.19 [.795]</td><td>12.70 [.500]</td><td>5</td><td>6</td><td>5-147324-5</td></tr><tr><td></td><td>32</td><td>14.99 [.590]</td><td>8.33 [.328]</td><td>7.37 [.290]</td><td>13.21 [.520]</td><td>17.65 [.695]</td><td>10.16 [.400]</td><td>4</td><td>5</td><td>5-147324-4</td></tr><tr><td></td><td>24</td><td>12.45 [.490]</td><td>7.06 [.278]</td><td>6.10 [.240]</td><td>10.67 [.420]</td><td>15.11 [.595]</td><td>7.62 [.300]</td><td>3</td><td>4</td><td>5-147324-3</td></tr><tr><td></td><td>24</td><td>9.91 [.390]</td><td>5.79 [.228]</td><td>4.83 [.190]</td><td>8.13 [.320]</td><td>12.57 [.495]</td><td>5.08 [.200]</td><td>2</td><td>3</td><td>5-147324-2</td></tr><tr><td></td><td>24</td><td>7.37 [.290]</td><td>4.52 [.178]</td><td>3.56 [.140]</td><td>5.59 [.220]</td><td>10.03 [.395]</td><td>2.54 [.100]</td><td>1</td><td>2</td><td>5-147324-1</td></tr><tr><td>PLATING</td><td>EIA 481 TAPE WIDTH mm</td><td>G</td><td>F</td><td>E</td><td>D</td><td>C</td><td>B</td><td>A</td><td>NO OF POSN</td><td>PART NUMBER</td></tr></table>																				88	65.79 [2.590]	33.73 [1.328]	32.77 [1.290]	64.01 [2.520]	68.45 [2.695]	60.96 [2.400]	24	25	7-147324-4		88	63.25 [2.490]	32.46 [1.278]	31.50 [1.240]	61.47 [2.420]	65.91 [2.595]	58.42 [2.300]	23	24	7-147324-3		88	60.71 [2.390]	31.19 [1.228]	30.23 [1.190]	58.93 [2.320]	63.37 [2.495]	55.88 [2.200]	22	23	7-147324-2		88	58.17 [2.290]	29.92 [1.178]	28.96 [1.140]	56.39 [2.220]	60.83 [2.395]	53.34 [2.100]	21	22	7-147324-1		88	55.63 [2.190]	28.65 [1.128]	27.69 [1.090]	53.85 [2.120]	58.29 [2.295]	50.80 [2.000]	20	21	7-147324-0		72	53.09 [2.090]	27.38 [1.078]	26.42 [1.040]	51.31 [2.020]	55.75 [2.195]	48.26 [1.900]	19	20	6-147324-9		72	50.55 [1.990]	26.11 [1.028]	25.15 [.990]	48.77 [1.920]	53.21 [2.095]	45.72 [1.800]	18	19	6-147324-8		72	48.01 [1.890]	24.84 [.978]	23.88 [.940]	46.23 [1.820]	50.67 [1.995]	43.18 [1.700]	17	18	6-147324-7		72	45.47 [1.790]	23.57 [.928]	22.61 [.890]	43.69 [1.720]	48.13 [1.895]	40.64 [1.600]	16	17	6-147324-6		72	42.93 [1.690]	22.30 [.878]	21.34 [.840]	41.15 [1.620]	45.59 [1.795]	38.10 [1.500]	15	16	6-147324-5		72	40.39 [1.590]	21.03 [.828]	20.07 [.790]	38.61 [1.520]	43.05 [1.695]	35.56 [1.400]	14	15	6-147324-4		56	37.85 [1.490]	19.76 [.778]	18.80 [.740]	36.07 [1.420]	40.51 [1.595]	33.02 [1.300]	13	14	6-147324-3		56	35.31 [1.390]	18.49 [.728]	17.53 [.690]	33.53 [1.320]	37.97 [1.495]	30.48 [1.200]	12	13	6-147324-2		56	32.77 [1.290]	17.22 [.678]	16.26 [.640]	30.99 [1.220]	35.43 [1.395]	27.94 [1.100]	11	12	6-147324-1		56	30.23 [1.190]	15.95 [.628]	14.99 [.590]	28.45 [1.120]	32.89 [1.295]	25.40 [1.000]	10	11	6-147324-0		44	27.69 [1.090]	14.68 [.578]	13.72 [.540]	25.91 [1.020]	30.35 [1.195]	22.86 [.900]	9	10	5-147324-9		44	25.15 [.990]	13.41 [.528]	12.45 [.490]	23.37 [.920]	27.81 [1.095]	20.32 [.800]	8	9	5-147324-8		44	22.61 [.890]	12.14 [.478]	11.18 [.440]	20.83 [.820]	25.27 [.995]	17.78 [.700]	7	8	5-147324-7		44	20.07 [.790]	10.87 [.428]	9.91 [.390]	18.29 [720]	22.73 [.895]	15.24 [.600]	6	7	5-147324-6		44	17.53 [.690]	9.60 [.378]	8.64 [.340]	15.75 [.620]	20.19 [.795]	12.70 [.500]	5	6	5-147324-5		32	14.99 [.590]	8.33 [.328]	7.37 [.290]	13.21 [.520]	17.65 [.695]	10.16 [.400]	4	5	5-147324-4		24	12.45 [.490]	7.06 [.278]	6.10 [.240]	10.67 [.420]	15.11 [.595]	7.62 [.300]	3	4	5-147324-3		24	9.91 [.390]	5.79 [.228]	4.83 [.190]	8.13 [.320]	12.57 [.495]	5.08 [.200]	2	3	5-147324-2		24	7.37 [.290]	4.52 [.178]	3.56 [.140]	5.59 [.220]	10.03 [.395]	2.54 [.100]	1	2	5-147324-1	PLATING	EIA 481 TAPE WIDTH mm	G	F	E	D	C	B	A	NO OF POSN	PART NUMBER
	88	65.79 [2.590]	33.73 [1.328]	32.77 [1.290]	64.01 [2.520]	68.45 [2.695]	60.96 [2.400]	24	25	7-147324-4																																																																																																																																																																																																																																																																																											
	88	63.25 [2.490]	32.46 [1.278]	31.50 [1.240]	61.47 [2.420]	65.91 [2.595]	58.42 [2.300]	23	24	7-147324-3																																																																																																																																																																																																																																																																																											
	88	60.71 [2.390]	31.19 [1.228]	30.23 [1.190]	58.93 [2.320]	63.37 [2.495]	55.88 [2.200]	22	23	7-147324-2																																																																																																																																																																																																																																																																																											
	88	58.17 [2.290]	29.92 [1.178]	28.96 [1.140]	56.39 [2.220]	60.83 [2.395]	53.34 [2.100]	21	22	7-147324-1																																																																																																																																																																																																																																																																																											
	88	55.63 [2.190]	28.65 [1.128]	27.69 [1.090]	53.85 [2.120]	58.29 [2.295]	50.80 [2.000]	20	21	7-147324-0																																																																																																																																																																																																																																																																																											
	72	53.09 [2.090]	27.38 [1.078]	26.42 [1.040]	51.31 [2.020]	55.75 [2.195]	48.26 [1.900]	19	20	6-147324-9																																																																																																																																																																																																																																																																																											
	72	50.55 [1.990]	26.11 [1.028]	25.15 [.990]	48.77 [1.920]	53.21 [2.095]	45.72 [1.800]	18	19	6-147324-8																																																																																																																																																																																																																																																																																											
	72	48.01 [1.890]	24.84 [.978]	23.88 [.940]	46.23 [1.820]	50.67 [1.995]	43.18 [1.700]	17	18	6-147324-7																																																																																																																																																																																																																																																																																											
	72	45.47 [1.790]	23.57 [.928]	22.61 [.890]	43.69 [1.720]	48.13 [1.895]	40.64 [1.600]	16	17	6-147324-6																																																																																																																																																																																																																																																																																											
	72	42.93 [1.690]	22.30 [.878]	21.34 [.840]	41.15 [1.620]	45.59 [1.795]	38.10 [1.500]	15	16	6-147324-5																																																																																																																																																																																																																																																																																											
	72	40.39 [1.590]	21.03 [.828]	20.07 [.790]	38.61 [1.520]	43.05 [1.695]	35.56 [1.400]	14	15	6-147324-4																																																																																																																																																																																																																																																																																											
	56	37.85 [1.490]	19.76 [.778]	18.80 [.740]	36.07 [1.420]	40.51 [1.595]	33.02 [1.300]	13	14	6-147324-3																																																																																																																																																																																																																																																																																											
	56	35.31 [1.390]	18.49 [.728]	17.53 [.690]	33.53 [1.320]	37.97 [1.495]	30.48 [1.200]	12	13	6-147324-2																																																																																																																																																																																																																																																																																											
	56	32.77 [1.290]	17.22 [.678]	16.26 [.640]	30.99 [1.220]	35.43 [1.395]	27.94 [1.100]	11	12	6-147324-1																																																																																																																																																																																																																																																																																											
	56	30.23 [1.190]	15.95 [.628]	14.99 [.590]	28.45 [1.120]	32.89 [1.295]	25.40 [1.000]	10	11	6-147324-0																																																																																																																																																																																																																																																																																											
	44	27.69 [1.090]	14.68 [.578]	13.72 [.540]	25.91 [1.020]	30.35 [1.195]	22.86 [.900]	9	10	5-147324-9																																																																																																																																																																																																																																																																																											
	44	25.15 [.990]	13.41 [.528]	12.45 [.490]	23.37 [.920]	27.81 [1.095]	20.32 [.800]	8	9	5-147324-8																																																																																																																																																																																																																																																																																											
	44	22.61 [.890]	12.14 [.478]	11.18 [.440]	20.83 [.820]	25.27 [.995]	17.78 [.700]	7	8	5-147324-7																																																																																																																																																																																																																																																																																											
	44	20.07 [.790]	10.87 [.428]	9.91 [.390]	18.29 [720]	22.73 [.895]	15.24 [.600]	6	7	5-147324-6																																																																																																																																																																																																																																																																																											
	44	17.53 [.690]	9.60 [.378]	8.64 [.340]	15.75 [.620]	20.19 [.795]	12.70 [.500]	5	6	5-147324-5																																																																																																																																																																																																																																																																																											
	32	14.99 [.590]	8.33 [.328]	7.37 [.290]	13.21 [.520]	17.65 [.695]	10.16 [.400]	4	5	5-147324-4																																																																																																																																																																																																																																																																																											
	24	12.45 [.490]	7.06 [.278]	6.10 [.240]	10.67 [.420]	15.11 [.595]	7.62 [.300]	3	4	5-147324-3																																																																																																																																																																																																																																																																																											
	24	9.91 [.390]	5.79 [.228]	4.83 [.190]	8.13 [.320]	12.57 [.495]	5.08 [.200]	2	3	5-147324-2																																																																																																																																																																																																																																																																																											
	24	7.37 [.290]	4.52 [.178]	3.56 [.140]	5.59 [.220]	10.03 [.395]	2.54 [.100]	1	2	5-147324-1																																																																																																																																																																																																																																																																																											
PLATING	EIA 481 TAPE WIDTH mm	G	F	E	D	C	B	A	NO OF POSN	PART NUMBER																																																																																																																																																																																																																																																																																											
<table><tr><td colspan="10">THIS DRAWING IS A CONTROLLED DOCUMENT.</td><td colspan="2">DWN B. HAYMAKER 02DEC99</td><td colspan="7"> TE Connectivity Ltd.</td></tr><tr><td colspan="5">DIMENSIONS: mm [INCHES]</td><td colspan="5">TOLERANCES UNLESS OTHERWISE SPECIFIED:</td><td colspan="2">CHK J. MOSIER 02DEC99</td><td colspan="7">APVD J. MOSIER 02DEC99</td></tr><tr><td colspan="5" rowspan="4"></td><td colspan="5">0. PLC ± —</td><td colspan="7">NAME</td></tr><tr><td colspan="5">1. PLC ± —</td><td colspan="7">PRODUCT SPEC</td></tr><tr><td colspan="5">2. PLC ± —</td><td colspan="7">108-25034</td></tr><tr><td colspan="5">3. PLC ± 0.13 [.005]</td><td colspan="7">APPLICATION SPEC</td></tr><tr><td colspan="5" rowspan="2"></td><td colspan="5">4. PLC ± —</td><td colspan="2">—</td><td colspan="7">SIZE</td></tr><tr><td colspan="5">ANGLES</td><td colspan="2">—</td><td colspan="7">CAGE CODE</td></tr><tr><td colspan="5">MATERIAL</td><td colspan="5">FINISH</td><td colspan="2">WEIGHT</td><td colspan="7">DRAWING NO</td></tr><tr><td colspan="5"></td><td colspan="5">SEE TABLE</td><td colspan="2">—</td><td colspan="7">A100779147324</td></tr><tr><td colspan="10">CUSTOMER DRAWING</td><td colspan="2">SCALE 1:1</td><td colspan="2">SHEET 4 OF 4</td><td colspan="5">REV L</td></tr></table>																			THIS DRAWING IS A CONTROLLED DOCUMENT.										DWN B. HAYMAKER 02DEC99		TE Connectivity Ltd.							DIMENSIONS: mm [INCHES]					TOLERANCES UNLESS OTHERWISE SPECIFIED:					CHK J. MOSIER 02DEC99		APVD J. MOSIER 02DEC99												0. PLC ± —					NAME							1. PLC ± —					PRODUCT SPEC							2. PLC ± —					108-25034							3. PLC ± 0.13 [.005]					APPLICATION SPEC												4. PLC ± —					—		SIZE							ANGLES					—		CAGE CODE							MATERIAL					FINISH					WEIGHT		DRAWING NO												SEE TABLE					—		A100779147324							CUSTOMER DRAWING										SCALE 1:1		SHEET 4 OF 4		REV L																																																																																																		
THIS DRAWING IS A CONTROLLED DOCUMENT.										DWN B. HAYMAKER 02DEC99		TE Connectivity Ltd.																																																																																																																																																																																																																																																																																									
DIMENSIONS: mm [INCHES]					TOLERANCES UNLESS OTHERWISE SPECIFIED:					CHK J. MOSIER 02DEC99		APVD J. MOSIER 02DEC99																																																																																																																																																																																																																																																																																									
					0. PLC ± —					NAME																																																																																																																																																																																																																																																																																											
					1. PLC ± —					PRODUCT SPEC																																																																																																																																																																																																																																																																																											
					2. PLC ± —					108-25034																																																																																																																																																																																																																																																																																											
					3. PLC ± 0.13 [.005]					APPLICATION SPEC																																																																																																																																																																																																																																																																																											
					4. PLC ± —					—		SIZE																																																																																																																																																																																																																																																																																									
					ANGLES					—		CAGE CODE																																																																																																																																																																																																																																																																																									
MATERIAL					FINISH					WEIGHT		DRAWING NO																																																																																																																																																																																																																																																																																									
					SEE TABLE					—		A100779147324																																																																																																																																																																																																																																																																																									
CUSTOMER DRAWING										SCALE 1:1		SHEET 4 OF 4		REV L																																																																																																																																																																																																																																																																																							

Mouser Electronics

Authorized Distributor

Click to View Pricing, Inventory, Delivery & Lifecycle Information:

[TE Connectivity:](#)

[2-147324-0](#)