

| LOC |    | DIST |     | REVISIONS                 |         |     |      |  |
|-----|----|------|-----|---------------------------|---------|-----|------|--|
| CM  | 00 | P    | LTR | DESCRIPTION               | DATE    | DWN | APVD |  |
|     |    | C    |     | REVISED PER ECO-08-017244 | 14JUL08 | HMR | DB   |  |
|     |    | D    |     | ECR-13-014450             | 12OCT13 | MT  | DZ   |  |

D

C

B

A

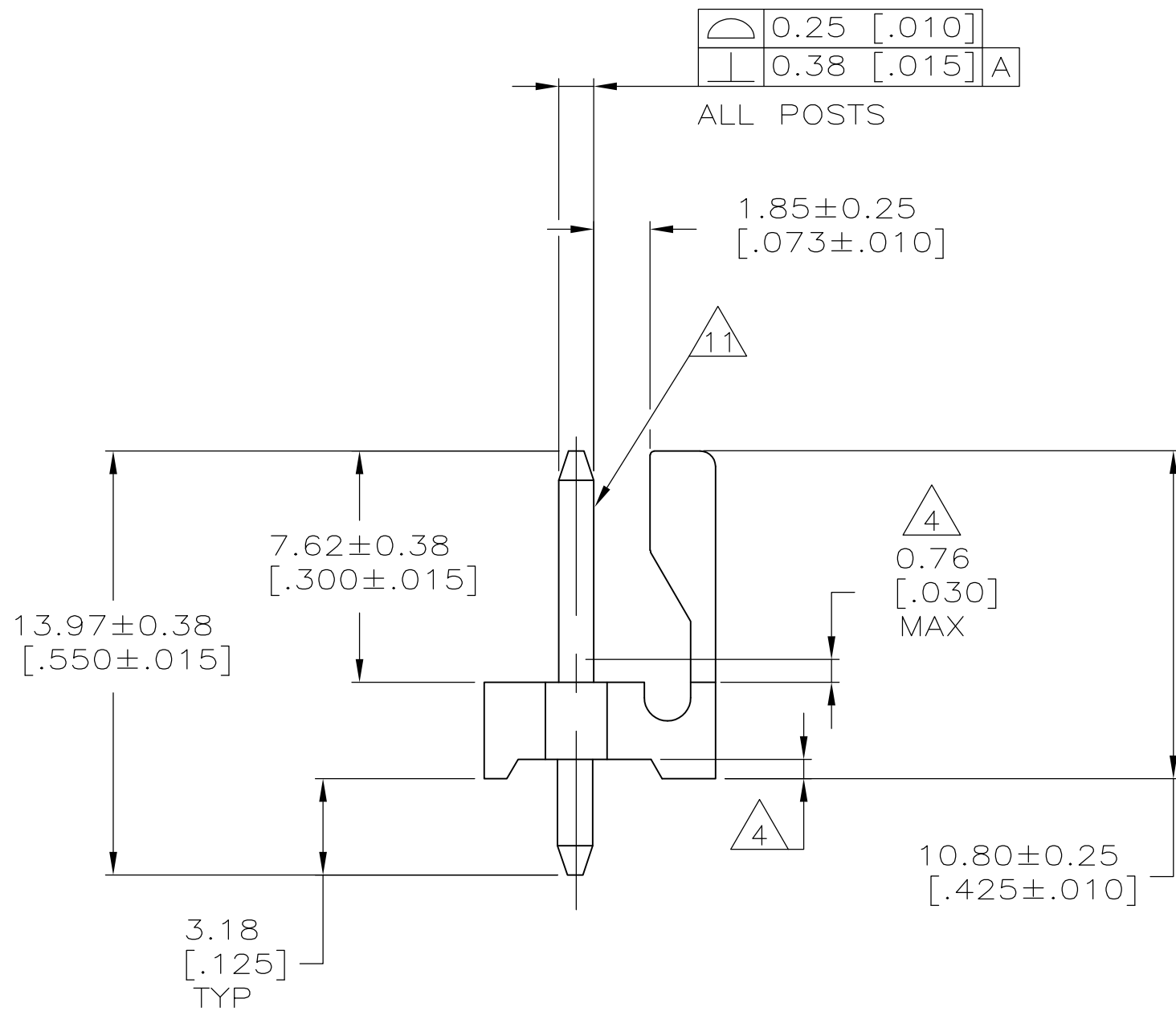
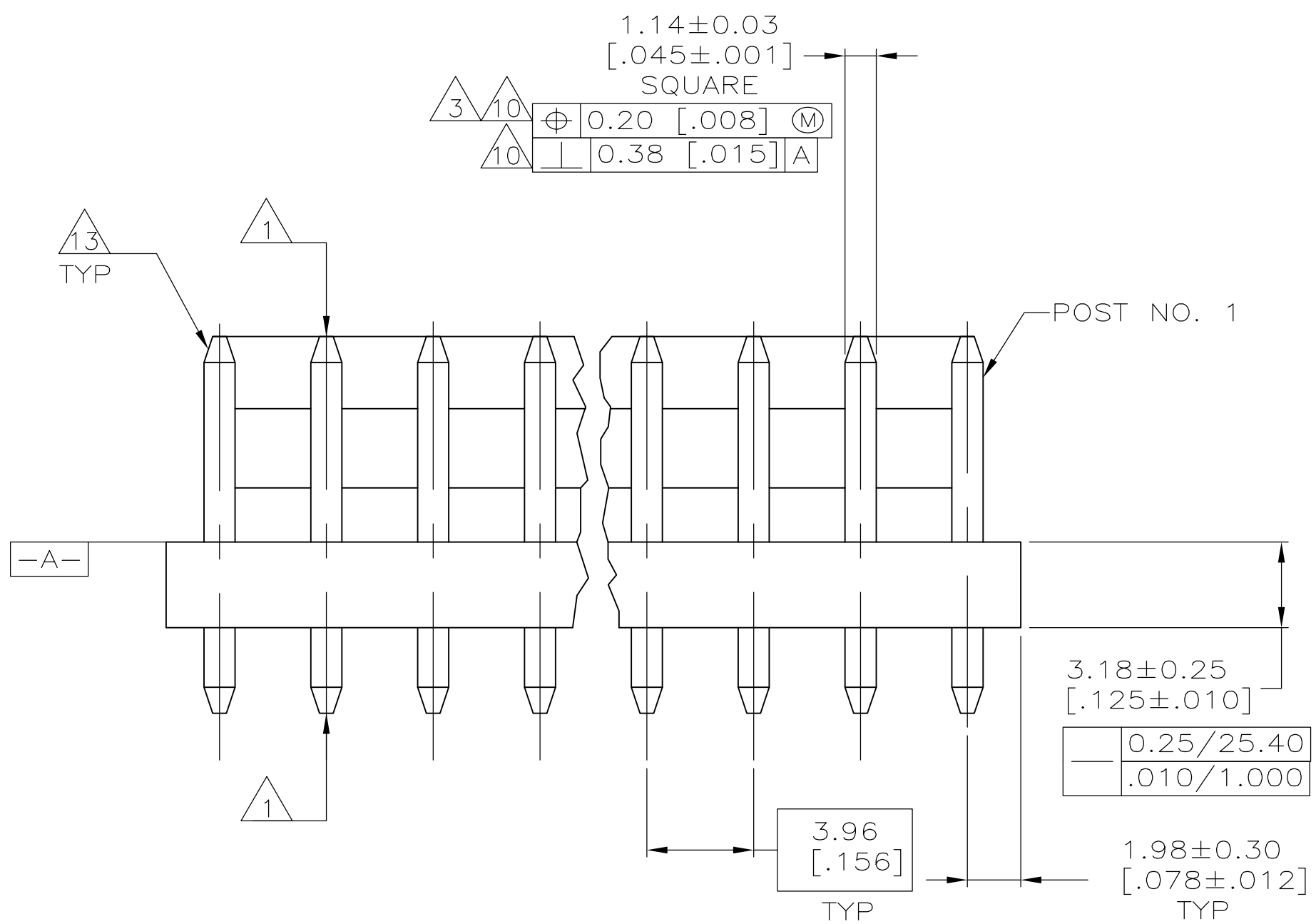
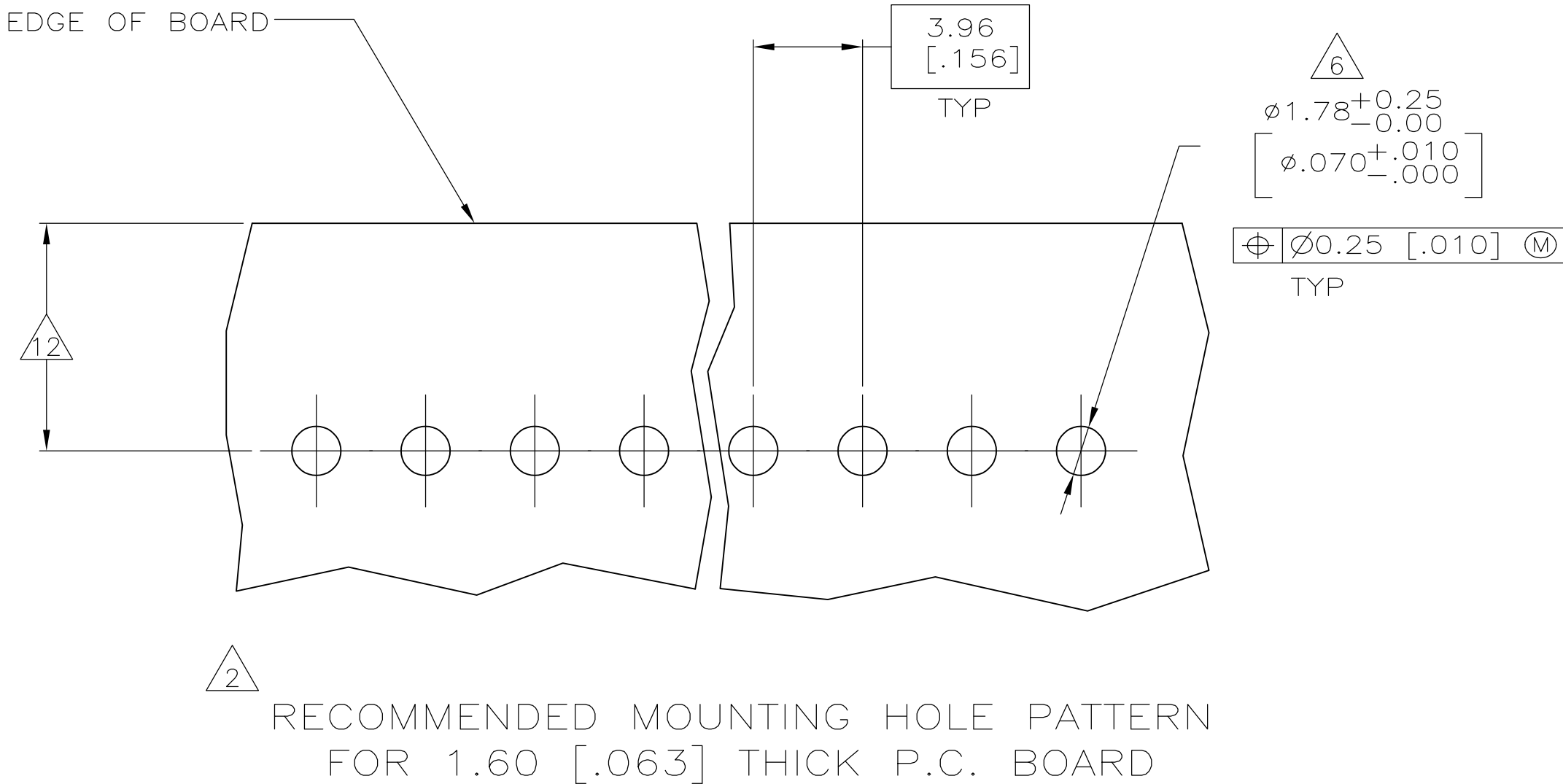
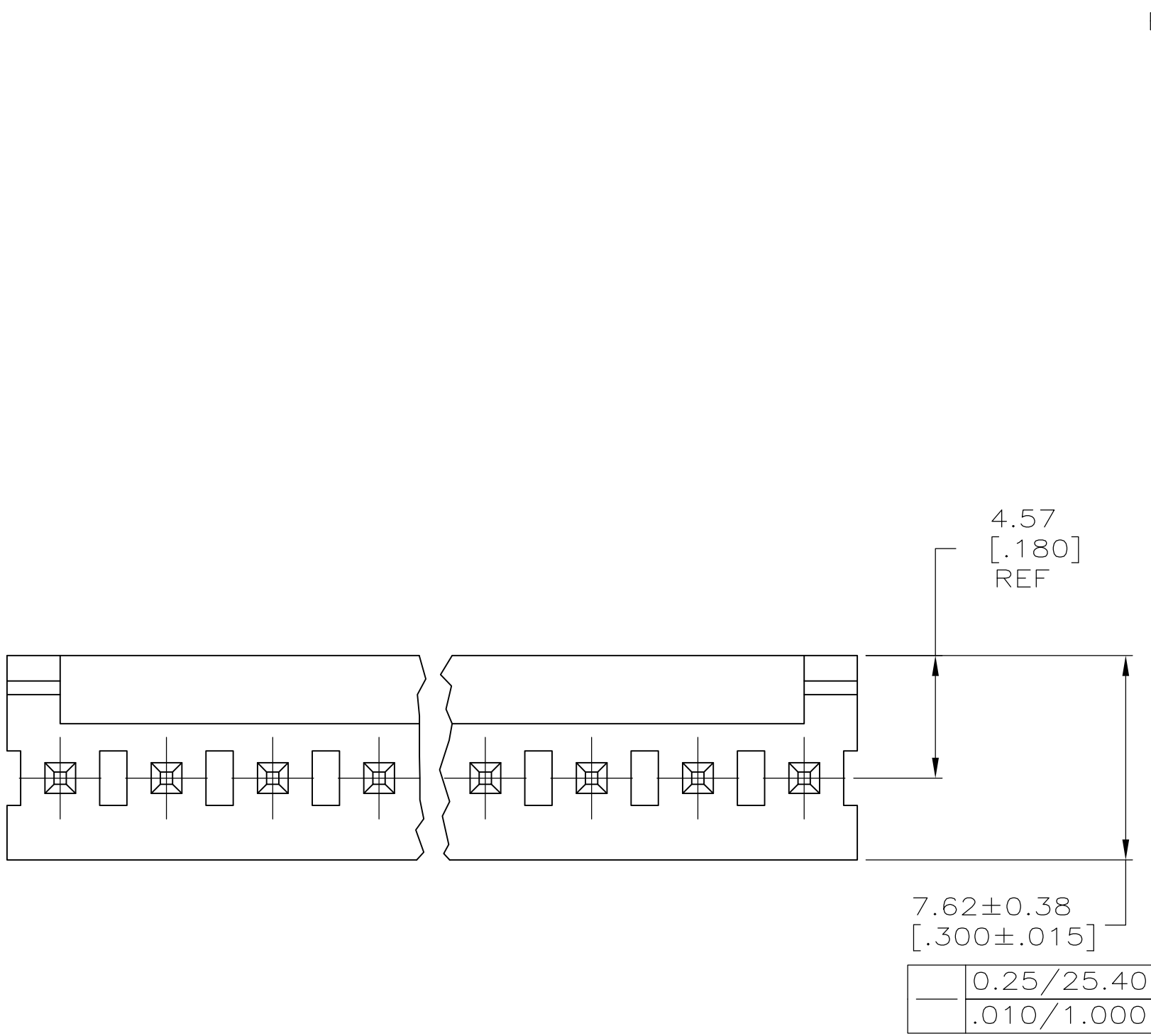

- 1 POST TO WITHSTAND 13 NEWTONS (3 LBS) MINIMUM AXIAL FORCE IN BOTH DIRECTIONS SHOWN WITHOUT DISLODGING.
- 2 TOLERANCES APPLY TO SOLDER SIDE OF BOARD.
- 3 MEASURED AT SURFACE
- 4 PLASTIC FLASH PERMITTED IN THIS AREA.
- 5 PARTS COMPLY WITH AMP SOLDERABILITY SPEC. NO. 109-11-2.
- 6 ONE HOLE MAY BE UNDERSIZED 1.65-1.52 [.065-.060] DIA. FOR ASSEMBLY RETENTION DURING WAVE SOLDERING.
- 7 MATERIAL: HEADER-THERMOPLASTIC POLYESTER GLASS-FILLED 94V-0 (NATURAL) POST-COPPER ALLOY (TIN PLATED) PLATING-ITEMS MARKED CONTAINS MATTIE TIN ITEMS MARKED LEAD FREE-MATTE TIN
- 8 COORDINATE DIMENSION APPLIES FROM CENTER OF ACTUAL FEATURE.
- 9 PLASTIC BURRS CAUSED BY CUT-OFF TOOLING ARE PERMITTED WITHIN THE MAXIMUM TOLERANCE ENVELOPE.
- 10 POST TO BE MEASURED WHEN STRIP IS HELD FLAT.
- 11 POST MUST WITHSTAND TWO 90° BENDS AGAINST EXTRUSION WITHOUT BREAKING.
- 12 DIMENSION SHOULD BE 4.45 [.175] MIN WHEN MATING WITH A MTA-156 CONNECTOR ASSEMBLY OR A SL-156 CONNECTOR ASSEMBLY.
- 13 PIN BURR OF 0.13 [.005] MAXIMUM VERTICAL AND 0.08 [.003] MAXIMUM HORIZONTAL PERMITTED AT POST TIPS ON BOTH ENDS.

|           |              |            |            |
|-----------|--------------|------------|------------|
| LEAD FREE |              |            |            |
|           | 23.77 [.936] | 6          | 3-644998-6 |
|           |              |            |            |
|           |              |            |            |
|           |              |            |            |
|           | DIM (L)      | NO.OF POSN | ASSEMBLY   |

|           |              |            |          |
|-----------|--------------|------------|----------|
| LEAD FREE |              |            |          |
|           | 23.77 [.936] | 6          | 644998-6 |
|           |              |            |          |
|           |              |            |          |
|           |              |            |          |
|           | DIM (L)      | NO.OF POSN | ASSEMBLY |

|  |  |                       |   |  |
|--|--|-----------------------|---|--|
| THIS DRAWING IS A CONTROLLED DOCUMENT. |  | DWN S. HOOVER 07NOV02 | Tyco Electronics Corporation<br>Harriaburg, PA 17105-3608                               |  |
| DIMENSIONS: mm [INCHES]                |  | CHK D. BOSSI 07NOV02  |   |  |
| TOLERANCES UNLESS OTHERWISE SPECIFIED: |  | APVD D. BOSSI 07NOV02 | NAME  |  |
| 0. PLC ± .01                           |  | PRODUCT SPEC          | MTA-156 HEADER ASSEMBLY, FRICTION LOCK, STRAIGHT, .045 SQUARE POST, TIN PLATED, SPECIAL |  |
| 1. PLC ± .01                           |  | APPLICATION SPEC      | SIZE  |  |
| 2. PLC ± .01                           |  | WEIGHT                | CAGE CODE   |  |
| 3. PLC ± .01                           |  | CUSTOMER DRAWING      | DRAWING NO  |  |
| 4. PLC ± .01                           |  | SCALE 5:1             | SHEET 1 OF 1  |  |
| ANGLES ± .01                           |  | REV D                 |   |  |
| FINISH                                 |  |                       |   |  |

METRIC

# Mouser Electronics

Authorized Distributor

Click to View Pricing, Inventory, Delivery & Lifecycle Information:

[TE Connectivity:](#)

[3-644998-6](#)