

LOC	DIST	P	F	REVISIONS				DATE	APPD
				ZONE	LTR	DESCRIPTION			
G	86				B	ECR-17-006035		02JUN17	M✓

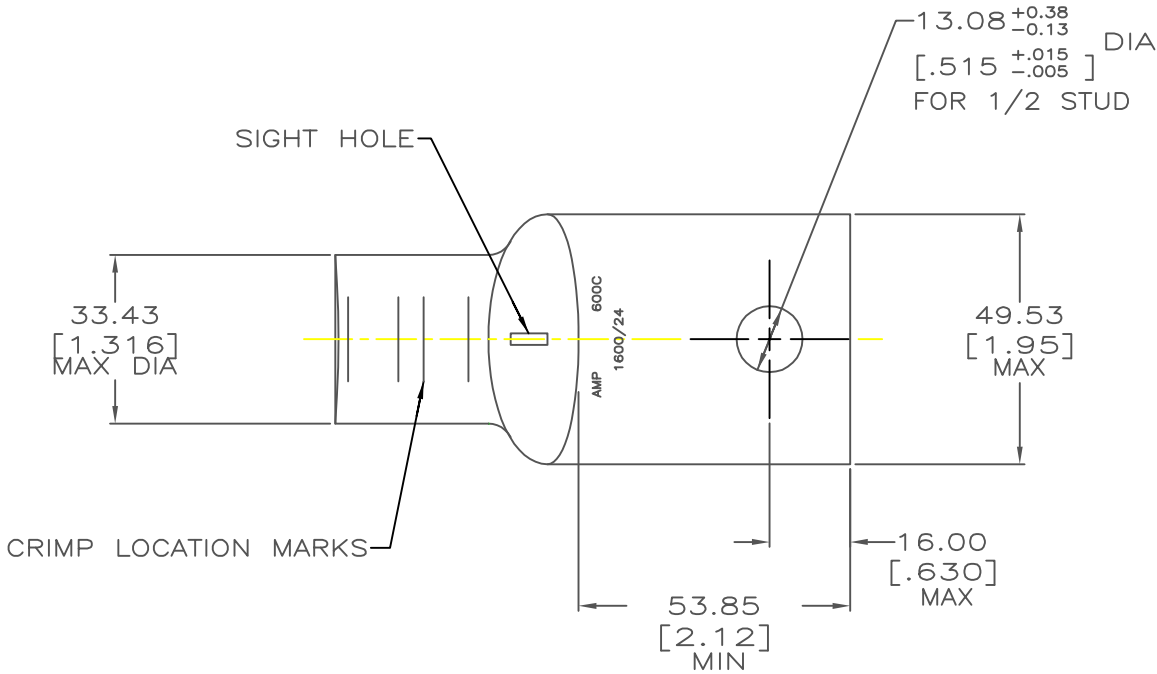

1 CIRCULAR MIL RANGE: 550-650 MCM

55842

					PART NO		
DO NOT SCALE PRINT. UNLESS SPECIFIED DIMENSIONS IN mm [INCHES] TOLERANCES ON : 2 PLC DEC ± 0.50[.020] 3 PLC DEC ± - ANGLES ± -	DR 7/21/92 DK SCHRUM		<div>AMP</div> <div>AMP Incorporated Harrisburg, PA 17105-3608</div>				
	CHK 7/21/92 AJ KAUFMAN						
	APPD 7/21/92 WJ VOCKROTH						
	APPD 7/21/92 CR RHOADS						
MATERIAL COPPER ASTM B-75 ANNEALED		PRODUCT SPEC -		NAME TERMINAL, RECTANGULAR TONGUE, AMPOWER, WIRE SIZE: 304.0mm[600] MCM			
FINISH TIN PLATE 0.00254[.000100] MIN THK PER MIL-T-10727		APPLICATION SPEC -					
WEIGHT -		SCALE 1:1				SHEET 10F 1	

Mouser Electronics

Authorized Distributor

Click to View Pricing, Inventory, Delivery & Lifecycle Information:

[TE Connectivity:](#)

[55842-1](#)