

P	LTR	DESCRIPTION	DATE	DWN	APVD
	F	REV PER 063A-0485-01	21AUG01	JR	MS

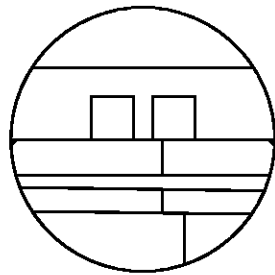
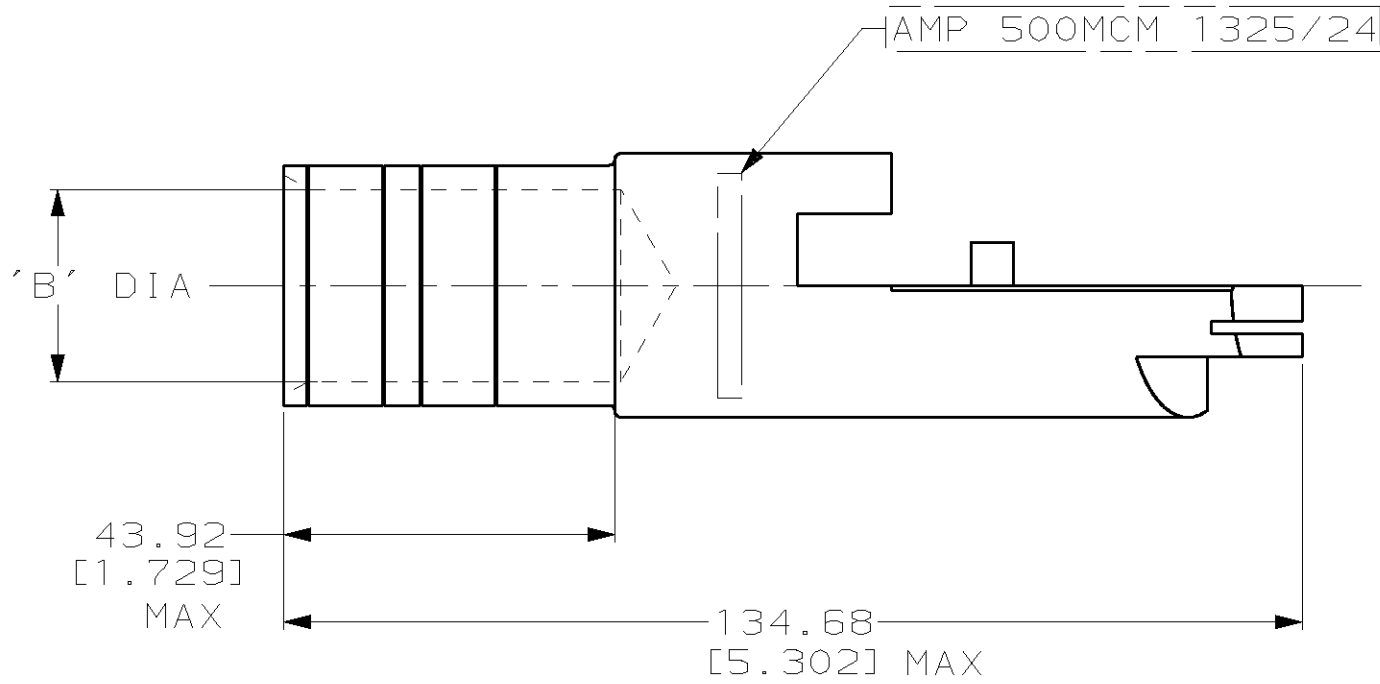
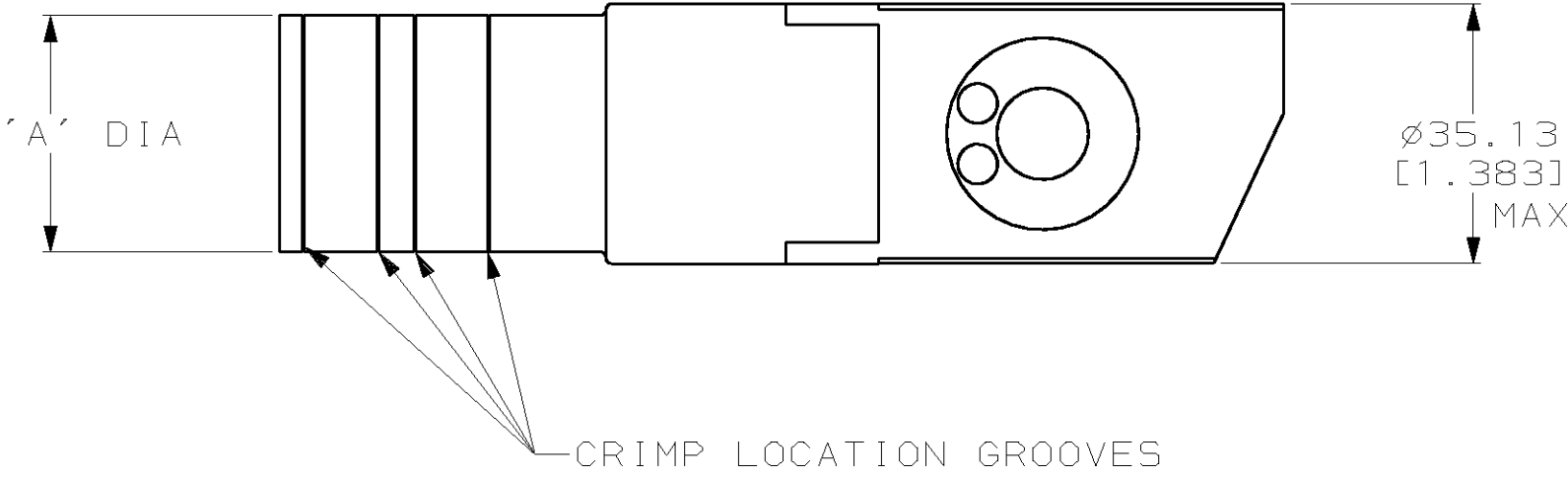

26.92-26.67 [1.060-1.050]	33.66-33.40 [1.325-1.315]	53435-2
25.53-25.40 [1.005-1.000]	32.00-31.75 [1.260-1.250]	53435-1
'B'	'A'	AMP PART NUMBER

THIS DRAWING IS A CONTROLLED DOCUMENT FOR AMP INCORPORATED. IT IS SUBJECT TO CHANGE AND THE CONTROLLING ENGINEERING ORGANIZATION SHOULD BE CONTACTED FOR THE LATEST REVISION.		DWN DK SCHRUM 17JUN96	AMP AMP Incorporated Harrisburg, PA 17105-3608		
DIMENSIONS: mm [INCHES]		CHK WJ VOCKROTH 25JUN96			
		APVD JL MECKLEY 25JUN96	NAME TERMINAL ASSEMBLY, QUICK-DISCONNECT, AMPOWER, WIRE SIZE: 500 MCM		
		PRODUCT SPEC 108-13014	SIZE A2		
MATERIAL BODY & PINS BRASS PER QQ-B-626		TOLERANCES UNLESS OTHERWISE SPECIFIED: 0 PLC ±- 1 PLC ±- 2 PLC ±0.20 [1.008] 3 PLC ±- 4 PLC ±- ANGLES ±- FINISH SILVER PL 0.00127 [1.000050] MIN THK PER QQ-S-365	APPLICATION SPEC -	CAGE CODE 00779	DRAWING NO C-53435
CUSTOMER DRAWING			WEIGHT - lbs	SCALE 1:1	SHEET 1 OF 1
				REV F	

Mouser Electronics

Authorized Distributor

Click to View Pricing, Inventory, Delivery & Lifecycle Information:

[TE Connectivity:](#)

[53435-2](#)