

LOC		DIST		REVISIONS			
P	LTR	DESCRIPTION		DATE	DWN	APVD	
F		ECR-09-005692		13APR2009	JS	JH	
G		ECR-09-011290		08JUN2009	JS	JH	
H		ECR-10-013410		28JUN2010	JS	DB	

CERTIFICATION: UL/CUL FILE NO. E102980 HZ. 50/60 V. A. 6  
DIMENSIONS FOR REFERENCE ONLY.

PRIMARY	SECONDARY		P.U. PART NUMBER	TYCO ELECTRONICS PART NUMBER
	SERIES	PARALLEL		
115 VAC	10 VCT	5 VAC	4900-8010RC62	3-1672209-7
115 VAC	16 VCT	8 VAC	4900-8016RC62	4-1672209-0
115 VAC	20 VCT	10 VAC	4900-8020RC62	4-1672209-1
115 VAC	24 VCT	12 VAC	4900-8024RC62	4-1672209-2
115 VAC	28 VCT	14 VAC	4900-8028RC62	4-1672209-3
115 VAC	36 VCT	18 VAC	4900-8036RC62	4-1672209-5
115 VAC	120 VCT	60 VAC	4900-8120RC62	4-1672209-8
115/230 VAC	10 VCT	5 VAC	4900-9010RC62	4-1672209-9
115/230 VAC	16 VCT	8 VAC	4900-9016RC62	5-1672209-2
115/230 VAC	20 VCT	10 VAC	4900-9020RC62	5-1672209-3
115/230 VAC	24 VCT	12 VAC	4900-9024RC62	5-1672209-4
115/230 VAC	28 VCT	14 VAC	4900-9028RC62	5-1672209-5
115/230 VAC	36 VCT	18 VAC	4900-9036RC62	5-1672209-7
115/230 VAC	120 VCT	60 VAC	4900-9120RC62	6-1672209-0

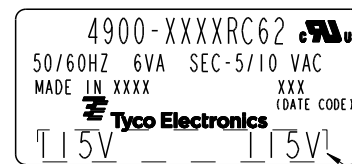
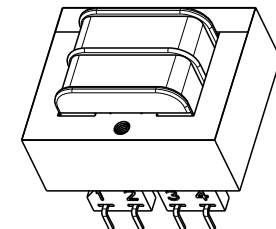
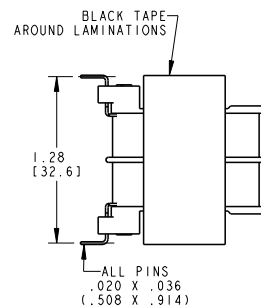

SAMPLE LABEL SCALE 4:1

VOLTAGE ON LABEL WILL VARY PER MODEL NUMBER

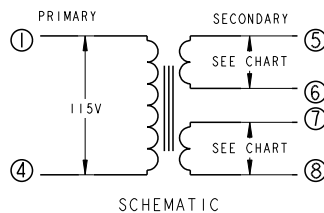
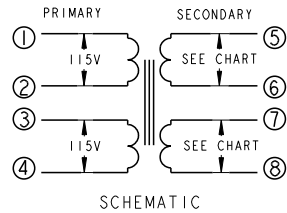
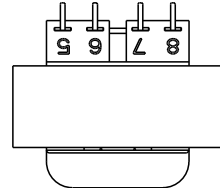
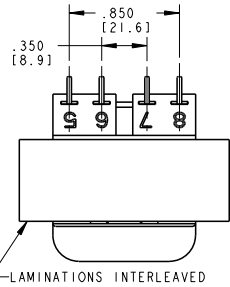
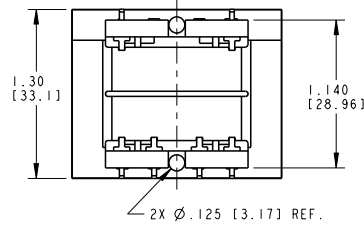
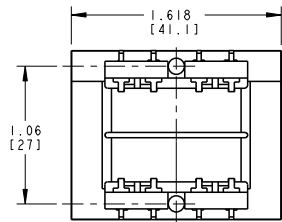
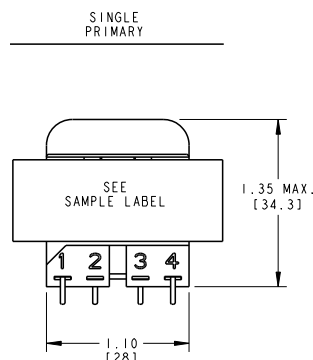
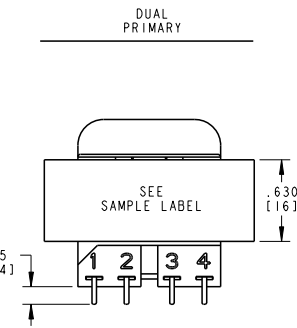

THIS DRAWING IS A CONTROLLED DOCUMENT FOR TYCO ELECTRONICS CORPORATION. IT IS SUBJECT TO THE COMPANY'S POLICY ON THE RELEASE OF INFORMATION. IT SHOULD BE CONTROLLED FOR THE LATEST REVISION.		DWN J. SLIKE 17AUG2007 CHK D. HAGGARD 17AUG2007 APVD J. HURLBURY 17AUG2007		Tyco Electronics Harrisburg, PA 17105-3608	
DIMENSIONS: INCHES [mm]		TOLERANCES UNLESS OTHERWISE SPECIFIED:		NAME	
0 PLC ±		0 PLC ±		PRODUCT SPEC	
1 PLC ±		1 PLC ±		APPLICATION SPEC	
2 PLC ±.01		2 PLC ±.01		WEIGHT	
3 PLC ±.005		3 PLC ±.005		CUSTOMER DRAWING	
4 PLC ±		4 PLC ±		SCALE 3:2	
ANGLES		FINISH		SHEET 1 OF 1	
MATERIAL		FINISH		REV H	

# Mouser Electronics

Authorized Distributor

Click to View Pricing, Inventory, Delivery & Lifecycle Information:

[TE Connectivity:](#)

[4900-9020RC62](#)