

LOC	DIST	REVISIONS					
		P	LTR	DESCRIPTION	DATE	DWN	APVD
AD	00		Z2	REVISED PER ECO-11-004587	11MAR11	RK	HMR

1. FOR ADDITIONAL SPECIFICATIONS SEE AMP PRODUCT SPEC 108-7519.
2. SWITCH HAS MAKE-BEFORE-BREAK OPERATION.
3. ALL CHARACTERS AND ROCKERS ARE WHITE, HOUSING IS BLACK.
4. STAMPING WILL VARY ON 2 POSITION SIDES DUE TO SPACE RESTRICTIONS.
5. .315 DIMENSION APPLIES AT TERMINAL TIPS. TERMINALS ARE .300 $\begin{smallmatrix} +.010 \\ -.000 \end{smallmatrix}$ AT MOUNTING SURFACE.
6. SWITCH POSITIONS ARE CLOSED WHEN ROCKERS ARE DOWN TOWARD DOTS.
7. ALL MATERIALS AND FINISHES SHALL COMPLY WITH EU DIRECTIVE 2002/95/EC OF 27JAN2003 (ROHS).
8. OBSOLETE PARTS: OBSOLETE CIS STREAMLINING PER D.RENAUD/D.SINISI

OBSOLETE 8	FIG 1	FIG 3	.48	DPDT	4	8-435470-1	8
	-FIG 1	AS SHOWN	1.28	SPDT	12	7-435470-6	8
	-FIG 1	AS SHOWN	1.08	SPDT	10	7-435470-5	8
	-FIG 1	AS SHOWN	.88	SPDT	8	7-435470-4	8
	-FIG 1	AS SHOWN	.48	SPDT	4	7-435470-2	8
OBSOLETE 8	FIG 1	FIG 4	.28	SPDT	2	7-435470-1	8
	AS SHOWN	FIG 2	.88	DPDT	8	5-435470-9	8
	AS SHOWN	FIG 4	.28	SPDT	2	5-435470-7	8
	AS SHOWN	FIG 3	.48	DPDT	4	5-435470-5	8
	AS SHOWN	AS SHOWN	.88	SPDT	8	5-435470-3	8
OBSOLETE 8	AS SHOWN	AS SHOWN	.68	SPDT	6	5-435470-2	8
	AS SHOWN	AS SHOWN	.48	SPDT	4	5-435470-1	8
	FIG 1	FIG 2	1.28	DPDT	12	3-435470-3	8
	FIG 1	FIG 2	.88	DPDT	8	3-435470-2	8
	FIG 1	FIG 3	.48	DPDT	4	3-435470-1	8
OBSOLETE 8	FIG 1	NONE	.88	SPDT	8	2-435470-7	8
	-FIG 1	AS SHOWN	1.28	SPDT	12	2-435470-6	8
	-FIG 1	AS SHOWN	1.08	SPDT	10	2-435470-5	8
	FIG 1	AS SHOWN	.88	SPDT	8	2-435470-4	8
	FIG 1	AS SHOWN	.68	SPDT	6	2-435470-3	8
OBSOLETE 8	-FIG 1	AS SHOWN	.48	SPDT	4	2-435470-2	8
	-FIG 1	FIG 4	.28	SPDT	2	2-435470-1	8
	AS SHOWN	FIG 2	.88	DPDT	8	435470-9	8
	AS SHOWN	AS SHOWN	1.28	SPDT	12	435470-8	8
	AS SHOWN	FIG 4	.28	SPDT	2	435470-7	8
OBSOLETE 8	AS SHOWN	FIG 3	.48	DPDT	4	435470-5	8
	AS SHOWN	AS SHOWN	1.08	SPDT	10	435470-4	8
	AS SHOWN	AS SHOWN	.88	SPDT	8	435470-3	8
	AS SHOWN	AS SHOWN	.68	SPDT	6	435470-2	8
	AS SHOWN	AS SHOWN	.48	SPDT	4	435470-1	8
ACTUATOR			TOP MARKING	A	SWITCH TYPE	NO. OF POSN	PART NO

435470-3 SHOWN

THIS DRAWING IS A CONTROLLED DOCUMENT.		DWN R.TALLEY	15MAR90	TE Connectivity			
DIMENSIONS: INCHES		CHK R.MILLER	27MAR90	NAME			
		APVD H.LEITER	27MAR90	SWITCH ASSY, DIP, TYPE C, 7000 SERIES, SPDT & DPDT			
		PRODUCT SPEC					
		APPLICATION SPEC		SIZE	CAGE CODE	DRAWING NO	RESTRICTED TO
MATERIAL HOUSING & ROCKER: POLYESTER CONTACTS: BERYLLIUM COPPER		FINISH CONTACTS: PLATED .000030 MIN GOLD IN CONTACT AREA OVER .000050 MIN NICKEL	WEIGHT	A2	00779	C=435470	-
CUSTOMER DRAWING				SCALE	4:1	SHEET	1 of 1
						REV	Z2

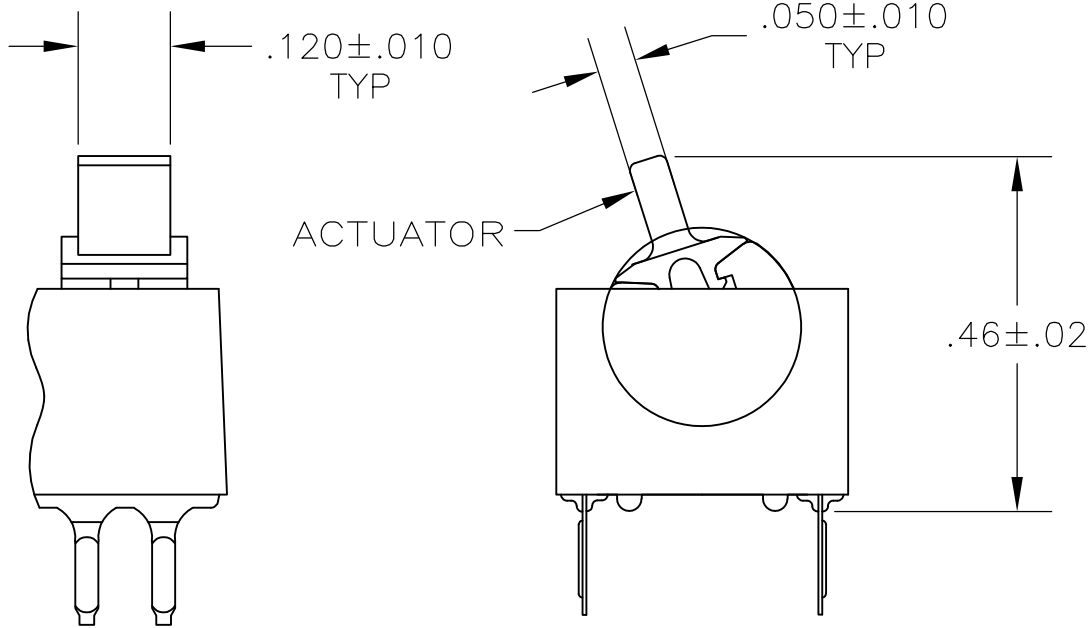
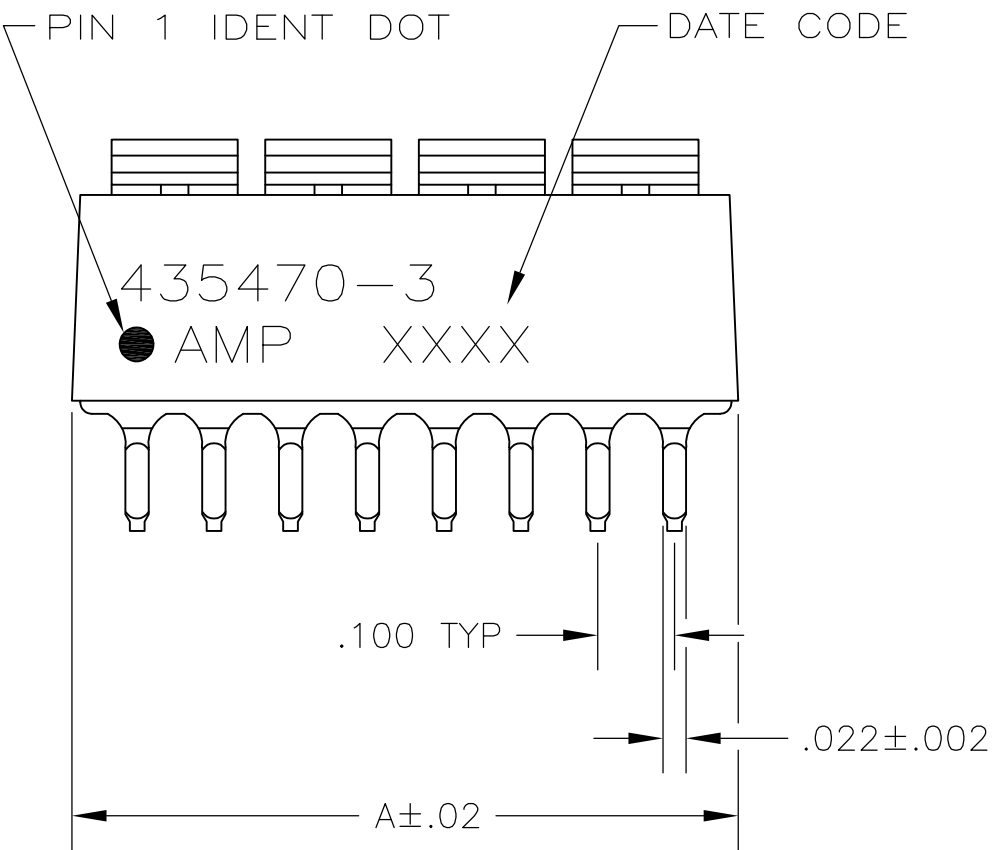
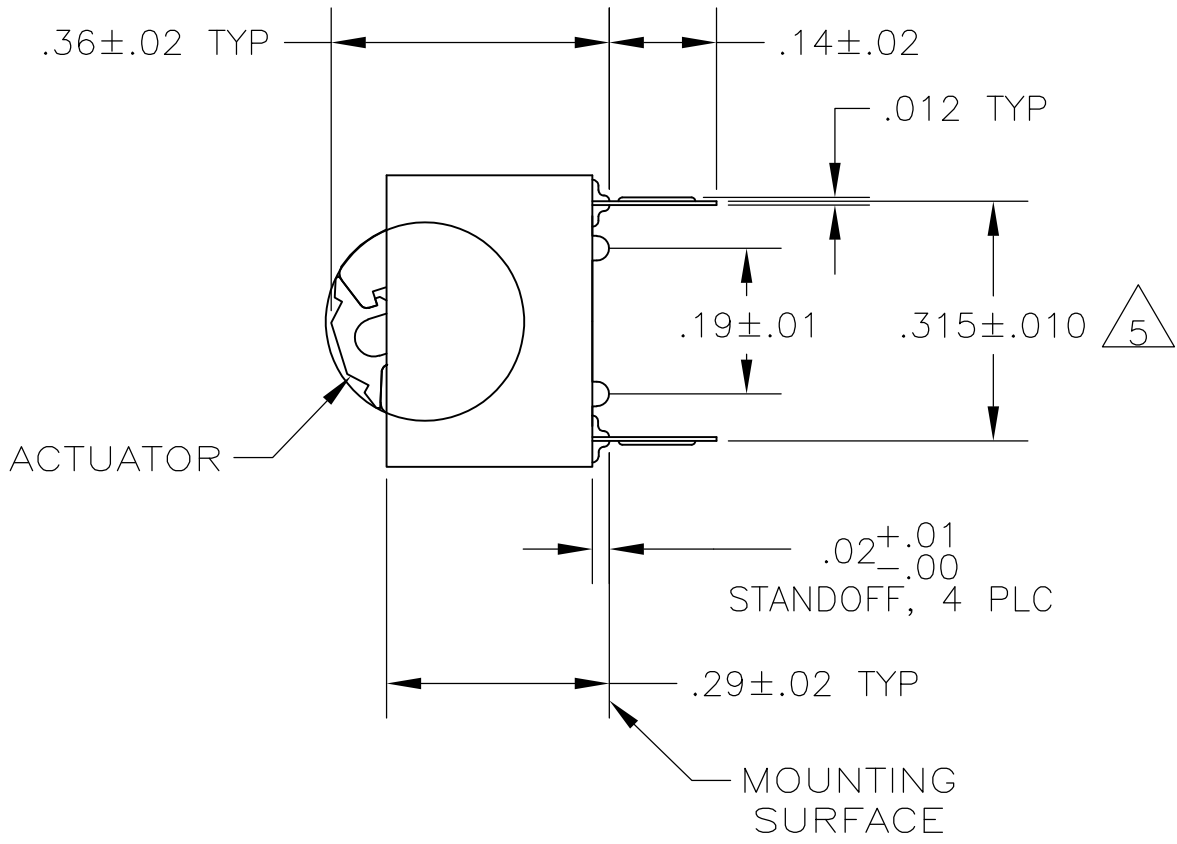
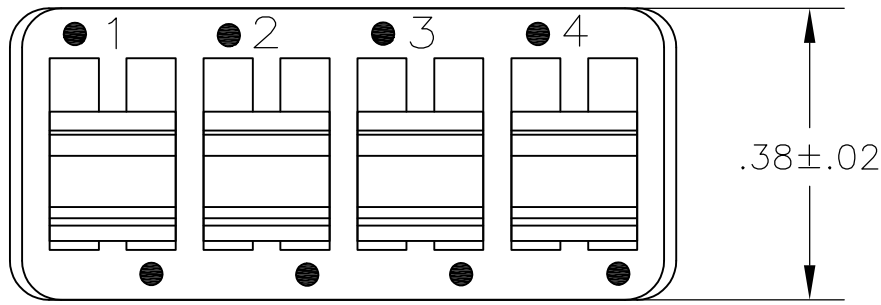

FIGURE 1
LEVER ACTUATOR SHOWN

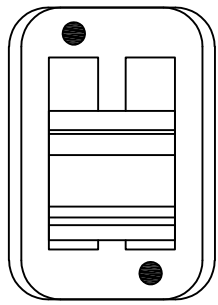
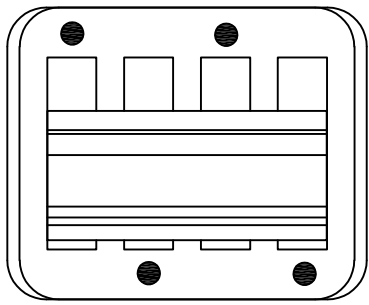
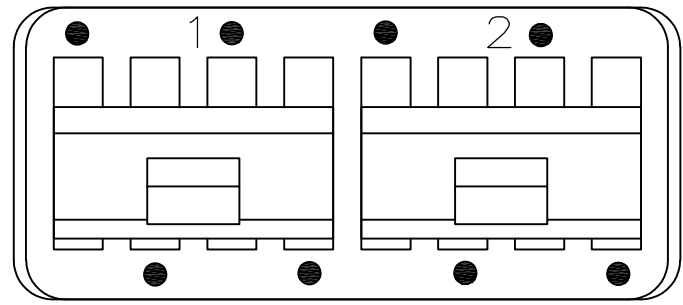
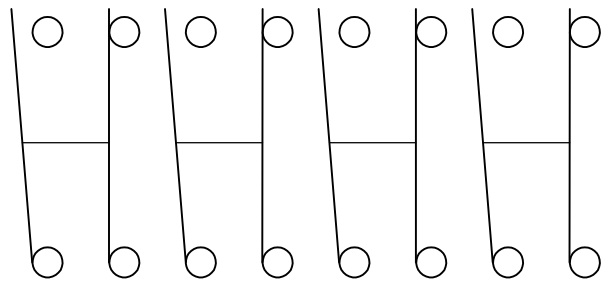

FIGURE 2

FIGURE 3

FIGURE 4



SPDT

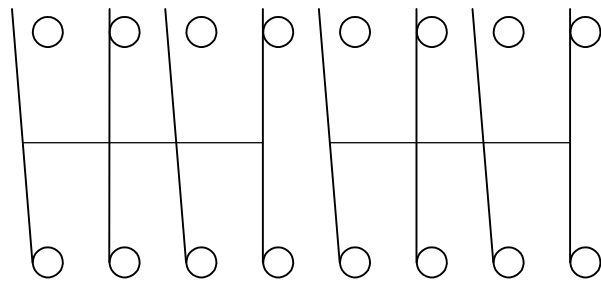

DPDT

CONTACT ARRANGEMENT

Mouser Electronics

Authorized Distributor

Click to View Pricing, Inventory, Delivery & Lifecycle Information:

[TE Connectivity:](#)

[7-435470-2](#)