

4

3

2

1

THIS DRAWING IS UNPUBLISHED.

RELEASED FOR PUBLICATION

ALL RIGHTS RESERVED.

© COPYRIGHT - By -

LOC

DIST

REVISIONS

P

LTR

DESCRIPTION

DATE

DWN

APVD

G

86

U

ECR-13-000998

11FEB2013

PK

HS

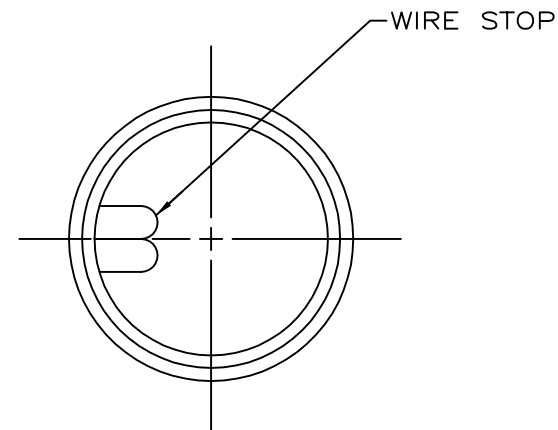
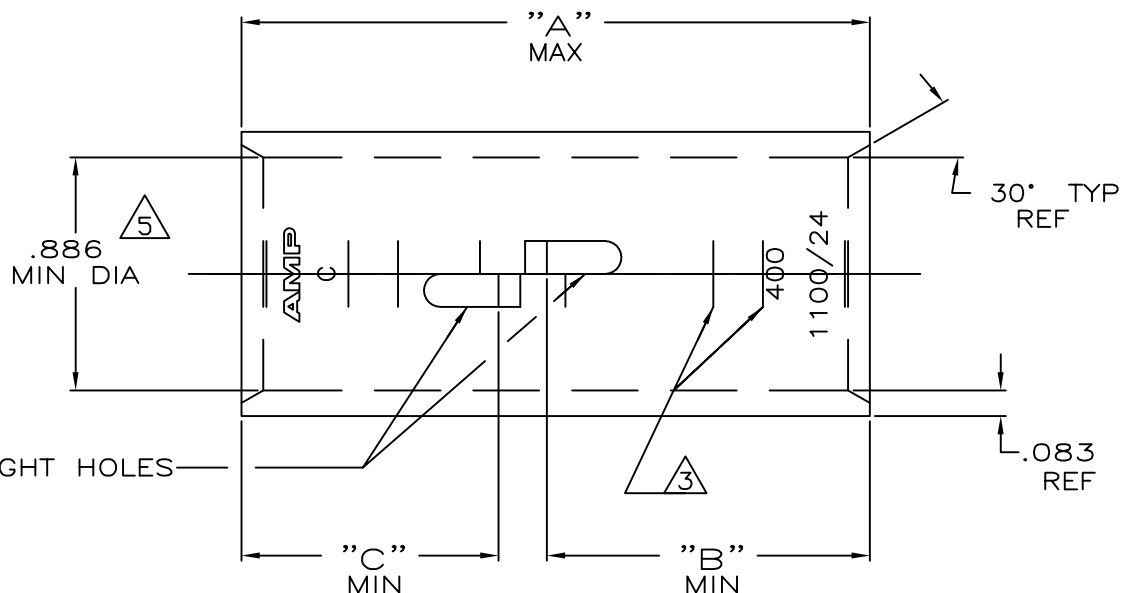

- 1 TIN PL .000150 MIN THK  
PER ASTM B-545
- 2 PART NO: 324465; .180 LB.  
PART NO: 1-324465-0; .180 LB.  
PART NO: 2-324465-5; .200 LB.
- 3 CRIMP LOCATION MARKS ON PART  
NO. 2-324465-5 ONLY.
- 4 CLEANED, UNPLATED
- 5 .045 MAX BURR ALLOWED INSIDE THE WIRE  
BARREL ID IN AREA OF SIGHT HOLE.

.97	1.22	2.45	△ △	375-450 MCM	COPPER ASTM-B-75 ANNEALED	2-324465-5
.97	.97	2.20	△			1-324465-0
			△			324465
"C"	"B"	"A"	FINISH	WIRE RANGE	MATERIAL	PART No

THIS DRAWING IS A CONTROLLED DOCUMENT.		DWN DK SCHRUM 4/24/89	TE Connectivity			
		CHK MS FEHER 4/24/89				
DIMENSIONS: INCHES		APVD WJ VOCKROTH 11/8/89	NAME			
		PRODUCT SPEC	SPLICE, BUTT, AMPPOWER WIRE SIZE:400 MCM			
		APPLICATION SPEC				
MATERIAL SEE TABLE		WEIGHT △ 2	SIZE A3	CAGE CODE 00779	DRAWING NO C=324465	RESTRICTED TO —
CUSTOMER DRAWING			SCALE 2:1	SHEET 1 OF 1	REV U	

# Mouser Electronics

Authorized Distributor

Click to View Pricing, Inventory, Delivery & Lifecycle Information:

[TE Connectivity:](#)

[2-324465-5](#)