

Rotary Encoder

Model EN12 Series



Features:

- 12 mm
- 2 bits gray code
- Incremental/contacting type
- Metal bushing/shaft
- Push-on switch option



Model Styles Available

| | |
|-----------------------------|---------|
| Top Adjust, with Switch | EN12-HS |
| Top Adjust, without Switch | EN12-HN |
| Side Adjust, with Switch | EN12-VS |
| Side Adjust, without Switch | EN12-VN |

Electrical

| | |
|-----------------------------------|--------------------------|
| Pulses (Per Revolution) | 12 & 24 |
| Closed Circuit Resistance, Ohms | 3 Ohms, max. |
| Contact Rating | 1mA/ 5Vdc |
| Operating Current, Maximum | 1mA |
| Dielectric Strength | 300Vac/ 1mA, 1 minute |
| Insulation Resistance, Minimum | 100M ohms at 250Vdc/ 1mA |
| Sliding Noise (at 60 RPM) | 2.0ms max. |
| Contact Bounce (at 15 RPM) | 5.0ms max. |
| Operating Speed (RPM) | 100 RPM max. |
| Switch Power Rating | 10mA/ 5Vdc |
| Switch Contact Resistance | 100 milliohms |
| Actual Electrical Travel, Nominal | Continuous |

Mechanical

| | |
|--------------------------------------|------------|
| Total Mechanical Travel | Continuous |
| Detents (per Revolution) | 0, 12, 24 |
| Rotational Torque of Detent, Maximum | 1.4 oz-in |
| Switch Operating Force | 550 gf |
| Switch Travel | 0.5mm |

General Note
 TT Electronics reserves the right to make changes in product specification without notice or liability. All information is subject to TT Electronics' own data and is considered accurate at time of going to print.

TT Electronics | BI Technologies
 Circulo de la Amistad #102 PIMSA IV Mexicali B.C. Mexico C.P 21210
 Ph: +1 714 447 2345
www.ttelectronics.com/bi-technologies

Environmental

Rotational Life

30,000 cycles

Ordering

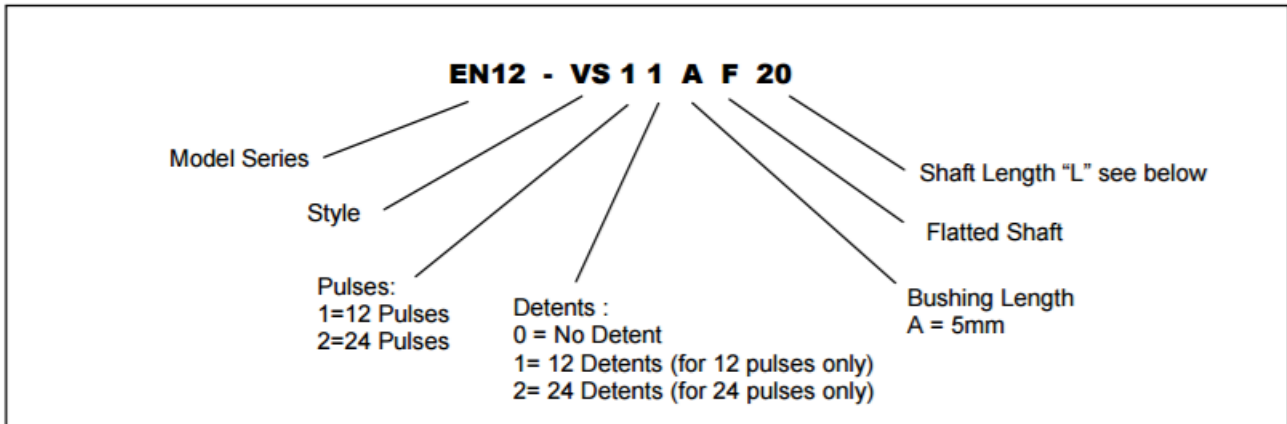

Shaft Length Options

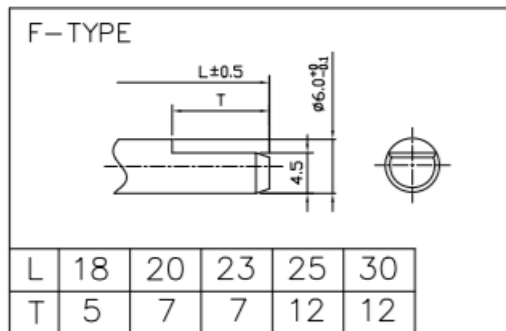

18 Length = 17.5mm

23 Length = 22.5mm

Circuit Diagram

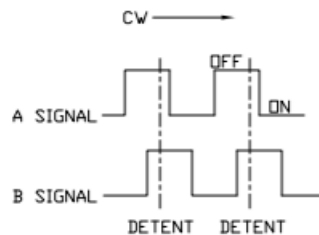

Mouser Electronics

Authorized Distributor

Click to View Pricing, Inventory, Delivery & Lifecycle Information:

TT Electronics:

[EN12-HN22AF18](#) [EN12-HS11AF25](#) [EN12-HS22AF20](#) [EN12-VN20AF20](#) [EN12-VS22AF18](#) [EN12-HN20AF18](#) [EN12-VS20A18](#) [EN12-VS22AF25](#) [EN12-HS11AF18](#) [EN12-VS20AF25](#) [EN12-HS22AF25](#) [EN12-VS22AF20](#) [EN12-HN22AF25](#) [EN12-VS22A18](#) [EN12-HN22AF23](#) [EN12-VS20AF18](#) [EN12-VS11AF18](#) [EN12-HN22BF23](#) [EN12-HS22AF18](#) [EN12-HS22AF30](#) [EN12-HS22AF23](#) [EN12-HN11AF20](#) [EN12-VS11AF20](#) [EN12-VS11AF25](#) [EN12-HN10AF18](#) [EN12-VS20AF20](#) [EN12-HN11AF18](#) [EN12-HN22AF20](#)