

MODEL 78

1-1/4" Rectangular

Multiturn

Cermet Trimming

Potentiometer

1

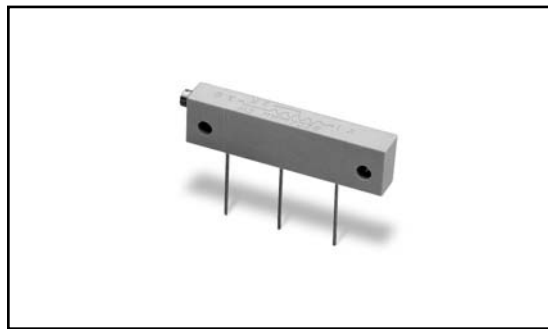

ELECTRICAL

Standard Resistance Range, Ohms	10 to 2Meg
Standard Resistance Tolerance	±10% (<100 Ohms = ±20%)
Input Voltage, Maximum	300 Vdc or rms not to exceed power rating
Slider Current, Maximum	100mA or within rated power, whichever is less
Power Rating, Watts	1.0 at 70°C derating to 0 at 125°C
End Resistance, Maximum	2 Ohms
Actual Electrical Travel, Turns, Nominal	22
Dielectric Strength	500 Vrms
Insulation Resistance, Minimum	1,000 Megohms
Resolution	Essentially infinite
Contact Resistance Variation, Maximum	1% or 1 Ohm, whichever is greater

ENVIRONMENTAL

Seal	85°C Fluorinert® (No Leaks)
Temperature Coefficient, Maximum	±100ppm/°C
Operating Temperature Range	-55°C to +125°C
Thermal Shock	5 cycles, -55°C to +125°C (1% ΔRT, 1% ΔVR)
Moisture Resistance	Ten 24 hour cycles (1% ΔRT, IR 1,000 Megohms Min.)
Shock, 6ms Sawtooth	100G's (1% ΔRT, 1% ΔVR)
Vibration	20G's, 10 to 2,000 Hz (1% ΔRT, 1% ΔVR)
High Temperature Exposure	250 hours at 125°C (2% ΔRT, 2% ΔVR)
Rotational Life	200 cycles (3% ΔRT)
Load Life at 1.0 Watts	1,000 hours at 70°C (2% ΔRT)
Resistance to Solder Heat	260°C for 10 sec. (1% ΔRT)

MECHANICAL

Mechanical Stops	Clutch Action, both ends
Torque, Starting Maximum	5oz.-in. (0.035 N-m)
Weight, Nominal	.09 oz. (2.6 grams)

Fluorinert® is a registered trademark of 3M Company.
Specifications subject to change without notice.



SIDE ADJUSTMENT (Inch/mm)

Model 78P

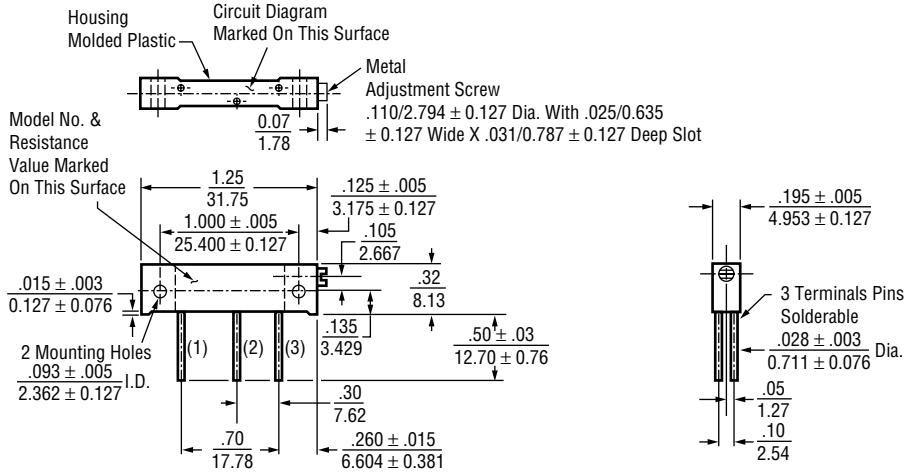

Note: Model 78P dimensions applicable to all other models except as noted.

Model 78L

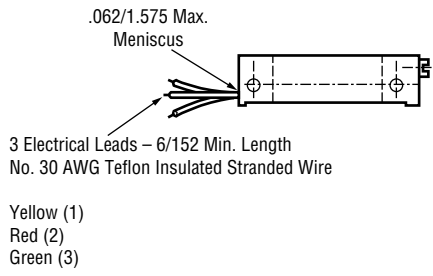

Model 78S

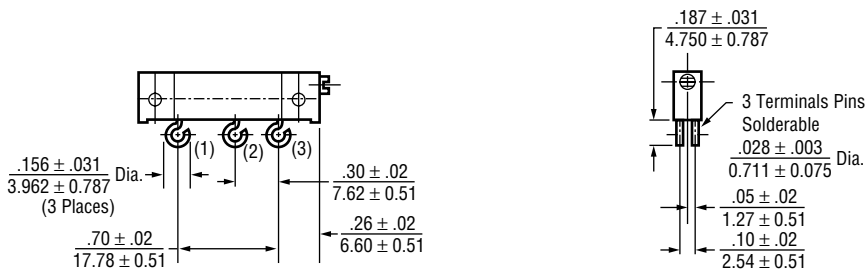

PANEL MOUNT ADAPTER (Inch/mm)

1

Model 56BW (Adapter Only)

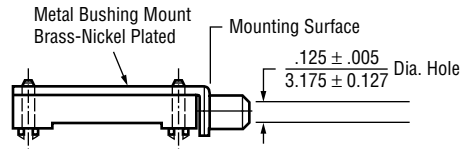

Use .22/5.613 Dia. Min. Mounting Hole

Lock Washer, Panel Nut, Sealing Washer & Mounting Screws Provided

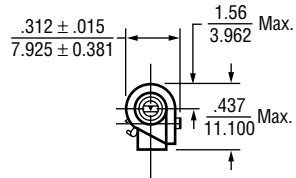

Model 78LBW (Adapter Pre-Assembled with Trimmer)

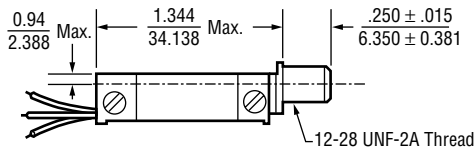

Model 78SBW (Adapter Pre-Assembled with Trimmer)

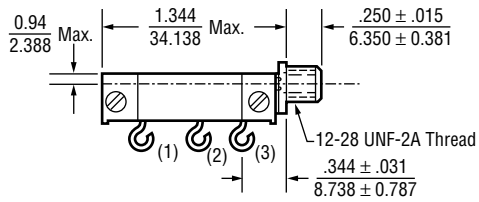

STANDARD RESISTANCE VALUES, OHMS

10	200	5K	50K	500K
20	500	10K	100K	1Meg
50	1K	20K	200K	2Meg
100	2K	25K	250K	

PACKAGING

Standard: Boxes
Capacity = 25 Units

ORDERING INFORMATION

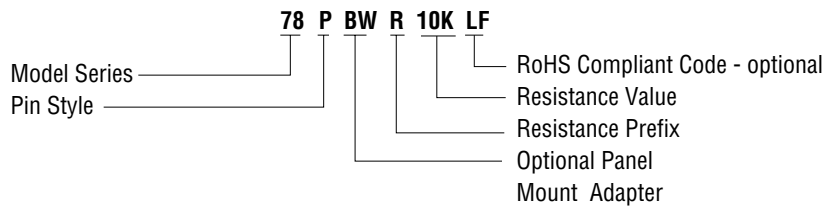

Note: Use '56BW' to order panel mount adapter without trimmer

CIRCUIT DIAGRAM

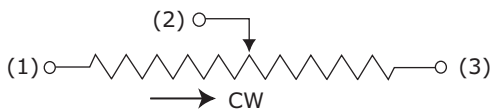

NOTES

Metric equivalents, based on 1 inch = 25.4mm are rounded to the same number of significant figures as in the original English units and are provided for general information only.

Tolerances unless otherwise specified:
Linear = ± .01 inches (.25mm)
Angular = ± 2 degrees

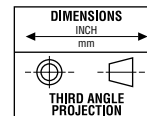

Mouser Electronics

Authorized Distributor

Click to View Pricing, Inventory, Delivery & Lifecycle Information:

TT Electronics:

[78LBWR2KLF](#) [78LR100LF](#) [78LR100KLF](#) [78LR1KLF](#) [78LR500KLF](#) [78PBWR2KLF](#) [78PBWR50LF](#) [78PR10LF](#)
[78PR100KLF](#) [78PR1KLF](#) [78PR200LF](#) [78PR200KLF](#) [78PR25KLF](#) [78PR2KLF](#) [78PR500LF](#) [78PR500KLF](#)
[78SBWR50KLF](#) [78PR6.5MEG](#) [78PR1MEG](#) [78LBWR10K](#) [78LR2KLF](#) [78LR200LF](#) [78LR2MEGLF](#) [78PR25K](#)
[78LBWR20LF](#) [78LBWR250KLF](#) [78PR2MEGLF](#) [78LBWR1KLF](#) [78LBWR200LF](#) [78PBWR100KLF](#) [78PBWR10KLF](#)
[78PBWR1MEGLF](#) [78PBWR20LF](#) [78PBWR2MEGLF](#) [78PBWR500LF](#) [78PR1MEGLF](#) [78PR20LF](#) [78PR50LF](#)
[78LBWR10LF](#) [78LR20KLF](#) [78PBWR100LF](#) [78LR50KLF](#) [78PBWR10LF](#) [78PBWR1KLF](#) [78PBWR250KLF](#)
[78PBWR5KLF](#) [78PR100LF](#) [78LBWR50LF](#) [78LBWR500LF](#) [78LBWR500KLF](#) [78LR250KLF](#) [78LR25KLF](#) [78LR500LF](#)
[78PBWR20KLF](#) [78PBWR500KLF](#) [78PBWR50KLF](#) [78PR250KLF](#) [78LBWR100KLF](#) [78LBWR200KLF](#) [78LR1MEGLF](#)
[78LR20LF](#) [78LR50LF](#) [78LR5KLF](#) [78PBWR200LF](#) [78PBWR200KLF](#) [78PBWR25KLF](#) [78LBWR100LF](#)
[78LBWR10KLF](#) [78LBWR1MEGLF](#) [78LBWR25KLF](#) [78LR10LF](#) [78LBWR2MEGLF](#) [78LBWR50KLF](#) [78LBWR20KLF](#)
[78LBWR5KLF](#) [78LR10KLF](#) [78LR200KLF](#) [78SBWR100LF](#) [78SR50LF](#) [78SR25KLF](#) [78SBWR100KLF](#) [78SBWR20LF](#)
[78SR100LF](#) [78SBWR50LF](#) [78SBWR5KLF](#) [78SBWR2KLF](#) [78SR100KLF](#) [78SBWR20KLF](#) [78SBWR500LF](#)
[78SR500KLF](#) [78SBWR1KLF](#) [78SBWR200LF](#) [78SR1MEGLF](#) [78SBWR200KLF](#) [78SR10LF](#) [78SR250KLF](#)
[78SBWR250KLF](#) [78SR2MEGLF](#) [78SR10KLF](#) [78SBWR500KLF](#)