

# LP1206 SMD High Performance Low Pass Filter **AVX RF**

LP1206A0700ASTR

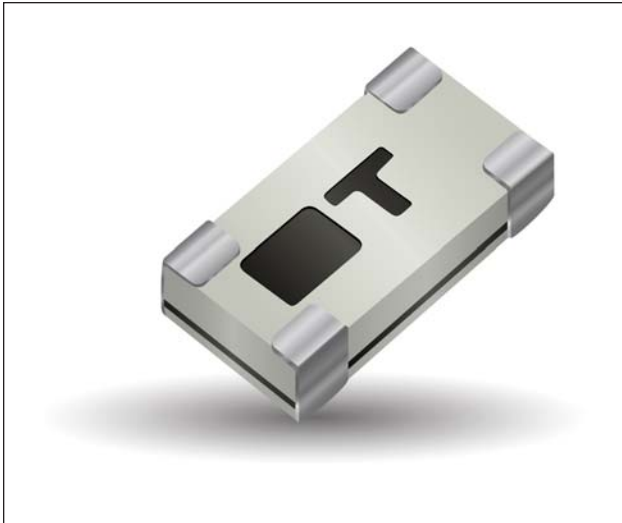

## ITF TECHNOLOGY

The ITF SMD Filter is based on thin-film multilayer technology. The technology provides a miniature part with excellent high frequency performance and rugged construction for reliable automatic assembly. The ITF Filter is offered in a variety of frequency bands compatible with various types of high frequency wireless systems.

## FEATURES

- Small size: 1206
- Frequency: 700MHz
- Sharp attenuation slope
- Characteristic impedance: 50Ohm
- Operating/Storage temp: -40°C – +85°C
- Low profile
- Rugged construction
- Taped and reeled
- Power handling: 8W

## APPLICATIONS

- Mobile communications
- Satellite TV receivers
- GPS
- Vehicle location systems
- Wireless LAN's

## HOW TO ORDER

**LP**   **1206**   **A**   **0700**   **A**   **S**   **TR**  
 Series   Size   Type   Frequency (MHz)   Sub-Type   Termination   Taped & Reeled

## FINAL QUALITY INSPECTION

Finished parts are 100% tested for electrical parameters and visual/mechanical characteristics. Each production lot is evaluated on a sample basis for:

- Static Humidity: 85°C, 85% RH, 160 hours
- Endurance: 125°C, I<sub>B</sub>, 4 hours

## TERMINATION

Nickel/ Lead free Solder coating (Sn100) compatible with automatic soldering technologies: reflow, wave soldering, vapor phase and manual.

## RECOMMENDED PAD LAYOUT mm (inches)

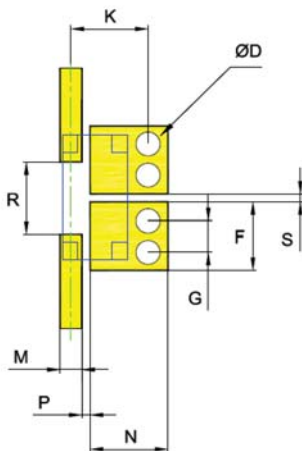

|   |                             |
|---|-----------------------------|
| F | 1.70±0.05<br>(0.067±0.002)  |
| G | 0.78±0.05<br>(0.031±0.002)  |
| K | 1.91±0.10<br>(0.075±0.004)  |
| M | 0.54±0.025<br>(0.021±0.001) |
| N | 1.93±0.05<br>(0.076±0.002)  |
| P | 0.21±0.04<br>(0.008±0.002)  |
| R | 1.80±0.04<br>(0.071±0.002)  |
| S | 0.20±0.04<br>(0.008±0.002)  |
| D | 0.60±0.10<br>(0.024±0.004)  |

## DIMENSIONS (Top View)

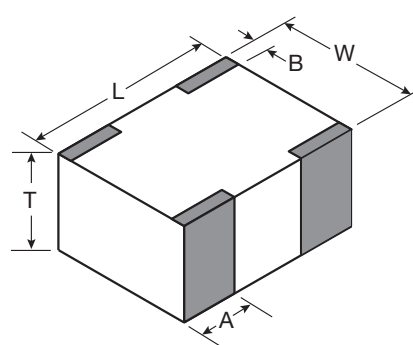

mm (inches)

|   |                            |
|---|----------------------------|
| L | 3.08±0.1<br>(0.121±0.004)  |
| W | 1.60±0.1<br>(0.063±0.004)  |
| T | 0.87±0.1<br>(0.034±0.004)  |
| A | 0.61±0.25<br>(0.028±0.010) |
| B | 0.35±0.15<br>(0.014±0.006) |

## TERMINALS AND LAYOUT (Top View)

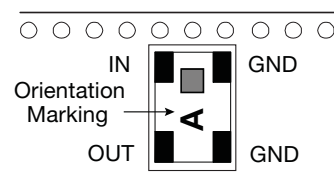

# LP1206 SMD High Performance Low Pass Filter **AVX RF**

LP1206A0700ASTR

## ELECTRICAL CHARACTERISTICS

| P/N             | I.Loss<br>@ 700MHz | R.Loss<br>@ 700MHz | Attenuation   |
|-----------------|--------------------|--------------------|---|
| LP1206A0700ASTR | 0.8dB max.         | -20dB              | -20dB at 980MHz<br>-45dB at 1400MHz<br>-45dB at 2100MHz<br>-30dB at 2800MHz |

## TYPICAL ELECTRICAL PERFORMANCE

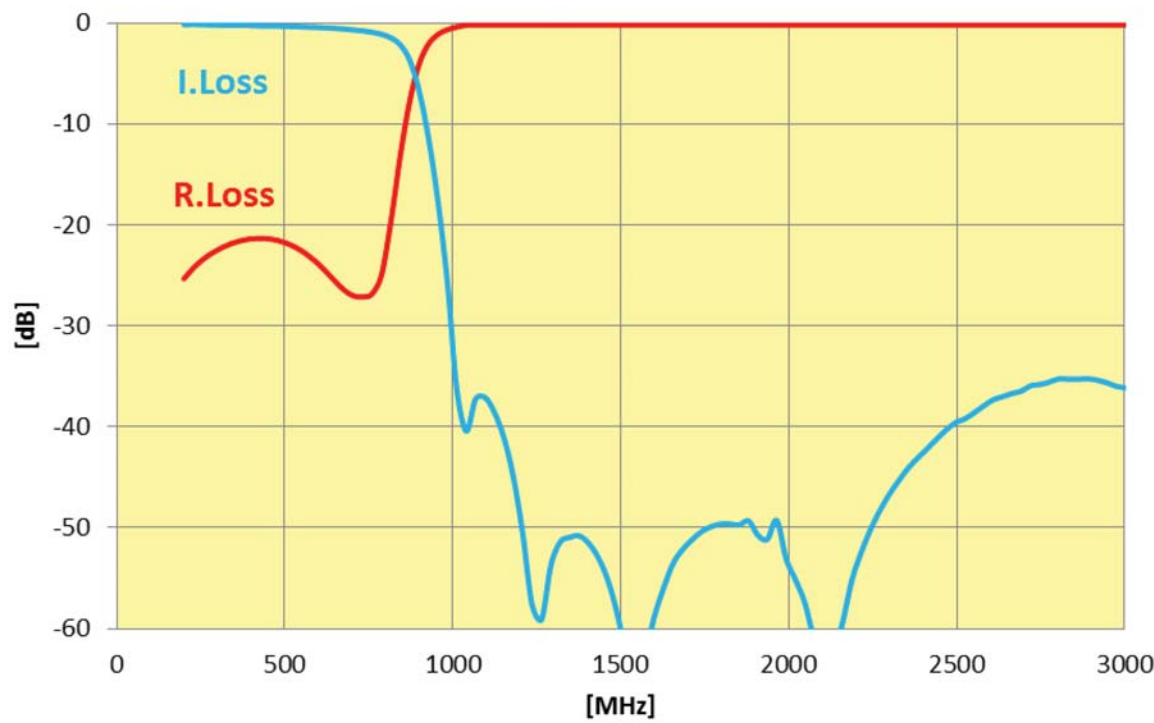

# LP1206 SMD High Performance Low Pass Filter **AVX RF**

## LP1206A0860ASTR

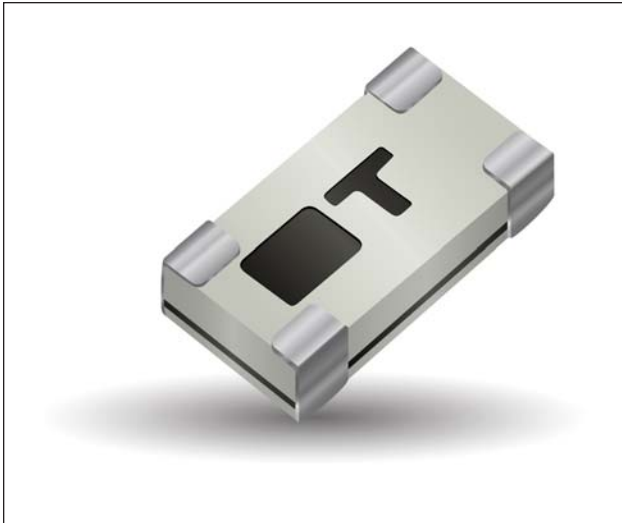

### ITF TECHNOLOGY

The ITF SMD Filter is based on thin-film multilayer technology. The technology provides a miniature part with excellent high frequency performance and rugged construction for reliable automatic assembly. The ITF Filter is offered in a variety of frequency bands compatible with various types of high frequency wireless systems.

### FEATURES

- Small size: 1206
- Frequency: 860MHz
- Sharp attenuation slope
- Characteristic impedance: 50Ohm
- Operating/Storage temp: -40°C – +85°C
- Low profile
- Rugged construction
- Taped and reeled
- Power handling: 8W

### APPLICATIONS

- Mobile communications
- Satellite TV receivers
- GPS
- Vehicle location systems
- Wireless LAN's

### HOW TO ORDER

| LP     | 1206 | A    | 0860            | A        | S           | TR             |
|--------|------|------|-----------------|----------|-------------|----------------|
| Series | Size | Type | Frequency (MHz) | Sub-Type | Termination | Taped & Reeled |

### FINAL QUALITY INSPECTION

Finished parts are 100% tested for electrical parameters and visual/mechanical characteristics. Each production lot is evaluated on a sample basis for:

- Static Humidity: 85°C, 85% RH, 160 hours
- Endurance: 125°C, I<sub>B</sub>, 4 hours

### TERMINATION

Nickel/ Lead free Solder coating (Sn100) compatible with automatic soldering technologies: reflow, wave soldering, vapor phase and manual.

### RECOMMENDED PAD LAYOUT mm (inches)

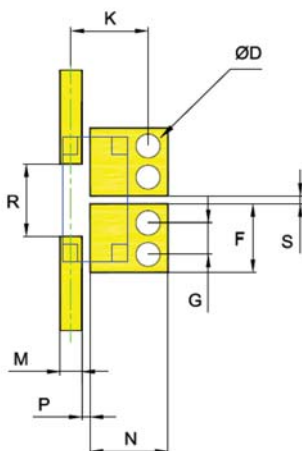

|   |                             |
|---|-----------------------------|
| F | 1.70±0.05<br>(0.067±0.002)  |
| G | 0.78±0.05<br>(0.031±0.002)  |
| K | 1.91±0.10<br>(0.075±0.004)  |
| M | 0.54±0.025<br>(0.021±0.001) |
| N | 1.93±0.05<br>(0.076±0.002)  |
| P | 0.21±0.04<br>(0.008±0.002)  |
| R | 1.80±0.04<br>(0.071±0.002)  |
| S | 0.20±0.04<br>(0.008±0.002)  |
| D | 0.60±0.10<br>(0.024±0.004)  |

### DIMENSIONS (Top View)

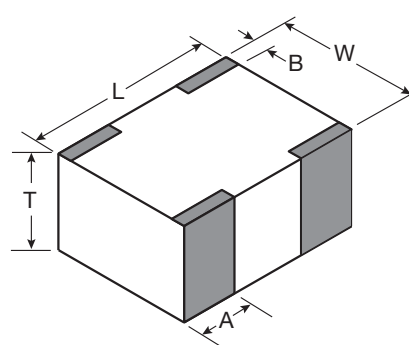

**mm (inches)**

|   |                            |
|---|----------------------------|
| L | 3.08±0.1<br>(0.121±0.004)  |
| W | 1.60±0.1<br>(0.063±0.004)  |
| T | 0.87±0.1<br>(0.034±0.004)  |
| A | 0.61±0.25<br>(0.028±0.010) |
| B | 0.35±0.15<br>(0.014±0.006) |

### TERMINALS AND LAYOUT (Top View)

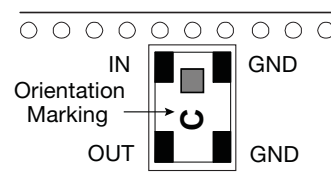

# LP1206 SMD High Performance Low Pass Filter **AVX RF**

LP1206A0860ASTR

## ELECTRICAL CHARACTERISTICS

| P/N             | I.Loss<br>@ 860MHz | R.Loss<br>@ 860MHz | Attenuation  |
|-----------------|--------------------|--------------------|--|
| LP1206A0860ASTR | 0.85dB max.        | -18dB              | -25dB at 1204MHz<br>-45dB at 1720MHz<br>-45dB at 2580MHz<br>-30dB at 3440MHz |

## TYPICAL ELECTRICAL PERFORMANCE

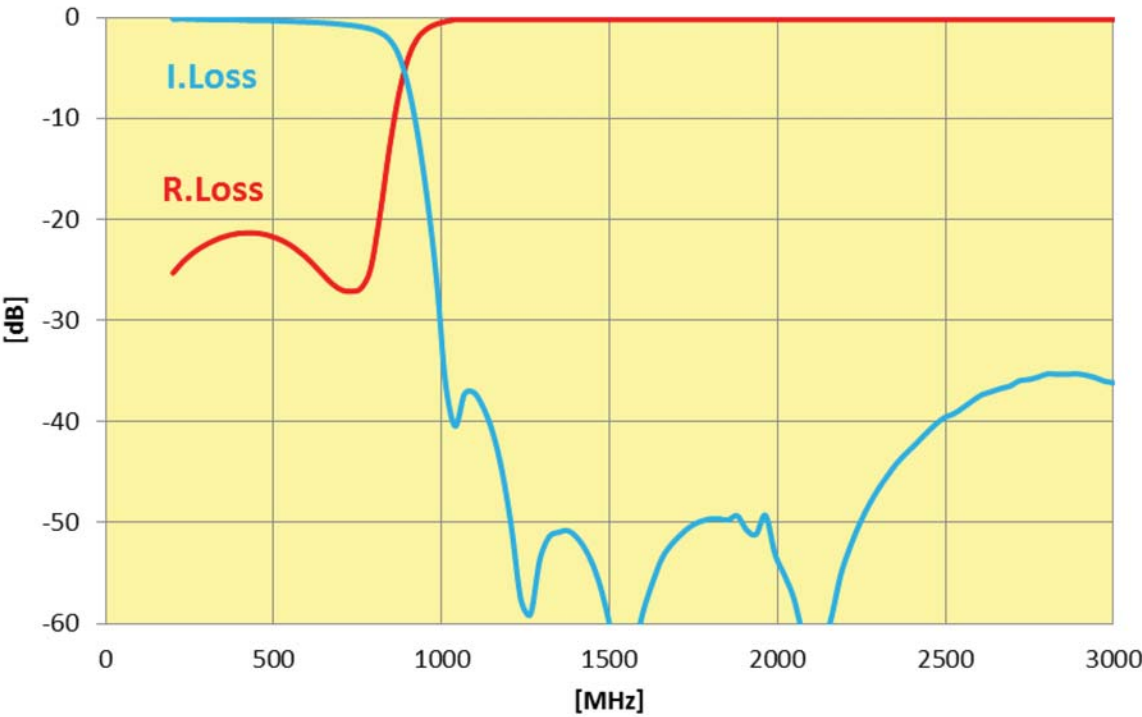

# LP1206 SMD High Performance Low Pass Filter **AVX RF**

## LP1206A3200ASTR

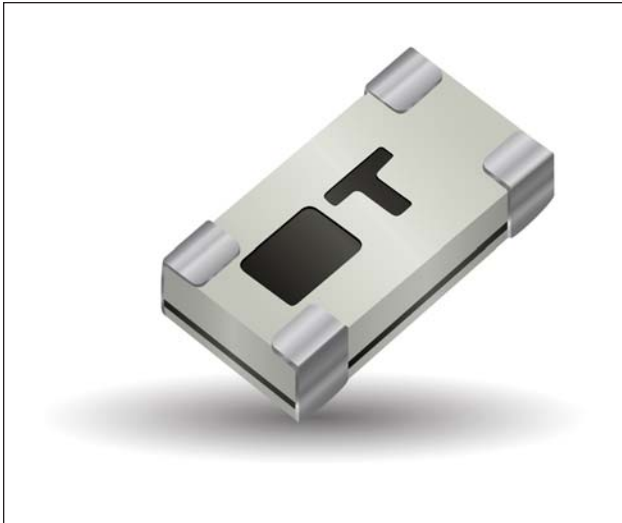

### ITF TECHNOLOGY

The ITF SMD Filter is based on thin-film multilayer technology. The technology provides a miniature part with excellent high frequency performance and rugged construction for reliable automatic assembly. The ITF Filter is offered in a variety of frequency bands compatible with various types of high frequency wireless systems.

### FEATURES

- Small size: 1206
- Frequency: 3.2GHz
- Sharp attenuation slope
- Characteristic impedance: 50Ohm
- Operating/Storage temp: -40°C – +85°C
- Low profile
- Rugged construction
- Taped and reeled
- Power handling: 8W

### APPLICATIONS

- Mobile communications
- Satellite TV receivers
- GPS
- Vehicle location systems
- Wireless LAN's

### HOW TO ORDER

| LP     | 1206 | A    | 3200            | A        | S           | TR             |
|--------|------|------|-----------------|----------|-------------|----------------|
| Series | Size | Type | Frequency (MHz) | Sub-Type | Termination | Taped & Reeled |

### FINAL QUALITY INSPECTION

Finished parts are 100% tested for electrical parameters and visual/mechanical characteristics. Each production lot is evaluated on a sample basis for:

- Static Humidity: 85°C, 85% RH, 160 hours
- Endurance: 125°C, I<sub>B</sub>, 4 hours

### TERMINATION

Nickel/ Lead free Solder coating (Sn100) compatible with automatic soldering technologies: reflow, wave soldering, vapor phase and manual.

### RECOMMENDED PAD LAYOUT mm (inches)

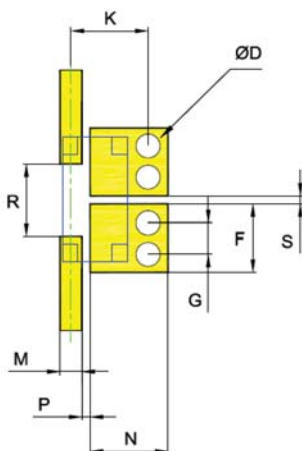

|   |                             |
|---|-----------------------------|
| F | 1.70±0.05<br>(0.067±0.002)  |
| G | 0.78±0.05<br>(0.031±0.002)  |
| K | 1.91±0.10<br>(0.075±0.004)  |
| M | 0.54±0.025<br>(0.021±0.001) |
| N | 1.93±0.05<br>(0.076±0.002)  |
| P | 0.21±0.04<br>(0.008±0.002)  |
| R | 1.80±0.04<br>(0.071±0.002)  |
| S | 0.20±0.04<br>(0.008±0.002)  |
| D | 0.60±0.10<br>(0.024±0.004)  |

### DIMENSIONS (Top View)

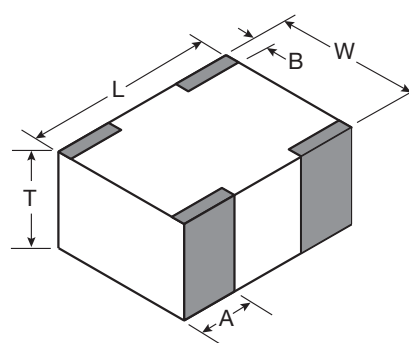

**mm (inches)**

|   |                            |
|---|----------------------------|
| L | 3.08±0.1<br>(0.121±0.004)  |
| W | 1.60±0.1<br>(0.063±0.004)  |
| T | 0.87±0.1<br>(0.034±0.004)  |
| A | 0.61±0.25<br>(0.028±0.010) |
| B | 0.35±0.15<br>(0.014±0.006) |

### TERMINALS AND LAYOUT (Top View)

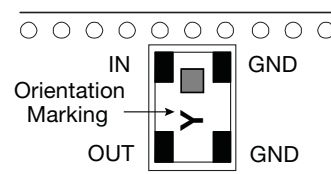

# LP1206 SMD High Performance Low Pass Filter **AVX RF**

LP1206A3200ASTR

## ELECTRICAL CHARACTERISTICS

| P/N             | I.Loss<br>@ 3.2GHz | R.Loss<br>@ 3.2GHz | Attenuation (min.)   |
|-----------------|--------------------|--------------------|--|
| LP1206A3200ASTR | 0.85dB max.        | -20dB              | -30dB at 4.48GHz<br>-40dB at 6.4GHz<br>-25dB at 9.6GHz<br>-25dB at 10GHz |

## TYPICAL ELECTRICAL PERFORMANCE

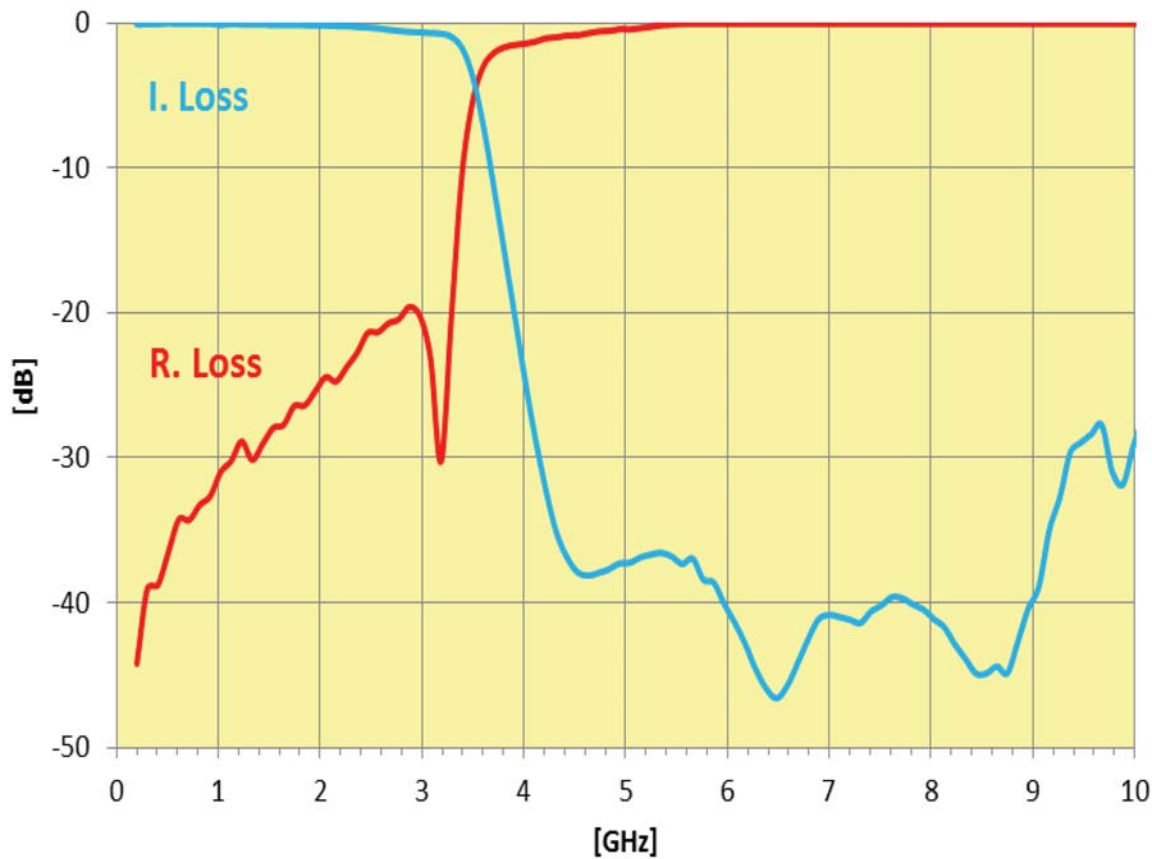

# LP1206 SMD High Performance Low Pass Filter **AVX RF**

## LP1206A3500ASTR

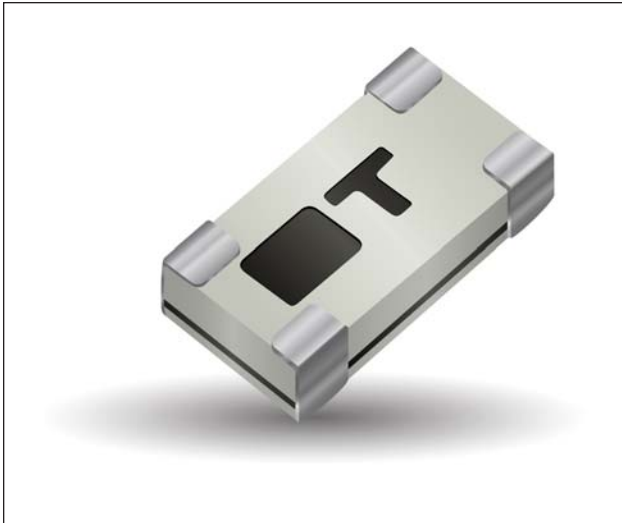

### ITF TECHNOLOGY

The ITF SMD Filter is based on thin-film multilayer technology. The technology provides a miniature part with excellent high frequency performance and rugged construction for reliable automatic assembly. The ITF Filter is offered in a variety of frequency bands compatible with various types of high frequency wireless systems.

### FEATURES

- Small size: 1206
- Frequency: 3.5GHz
- Sharp attenuation slope
- Characteristic impedance: 50Ohm
- Operating/Storage temp: -40°C – +85°C
- Low profile
- Rugged construction
- Taped and reeled
- Power handling: 8W

### APPLICATIONS

- Mobile communications
- Satellite TV receivers
- GPS
- Vehicle location systems
- Wireless LAN's

### HOW TO ORDER

| LP     | 1206 | A    | 3500            | A        | S           | TR             |
|--------|------|------|-----------------|----------|-------------|----------------|
| Series | Size | Type | Frequency (MHz) | Sub-Type | Termination | Taped & Reeled |

### FINAL QUALITY INSPECTION

Finished parts are 100% tested for electrical parameters and visual/mechanical characteristics. Each production lot is evaluated on a sample basis for:

- Static Humidity: 85°C, 85% RH, 160 hours
- Endurance: 125°C, I<sub>B</sub>, 4 hours

### TERMINATION

Nickel/ Lead free Solder coating (Sn100) compatible with automatic soldering technologies: reflow, wave soldering, vapor phase and manual.

### RECOMMENDED PAD LAYOUT mm (inches)

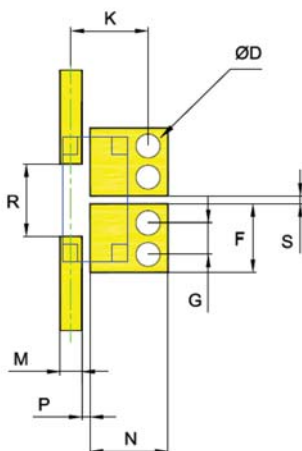

|   |                             |
|---|-----------------------------|
| F | 1.70±0.05<br>(0.067±0.002)  |
| G | 0.78±0.05<br>(0.031±0.002)  |
| K | 1.91±0.10<br>(0.075±0.004)  |
| M | 0.54±0.025<br>(0.021±0.001) |
| N | 1.93±0.05<br>(0.076±0.002)  |
| P | 0.21±0.04<br>(0.008±0.002)  |
| R | 1.80±0.04<br>(0.071±0.002)  |
| S | 0.20±0.04<br>(0.008±0.002)  |
| D | 0.60±0.10<br>(0.024±0.004)  |

### DIMENSIONS (Top View)

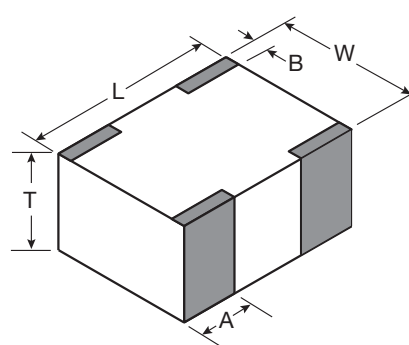

**mm (inches)**

|   |                            |
|---|----------------------------|
| L | 3.08±0.1<br>(0.121±0.004)  |
| W | 1.60±0.1<br>(0.063±0.004)  |
| T | 0.87±0.1<br>(0.034±0.004)  |
| A | 0.61±0.25<br>(0.028±0.010) |
| B | 0.35±0.15<br>(0.014±0.006) |

### TERMINALS AND LAYOUT (Top View)

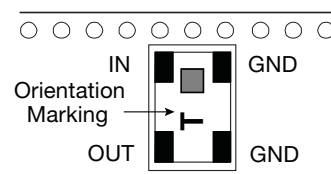

# LP1206 SMD High Performance Low Pass Filter **AVX RF**

LP1206A3500ASTR

## ELECTRICAL CHARACTERISTICS

| P/N             | I.Loss<br>@ 3.5GHz | R.Loss<br>@ 3.5GHz | Attenuation (min.)   |
|-----------------|--------------------|--------------------|--|
| LP1206A3500ASTR | 0.7dB max.         | -18dB              | -30dB at 4.9GHz<br>-40dB at 7GHz<br>-25dB at 10.5GHz<br>-15dB at 11GHz |

## TYPICAL ELECTRICAL PERFORMANCE

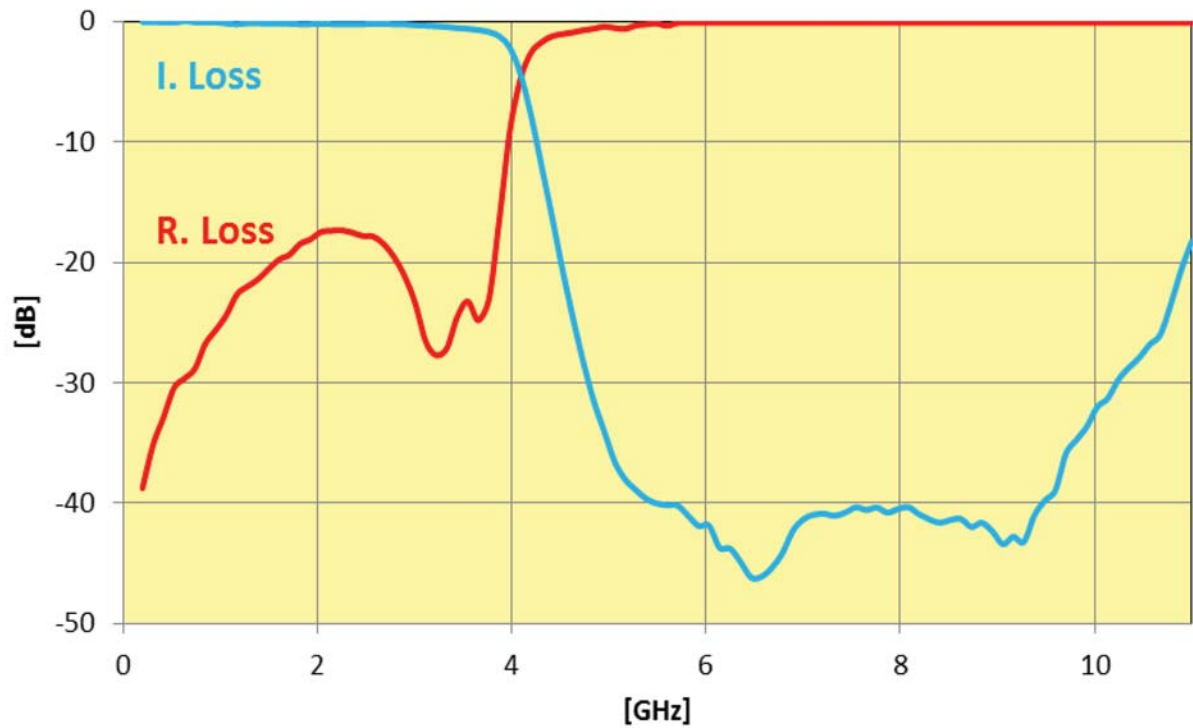



# LP1206 SMD High Performance Low Pass Filter **AVX RF**

## LP1206A3600ASTR

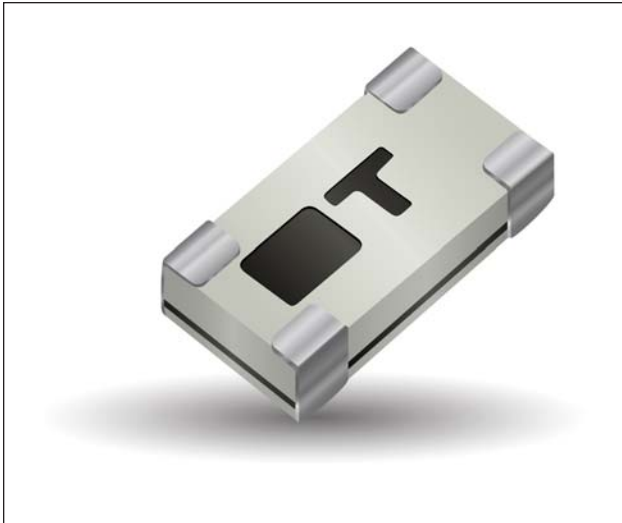

### ITF TECHNOLOGY

The ITF SMD Filter is based on thin-film multilayer technology. The technology provides a miniature part with excellent high frequency performance and rugged construction for reliable automatic assembly. The ITF Filter is offered in a variety of frequency bands compatible with various types of high frequency wireless systems.

### FEATURES

- Small size: 1206
- Frequency: 3.6GHz
- Sharp attenuation slope
- Characteristic impedance: 50Ohm
- Operating/Storage temp: -40°C – +85°C
- Low profile
- Rugged construction
- Taped and reeled
- Power handling: 8W

### APPLICATIONS

- Mobile communications
- Satellite TV receivers
- GPS
- Vehicle location systems
- Wireless LAN's

### HOW TO ORDER

| LP     | 1206 | A    | 3600            | A        | S           | TR             |
|--------|------|------|-----------------|----------|-------------|----------------|
| Series | Size | Type | Frequency (MHz) | Sub-Type | Termination | Taped & Reeled |

### FINAL QUALITY INSPECTION

Finished parts are 100% tested for electrical parameters and visual/mechanical characteristics. Each production lot is evaluated on a sample basis for:

- Static Humidity: 85°C, 85% RH, 160 hours
- Endurance: 125°C, I<sub>B</sub>, 4 hours

### TERMINATION

Nickel/ Lead free Solder coating (Sn100) compatible with automatic soldering technologies: reflow, wave soldering, vapor phase and manual.

### RECOMMENDED PAD LAYOUT mm (inches)

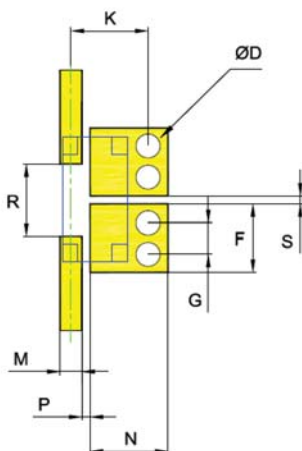

|   |                             |
|---|-----------------------------|
| F | 1.70±0.05<br>(0.067±0.002)  |
| G | 0.78±0.05<br>(0.031±0.002)  |
| K | 1.91±0.10<br>(0.075±0.004)  |
| M | 0.54±0.025<br>(0.021±0.001) |
| N | 1.93±0.05<br>(0.076±0.002)  |
| P | 0.21±0.04<br>(0.008±0.002)  |
| R | 1.80±0.04<br>(0.071±0.002)  |
| S | 0.20±0.04<br>(0.008±0.002)  |
| D | 0.60±0.10<br>(0.024±0.004)  |

### DIMENSIONS (Top View)

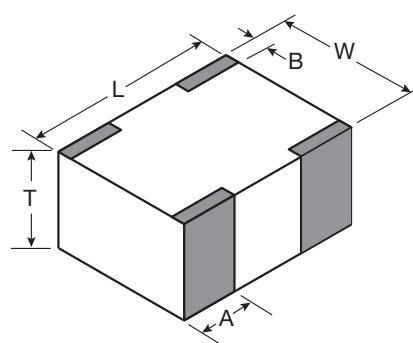

mm (inches)

|   |                            |
|---|----------------------------|
| L | 3.08±0.1<br>(0.121±0.004)  |
| W | 1.60±0.1<br>(0.063±0.004)  |
| T | 0.87±0.1<br>(0.034±0.004)  |
| A | 0.61±0.25<br>(0.028±0.010) |
| B | 0.35±0.15<br>(0.014±0.006) |

### TERMINALS AND LAYOUT (Top View)

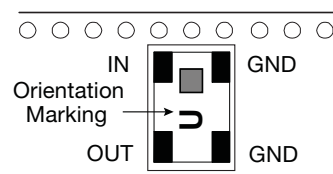

# LP1206 SMD High Performance Low Pass Filter **AVX RF**

LP1206A3600ASTR

## ELECTRICAL CHARACTERISTICS

| P/N             | I.Loss<br>@ 3.6GHz | R.Loss<br>@ 3.6GHz | Attenuation (min.)                                      |
|-----------------|--------------------|--------------------|---|
| LP1206A3600ASTR | 0.7dB max.         | -25dB              | -30dB at 5.04GHz<br>-35dB at 7.2GHz<br>-25dB at 10.8GHz |

## TYPICAL ELECTRICAL PERFORMANCE

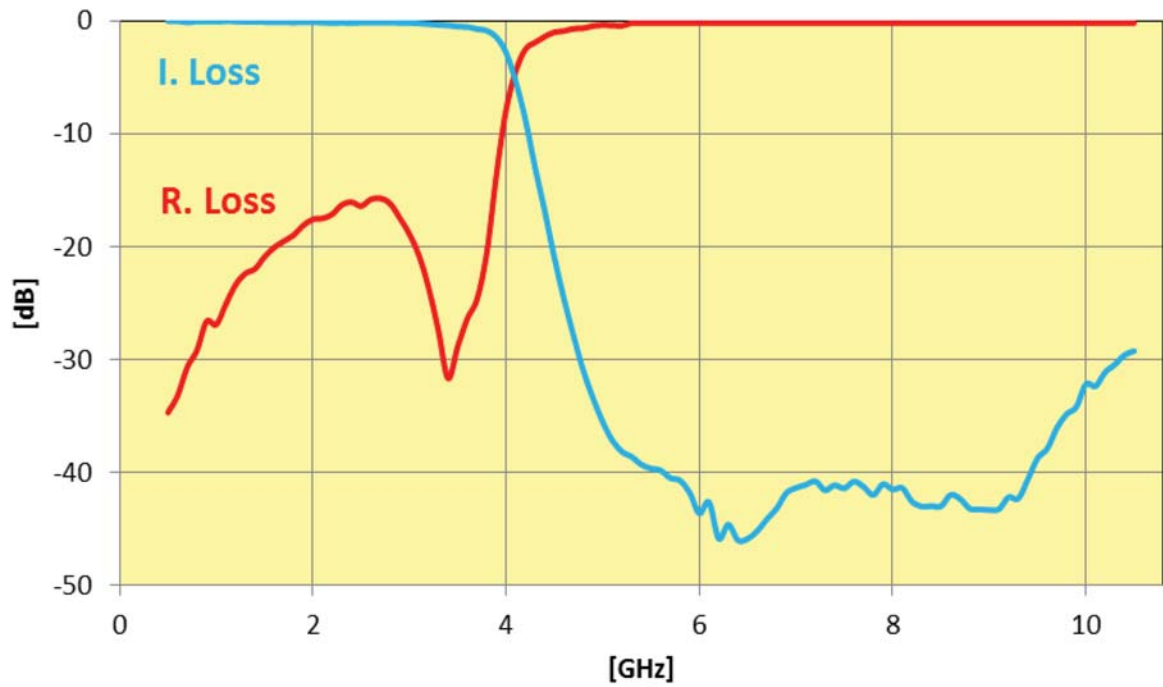

# LP1206 SMD High Performance Low Pass Filter **AVX RF**

## LP1206A3800ASTR

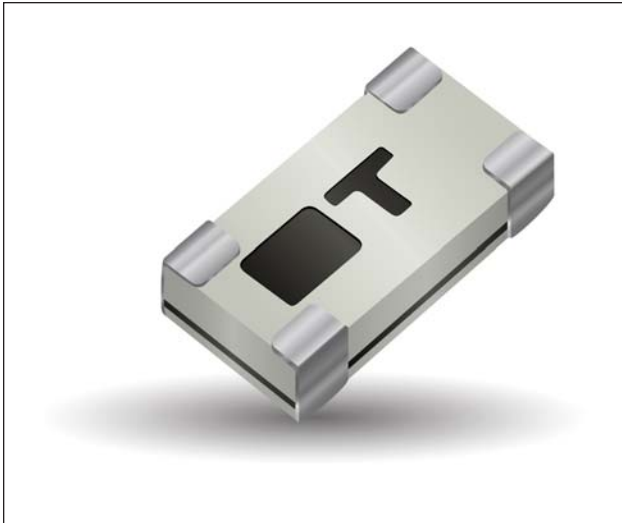

### ITF TECHNOLOGY

The ITF SMD Filter is based on thin-film multilayer technology. The technology provides a miniature part with excellent high frequency performance and rugged construction for reliable automatic assembly. The ITF Filter is offered in a variety of frequency bands compatible with various types of high frequency wireless systems.

### FEATURES

- Small size: 1206
- Frequency: 3.8GHz
- Sharp attenuation slope
- Characteristic impedance: 50Ohm
- Operating/Storage temp: -40°C – +85°C
- Low profile
- Rugged construction
- Taped and reeled
- Power handling: 8W

### APPLICATIONS

- Mobile communications
- Satellite TV receivers
- GPS
- Vehicle location systems
- Wireless LAN's

### HOW TO ORDER

| LP     | 1206 | A    | 3800            | A        | S           | TR             |
|--------|------|------|-----------------|----------|-------------|----------------|
| Series | Size | Type | Frequency (MHz) | Sub-Type | Termination | Taped & Reeled |

### FINAL QUALITY INSPECTION

Finished parts are 100% tested for electrical parameters and visual/mechanical characteristics. Each production lot is evaluated on a sample basis for:

- Static Humidity: 85°C, 85% RH, 160 hours
- Endurance: 125°C, I<sub>B</sub>, 4 hours

### TERMINATION

Nickel/ Lead free Solder coating (Sn100) compatible with automatic soldering technologies: reflow, wave soldering, vapor phase and manual.

### RECOMMENDED PAD LAYOUT mm (inches)

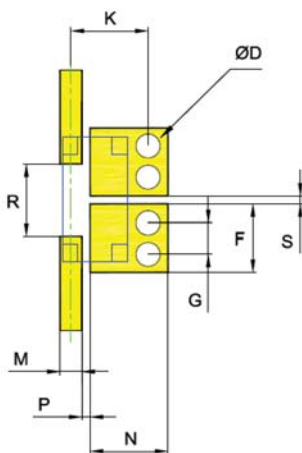

|   |                             |
|---|-----------------------------|
| F | 1.70±0.05<br>(0.067±0.002)  |
| G | 0.78±0.05<br>(0.031±0.002)  |
| K | 1.91±0.10<br>(0.075±0.004)  |
| M | 0.54±0.025<br>(0.021±0.001) |
| N | 1.93±0.05<br>(0.076±0.002)  |
| P | 0.21±0.04<br>(0.008±0.002)  |
| R | 1.80±0.04<br>(0.071±0.002)  |
| S | 0.20±0.04<br>(0.008±0.002)  |
| D | 0.60±0.10<br>(0.024±0.004)  |

### DIMENSIONS (Top View)

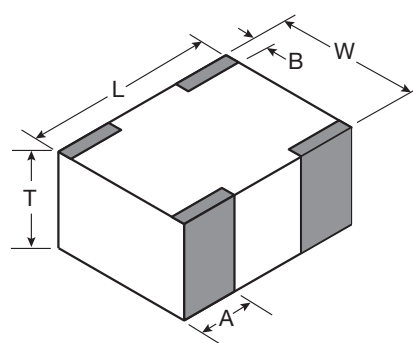

**mm (inches)**

|   |                            |
|---|----------------------------|
| L | 3.08±0.1<br>(0.121±0.004)  |
| W | 1.60±0.1<br>(0.063±0.004)  |
| T | 0.87±0.1<br>(0.034±0.004)  |
| A | 0.61±0.25<br>(0.028±0.010) |
| B | 0.35±0.15<br>(0.014±0.006) |

### TERMINALS AND LAYOUT (Top View)

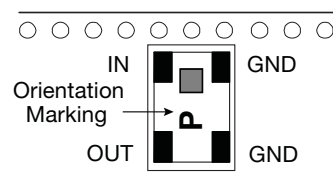

# LP1206 SMD High Performance Low Pass Filter **AVX RF**

LP1206A3800ASTR

## ELECTRICAL CHARACTERISTICS

| P/N             | I.Loss<br>@ 3.8GHz | R.Loss<br>@ 3.8GHz | Attenuation (min.)                                    |
|-----------------|--------------------|--------------------|---|
| LP1206A3800ASTR | 0.8dB max.         | -20dB              | -35dB at 5.32GHz<br>-28dB at 7.6GHz<br>-33dB at 10GHz |

## TYPICAL ELECTRICAL PERFORMANCE

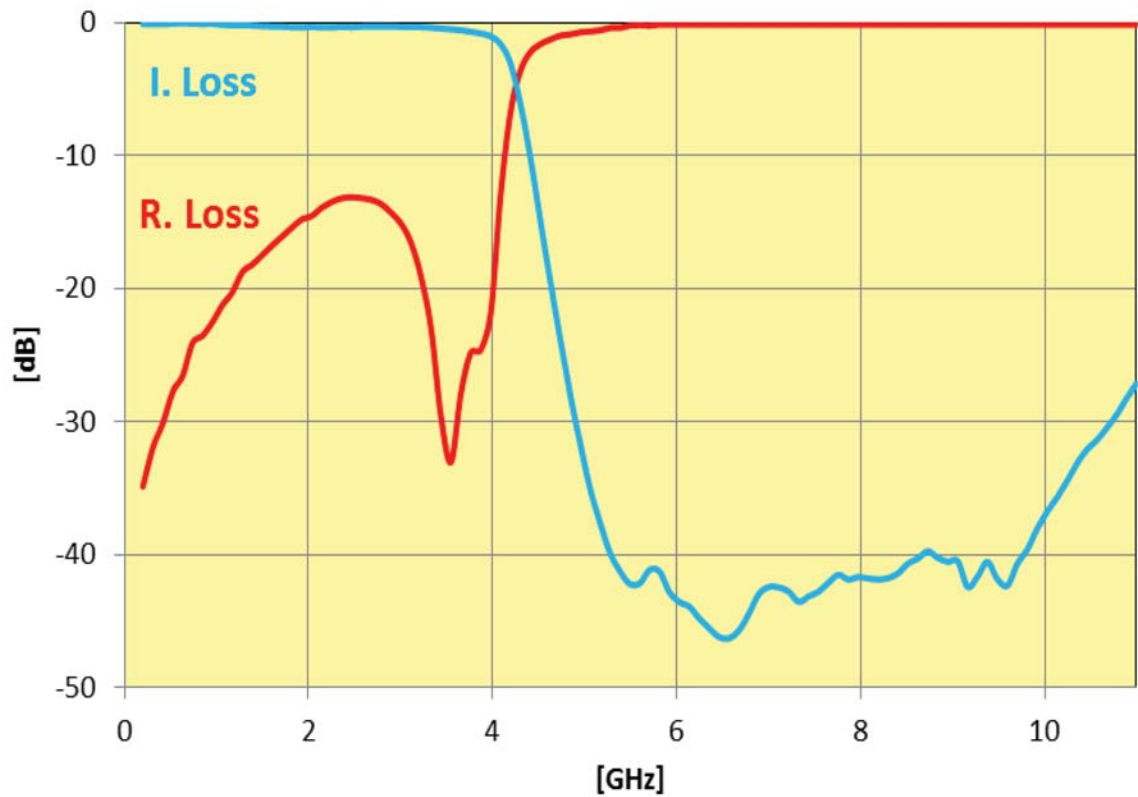

# Mouser Electronics

Authorized Distributor

Click to View Pricing, Inventory, Delivery & Lifecycle Information:

[AVX:](#)

[LP1206A0700ASTR](#) [LP1206A3800ASTR](#) [LP1206A3600ASTR](#) [LP1206A3200ASTR](#) [LP1206A0860ASTR](#)  
[LP1206A3500ASTR](#) [LP1206A3200ASTR\500](#)