

DATE: _____ TITLE: _____

Rev	AWO #	Description	Date	Appr
-		RELEASED	10/19/18	
A		UPDATE DIM.	12/26/24	WY/FH

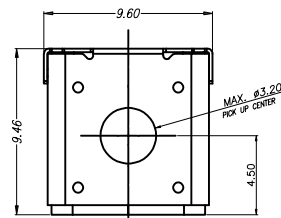

PIN ASSIGNMENT												
A1	A2	A3	A4	A5	A6	A7	A8	A9	A10	A11	A12	A13
GND	TX1-	TX1-	VBUS	CC1	D+	D-	RFU1	VBUS	RX2-	RX2+	GND	
GND	RX1+	RX1-	VBUS	RFU2	D-	D+	CC2	VBUS	TX2-	TX2-	GND	
R12	B11	B10	B9	B8	B7	B6	B5	B4	B3	B2	B1	

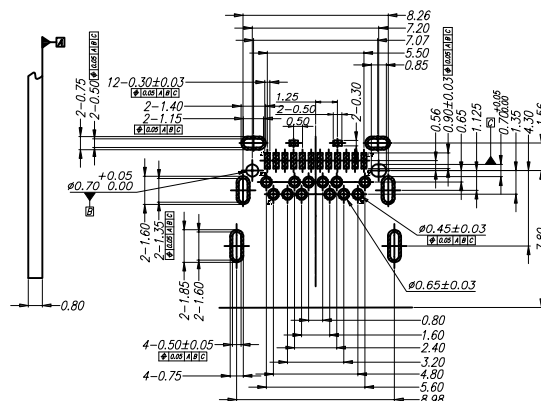

RECOMMENDED PCB LAYOUT
(TOP VIEW)

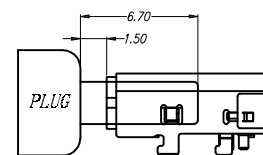
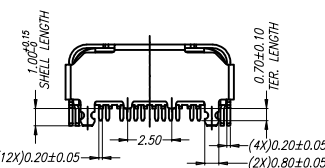
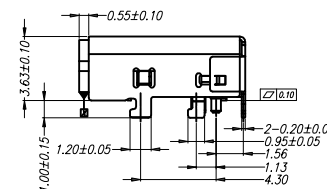
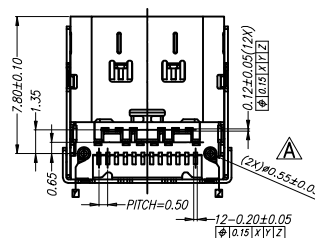
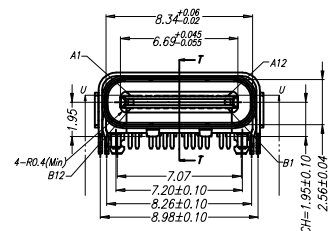

MATING CONDITION

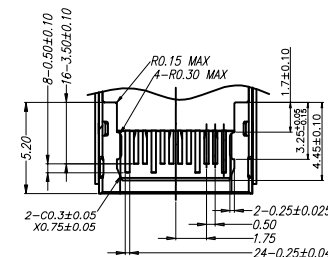

SECTION U-U

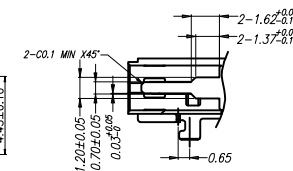

SECTION T-T

Material:

Insulator: Hi-Temp Thermoplastic, rated UL 94V-0
Insulator color: Black
Contacts: Copper Alloy
MID-Plate: Stainless Steel
Shell: Stainless Steel
Outer Shell: Stainless Steel

Plating:

Gold flash over Nickel underplate on contact area,
Matte Tin over Nickel underplate on solder tails.

Electrical:

Voltage rating: 20V
 Current rating: 5A for VBUS Pins (A4, A9, B4, B9)
 1.25A for GND Pins (A1, A12, B1, B12)
 0.25A for Other Pins

Contact resistance: 40 mohms max for VBUS GND & Other Contact
50 mohms max After Environment Test.
Measure at 20mV, 100mA

Mechanical:

Insertion force: 5~20N
Withdrawal force: 8~20N
Durability: 10,000 cycles

Temperature Rating:
Operating temperature: -55°C to $+85^{\circ}\text{C}$

Environmental:

Lead free, RoHS compliant.



PACKAGED ON TAPE & REEL

UNLESS OTHERWISE SPECIFIED ALL DIMENSIONS
ARE MILLIMETERS. TOLERANCES: EXCEPT AS NOTED

	MM		ANGLE
X	± 0.50	X	± 1°
X.X	± 0.25		
X.XX	± 0.15		
X.XXX	± 0.10		

DRAWN	AY	10/19/18
CHECKED	TW	10/19/18
APPROVED		

THIS DRAWING CONTAINS INFORMATION THAT IS PROPRIETARY
AND SHOULD NOT BE USED WITHOUT PRIOR WRITTEN
PERMISSION FROM ADAM TECH

ADAM TECH

909 Rahway Avenue,
Union, NJ 07083
Phone: 908-687-5000
Fax: 908-687-5710

TITLE	UNIVERSAL SERIAL BUS, TYPE C, FEMALE, HYBRID TYPE, RIGHT ANGLE, H=3.63 MM
-------	--

SIZE X	PART NO. USB-C31-S-RA-CS12-BK-T/R	REV. A
REF: S00288T	SCALE: NTS	SHEET 1 OF 1

Mouser Electronics

Authorized Distributor

Click to View Pricing, Inventory, Delivery & Lifecycle Information:

[Adam Tech:](#)

[USB-C31-S-RA-CS12-BK-TR](#)