

APPROVED: _____
 DATE: _____ TITLE: _____

Rev	AWO #	Description	Date	Appr
-		RELEASED	12/24/20	
A		UPDATE TITLE	6/25/21	JJ/RC

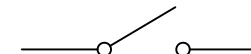
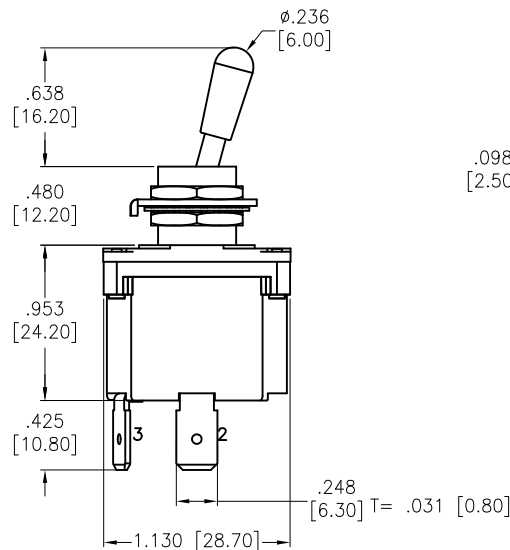
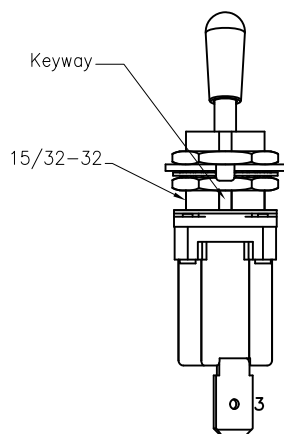
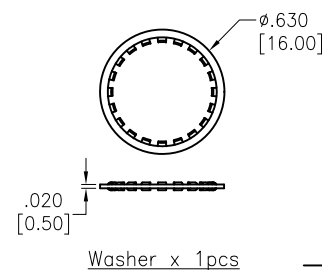
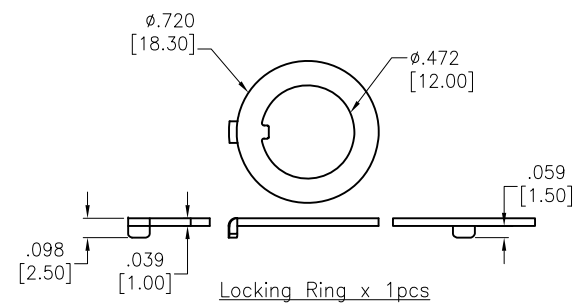
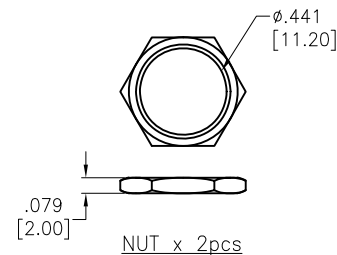
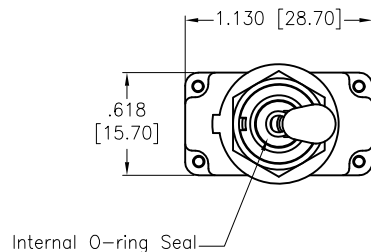
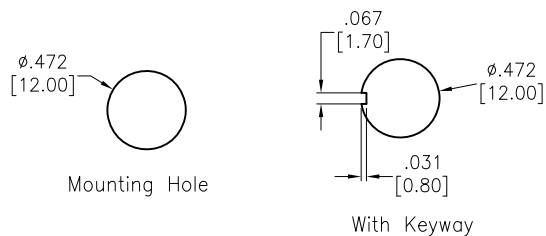

CIRCUIT DIAGRAM
(SPST) ON-OFF

SPECIFICATIONS:

Material:

Movable contact: Copper Alloy, Silver plated

Terminals: Brass, Tin plated

Electrical:

Rating: 12A @ 125/250VAC

1/2 HP 125VAC/ 1HP 250VAC/5A 125VAC

Contact resistance: 20 mohms max initial

Insulation resistance: 100 Mohms min @ 500 VDC

Dielectric withstanding voltage: 1500V RMS @ sea level

Electrical life: 30,000 make and break cycles at full load

Temperature Rating:

Operating temperature: -30°C to +85°C

Environmental:

IP68 Protection Class

Lead free, RoHS compliant



UNLESS OTHERWISE SPECIFIED ALL DIMENSIONS
ARE INCHES [MM]. TOLERANCES: EXCEPT AS NOTED

INCHES	HOLES
.X ± .10	ØX ± .10
.XX ± .020	ØXX ± .015
.XXX ± .015	ØXXX ± .010

DRAWN	OW	12/24/20
CHECKED	AC	12/24/20
APPROVED		

THIS DRAWING CONTAINS INFORMATION THAT IS PROPRIETARY
AND SHOULD NOT BE USED WITHOUT PRIOR WRITTEN
PERMISSION FROM ADAM TECH

**ADAM
TECH**

909 Rahway Avenue,
Union, NJ 07083
Phone: 908-687-5000
Fax: 908-687-5710

TITLE
POWER TOGGLE SWITCH, SPST,
ON-ON, QC .250 [6.35MM]

SIZE X	PART NO. SW-T4-1A-E-TA1-01	REV. A
REF: S00198T	SCALE: NTS	SHEET 1 OF 1

Mouser Electronics

Authorized Distributor

Click to View Pricing, Inventory, Delivery & Lifecycle Information:

[Adam Tech:](#)

[SW-T4-1A-E-TA1-01](#)