

APPROVED: _____
DATE: _____ TITLE: _____

Rev	AWO #	Description	Date	Appr
-		RELEASED	8/11/21	
A		UPDATED SPEC.	5/27/22	JJ/MC
B		UPDATED SPEC.	11/22/22	WX/AC1

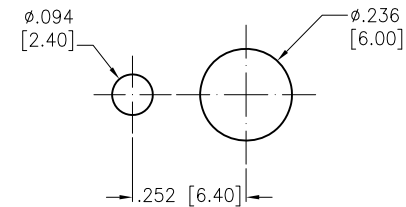

RECOMMENDED
PANEL CUT-OUT

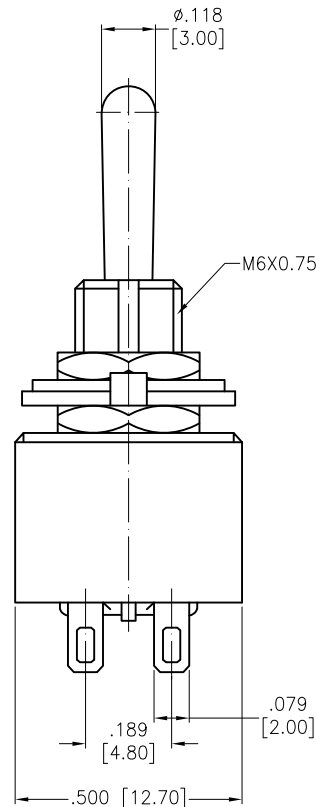
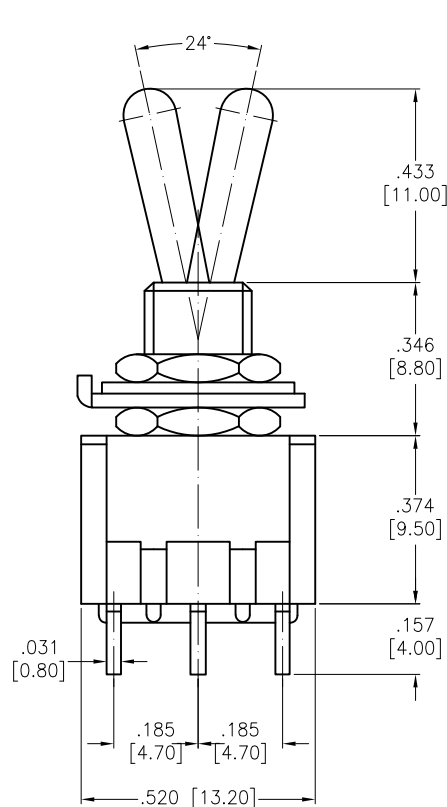
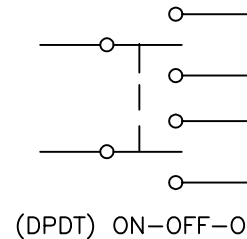

(DPDT) ON-OFF-ON

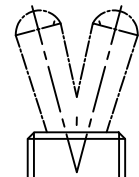

2 WAY

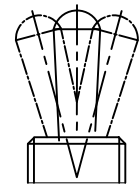

3 WAY

SW-T2-4X-A-A2-MA2

- B=ON-ON (2 WAY)
- D=ON-(ON) (2 WAY)
- E=ON-OFF-ON (3 WAY)
- F=ON-OFF-(ON) (3 WAY)
- G=(ON)-OFF-(ON) (3 WAY)
- H=ON-ON-ON (3 WAY)

SPECIFICATIONS:

Material:

Body: Bakelite, Color: Red **B**

Lever: Brass, Nickel plated

Terminal: Brass, Silver plated

Electrical:

Rating: 3A @ 250V AC

6A @ 125V AC

Contact resistance: 20 mΩ max

Insulation resistance: 1000 MΩ min (500VDC)

Dielectric withstanding voltage: 1500V AC for 1 minute

Electrical Life: 10,000 cycles

Temperature Rating:

Operating temperature: -25°C to +85°C

Environmental:

Lead free, RoHS compliant



UNLESS OTHERWISE SPECIFIED ALL DIMENSIONS
ARE INCHES [MM]. TOLERANCES: EXCEPT AS NOTED

INCHES	HOLES
.X ± .10	ØX ± .10
.XX ± .020	ØXX ± .015
.XXX ± .015	ØXXX ± .010

DRAWN	JJ	8/11/21
CHECKED	RC	8/11/21
APPROVED		

THIS DRAWING CONTAINS INFORMATION THAT IS PROPRIETARY
AND SHOULD NOT BE USED WITHOUT PRIOR WRITTEN
PERMISSION FROM ADAM TECH

**ADAM
TECH**

909 Rahway Avenue,
Union, NJ 07083
Phone: 908-687-5000
Fax: 908-687-5710

TITLE
SWITCH, TOGGLE MINIATURE, DPDT,
ON-OFF-ON, SOLDER TYPE

SIZE X	PART NO. SW-T2-4X-A-A2-MA2	REV. B
REF: -	SCALE: NTS	SHEET 1 OF 1

Mouser Electronics

Authorized Distributor

Click to View Pricing, Inventory, Delivery & Lifecycle Information:

[Adam Tech:](#)

[SW-T2-4E-A-A2-MA2](#)