

APPROVED: \_\_\_\_\_  
DATE: \_\_\_\_\_ TITLE: \_\_\_\_\_

Rev	AWO #	Description	Date	Appr
-		RELEASED	11/16/20	

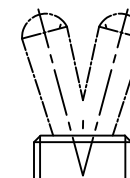

2 WAY

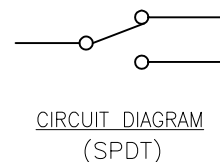
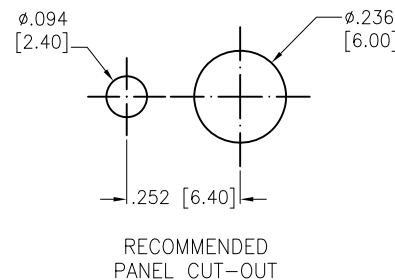
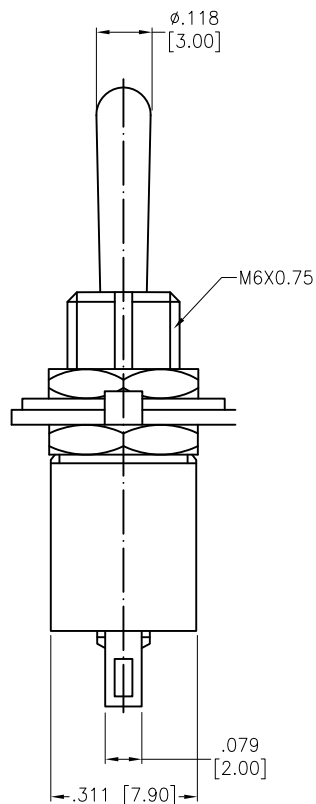
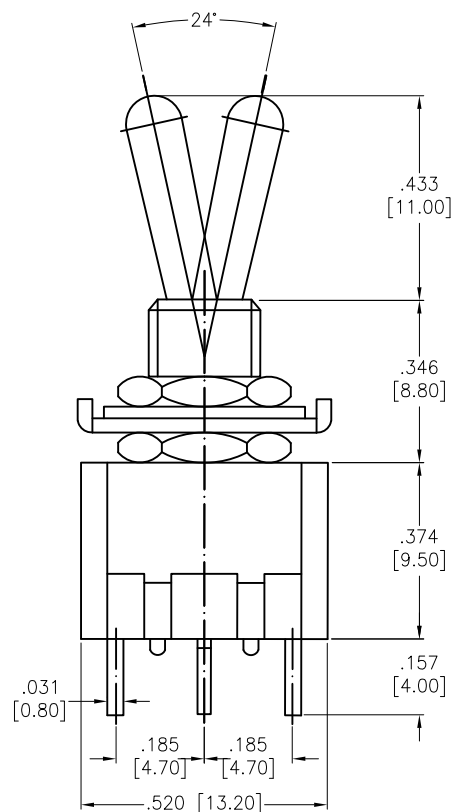
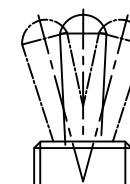

3 WAY

SW-T2-2X-A-A2-M1  
—B=ON-ON  
—D=ON-(ON)  
—E=ON-OFF-ON  
—F=ON-OFF-(ON)  
—G=(ON)-OFF-(ON)

#### SPECIFICATIONS:

##### Material:

Body: Bakelite, Color: Black

Lever: Brass, Nickel plated

Terminal: Brass, Silver plated

##### Electrical:

Rating: 3A @ 250V AC

6A @ 125V AC

Contact resistance: 20 mΩ max

Insulation resistance: 1000 MΩ min (500VDC)

Dielectric withstanding voltage: 1500V AC for 1 minute

Electrical Life: 10,000 cycles

Temperature Rating:

Operating temperature: -25°C to +85°C

Environmental:

Lead free, RoHS compliant



UNLESS OTHERWISE SPECIFIED ALL DIMENSIONS  
ARE INCHES [MM]. TOLERANCES: EXCEPT AS NOTED

INCHES	HOLES
.X ± .10	ØX ± .10
.XX ± .020	ØXX ± .015
.XXX ± .015	ØXXX ± .010

DRAWN	OW	11/16/20
CHECKED	AC	11/16/20
APPROVED		

THIS DRAWING CONTAINS INFORMATION THAT IS PROPRIETARY  
AND SHOULD NOT BE USED WITHOUT PRIOR WRITTEN  
PERMISSION FROM ADAM TECH

**ADAM**  
**TECH**

909 Rahway Avenue,  
Union, NJ 07083  
Phone: 908-687-5000  
Fax: 908-687-5710

TITLE	SWITCH, TOGGLE MINIATURE, SPDT, SOLDER TYPE		
SIZE	PART NO.	REV.	
X	SW-T2-2X-A-A2-M1	-	
REF:	S00204C	SCALE:	NTS SHEET 1 OF 1

# Mouser Electronics

Authorized Distributor

Click to View Pricing, Inventory, Delivery & Lifecycle Information:

[Adam Tech:](#)

[SW-T2-2E-A-A2-M1](#)