

APPROVED: \_\_\_\_\_

DATE: \_\_\_\_\_ TITLE: \_\_\_\_\_

| Rev | AWO # | Description | Date     | Appr |
|-----|-------|-------------|----------|------|
| -   |       | RELEASED    | 11/18/21 |      |

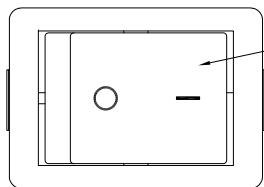

LIGHTED WITH  
WHITE MARKINGS

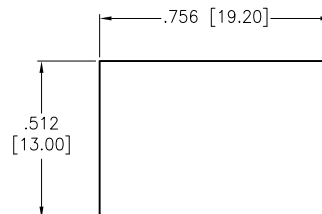

RECOMMENDED  
PANEL CUT-OUT

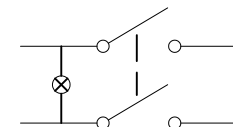

CIRCUIT DIAGRAM  
(DPST) ON-OFF

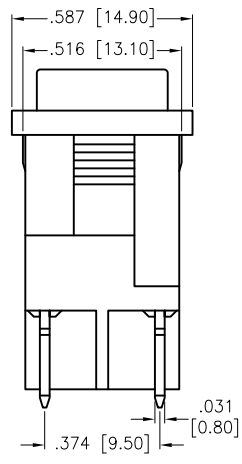
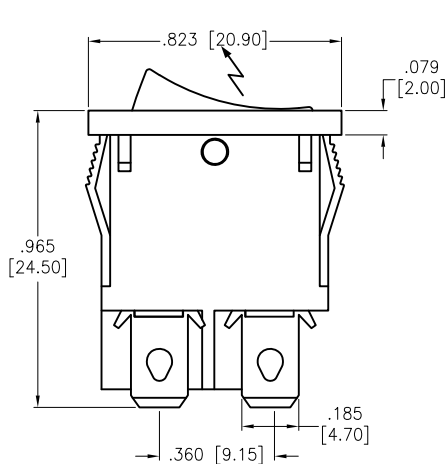

SW-R2-3A-F-LXXX-4

|   | Lighted Actuator       |
|---|------------------------|
| W | Lighted White          |
| R | Lighted Red            |
| G | Lighted Green          |
| Y | Lighted Yellow (Amber) |
| B | Lighted Blue           |
| O | Lighted Orange         |

|   | Actuator Markings |
|---|-------------------|
| 1 |                   |
| 2 |                   |
| 3 |                   |
| 4 |                   |
| 5 |                   |

|   | LED Voltage |
|---|-------------|
| 1 | 3V          |
| 2 | 6V          |
| 3 | 12V         |
| 4 | 24V         |
| 5 | 48V         |
| 6 | 110V        |
| 7 | 220V        |

SPECIFICATIONS:

Material:

Body: Nylon 66, Color Black, Rated UL 94V-0

Terminal: Brass, Silver plated

Button: Nylon 66, Lighted color (See Chart). White color markings

Electrical:

Rating: 10A @ 125V AC  
6A @ 250V AC

Contact resistance: 50 mohms max (Initial)

Insulation resistance: 100 mohms min @ 500V AC

Dielectric withstanding voltage: 1500V AC for 1 Min.

Electrical Life: 10,000 cycles min.

Mechanical:

Operating Life: 100,000 cycles min.

Temperature Rating:

Operating temperature: -25°C to +85°C

Environmental:

Lead free, RoHS compliant



Replace "x" in P/N with the corresponding switch color and marking

|  |              |          |                          |  |   |  |
|--|--------------|----------|--------------------------|--|---|--|
| UNLESS OTHERWISE SPECIFIED ALL DIMENSIONS<br>ARE INCHES [MM]. TOLERANCES: EXCEPT AS NOTED  |              |          | <div>ADAM<br/>TECH</div> |  | 909 Rahway Avenue,<br>Union, NJ 07083<br>Phone: 908-687-5000<br>Fax: 908-687-5710 |  |
| INCHES   |              | HOLES    |                          |  |   |  |
| .X ± .10   | Ø.X ± .10    |          |                          |  |   |  |
| .XX ± .020   | Ø.XX ± .015  |          |                          |  |   |  |
| .XXX ± .015  | Ø.XXX ± .010 |          |                          |  |   |  |
| DRAWN  | JJ           | 11/18/21 |                          | TITLE<br>SWITCH, ROCKER, DPST, ON-OFF, COLOR<br>BLACK, PANEL MOUNT, .187" [4.8] SOLDER |   |  |
| CHECKED  | RC           | 11/18/21 |                          |  |   |  |
| APPROVED   |              |          |                          |  |   |  |
| THIS DRAWING CONTAINS INFORMATION THAT IS PROPRIETARY<br>AND SHOULD NOT BE USED WITHOUT PRIOR WRITTEN<br>PERMISSION FROM ADAM TECH |              |          | SIZE<br>X                | PART NO.<br>SW-R2-3A-F-LXXX-4  | REV.<br>-   |  |
|  |              |          | REF: S00206C             | SCALE: NTS   | SHEET 1 OF 1  |  |

# Mouser Electronics

Authorized Distributor

Click to View Pricing, Inventory, Delivery & Lifecycle Information:

[Adam Tech:](#)

[SW-R2-3A-F-LR13-4](#)