

6

5

4

3

2

1

APPROVED: _____

DATE: _____ TITLE: _____

Rev

AWO #

Description

Date

Appr

-

RELEASED

2/8/21

D

D

C

C

B

B

A

A

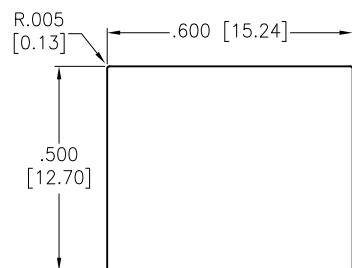
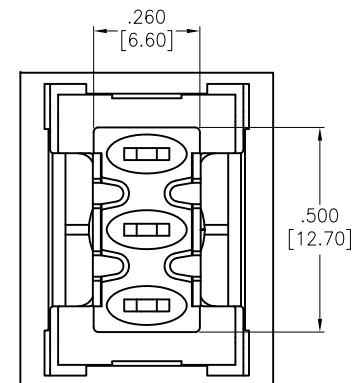
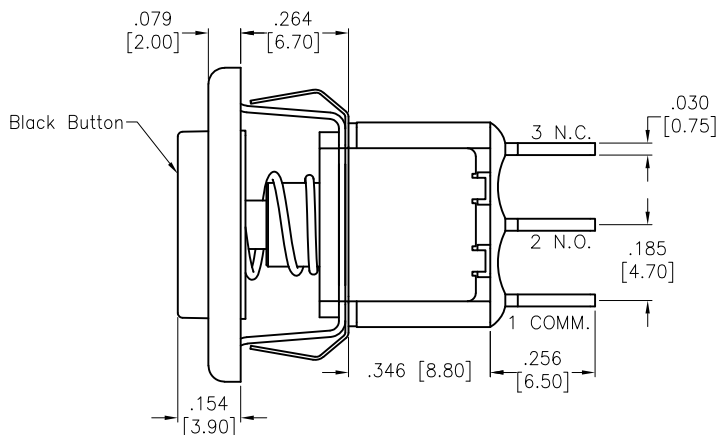
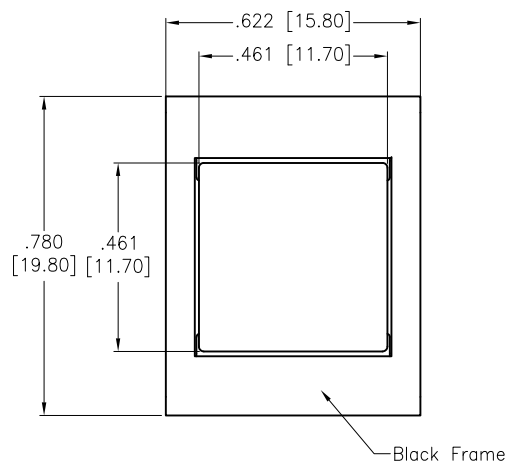

P.C MOUNTING

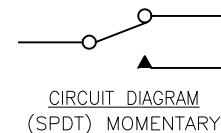
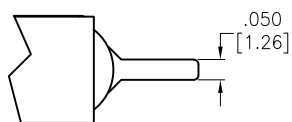
CIRCUIT DIAGRAM
(SPDT) MOMENTARY

SPECIFICATIONS:

Material:

Movable Contact: Copper Alloy, Silver Plated

Terminal: Copper Alloy, Silver Plated

Electrical:

Voltage rating: 120VAC or 38VDC

Current rating: 1 Amps

Contact resistance: 10 mΩ max

Insulation resistance: 1,000 Mohms min

Dielectric withstanding voltage: 1,500V RMS @Sea level

Temperature Rating:

Operating temperature: -30°C to +85°C

Environmental:

Lead free, RoHS compliant

UNLESS OTHERWISE SPECIFIED
ALL DIMENSIONS ARE INCHES [MM]
TOLERANCES: EXCEPT AS NOTED
INCHES HOLES

| | | | |
|------|--------|-------|--------|
| .X | ± .10 | Ø.X | ± .10 |
| .XX | ± .020 | Ø.XX | ± .015 |
| .XXX | ± .015 | Ø.XXX | ± .010 |

APPROVALS

DATE

DRAWN

LH

2/8/21

CHECKED

AC

2/8/21

APPROVED

ADAM
TECH909 Rahway Avenue,
Union, NJ 07083
Phone: 908-687-5000
Fax: 908-687-5710

TITLE

SNAP-ACTING PUSH BUTTON SWITCH, BLACK FRAME
SPDT, ON-MOMENTARY, SILVER PLATED, PCB TYPE

SIZE

X

PART NO.

SW-PB8-AE222QE-1

REV.

-

REF: S00198T

SCALE: NTS

SHEET 1 OF 1

6

5

4

3

2

1

Mouser Electronics

Authorized Distributor

Click to View Pricing, Inventory, Delivery & Lifecycle Information:

[Adam Tech:](#)

[SW-PB8-AE222QE-1](#)