

APPROVED: \_\_\_\_\_  
 DATE: \_\_\_\_\_ TITLE: \_\_\_\_\_

Rev	AWO #	Description	Date	Appr
-		RELEASED	2/9/21	

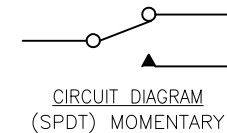
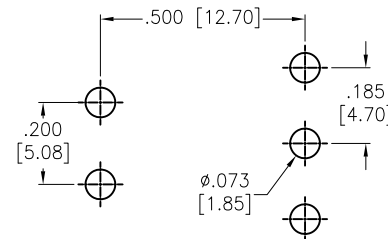
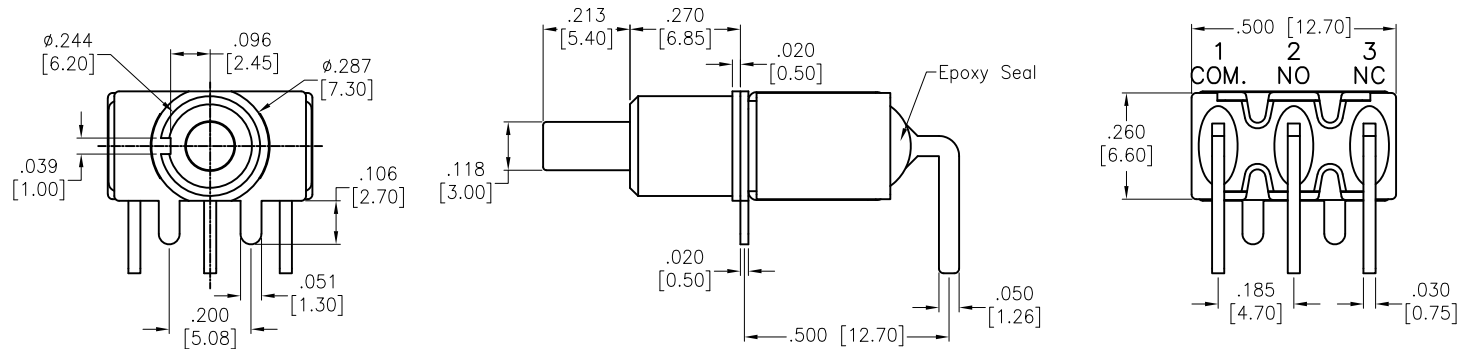

RECOMMENDED PCB LAYOUT

#### SPECIFICATIONS:

Material:  
 Movable Contact: Copper Alloy, Silver Plated  
 Terminal: Copper Alloy, Silver Plated  
 Electrical:  
 Voltage rating: 120VAC or 38VDC  
 Current rating: 1 Amps  
 Contact resistance: 10 m $\Omega$  max  
 Insulation resistance: 1,000 Mohms min  
 Dielectric withstanding voltage: 1,500V RMS @Sea level  
 Temperature Rating:  
 Operating temperature: -30°C to +85°C  
 Environmental:  
 Lead free, RoHS compliant



UNLESS OTHERWISE SPECIFIED ALL DIMENSIONS ARE INCHES [MM] TOLERANCES: EXCEPT AS NOTED INCHES HOLES .X $\pm$ .10 $\phi$ .X $\pm$ .10 .XX $\pm$ .020 $\phi$ .XX $\pm$ .015 .XXX $\pm$ .015 $\phi$ .XXX $\pm$ .010				<b>ADAM TECH</b> 909 Rahway Avenue, Union, NJ 07083 Phone: 908-687-5000 Fax: 908-687-5710	
APPROVALS DRAWN LH 2/8/21 CHECKED AC 2/8/21 APPROVED				TITLE SNAP-ACTING PUSH BUTTON SWITCH, R/A, THRU-HOLE SPDT, ON-MOMENTARY, SILVER PLATED, PCB TYPE	
SIZE X		PART NO. SW-PB8-AB00B6QE-1		REV. -	
REF: S00198T		SCALE: NTS		SHEET 1 OF 1	

# Mouser Electronics

Authorized Distributor

Click to View Pricing, Inventory, Delivery & Lifecycle Information:

[Adam Tech:](#)

[SW-PB8-AB00B6QE-1](#)