

APPROVED: _____
DATE: _____ TITLE: _____

Rev	AWO #	Description	Date	Appr
-		RELEASED	10/23/07	
A		REDRAWN	10/3/11	

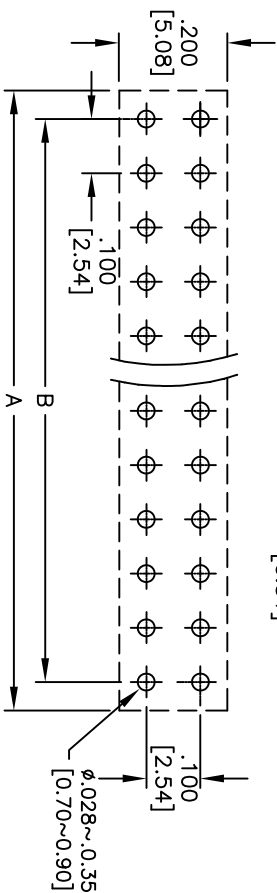
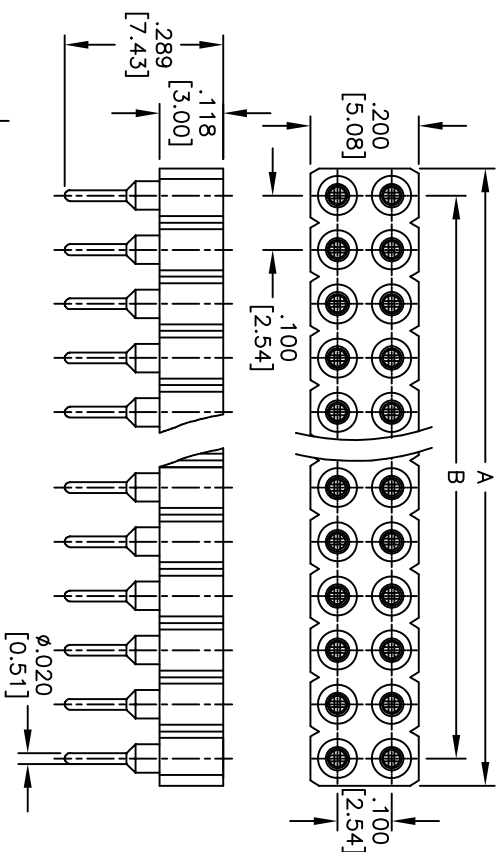

RECOMMENDED PCB LAYOUT

Positions: 2 thru 80
A = .100 [2.54] x No. of Positions per Row
B = .100 [2.54] x No. of Spaces per Row

SPECIFICATIONS:

Material: PBT, Glass reinforced, rated UL 94V-0
Insulator color: Black
Contacts: Copper alloy
Sleeve: Brass
Plating:
Inner contact: Gold flash over Nickel underplate
Outer sleeve: Tin over Copper underplate overall
Electical:
Rated voltage : 100V RMS/ 150VDC
Current rating: 3 Amp
Contact resistance: 4 mohms max
Insulation resistance: 10,000 Mohms min @ 500 VAC
Mechanical :
Average insertion force : < 250g
With steel pin of $\phi .017$ [0.43]mm
Average withdrawal force : > 50g
With steel pin of $\phi .017$ [0.43]mm
Mechanical life : min. 200
Temperature Rating:
Operating temperature : Gold plated : -55°C to $+125^{\circ}\text{C}$
(Continuous) Tin plated : -40°C to $+105^{\circ}\text{C}$
Environmental:
Lead free, RoHS compliant



ADAM TECH

909 Rahway Avenue, Union, NJ 07083
Phone: 908-687-5000 Fax: 908-687-5710

SCREW MACHINE CONTACT SOCKET
.100" X .100" SPACING, GOLD / TIN PLATED

UNLESS OTHERWISE SPECIFIED ALL DIMENSIONS ARE INCHES [MM] TOLERANCES: EXCEPT AS NOTED				TITLE			
INCHES	HOLES			SIZE	PART NO.	REV.	
.X $\pm .10$	$\phi .10$	$\pm .10$		X	SMC-2-XX-1-GT	A	
.XX $\pm .020$	$\phi .XX$	$\pm .015$					
.XXX $\pm .015$	$\phi .XXX$	$\pm .010$					
APPROVALS	DATE						
DRAWN	SS	10/23/07					
CHECKED							
APPROVED							
				REF:	S00007T	SCALE: NTS	SHEET 1 OF 1

Mouser Electronics

Authorized Distributor

Click to View Pricing, Inventory, Delivery & Lifecycle Information:

[Adam Tech:](#)

[SMC-2-28-1-GT](#) [SMC-2-80-1-GT](#) [SMC-2-08-1-GT](#) [SMC-2-06-1-GT](#) [SMC-2-10-1-GT](#) [SMC-2-12-1-GT](#) [SMC-2-04-1-GT](#) [SMC-2-02-1-GT](#)