

6

5

4

3

2

1

Rev	AWO #	Description	Date	Appr
-		RELEASED	3/28/06	

APPROVED: _____

DATE: _____ TITLE: _____

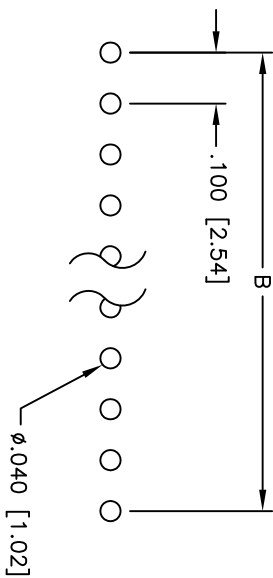
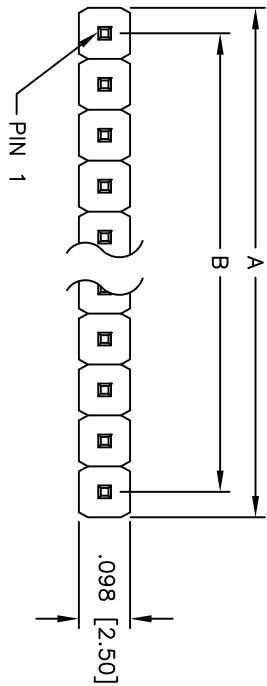

PCB LAYOUT

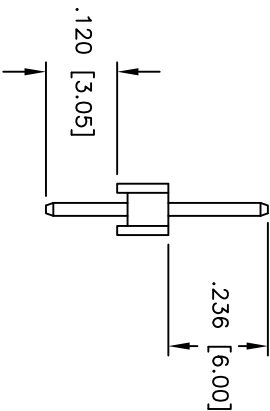
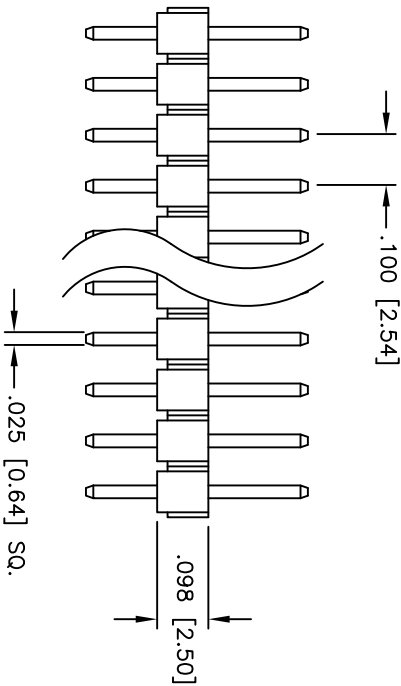

SPECIFICATIONS:

Material:

Insulator: PBT, glass reinforced, rated UL 94V-0

Insulator color: Black

Contacts: Brass

Plating:

Gold flash over Nickel underplate overall

Electrical:

Operating voltage: 250 VAC max

Current rating: 3 Amps max

Contact resistance: 20 mohms max

Insulation resistance: 5,000 Mohms min @ 500 VDC

Dielectric withstanding voltage: 1,000 VAC for 1 minute

Environmental:

Lead free, RoHS compliant



Positions: 1 thru 40
A = .100 [2.54] x No. of Positions
B = .100 [2.54] x No. of Spaces

ADAM TECH

909 Rahway Avenue, Union, NJ 07083
Phone: 908-687-5000 Fax: 908-687-5710

TITLE
.100 [2.54] SINGLE ROW PIN HEADER
GOLD PLATED

UNLESS OTHERWISE SPECIFIED ALL DIMENSIONS ARE INCHES [MM] TOLERANCES: EXCEPT AS NOTED INCHES HOLES			ADAM TECH		
.X ± .10 .XX ± .020 .XXX ± .015	Ø.X ± .10 Ø.XX ± .015 Ø.XXX ± .010		909 Rahway Avenue, Union, NJ 07083 Phone: 908-687-5000 Fax: 908-687-5710		
APPROVALS		DATE	TITLE .100 [2.54] SINGLE ROW PIN HEADER GOLD PLATED		
DRAWN	L.F.J	3/28/06	SIZE PART NO.		
CHECKED			X PH1-XX-UA		
APPROVED			REF:	SCALE: NTS	SHEET 1 OF 1
					REV. -

Mouser Electronics

Authorized Distributor

Click to View Pricing, Inventory, Delivery & Lifecycle Information:

[Adam Tech:](#)

<u>PH1-40-UA</u>	<u>PH1-10-UA</u>	<u>PH1-20-UA</u>	<u>PH1-04-UA</u>	<u>PH1-12-UA</u>	<u>PH1-15-UA</u>	<u>PH1-17-UA</u>	<u>PH1-08-UA</u>	<u>PH1-19-UA</u>
<u>PH1-21-UA</u>	<u>PH1-31-UA</u>	<u>PH1-34-UA</u>	<u>PH1-18-UA</u>	<u>PH1-07-UA</u>	<u>PH1-05-UA</u>	<u>PH1-32-UA</u>	<u>PH1-09-UA</u>	<u>PH1-38-UA</u>
<u>PH1-22-UA</u>	<u>PH1-25-UA</u>	<u>PH1-06-UA</u>	<u>PH1-01-UA</u>	<u>PH1-03-UA</u>	<u>PH1-11-UA</u>	<u>PH1-13-UA</u>	<u>PH1-33-UA</u>	<u>PH1-02-UA</u>
<u>PH1-39-UA</u>	<u>PH1-30-UA</u>	<u>PH1-23-UA</u>	<u>PH1-14-UA</u>	<u>PH1-16-UA</u>	<u>PH1-24-UA</u>	<u>PH1-35-UA</u>	<u>PH1-36-UA</u>	<u>PH1-37-UA</u>