

6	5	4	3	2	1
APPROVED: _____			Rev	AWO #	Description
DATE: _____ TITLE: _____			-		RELEASED
					Date
					5/12/20
					Appr

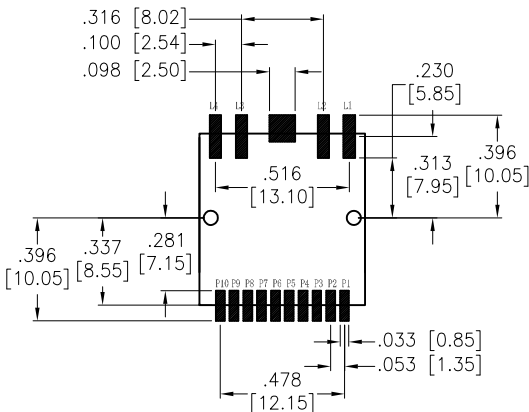
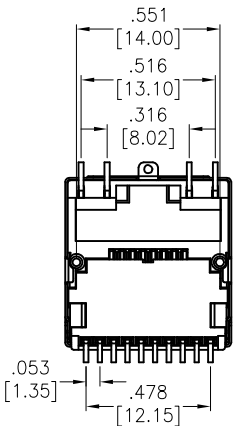
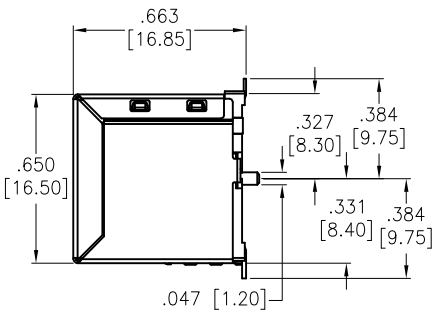
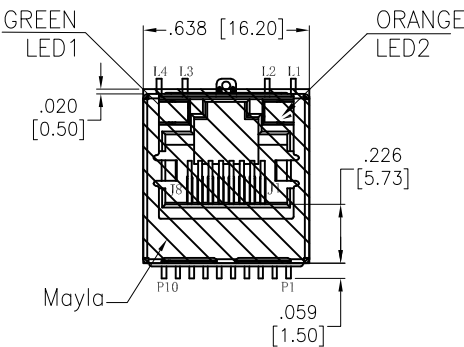

RECOMMENDED PCB LAYOUT

SPECIFICATIONS:

Material:
 Insulator: Hi-Temp Thermoplastic, rated UL 94V-0
 Insulator color: Black
 Contacts: Phosphor Bronze
 Shield: Brass, Nickel plated
 Contact Plating:
 Round contact
 Gold over Nickel underplate overall
 Flat contact
 Gold over Nickel underplate on contact area,
 Tin over Nickel underplate on solder tails

Electrical:
 Voltage rating: 150 VAC
 Contact Resistance: 20 mohms max
 Insulation resistance: 500 Mohms min
 Dielectric withstanding voltage: 2250 VDC For 1 Minute

Temperature Rating:
 Operating temperature: -40°C to +85°C

Agency Certifications:

UL Recognized 

Environmental:

Lead free, RoHS compliant.



UNLESS OTHERWISE SPECIFIED ALL DIMENSIONS ARE INCHES [MM] TOLERANCES: EXCEPT AS NOTED INCHES HOLES .X ± .10 Ø.X ±.10 .XX ± .020 Ø.XX ±.015 .XXX ± .015 Ø.XXX ±.010			<div>ADAM TECH</div> INTERCONNECTS		909 Rahway Avenue, Union, NJ 07083 Phone: 908-687-5000 Fax: 908-687-5710	
APPROVALS			DATE			
DRAWN	LH		5/12/20			
CHECKED	AC		5/12/20			
APPROVED						
TITLE			MODULAR TELEPHONE JACK, 8P8C W/ LED1 GREEN, W/ LED2 ORANGE, 2.5G BASE-T			
SIZE		PART NO.			REV.	
X		MTJ-88AX1-FS-TSMT-P-L5-M398CH-WOT-KT			-	
REF: S00005C		SCALE: NTS		SHEET 1 OF 2		

654321

RevAWO #DescriptionDateAppr

SEE SHT 1 OF 2 FOR REVISION

APPROVED: _____
DATE: _____ TITLE: _____

BOARD SIDE

CABLE SIDE

TCT P5

TD1+ P1

TD1- P2

TD2+ P3

TD2- P4

TD3+ P7

TD3- P8

TD4+ P9

TD4- P10

TCT P6

SHIELD

1CT:1CT

1CT:1CT

1CT:1CT

1CT:1CT

75 OHM

75 OHM

75 OHM

75 OHM

J1

J2

J3

J6

J4

J5

J7

J8

L4

L3

L2

L1

G

O

Pin	Green		ORANGE
L4	+	L2	+
L3	-	L1	-

CAP 1000pF 2KV

Electronical Specifications:

PARAMETER	SPECIFICATIONS			
Turns Ratio	1.00 ± 2%			
Polarity	PER SCHEMATIC			
Insertion Loss (Data Channels)	1MHz-50MHz	50-125 MHz	125-250 MHz	
	-0.5dB MAX	-1.0dB MAX	-2.0 dB MAX	
Return Loss (Z OUT=100 OHM ±1%)	1MHz TO 40MHz		40MHz TO 250MHz	
	-20dB MIN		-16+10Log(Freq MHz/40MHz)dB MIN	
Inductance (OCL)	180 uH MIN @ 100 KHz, 100 mV			
Reflected CM to DIFF Conversion (REF)	1 MHz	50 MHz	100 MHz	200 MHz
	-30dB MAX	-30dB MAX	-27dB MAX	-24dB MAX
Reflected DIFF to CM Conversion (REF)	1 MHz TO 10 MHz		10 MHz TO 200 MHz	
	-48 dB MIN		-48+19Log(Freq MHz/10MHz) dB MIN	
CM to CM Attenuation (REF)	1 MHz-200MHz			
	-25dB MIN			
CROSS TALK	1 MHz TO 40 MHz		40 MHz TO 125 MHz	
	-35dB MIN		-35+15log(Freq MHz/40MHz)dB MIN	
HIPOT-OUTPUT ISOLATION	2250 VDC MIN @ 60 SECONDS			

UNLESS OTHERWISE SPECIFIED
ALL DIMENSIONS ARE INCHES [MM]
TOLERANCES: EXCEPT AS NOTED

INCHES		HOLES	
.X	± .10	Ø.X	±.10
.XX	± .020	Ø.XX	±.015
.XXX	± .015	Ø.XXX	±.010

APPROVALS		DATE
DRAWN	LH	5/12/20
CHECKED	AC	5/12/20
APPROVED		

ADAMTECH

INTERCONNECTS

909 Rahway Avenue,
Union, NJ 07083
Phone: 908-687-5000
Fax: 908-687-5710

TITLE

MODULAR TELEPHONE JACK, 8P8C
W/ LED1 GREEN, W/ LED2 ORANGE, 2.5G BASE-T

SIZE	PART NO.	REV.
X	MTJ-88AX1-FS-TSMT-P-L5-M398CH-WOT-KT	-

REF:	SCALE:	SHEET
S00005C	NTS	2 OF 2

654321

SEE SHT 1 OF 2 FOR REVISION

APPROVED: _____
DATE: _____ TITLE: _____

BOARD SIDE

CABLE SIDE

TCT P5

TD1+ P1

TD1- P2

TD2+ P3

TD2- P4

TD3+ P7

TD3- P8

TD4+ P9

TD4- P10

TCT P6

SHIELD

1CT:1CT

1CT:1CT

1CT:1CT

1CT:1CT

75 OHM

75 OHM

75 OHM

75 OHM

J1

J2

J3

J6

J4

J5

J7

J8

L4

L3

L2

L1

G

O

Pin	Green		ORANGE
L4	+	L2	+
L3	-	L1	-

CAP 1000pF 2KV

Electronical Specifications:

PARAMETER	SPECIFICATIONS			
Turns Ratio	1.00 ± 2%			
Polarity	PER SCHEMATIC			
Insertion Loss (Data Channels)	1MHz-50MHz	50-125 MHz	125-250 MHz	
	-0.5dB MAX	-1.0dB MAX	-2.0 dB MAX	
Return Loss (Z OUT=100 OHM ±1%)	1MHz TO 40MHz		40MHz TO 250MHz	
	-20dB MIN		-16+10Log(Freq MHz/40MHz)dB MIN	
Inductance (OCL)	180 uH MIN @ 100 KHz, 100 mV			
Reflected CM to DIFF Conversion (REF)	1 MHz	50 MHz	100 MHz	200 MHz
	-30dB MAX	-30dB MAX	-27dB MAX	-24dB MAX
Reflected DIFF to CM Conversion (REF)	1 MHz TO 10 MHz		10 MHz TO 200 MHz	
	-48 dB MIN		-48+19Log(Freq MHz/10MHz) dB MIN	
CM to CM Attenuation (REF)	1 MHz-200MHz			
	-25dB MIN			
CROSS TALK	1 MHz TO 40 MHz		40 MHz TO 125 MHz	
	-35dB MIN		-35+15log(Freq MHz/40MHz)dB MIN	
HIPOT-OUTPUT ISOLATION	2250 VDC MIN @ 60 SECONDS			

UNLESS OTHERWISE SPECIFIED
ALL DIMENSIONS ARE INCHES [MM]
TOLERANCES: EXCEPT AS NOTED

INCHES		HOLES	
.X	± .10	Ø.X	±.10
.XX	± .020	Ø.XX	±.015
.XXX	± .015	Ø.XXX	±.010

APPROVALS		DATE
DRAWN	LH	5/12/20
CHECKED	AC	5/12/20
APPROVED		

ADAMTECH

INTERCONNECTS

909 Rahway Avenue,
Union, NJ 07083
Phone: 908-687-5000
Fax: 908-687-5710

TITLE

MODULAR TELEPHONE JACK, 8P8C
W/ LED1 GREEN, W/ LED2 ORANGE, 2.5G BASE-T

SIZE	PART NO.	REV.
X	MTJ-88AX1-FS-TSMT-P-L5-M398CH-WOT-KT	-

REF:	SCALE:	SHEET
S00005C	NTS	2 OF 2

Mouser Electronics

Authorized Distributor

Click to View Pricing, Inventory, Delivery & Lifecycle Information:

[Adam Tech:](#)

[MTJ-88AX1-FS-TSMT-P-L5-M398CH-WOT-KT](#)