

APPROVED: \_\_\_\_\_  
DATE: \_\_\_\_\_ TITLE: \_\_\_\_\_

| Rev | AWO # | Description         | Date     | Appr   |
|-----|-------|---------------------|----------|--------|
| -   |       | UPDATE SPEC.        | 10/01/16 |        |
| A   |       | ADDED LED SCHEMATIC | 7/9/19   | AY/AY1 |

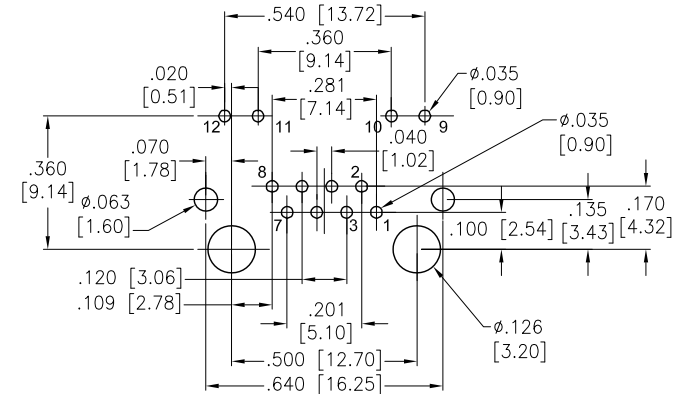
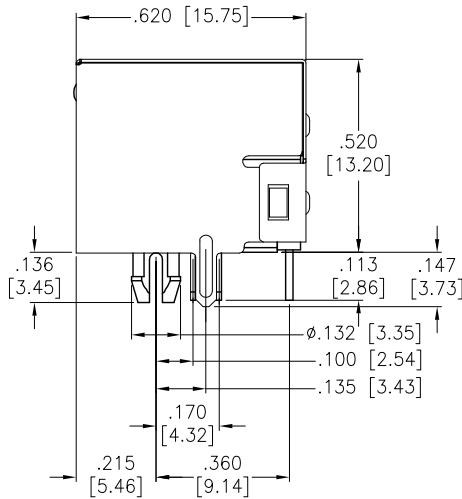
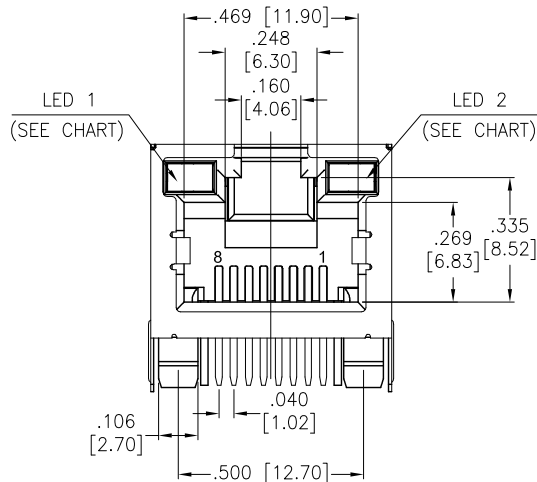

RECOMMENDED PCB LAYOUT

#### SPECIFICATIONS:

##### Material:

Insulator: PBT, glass reinforced, rated UL 94V-0

Insulator color: Black

Contacts: Phosphor Bronze

Shield: Brass, Nickel plated

Contacts Plating:

Round contact

Gold over Nickel underplate overall

Flat contact

Gold over Nickel underplate on contact area,

Tin over Nickel underplate on solder tails

##### Electrical:

Voltage rating: 150 VAC rms

Current rating: 1.5 Amp

Contact resistance: 20 mohms max.

Insulation resistance: 1000 Mohms min @ 500 VDC

Dielectric withstanding voltage:

Contact to Contact: 1,000 VDC or AC Peak for 1 minute

Contact to Screen and Test panel: 1,500 VDC or AC Peak for 1 minute

##### Temperature Rating:

Operating temperature: -40°C to +85°C

Environmental:

Lead free, RoHS compliant.

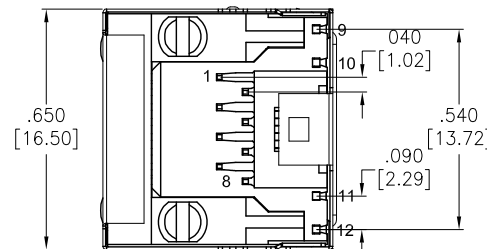

| Part Number        | LED 1 Color  | LED 2 Color  |
|--------------------|--------------|--------------|
| MTJ-88ARX1-FSM-LD  | Green        | Green        |
| MTJ-88ARX1-FSM-LG  | Yellow       | Green        |
| MTJ-88ARX1-FSM-LH  | Green        | Yellow       |
| MTJ-88ARX1-FSM-LP  | Yellow/Green | Yellow/Green |
| MTJ-88ARX1-FSM-LV  | Green        | Yellow/Green |
| MTJ-88ARX1-FSM-L16 | Green/Yellow | Green/Yellow |

UNLESS OTHERWISE SPECIFIED  
ALL DIMENSIONS ARE MM [INCHES]  
TOLERANCES: EXCEPT AS NOTED  
INCHES HOLES  
.X ± .10 Ø.X ± .10  
.XX ± .020 Ø.XX ± .015  
.XXX ± .015 Ø.XXX ± .010

| APPROVALS |     | DATE     |
|-----------|-----|----------|
| DRAWN     | SLS | 10/01/16 |
| CHECKED   |     |          |
| APPROVED  |     |          |

**ADAM**  
**TECH**  
**INTERCONNECTS**

909 Rahway Avenue,  
Union, NJ 07083  
Phone: 908-687-5000  
Fax: 908-687-5710

TITLE  
MODULAR TELEPHONE JACK, R/A, 8P8C  
SHIELDED WITH LED'S

| SIZE         | PART NO.          | REV.       |
|--------------|-------------------|------------|
| X            | MTJ-88ARX1-FSM-LX | A          |
| REF:         | S00005C           | SCALE: NTS |
| SHEET 1 OF 2 |                   |            |

6

5

4

3

2

1

APPROVED: \_\_\_\_\_

DATE: \_\_\_\_\_ TITLE: \_\_\_\_\_

Rev

AWO #

Description

Date

Appr

SEE SHT 1 OF 2 FOR REVISION

## LED SCHEMATIC

## MTJ-88AAX1-FSM-LD

GREEN

GREEN

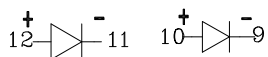

## MTJ-88AAX1-FSM-LG

YELLOW

GREEN

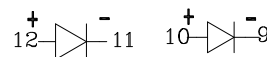

## MTJ-88AAX1-FSM-LH

GREEN

YELLOW

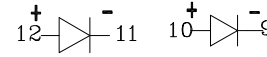

## MTJ-88AAX1-FSM-LP

YELLOW

YELLOW

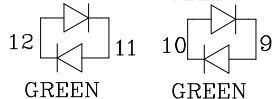

## MTJ-88AAX1-FSM-LV

GREEN

YELLOW

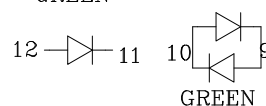

## MTJ-88AAX1-FSM-L16

GREEN

GREEN

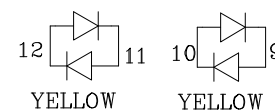

UNLESS OTHERWISE SPECIFIED  
ALL DIMENSIONS ARE MM [INCHES]  
TOLERANCES: EXCEPT AS NOTED  
INCHES HOLES

|      |        |       |       |
|------|--------|-------|-------|
| .X   | ± .10  | Ø.X   | ±.10  |
| .XX  | ± .020 | Ø.XX  | ±.015 |
| .XXX | ± .015 | Ø.XXX | ±.010 |

APPROVALS

DATE

DRAWN

SLS

10/01/16

CHECKED

APPROVED

**ADAM**  
**TECH**  
**INTERCONNECTS**

909 Rahway Avenue,  
Union, NJ 07083  
Phone: 908-687-5000  
Fax: 908-687-5710

TITLE

MODULAR TELEPHONE JACK, R/A, 8P8C  
SHIELDED WITH LED'S

SIZE  
X

PART NO.

MTJ-88ARX1-FSM-LX

REV.  
A

REF: S00005C

SCALE: NTS

SHEET 2 OF 2

6

5

4

3

2

1

# Mouser Electronics

Authorized Distributor

Click to View Pricing, Inventory, Delivery & Lifecycle Information:

[Adam Tech:](#)

[MTJ-88ARX1-FSM-LV](#)