

APPROVED: _____
DATE: _____ TITLE: _____

Rev	AWO #	Description	Date	Appr
-		RELEASED	8/16/21	

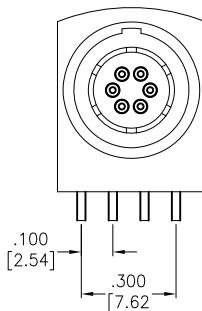
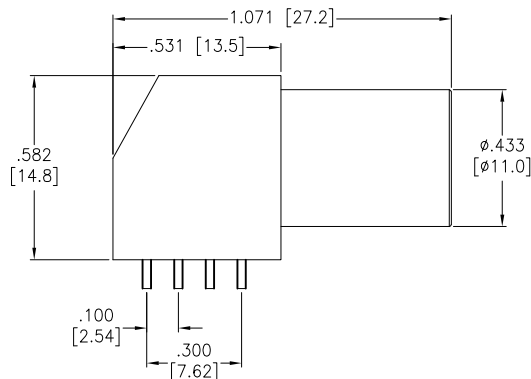

MMI-ES1GXXPR

OF POSITIONS
(02, 03, 04, 05, 06, 07, 08 & 10)

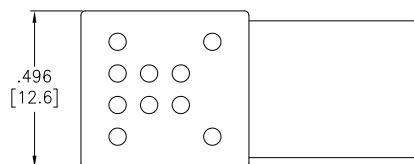
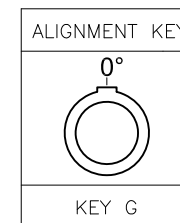

SPECIFICATIONS:

Material:

Insulator: (PPS) Hi-temp thermoplastic, rated UL 94V-0

Insulator color: Black

Contacts: Brass, Gold plated

Shell: Brass

Electrical:

Voltage Rating: See chart

Current Rating: See chart

Dielectric withstanding voltage: See chart

Electrical Life: 1,000 Cycles min.

Mechanical:

Endurance: 5,000 Cycles Min.

Temperature Rating:

Operating temperature: -55°C to +150°C

Environmental:

IP50 Protection (Mated Condition)

Lead free, RoHS compliant



	2 Pin	3 Pin	4 Pin	5 Pin	6 Pin	7 Pin	8 Pin	10 Pin
Configuration								
Testing Voltage	1700V	1700V	1600V	1300V	1350V	1450V	1300V	1000V
Working Voltage	300V	300V	250V	250V	200V	200V	200V	200V
Rated Current / Pin	4.5A	4.5A	4.5A	4.5A	4.5A	2A	2A	1.5A

UNLESS OTHERWISE SPECIFIED
ALL DIMENSIONS ARE INCHES [MM]
TOLERANCES: EXCEPT AS NOTED
INCHES HOLES
.X ± .10 Ø.X ± .10
.XX ± .020 Ø.XX ± .015
.XXX ± .015 Ø.XXX ± .010

APPROVALS		DATE
DRAWN	SS	8/16/21
CHECKED	SS	8/16/21
APPROVED		

ADAM
TECH

909 Rahway Avenue,
Union, NJ 07083
Phone: 908-687-5000
Fax: 908-687-5710

TITLE
PUSH-PULL ELBOW SOCKET, RIGHT ANGLE, SIZE 1,
PCB MOUNT, IP50

SIZE	PART NO.	REV.
X	MMI-ES1GXXPR	-
REF:	SXXXXXX	SCALE: NTS
SHEET 1 OF 2		

APPROVED: _____
DATE: _____ TITLE: _____

Rev	AWO #	Description	Date	Appr
-		RELEASED	8/16/21	

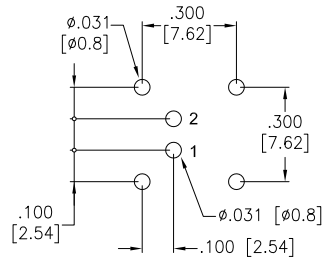

2 PIN

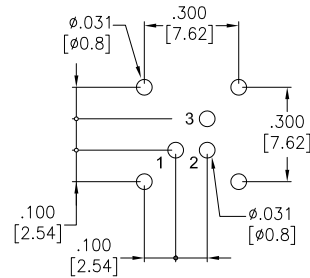

3 PIN

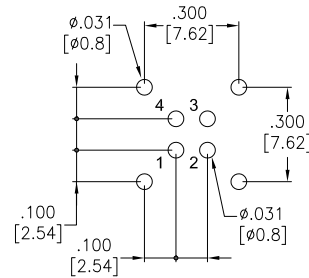

4 PIN

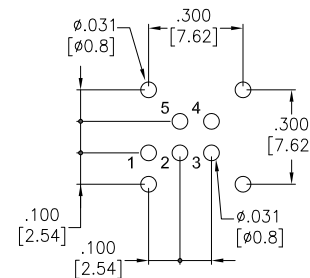

5 PIN

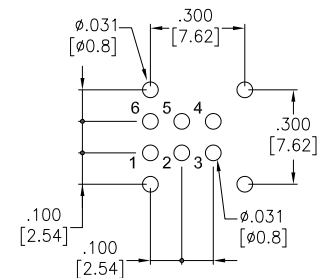

6 PIN

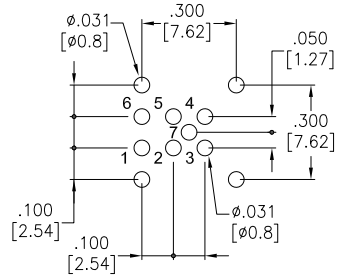

7 PIN

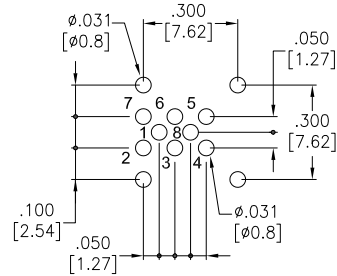

8 PIN

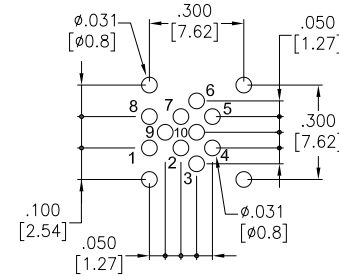

10 PIN

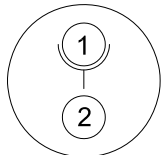

2 PIN

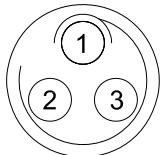

3 PIN

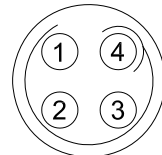

4 PIN

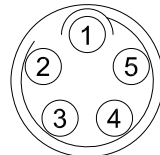

5 PIN

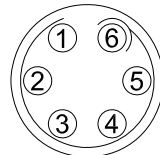

6 PIN

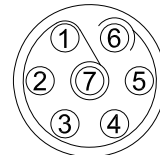

7 PIN

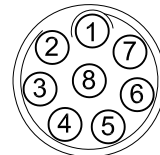

8 PIN

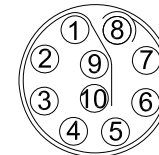

10 PIN

UNLESS OTHERWISE SPECIFIED ALL DIMENSIONS ARE INCHES [MM] TOLERANCES: EXCEPT AS NOTED INCHES HOLES .X ± .10 Ø.X ± .10 .XX ± .020 Ø.XX ± .015 .XXX ± .015 Ø.XXX ± .010		ADAM TECH		909 Rahway Avenue, Union, NJ 07083 Phone: 908-687-5000 Fax: 908-687-5710	
APPROVALS		DATE		TITLE PUSH-PULL ELBOW SOCKET, RIGHT ANGLE, SIZE 1, PCB MOUNT, IP50	
DRAWN	SS	8/16/21		SIZE X	
CHECKED	SS	8/16/21		PART NO. MMI-ES1GXXPR	
APPROVED				REV. -	
REF: SXXXXXX		SCALE: NTS		SHEET 2 OF 2	

Mouser Electronics

Authorized Distributor

Click to View Pricing, Inventory, Delivery & Lifecycle Information:

[Adam Tech:](#)

[MMI-ES1G04PR](#) [MMI-ES1G06PR](#) [MMI-ES1G07PR](#) [MMI-ES1G08PR](#) [MMI-ES1G02PR](#) [MMI-ES1G05PR](#) [MMI-ES1G03PR](#)