

APPROVED: _____
DATE: _____ TITLE: _____

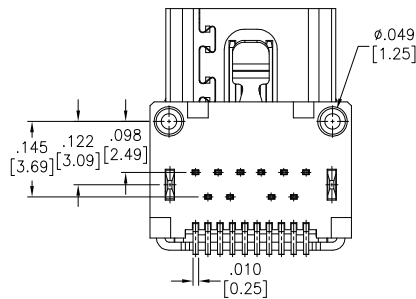

Rev	AWO #	Description	Date	Appr
-		RELEASED	10/16/09	
A		REDRAWN	05/18/12	
B		ADDED LAYOUT DIM.	12/14/12	
C		REVISED SPEC.	2/26/15	AY/AC
D		UPDATED DRAWING	8/19/15	HR/LL
E		UPDATED SPEC.	7/30/18	AY/TW
F		UPDATED SPEC.	10/12/18	SS

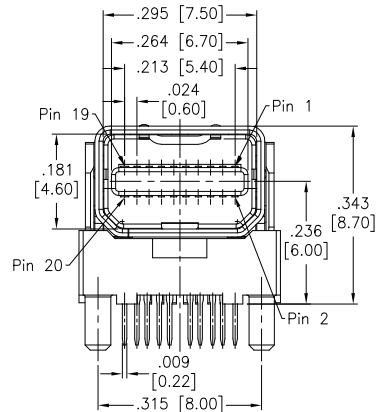
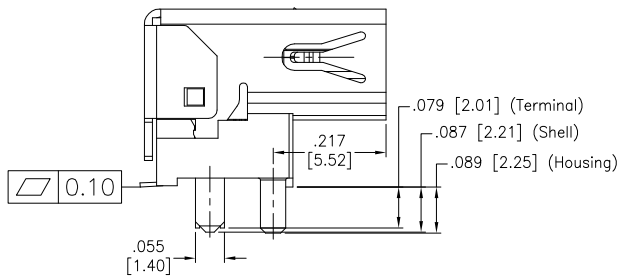
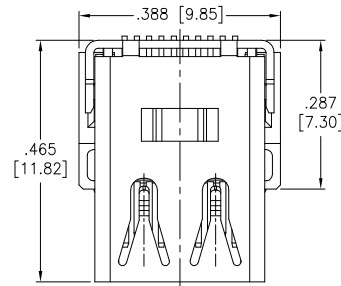
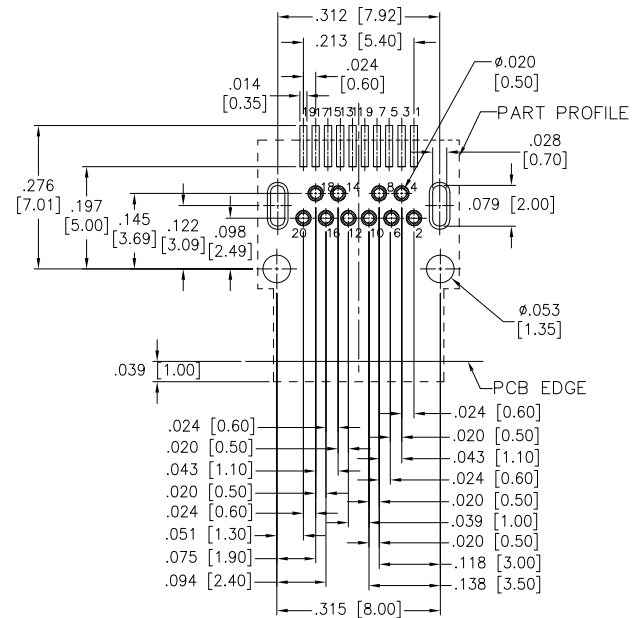

RECOMMENDED PCB LAYOUT

SPECIFICATIONS:

Material:

Housing: Hi-Temp Thermoplastic, rated UL 94V-0

Insulator color: Black

Contact: Copper Alloy

Shell: Stainless Steel, Nickel plated

Plating:

15u" Gold over Nickel underplate on contact area,

Matte Tin over Nickel underplate on solder tails

Electrical:

Voltage rating: 40 V

Current rating: 0.5 A

Contact Resistance: 30 mΩ max.

Insulation Resistance: 100 Mohms min. @ 500 VDC (unmated)

10 Mohms min. @ 150 VDC (mated)

Dielectric Withstanding Voltage: 300V AC for 1 minute

Mechanical:

Insertion force: 44.1N Max

Extraction force: 9.8N Min, 39.2N Max

Durability: 10,000 cycles

Environment:

Lead free, RoHS compliant.



UNLESS OTHERWISE SPECIFIED
ALL DIMENSIONS ARE INCHES [MM]
TOLERANCES: EXCEPT AS NOTED
INCHES HOLES

.X ± .10 Ø.X ± .10
.XX ± .020 Ø.XX ± .015
.XXX ± .015 Ø.XXX ± .010

APPROVALS

DATE

DRAWN

DY

10/16/09

CHECKED

APPROVED

ADAM
TECH
INTERCONNECTS

909 Rahway Avenue,
Union, NJ 07083
Phone: 908-687-5000
Fax: 908-687-5710

TITLE

MINI DISPLAY PORT RECEPTACLE, R/A,
DIP TYPE, 20 PIN, 15u" GOLD PLATED

SIZE

X

PART NO.

MDPC-S-RA

REV.

E

REF: S00015C

SCALE: NTS

SHEET 1 OF 1

Mouser Electronics

Authorized Distributor

Click to View Pricing, Inventory, Delivery & Lifecycle Information:

[Adam Tech:](#)

[MDPC-S-RA](#)