

APPROVED: _____

DATE: _____ TITLE: _____

| Rev | AWO # | Description | Date | Appr |
|-----|-------|----------------|----------|-------|
| - | | RELEASED | 08/01/13 | |
| A | | UPDATED SPEC. | 7/20/15 | HR/AY |
| B | | UPDATE DRAWING | 9/13/18 | AY/DH |

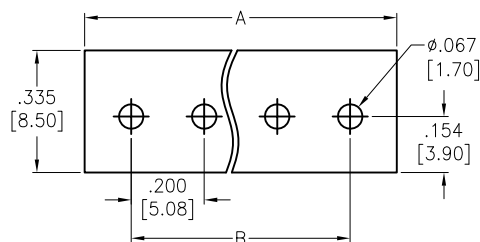

RECOMMENDED PCB LAYOUT

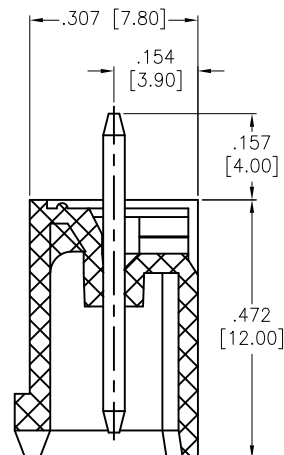
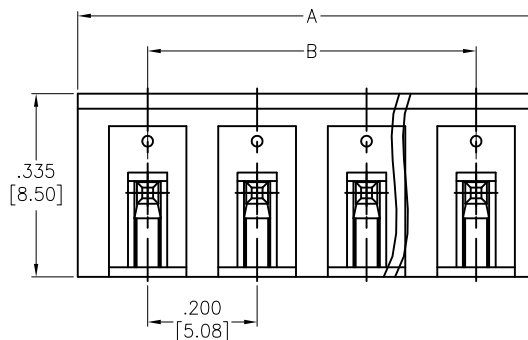

SECTION A-A

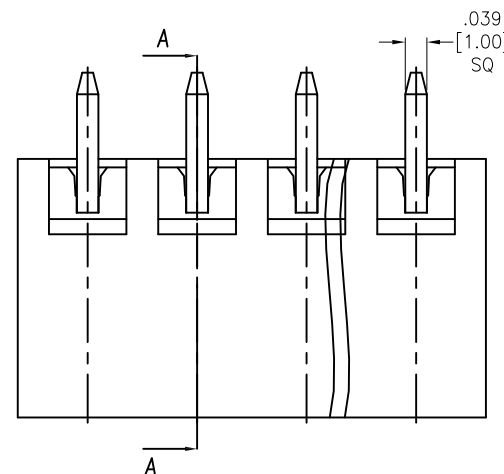

Positions: 02 thru 24

A = .200 [5.08] x No. of Positions + .055 [1.40]

B = .200 [5.08] x No. of Spaces

SPECIFICATIONS:

Material:

Insulator: PA66, rated UL 94V-0

Insulator color: Green

Contact: Brass, Tin plated.

Electrical:

Voltage rated: 300 VAC

Current rated: 15 Amp

Contact resistance: 20 mohms max

Insulation resistance: 500 Mohms min @ 500 VDC

Dielectric withstanding voltage: 2,000 VAC for 1 minute

Temperature Rating:

-40°C to +105°C

Environmental:

Lead free, RoHS compliant.



UNLESS OTHERWISE SPECIFIED
ALL DIMENSIONS ARE MM [INCHES]
TOLERANCES: EXCEPT AS NOTED
INCHES HOLES
.X ±.10 Ø.X ±.10
.XX ±.020 Ø.XX ±.015
.XXX ±.015 Ø.XXX ±.010

| APPROVALS | | DATE |
|-----------|----|----------|
| DRAWN | AY | 10/17/13 |
| CHECKED | NP | 10/17/13 |
| APPROVED | | |

**ADAM
TECH**
INTERCONNECTS

909 Rahway Avenue,
Union, NJ 07083
Phone: 908-687-5000
Fax: 908-687-5710

TITLE
TERMINAL BLOCK, SOCKETS .200 [5.08] PITCH
VERTICAL, CLOSE TYPE

| | | |
|--------------|-------------------------|--------------|
| SIZE X | PART NO. EBPA-XX-D-C | REV. B |
| REF: S00067C | SCALE: NTS | SHEET 1 OF 1 |

Mouser Electronics

Authorized Distributor

Click to View Pricing, Inventory, Delivery & Lifecycle Information:

[Adam Tech:](#)

[EBPA-12-D-C](#) [EBPA-02-D-C](#) [EBPA-07-D-C](#) [EBPA-04-D-C](#) [EBPA-03-D-C](#) [EBPA-10-D-C](#) [EBPA-08-D-C](#) [EBPA-05-D-C](#) [EBPA-06-D-C](#)