

| Rev | AWO # | Description | Date | Appr |
|-----|-------|---------------|---------|------|
| - | | RELEASED | 4/22/05 | |
| A | | REDRAWN | 7/14/11 | |
| B | | REVISED SPEC. | 7/10/12 | |

APPROVED: _____
DATE: _____ TITLE: _____

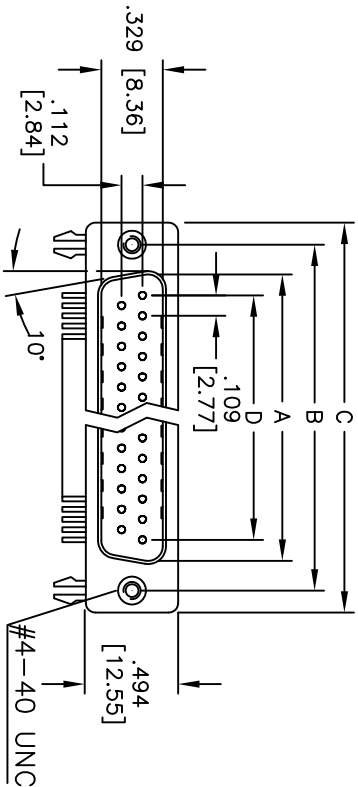

RECOMMENDED PCB LAYOUT

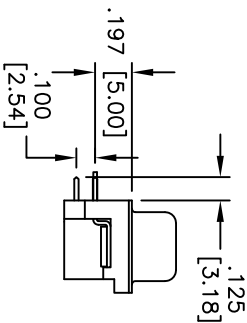
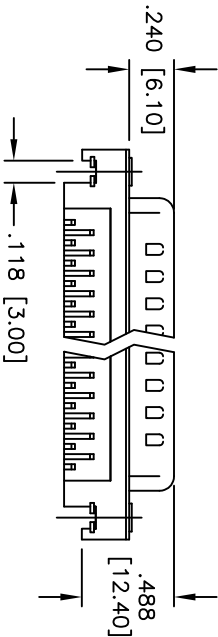
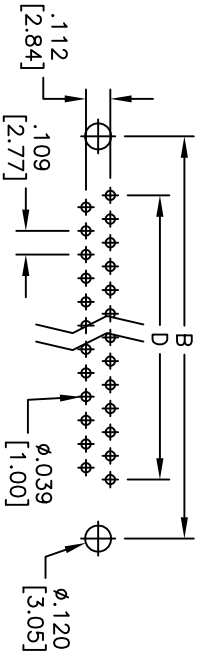

SPECIFICATIONS:

Material:

Insulator: PBT, glass reinforced, rated UL 94V-0

Insulator color: Black

Contacts: Copper Alloy

Shell: Steel, Nickel plated.

Clinch Nut: Copper Alloy, Nickel plated

Boardlock: Brass, Tin plated

Plating:

Gold flash over Nickel underplate overall

Electrical:

Operating voltage: 250 VAC max

Current rating: 3 Amps max

Contact resistance: 20 mohms max

Insulation resistance: 1,000 mohms min

Dielectric withstanding voltage: 1,000 VAC for 1 minute

Temperature Rating:

Operating temperature: -55°C to +105°C

Environmental:

Lead free, RoHS compliant

| DXXX | NO. OF CONTACTS | DIMENSIONS | | | |
|------|-----------------|---------------|---------------|---------------|---------------|
| | | A | B | C | D |
| DE09 | 9 | .666 [16.92] | .984 [24.99] | 1.213 [30.81] | .436 [11.08] |
| DA15 | 15 | .994 [25.25] | 1.311 [33.30] | 1.543 [39.20] | .763 [19.39] |
| DB25 | 25 | 1.573 [38.96] | 1.852 [47.04] | 2.089 [53.05] | 1.309 [33.24] |
| DC37 | 37 | 2.182 [55.42] | 2.500 [63.50] | 2.732 [69.40] | 1.963 [49.86] |

ADAM TECH

909 Railway Avenue, Union, NJ 07083
Phone: 908-687-5000 Fax: 908-687-5710

.197 [5.00] SLIMLINE D-SUB PLUG

FORKED BOARDLOCKS, #4-40 INSERTS

| | | | | | |
|--|----|------------|--|--------------|--|
| UNLESS OTHERWISE SPECIFIED ALL DIMENSIONS ARE INCHES [MM] TOLERANCES: EXCEPT AS NOTED INCHES .X ±.10 ØXX ±.10 .XX ±.020 ØXXX ±.015 .XXX ±.015 ØXXX ±.010 | | APPROVALS | | DATE | |
| DRAWN | SS | 4/22/05 | | | |
| CHECKED | | | | | |
| APPROVED | | | | | |
| TITLE | | SIZE | | PART NO. | |
| DRAWN | | X | | DXXX-PN-24 | |
| CHECKED | | | | | |
| APPROVED | | | | | |
| REF: S00087T | | SCALE: NTS | | SHEET 1 OF 1 | |

Mouser Electronics

Authorized Distributor

Click to View Pricing, Inventory, Delivery & Lifecycle Information:

[Adam Tech:](#)

[DE09-PN-24](#)