

6

5

4

3

2

1

APPROVED: _____

DATE: _____ TITLE: _____

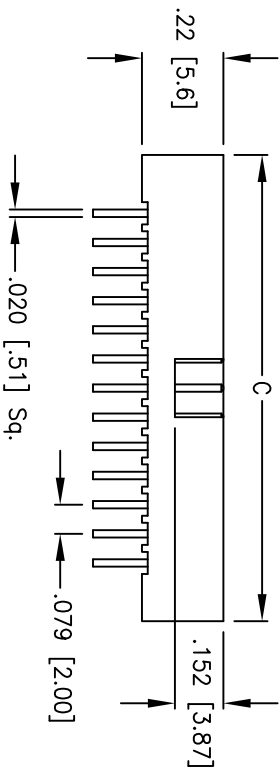
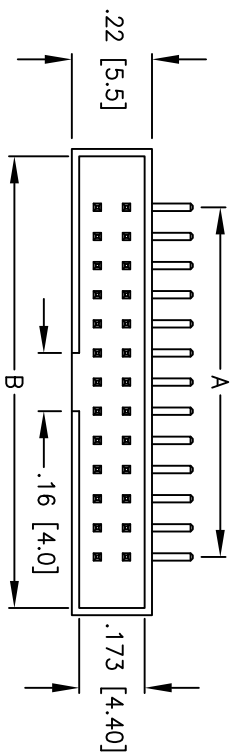

POSITION	A	B	C
10	.315 [8.00]	.633 [16.08]	.673 [17.10]
12	.394 [10.00]	.712 [18.08]	.752 [19.10]
14	.472 [12.00]	.791 [20.08]	.831 [21.10]
16	.551 [14.00]	.869 [22.08]	.909 [23.10]
20	.709 [18.00]	1.027 [26.08]	1.067 [27.10]
26	.945 [24.00]	1.263 [32.08]	1.303 [33.10]
34	1.260 [32.00]	1.578 [40.08]	1.618 [41.10]
40	1.496 [38.00]	1.814 [46.08]	1.854 [47.10]
44	1.654 [42.00]	1.972 [50.08]	2.012 [51.10]
50	1.890 [48.00]	2.208 [56.08]	2.248 [57.10]
68	2.598 [66.00]	2.917 [74.08]	2.957 [75.10]

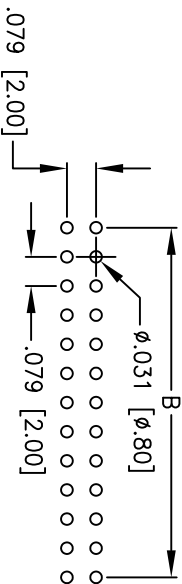
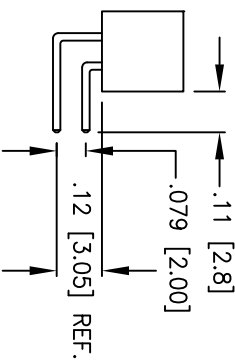

RECOMMENDED PCB LAYOUT
Tolerances: ±.004 [±.10]

SPECIFICATIONS:

Material:

Insulator: PBT, glass reinforced, rated UL 94V-0

Insulator color: Black

Contacts: Brass

Plating:

Gold Flash over Nickel underplate overall

Electrical:

Operating voltage: 250 VAC max

Current rating: 1 Amp max

Contact resistance: 20 mohms max

Insulation resistance: 5000 Mohms min

Dielectric withstanding voltage: 1000 VAC for 1 minute

Temperature Rating:

Operating temperature: -55C to +105C

Environmental:

Lead free, RoHS compliant.



Rev	AWO #	Description	Date	Appr
-	7466	RELEASED	01/25/07	

UNLESS OTHERWISE SPECIFIED ALL DIMENSIONS ARE INCHES [MM] TOLERANCES: EXCEPT AS NOTED INCHES HOLES .X ±.10 ØX ±.10 .XX ±.020 ØXX ±.015 .XXX ±.015 ØXXX ±.010		ADAM TECH 909 Rahway Avenue, Union, NJ 07083 Phone: 908-687-5000 Fax: 908-687-5710	
APPROVALS		TITLE 2.0mm DUAL ROW, HORIZONTAL MOUNT BOX HEADER, GOLD PLATED	
DRAWN	BW	DATE	01/25/07
CHECKED		SIZE	PART NO.
APPROVED		REF:	SCALE: NTS SHEET 1 OF 1

6

5

4

3

2

1

Mouser Electronics

Authorized Distributor

Click to View Pricing, Inventory, Delivery & Lifecycle Information:

[Adam Tech:](#)

[2BHR-16-HUA](#) [2BHR-10-HUA](#) [2BHR-68-HUA](#) [2BHR-30-HUA](#) [2BHR-12-HUA](#) [2BHR-24-HUA](#) [2BHR-34-HUA](#)
[2BHR-20-HUA](#) [2BHR-40-HUA](#) [2BHR-50-HUA](#) [2BHR-60-HUA](#) [2BHR-14-HUA](#) [2BHR-08-HUA](#) [2BHR-26-HUA](#) [2BHR-](#)
[44-HUA](#) [2BHR-64-HUA](#)