

## 2A, 40V - 200V Schottky Barrier Surface Mount Rectifier

### FEATURES

- AEC-Q101 qualified
- Low power loss, high efficiency
- Ideal for automated placement
- High surge current capability
- Moisture sensitivity level: level 1, per J-STD-020
- RoHS Compliant
- Halogen-free according to IEC 61249-2-21

### APPLICATIONS

- Switching mode power supply (SMPS)
- Adapters
- Lighting application
- On-board DC/DC converter

### MECHANICAL DATA

- Case: Thin SMA
- Molding compound meets UL 94V-0 flammability rating
- Terminal: Matte tin plated leads, solderable per J-STD-002
- Meet JESD 201 class 2 whisker test
- Polarity: Indicated by cathode band
- Weight: 0.028g (approximately)

KEY PARAMETERS		
PARAMETER	VALUE	UNIT
$I_F$	2	A
$V_{RRM}$	40 - 200	V
$I_{FSM}$	50	A
$T_{J\ MAX}$	150	°C
Package	Thin SMA	
Configuration	Single die	



Thin SMA



ABSOLUTE MAXIMUM RATINGS ( $T_A = 25^\circ\text{C}$ unless otherwise noted)							
PARAMETER	SYMBOL	SS24 ALH	SS26 ALH	SS210 ALH	SS215 ALH	SS220 ALH	UNIT
Marking code on the device		24ALH	26ALH	210ALH	215ALH	220ALH	
Repetitive peak reverse voltage	$V_{RRM}$	40	60	100	150	200	V
Reverse voltage, total rms value	$V_{R(RMS)}$	28	42	70	105	140	V
Forward current	$I_F$	2					A
Surge peak forward current single half sine-wave superimposed on rated load	$t = 8.3\text{ms}$	50					A
	$t = 1.0\text{ms}$	145					A
Junction temperature	$T_J$	-55 to +150					°C
Storage temperature	$T_{STG}$	-55 to +150					°C

<b>THERMAL PERFORMANCE</b>			
<b>PARAMETER</b>	<b>SYMBOL</b>	<b>TYP</b>	<b>UNIT</b>
Junction-to-lead thermal resistance	$R_{\theta JL}$	21	$^{\circ}\text{C/W}$
Junction-to-ambient thermal resistance	$R_{\theta JA}$	78	$^{\circ}\text{C/W}$
Junction-to-case thermal resistance	$R_{\theta JC}$	20	$^{\circ}\text{C/W}$

**Thermal Performance Note:** Units mounted on PCB (5mm x 5mm Cu pad test board)

<b>ELECTRICAL SPECIFICATIONS</b> ( $T_A = 25^{\circ}\text{C}$ unless otherwise noted)						
<b>PARAMETER</b>		<b>CONDITIONS</b>	<b>SYMBOL</b>	<b>TYP</b>	<b>MAX</b>	<b>UNIT</b>
Forward voltage <sup>(1)</sup>	SS24ALH	$I_F = 1\text{A}, T_J = 25^{\circ}\text{C}$	$V_F$	0.40	-	V
		$I_F = 2\text{A}, T_J = 25^{\circ}\text{C}$		0.46	0.57	V
		$I_F = 1\text{A}, T_J = 125^{\circ}\text{C}$		0.34	-	V
		$I_F = 2\text{A}, T_J = 125^{\circ}\text{C}$		0.40	0.56	V
	SS26ALH	$I_F = 1\text{A}, T_J = 25^{\circ}\text{C}$		0.50	-	V
		$I_F = 2\text{A}, T_J = 25^{\circ}\text{C}$		0.60	0.70	V
		$I_F = 1\text{A}, T_J = 125^{\circ}\text{C}$		0.44	-	V
		$I_F = 2\text{A}, T_J = 125^{\circ}\text{C}$		0.54	0.62	V
	SS210ALH	$I_F = 1\text{A}, T_J = 25^{\circ}\text{C}$		0.66	-	V
		$I_F = 2\text{A}, T_J = 25^{\circ}\text{C}$		0.76	0.85	V
		$I_F = 1\text{A}, T_J = 125^{\circ}\text{C}$		0.57	-	V
		$I_F = 2\text{A}, T_J = 125^{\circ}\text{C}$		0.62	0.76	V
	SS215ALH	$I_F = 1\text{A}, T_J = 25^{\circ}\text{C}$		0.75	-	V
		$I_F = 2\text{A}, T_J = 25^{\circ}\text{C}$		0.81	0.95	V
		$I_F = 1\text{A}, T_J = 125^{\circ}\text{C}$		0.61	-	V
		$I_F = 2\text{A}, T_J = 125^{\circ}\text{C}$		0.67	0.80	V
	SS220ALH	$I_F = 1\text{A}, T_J = 25^{\circ}\text{C}$		0.78	-	V
		$I_F = 2\text{A}, T_J = 25^{\circ}\text{C}$		0.84	0.95	V
		$I_F = 1\text{A}, T_J = 125^{\circ}\text{C}$		0.63	-	V
		$I_F = 2\text{A}, T_J = 125^{\circ}\text{C}$		0.71	0.89	V
Reverse current @ rated $V_R$ <sup>(2)</sup>	SS24ALH SS26ALH	$T_J = 25^{\circ}\text{C}$	$I_R$	-	200	$\mu\text{A}$
		$T_J = 125^{\circ}\text{C}$		-	40	mA
	SS210ALH SS215ALH SS220ALH	$T_J = 25^{\circ}\text{C}$		-	10	$\mu\text{A}$
		$T_J = 125^{\circ}\text{C}$		-	5	mA
Junction capacitance	SS24ALH	1MHz, $V_R = 4.0\text{V}$	$C_J$	124	-	pF
	SS26ALH			95	-	pF
	SS210ALH			61	-	pF
	SS215ALH			48	-	pF
	SS220ALH			39	-	pF

**Notes:**

1. Pulse test with  $PW = 0.3\text{ms}$
2. Pulse test with  $PW = 30\text{ms}$

**ORDERING INFORMATION**

<b>ORDERING CODE<sup>(1)</sup></b>	<b>PACKAGE</b>	<b>PACKING</b>
SS2xALH M3G	Thin SMA	3,500 / 7" reel
SS2xALH M2G	Thin SMA	14,000 / 13" reel

**Notes:**

1. "x" defines voltage from 40V(SS24ALH) to 200V(SS220ALH)

**CHARACTERISTICS CURVES**

( $T_A = 25^\circ\text{C}$  unless otherwise noted)

**Fig.1 Forward Current Derating Curve**

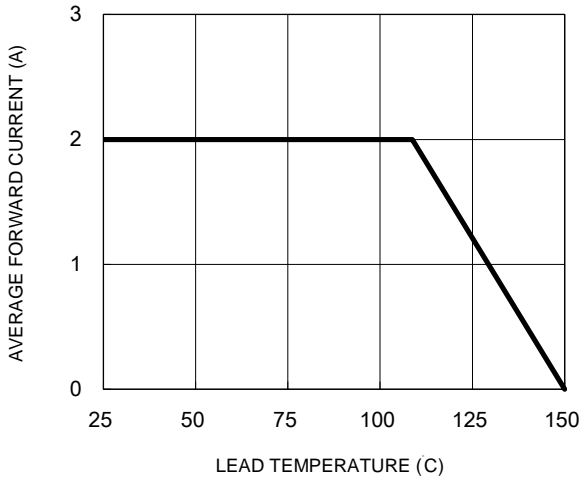

**Fig.2 Typical Junction Capacitance**

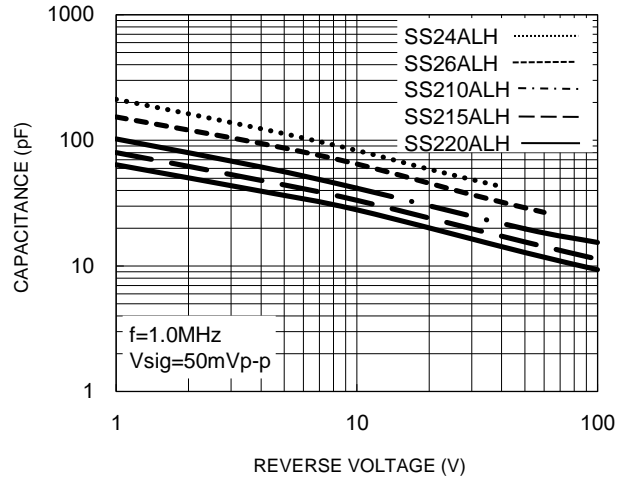

**Fig.3 Typical Reverse Characteristics**

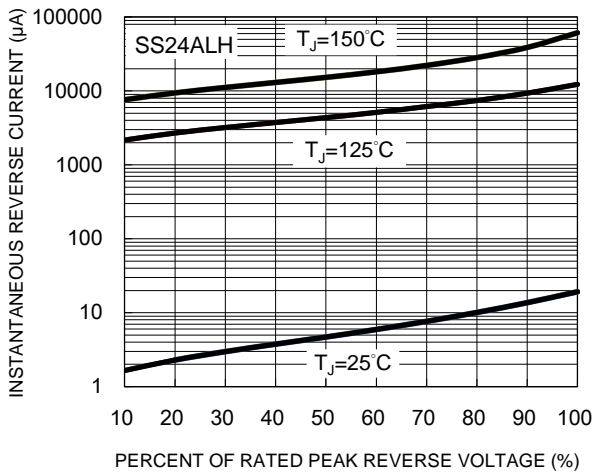

**Fig.4 Typical Forward Characteristics**

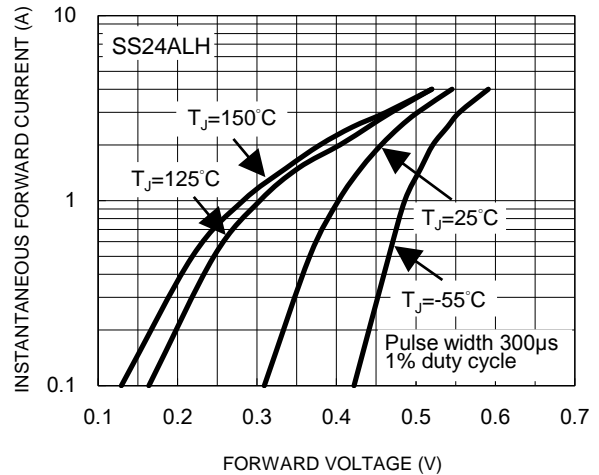

**Fig.5 Typical Reverse Characteristics**

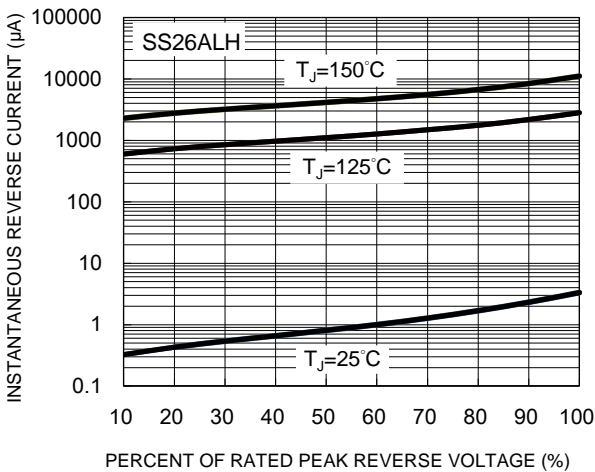

**Fig.6 Typical Forward Characteristics**

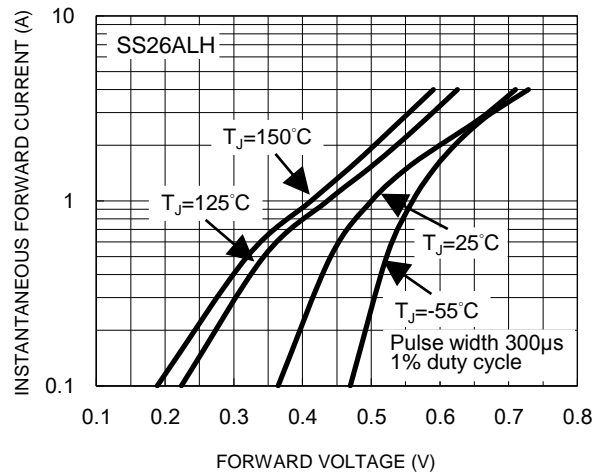

**CHARACTERISTICS CURVES**

( $T_A = 25^\circ\text{C}$  unless otherwise noted)

**Fig.7 Typical Reverse Characteristics**

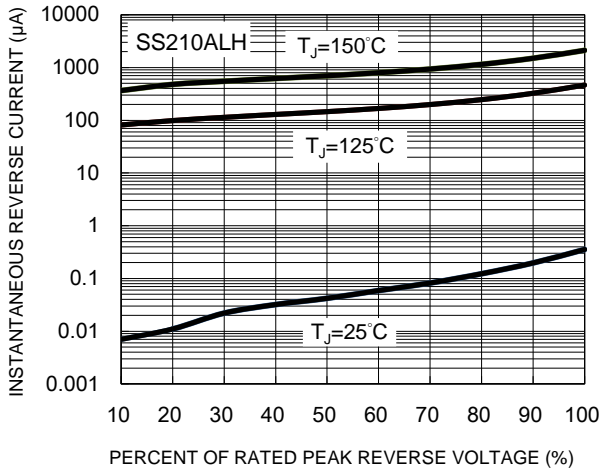

**Fig.9 Typical Reverse Characteristics**

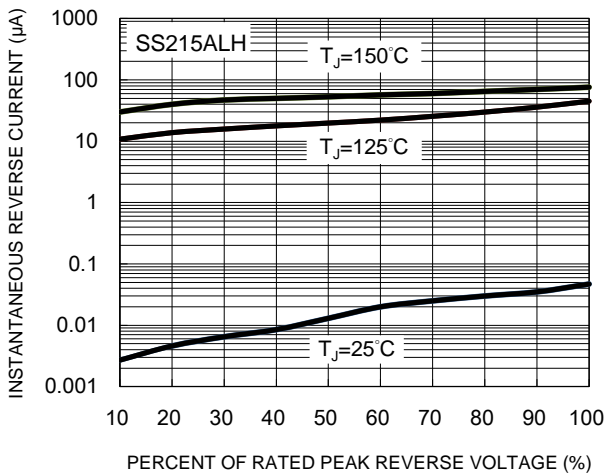

**Fig.11 Typical Reverse Characteristics**

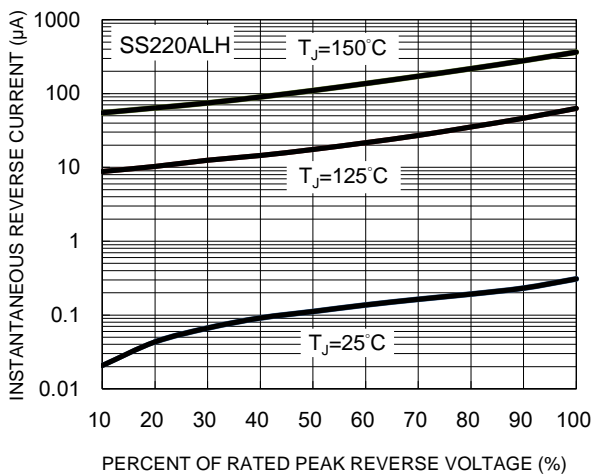

**Fig.8 Typical Forward Characteristics**

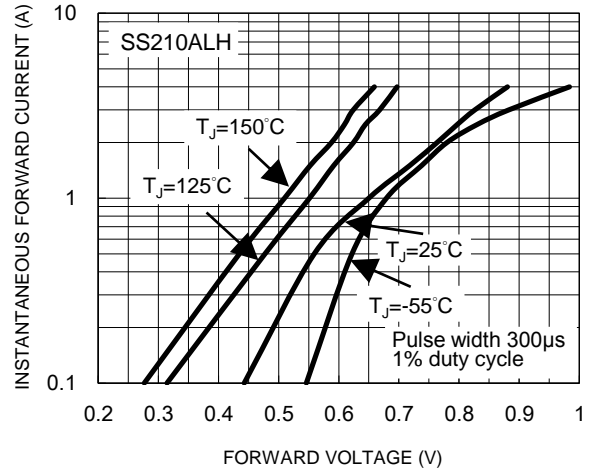

**Fig.10 Typical Forward Characteristics**

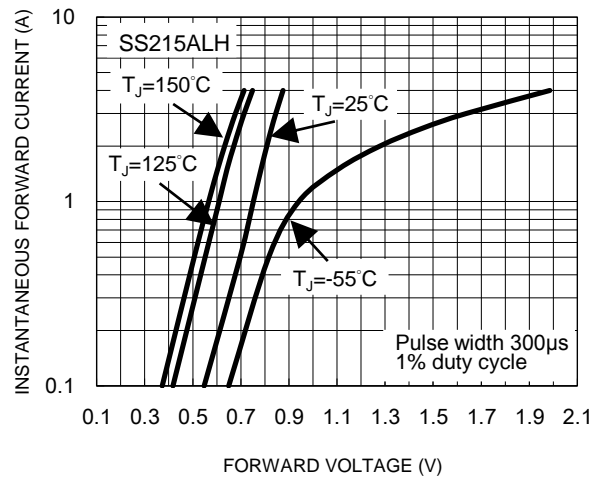

**Fig.12 Typical Forward Characteristics**

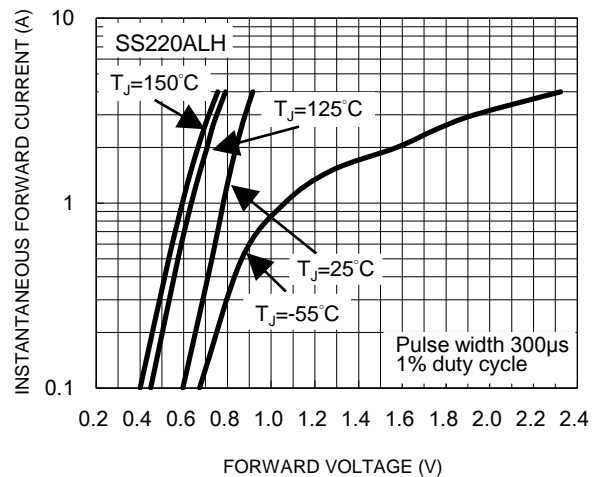

**CHARACTERISTICS CURVES**

( $T_A = 25^\circ\text{C}$  unless otherwise noted)

**Fig.13 Typical Transient Thermal Impedance**

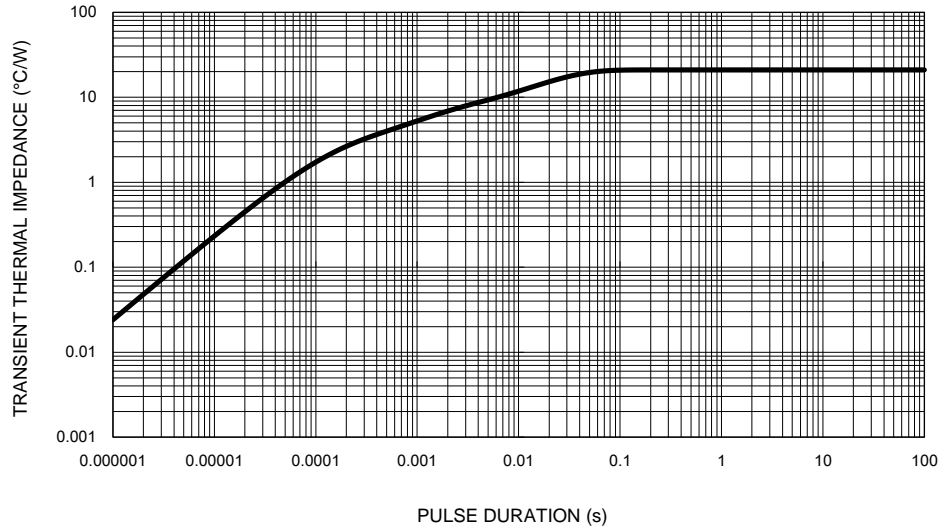

**PACKAGE OUTLINE DIMENSIONS**

Thin SMA

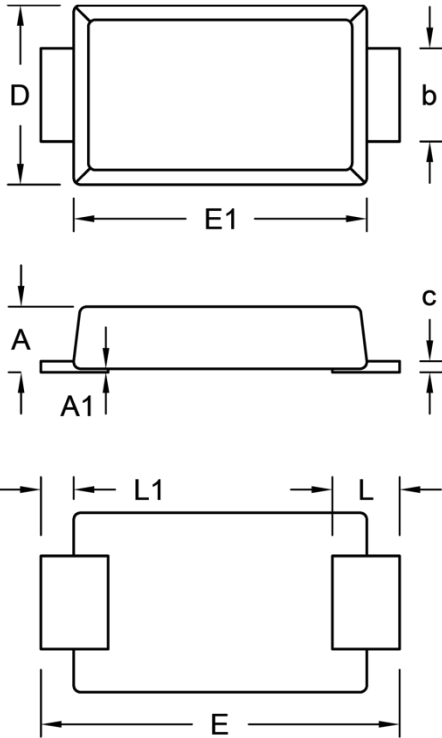

DIM.	Unit (mm)		Unit (inch)	
	Min.	Max.	Min.	Max.
A	0.90	1.00	0.035	0.039
A1	0.00	0.10	0.000	0.004
b	1.25	1.45	0.049	0.057
c	0.10	0.22	0.004	0.009
D	2.50	2.70	0.098	0.106
E	5.05	5.35	0.199	0.211
E1	4.15	4.35	0.163	0.171
L	0.75	1.20	0.030	0.047
L1	0.30	0.60	0.012	0.024

**SUGGESTED PAD LAYOUT**

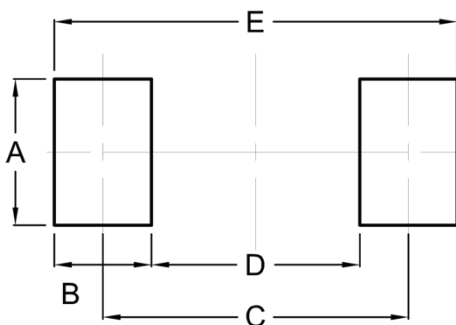

Symbol	Unit (mm)	Unit (inch)
A	2.10	0.083
B	1.40	0.055
C	4.40	0.173
D	3.00	0.118
E	5.80	0.228

**MARKING DIAGRAM**



P/N = Marking Code  
 YW = Date Code  
 F = Factory Code

## **Notice**

Specifications of the products displayed herein are subject to change without notice. TSC or anyone on its behalf, assumes no responsibility or liability for any errors or inaccuracies.

Purchasers are solely responsible for the choice, selection, and use of TSC products and TSC assumes no liability for application assistance or the design of Purchasers' products.

Information contained herein is intended to provide a product description only. No license, express or implied, to any intellectual property rights is granted by this document. Except as provided in TSC's terms and conditions of sale for such products, TSC assumes no liability whatsoever, and disclaims any express or implied warranty, relating to sale and/or use of TSC products including liability or warranties relating to fitness for a particular purpose, merchantability, or infringement of any patent, copyright, or other intellectual property right.

The products shown herein are not designed for use in medical, life-saving, or life-sustaining applications. Customers using or selling these products for use in such applications do so at their own risk and agree to fully indemnify TSC for any damages resulting from such improper use or sale.



# Mouser Electronics

Authorized Distributor

Click to View Pricing, Inventory, Delivery & Lifecycle Information:

## Taiwan Semiconductor:

[SS24ALH M2G](#) [SS26ALH M2G](#) [SS310ALH M2G](#) [SS315ALH M2G](#) [SS320ALH M2G](#) [SS34ALH M2G](#) [SS36ALH M2G](#) [SS510ALH M2G](#) [SS515ALH M2G](#) [SS520ALH M2G](#) [SS54ALH M2G](#) [SS56ALH M2G](#)