

## 20A, 20V - 150V Schottky Barrier Surface Mount Rectifier

### FEATURES

- AEC-Q101 qualified
- Low power loss, high efficiency
- Ideal for automated placement
- Guard ring for overvoltage protection
- High surge current capability
- Moisture sensitivity level: level 1, per J-STD-020
- RoHS Compliant
- Halogen-free according to IEC 61249-2-21

### APPLICATIONS

- Low voltage, high freq. inverter
- DC/DC converter
- Freewheeling diodes
- Reverse battery protection
- Car lighting

### MECHANICAL DATA

- Case: TO-263AB (D<sup>2</sup>PAK)
- Molding compound meets UL 94V-0 flammability rating
- Terminal: Matte tin plated leads, solderable per J-STD-002
- Meet JESD 201 class 2 whisker test
- Polarity: As marked
- Weight: 1.37g (approximately)

KEY PARAMETERS		
PARAMETER	VALUE	UNIT
$I_F$	20	A
$V_{RRM}$	20 - 150	V
$I_{FSM}$	200	A
$T_{J\ MAX}$	125, 150	°C
Package	TO-263AB (D <sup>2</sup> PAK)	
Configuration	Dual dies	

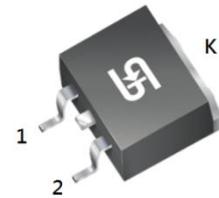

**TO-263AB (D<sup>2</sup>PAK)**

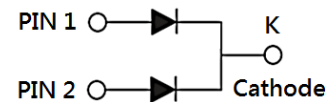

ABSOLUTE MAXIMUM RATINGS (T <sub>A</sub> = 25°C unless otherwise noted)										
PARAMETER	SYMBOL	SRS 2020 H	SRS 2030 H	SRS 2040 H	SRS 2050 H	SRS 2060 H	SRS 2090 H	SRS 20100 H	SRS 20150 H	UNIT
Marking code on the device		SRS 2020	SRS 2030	SRS 2040	SRS 2050	SRS 2060	SRS 2090	SRS 20100	SRS 20150	
Repetitive peak reverse voltage	V <sub>RRM</sub>	20	30	40	50	60	90	100	150	V
Reverse voltage, total rms value	V <sub>R(RMS)</sub>	14	21	28	35	42	63	70	105	V
Forward current	I <sub>F</sub>	20								A
Surge peak forward current, 8.3ms single half sine wave superimposed on rated load	I <sub>FSM</sub>	200								A
Junction temperature	T <sub>J</sub>	-55 to +125				-55 to +150				°C
Storage temperature	T <sub>STG</sub>	-55 to +150								°C

**THERMAL PERFORMANCE**

PARAMETER	SYMBOL	TYP	UNIT
Junction-to-case thermal resistance	$R_{\theta JC}$	1.5	°C/W

**ELECTRICAL SPECIFICATIONS** ( $T_A = 25^\circ\text{C}$  unless otherwise noted)

PARAMETER	CONDITIONS	SYMBOL	TYP	MAX	UNIT
Forward voltage per diode <sup>(1)</sup>	SRS2020H SRS2030H SRS2040H	$V_F$	-	0.55	V
	SRS2050H SRS2060H		-	0.70	V
	SRS2090H SRS20100H		-	0.92	V
	SRS20150H		-	1.02	V
Reverse current @ rated $V_R$ per diode <sup>(2)</sup>	SRS2020H SRS2030H SRS2040H SRS2050H SRS2060H	$I_R$	-	500	$\mu\text{A}$
	SRS2090H SRS20100H SRS20150H		-	100	$\mu\text{A}$
	SRS2020H SRS2030H SRS2040H		-	15	mA
	SRS2050H SRS2060H		-	10	mA
	SRS2090H SRS20100H SRS20150H		-	-	mA
	SRS2020H SRS2030H SRS2040H SRS2050H SRS2060H		-	-	mA
	SRS2090H SRS20100H SRS20150H		-	5	mA

**Notes:**

- Pulse test with  $PW = 0.3\text{ms}$
- Pulse test with  $PW = 30\text{ms}$

**ORDERING INFORMATION**

ORDERING CODE <sup>(1)</sup>	PACKAGE	PACKING
SRS20xH	TO-263AB (D <sup>2</sup> PAK)	800 / Tape & Reel

**Notes:**

- "x" defines voltage from 20V(SRS2020H) to 150V(SRS20150H)

## CHARACTERISTICS CURVES

( $T_A = 25^\circ\text{C}$  unless otherwise noted)

**Fig.1 Forward Current Derating Curve**

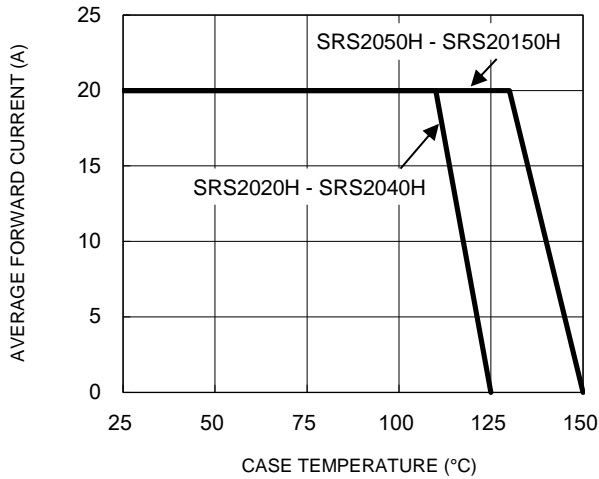

**Fig.2 Typical Junction Capacitance**

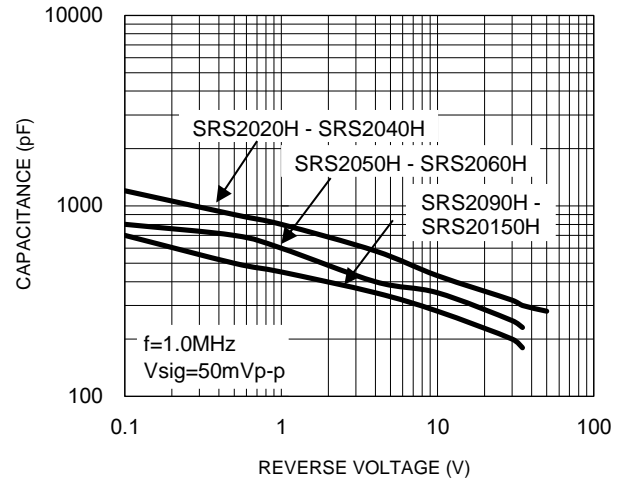

**Fig.3 Typical Reverse Characteristics**

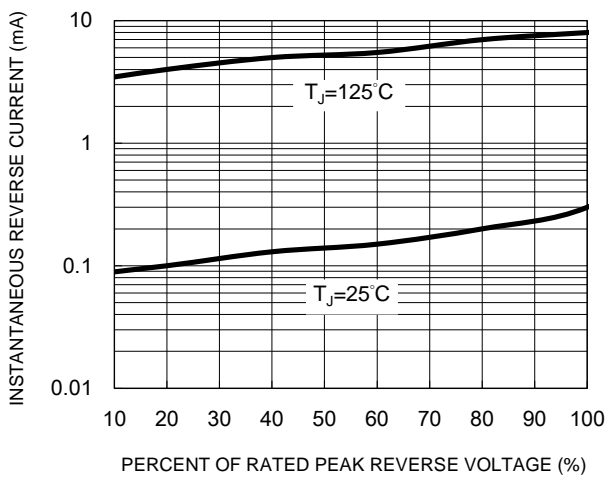

**Fig.4 Typical Forward Characteristics**

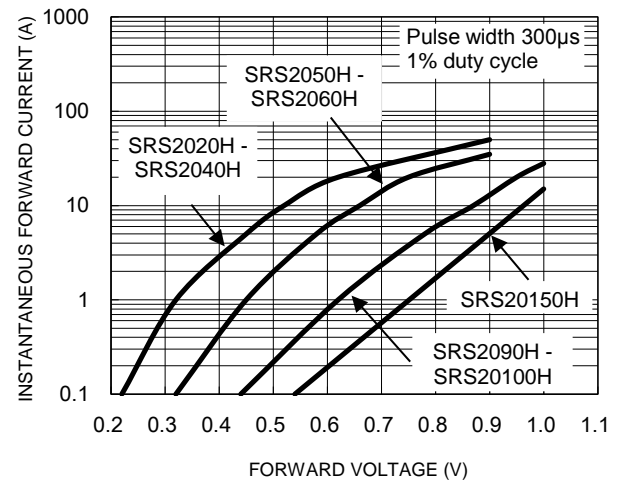

**Fig.5 Maximum Non-Repetitive Forward Surge Current**

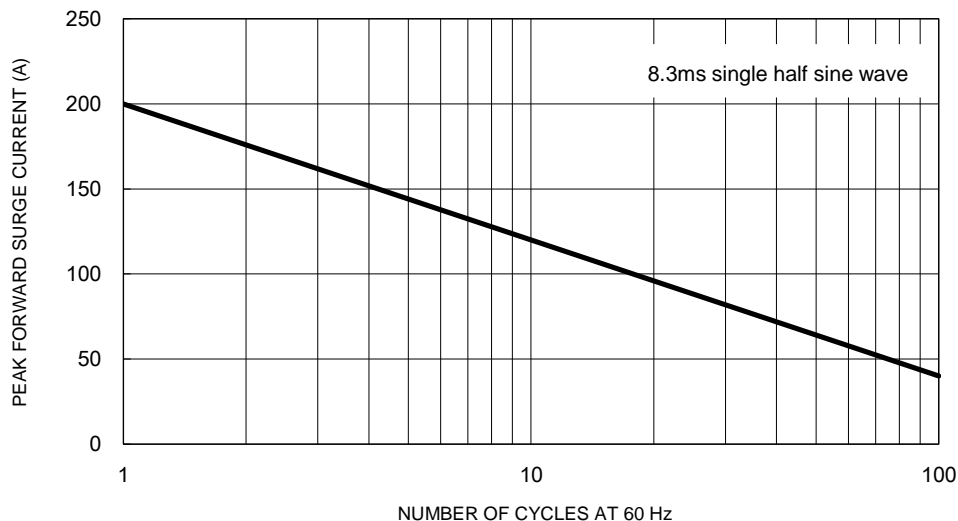

## CHARACTERISTICS CURVES

( $T_A = 25^\circ\text{C}$  unless otherwise noted)

**Fig.6 Typical Transient Thermal Impedance**

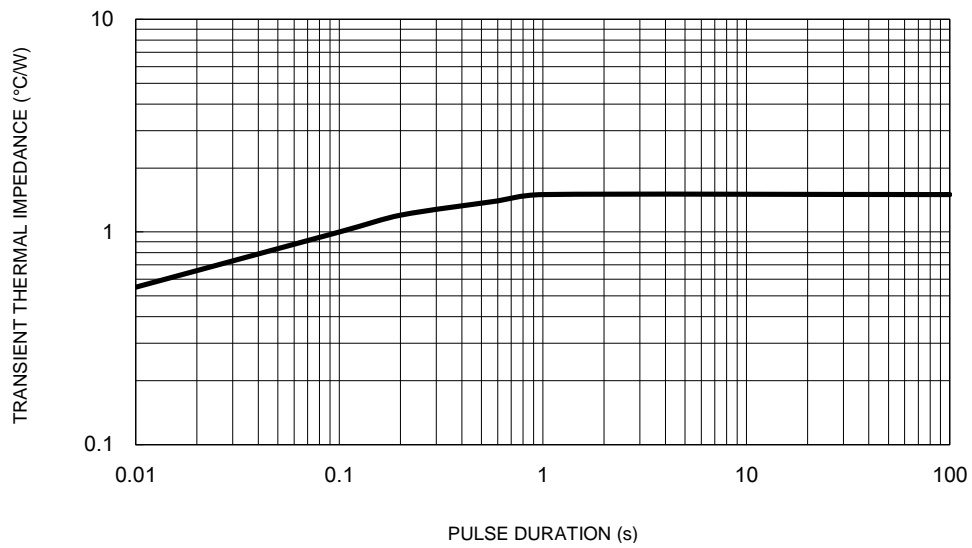

## PACKAGE OUTLINE DIMENSIONS

TO-263AB (D<sup>2</sup>PAK)

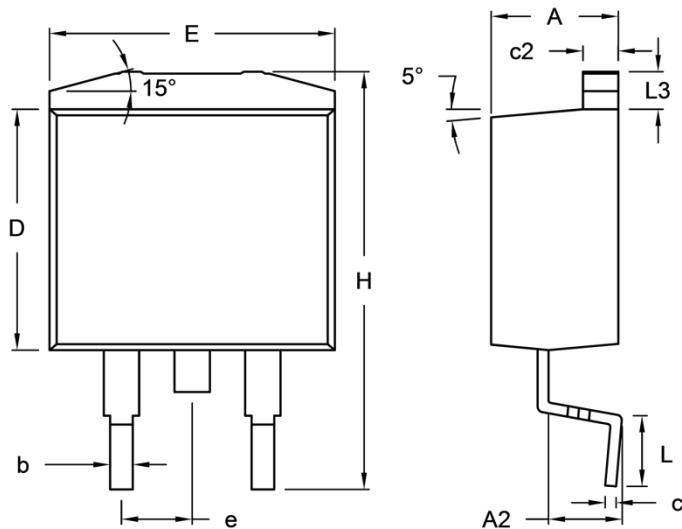

DIM.	Unit (mm)		Unit (inch)	
	Min.	Max.	Min.	Max.
A	4.44	4.70	0.175	0.185
A2	2.03	2.79	0.080	0.110
b	0.68	0.94	0.027	0.037
c	0.36	0.53	0.014	0.021
c2	1.14	1.40	0.045	0.055
D	8.25	9.25	0.325	0.364
E	-	10.50	-	0.413
e	2.41	2.67	0.095	0.105
H	14.60	15.88	0.575	0.625
L	2.29	2.79	0.090	0.110
L3	1.14	1.40	0.045	0.055

## SUGGESTED PAD LAYOUT

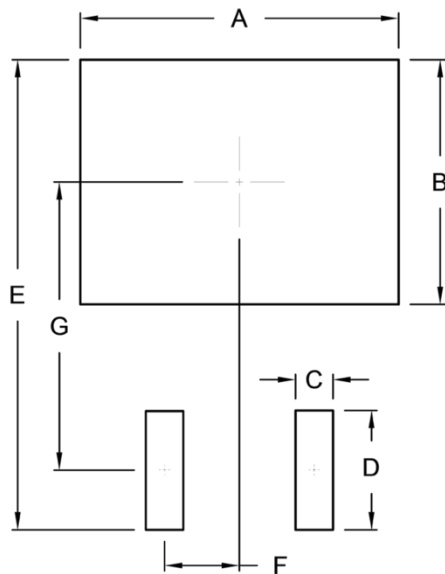

Symbol	Unit (mm)	Unit (inch)
A	10.80	0.425
B	8.30	0.327
C	1.27	0.050
D	4.05	0.159
E	15.95	0.628
F	2.54	0.100
G	9.775	0.385

## MARKING DIAGRAM



P/N = Marking Code  
 G = Green Compound  
 YWW = Date Code  
 F = Factory Code

## **Notice**

Specifications of the products displayed herein are subject to change without notice. TSC or anyone on its behalf assumes no responsibility or liability for any errors or inaccuracies.

Purchasers are solely responsible for the choice, selection, and use of TSC products and TSC assumes no liability for application assistance or the design of Purchasers' products.

Information contained herein is intended to provide a product description only. No license, express or implied, to any intellectual property rights is granted by this document. Except as provided in TSC's terms and conditions of sale for such products, TSC assumes no liability whatsoever, and disclaims any express or implied warranty, relating to sale and/or use of TSC products including liability or warranties relating to fitness for a particular purpose, merchantability, or infringement of any patent, copyright, or other intellectual property right.

The products shown herein are not designed for use in medical, life-saving, or life-sustaining applications. Customers using or selling these products for use in such applications do so at their own risk and agree to fully indemnify TSC for any damages resulting from such improper use or sale.

# Mouser Electronics

Authorized Distributor

Click to View Pricing, Inventory, Delivery & Lifecycle Information:

Taiwan Semiconductor:

[SRS20100H](#) [SRS20150H](#) [SRS2040H](#) [SRS2060H](#)