

## High Efficient Surface Mount Rectifiers

### FEATURES

- Glass passivated junction chip
- Ideal for automated placement
- Low profile package
- Fast switching for high efficiency
- Moisture sensitivity level: level 1, per J-STD-020
- Compliant to RoHS Directive 2011/65/EU and in accordance to WEEE 2002/96/EC
- Halogen-free according to IEC 61249-2-21 definition



### MECHANICAL DATA

**Case:** DO-214AC (SMA)

Molding compound, UL flammability classification rating 94V-0

Base P/N with suffix "G" on packing code - Green compound (halogen-free)

Base P/N with prefix "H" on packing code - AEC-Q101 qualified

**Terminal:** Matte tin plated leads, solderable per JESD22-B102

Meet JESD 201 class 1A whisker test

with prefix "H" on packing code meet JESD 201 class 2 whisker test

**Polarity:** Indicated by cathode band

**Weight:** 0.06 g (approximately)

DO-214AC(SMA)

MAXIMUM RATINGS AND ELECTRICAL CHARACTERISTICS (T <sub>A</sub> =25°C unless otherwise noted)										
PARAMETER	SYMBOL	HS 2AA	HS 2BA	HS 2DA	HS 2FA	HS 2GA	HS 2JA	HS 2KA	HS 2MA	UNIT
Maximum repetitive peak reverse voltage	V <sub>RRM</sub>	50	100	200	300	400	600	800	1000	V
Maximum RMS voltage	V <sub>RMS</sub>	35	70	140	210	280	420	560	700	V
Maximum DC blocking voltage	V <sub>DC</sub>	50	100	200	300	400	600	800	1000	V
Maximum average forward rectified current	I <sub>F(AV)</sub>	1.5								A
Peak forward surge current, 8.3 ms single half sine-wave superimposed on rated load	I <sub>FSM</sub>	50								A
Maximum instantaneous forward voltage (Note 1) @ 1.5 A	V <sub>F</sub>	1.0				1.3	1.7			V
Maximum reverse current @ rated VR    T <sub>J</sub> =25 °C T <sub>J</sub> =125 °C	I <sub>R</sub>	5								μA
		100								
Maximum reverse recovery time (Note 2)	trr	50					75			ns
Typical junction capacitance (Note 3)	C <sub>j</sub>	50					30			pF
Typical thermal resistance	R <sub>θJA</sub>	80								°C/W
Operating junction temperature range	T <sub>J</sub>	- 55 to +150								°C
Storage temperature range	T <sub>STG</sub>	- 55 to +150								°C

Note 1: Pulse test with PW=300μs, 1% duty cycle

Note 2: Reverse Recovery Test Conditions: I<sub>F</sub>=0.5A, I<sub>R</sub>=1.0A, I<sub>RR</sub>=0.25A

Note 3: Measured at 1 MHz and Applied Reverse Voltage of 4.0V D.C.

ORDERING INFORMATION					
PART NO.	AEC-Q101 QUALIFIED	PACKING CODE	GREEN COMPOUND CODE	PACKAGE	PACKING
HS2xA (Note 1)	Prefix "H"	R3	Suffix "G"	SMA	1,800 / 7" Plastic reel
		R2		SMA	7,500 / 13" Paper reel
		M2		SMA	7,500 / 13" Plastic reel
		F3		Folded SMA	1,800 / 7" Plastic reel
		F2		Folded SMA	7,500 / 13" Paper reel
		F4		Folded SMA	7,500 / 13" Plastic reel
	N/A	E3		Clip SMA	1,800 / 7" Plastic reel
		E2		Clip SMA	7,500 / 13" Plastic reel

Note 1: "x" defines voltage from 50V (HS2AA) to 1000V (HS2MA)

EXAMPLE					
PREFERRED P/N	PART NO.	AEC-Q101 QUALIFIED	PACKING CODE	GREEN COMPOUND CODE	DESCRIPTION
HS2MA R3	HS2MA		R3		
HS2MA R3G	HS2MA		R3	G	Green compound
HS2MAHR3	HS2MA	H	R3		AEC-Q101 qualified

## RATINGS AND CHARACTERISTICS CURVES

(TA=25°C unless otherwise noted)

FIG.1 FORWARD CURRENT DERATING CURVE

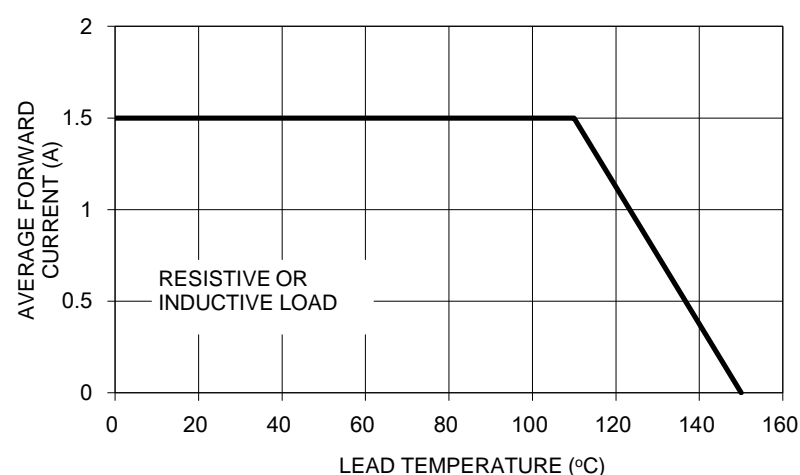

FIG. 2 TYPICAL REVERSE CHARACTERISTICS

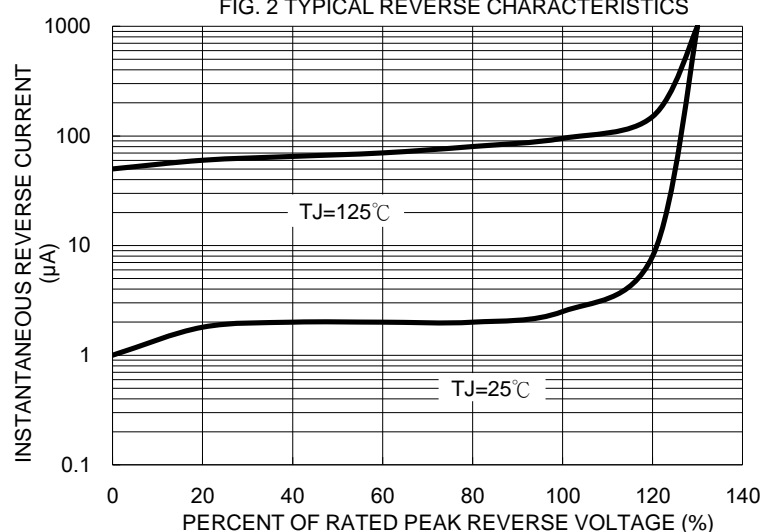

FIG. 3 MAXIMUM NON-REPETITIVE FORWARD SURGE CURRENT

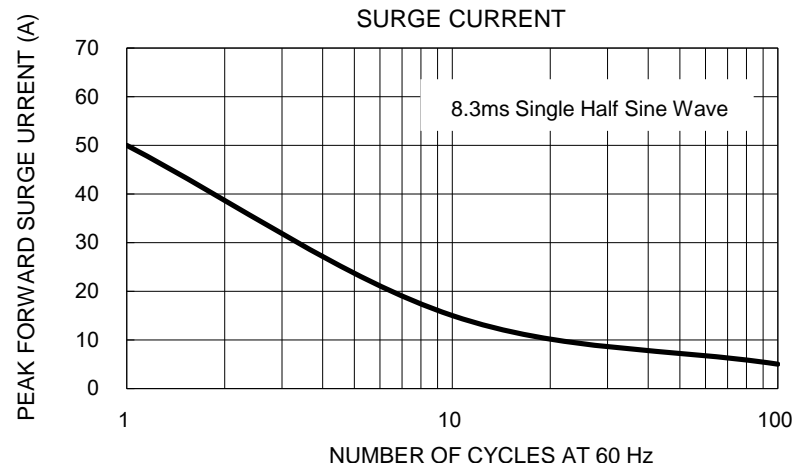

FIG. 4 TYPICAL FORWARD CHARACTERISTICS

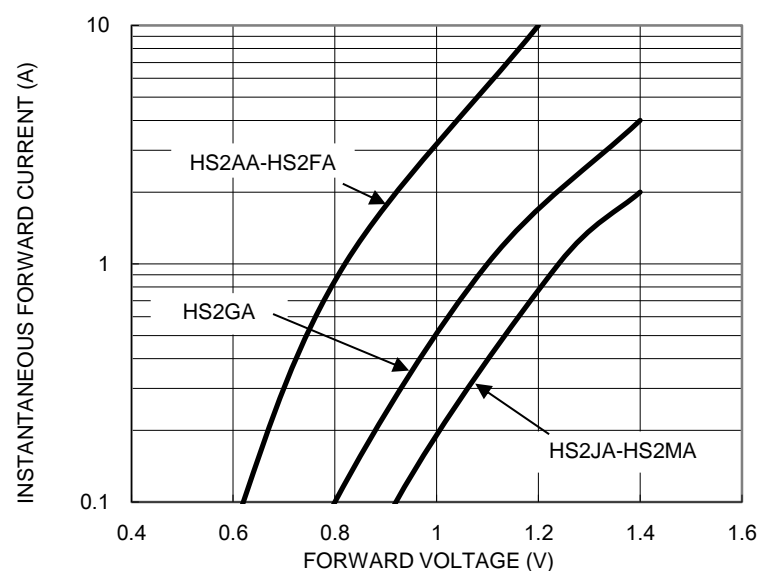

FIG. 5 TYPICAL JUNCTION CAPACITANCE

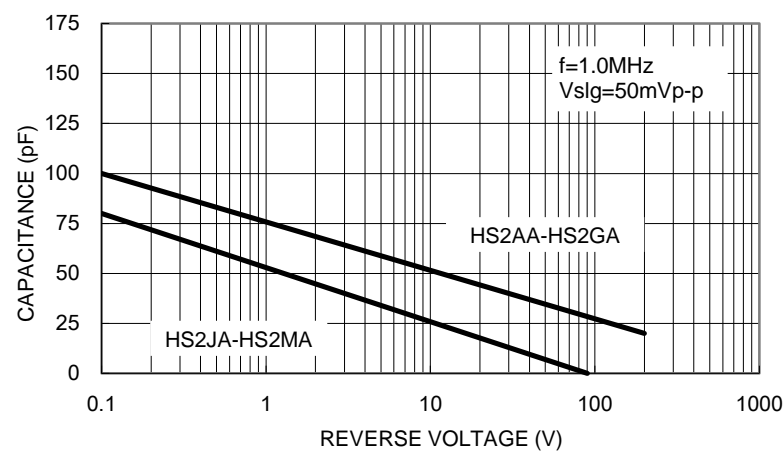
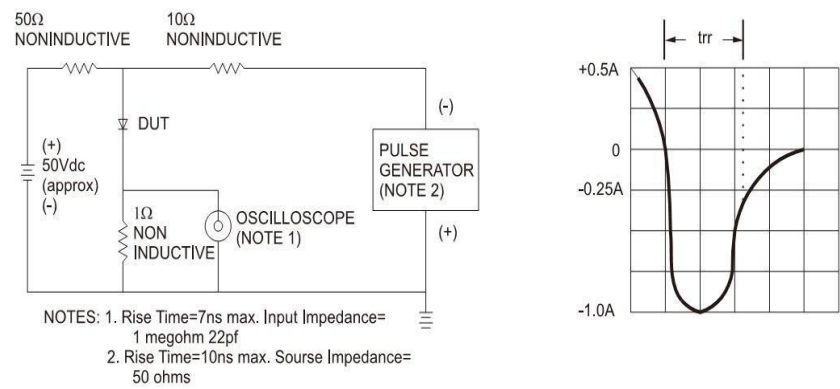
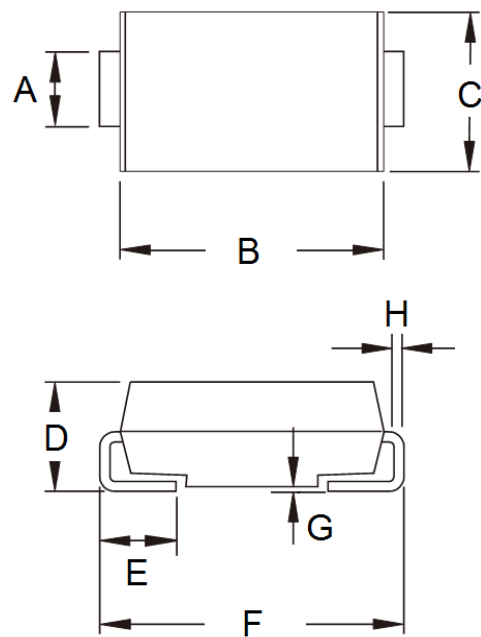

FIG.6- REVERSE RECOVERY TIME CHARACTERISTIC AND TEST CIRCUIT DIAGRAM



PACKAGE OUTLINE DIMENSIONS



DIM.	Unit (mm)		Unit (inch)	
	Min	Max	Min	Max
A	1.27	1.58	0.050	0.062
B	4.06	4.60	0.160	0.181
C	2.29	2.83	0.090	0.111
D	1.99	2.50	0.078	0.098
E	0.90	1.41	0.035	0.056
F	4.95	5.33	0.195	0.210
G	0.10	0.20	0.004	0.008
H	0.15	0.31	0.006	0.012

SUGGESTED PAD LAYOUT

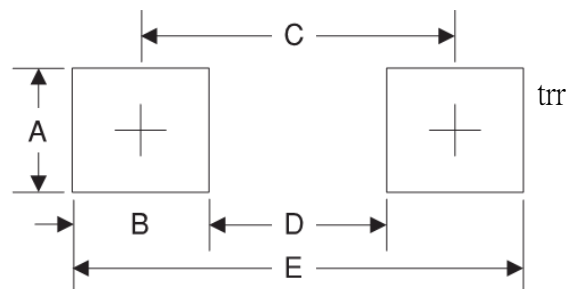

Symbol	Unit (mm)	Unit (inch)
A	1.68	0.066
B	1.52	0.060
C	3.93	0.155
D	2.41	0.095
E	5.45	0.215

MARKING DIAGRAM



P/N = Specific Device Code  
G = Green Compound  
YW = Date Code  
F = Factory Code

### **Notice**

Specifications of the products displayed herein are subject to change without notice. TSC or anyone on its behalf, assumes no responsibility or liability for any errors in accuracies.

Information contained herein is intended to provide a product description only. No license, express or implied, to any intellectual property rights is granted by this document. Except as provided in TSC's terms and conditions of sale for such products, TSC assumes no liability whatsoever, and disclaims any express or implied warranty, relating to sale and/or use of TSC products including liability or warranties relating to fitness for a particular purpose, merchantability, or infringement of any patent, copyright, or other intellectual property right.

The products shown herein are not designed for use in medical, life-saving, or life-sustaining applications. Customers using or selling these products for use in such applications do so at their own risk and agree to fully indemnify TSC for any damages resulting from such improper use or sale.

# Mouser Electronics

Authorized Distributor

Click to View Pricing, Inventory, Delivery & Lifecycle Information:

## Taiwan Semiconductor:

[HS2AA](#) [HS2DA](#) [HS2FA](#) [HS2GA](#) [HS2KA](#) [HS2GAHF3G](#) [HS2MA F2](#) [HS2MA R2G](#) [HS2GA R2G](#) [HS2MAHR2G](#)  
[HS2KAHF2G](#) [HS2MA R2](#) [HS2BA R3](#) [HS2MAHF3G](#) [HS2JA R2G](#) [HS2KA F2G](#) [HS2BAHF3G](#) [HS2FA F2G](#)  
[HS2FAHR3G](#) [HS2KAHF3G](#) [HS2GA F2G](#) [HS2KAHR3G](#) [HS2BAHF2G](#) [HS2FA R2](#) [HS2MAHR3G](#) [HS2JAHR3G](#)  
[HS2JA F2](#) [HS2DA R3](#) [HS2DA R2G](#) [HS2KA R2G](#) [HS2JA F2G](#) [HS2FAHR2G](#) [HS2GAHR2G](#) [HS2GA R2](#)  
[HS2JAHR2G](#) [HS2FAHF2G](#) [HS2MA F2G](#) [HS2DA R2](#) [HS2GAHR3G](#) [HS2BA R2](#) [HS2BAHR2G](#) [HS2BAHR3G](#)  
[HS2FA R2G](#) [HS2BA F2G](#) [HS2JAHF2G](#) [HS2DAHF2G](#) [HS2JA R3](#) [HS2KA R3](#) [HS2FA R3](#) [HS2FAHF3G](#) [HS2JA R2](#)  
[HS2MAHF2G](#) [HS2GA R3](#) [HS2KA R2](#) [HS2MA R3](#) [HS2GAHF2G](#) [HS2KAHR2G](#) [HS2DAHF3G](#) [HS2DAHR2G](#)  
[HS2JAHF3G](#) [HS2DA F2G](#) [HS2DAHR3G](#) [HS2BA R2G](#) [HS2AA R2G](#) [HS2AAHR2G](#) [HS2AAHF3G](#) [HS2AAHR3G](#)  
[HS2AA R3](#) [HS2AAHF2G](#) [HS2AA F2G](#) [HS2JAHM2G](#) [HS2BA M2G](#) [HS2BAHM2G](#) [HS2DA M2G](#) [HS2DAHM2G](#)  
[HS2FA M2G](#) [HS2FAHM2G](#) [HS2AA M2G](#) [HS2AAHM2G](#) [HS2KA M2G](#) [HS2KAHM2G](#) [HS2MAHM2G](#) [HS2GA M2G](#)  
[HS2GAHM2G](#) [HS2JA M2G](#) [HS2BA](#) [HS2DAH](#) [HS2FAH](#) [HS2GAH](#) [HS2JAH](#) [HS2KAH](#) [HS2MAH](#)