

## 2A, 100V-600V Super Fast Surface Mount Rectifier

### FEATURES

- Glass passivated junction chip
- Ideal for automated placement
- Low power loss, high efficiency
- Low profile package
- Moisture sensitivity level: level 1, per J-STD-020
- RoHS Compliant
- Halogen-free according to IEC 61249-2-21

### APPLICATIONS

- Freewheeling application
- Switching mode converters and inverters, computer and telecommunication.

### MECHANICAL DATA

- Case: SOD-128
- Molding compound meets UL 94V-0 flammability rating
- Terminal: Matte tin plated leads, solderable per J-STD-002
- Meet JESD 201 class 2 whisker test
- Polarity: Indicated by cathode band
- Weight: 0.028g (approximately)

KEY PARAMETERS		
PARAMETER	VALUE	UNIT
$I_F$	2	A
$V_{RRM}$	100 - 600	V
$I_{FSM}$	50	A
$T_{JMAX}$	150	°C
Package	SOD-128	
Configuration	Single die	


**HALOGEN FREE**

**SOD-128**


ABSOLUTE MAXIMUM RATINGS ( $T_A = 25^\circ\text{C}$ unless otherwise noted)						
PARAMETER	SYMBOL	ES2BFS	ES2DFS	ES2GFS	ES2JFS	UNIT
Marking code on the device		ES2BFS	ES2DFS	ES2GFS	ES2JFS	
Repetitive peak reverse voltage	$V_{RRM}$	100	200	400	600	V
Reverse voltage, total rms value	$V_{R(RMS)}$	70	140	280	420	V
Forward current	$I_F$	2				A
Surge peak forward current single half sine-wave superimposed on rated load	t = 8.3ms	50				A
	t = 1.0ms	120				A
Junction temperature	$T_J$	-55 to +150				°C
Storage temperature	$T_{STG}$	-55 to +150				°C

<b>THERMAL PERFORMANCE</b>			
<b>PARAMETER</b>	<b>SYMBOL</b>	<b>TYP</b>	<b>UNIT</b>
Junction-to-lead thermal resistance	$R_{\theta JL}$	24	°C/W
Junction-to-ambient thermal resistance	$R_{\theta JA}$	72	°C/W
Junction-to-case thermal resistance	$R_{\theta JC}$	14	°C/W

**Thermal Performance Note:** Units mounted on PCB (5mm x 5mm Cu pad test board)

<b>ELECTRICAL SPECIFICATIONS</b> ( $T_A = 25^\circ\text{C}$ unless otherwise noted)						
<b>PARAMETER</b>		<b>CONDITIONS</b>	<b>SYMBOL</b>	<b>TYP</b>	<b>MAX</b>	<b>UNIT</b>
Forward voltage <sup>(1)</sup>	ES2BFS ES2DFS	$I_F = 1.0\text{A}, T_J = 25^\circ\text{C}$	$V_F$	0.82	-	V
		$I_F = 2.0\text{A}, T_J = 25^\circ\text{C}$		0.88	0.95	V
		$I_F = 1.0\text{A}, T_J = 125^\circ\text{C}$		0.66	-	V
		$I_F = 2.0\text{A}, T_J = 125^\circ\text{C}$		0.74	0.84	V
	ES2GFS	$I_F = 1.0\text{A}, T_J = 25^\circ\text{C}$		0.89	-	V
		$I_F = 2.0\text{A}, T_J = 25^\circ\text{C}$		0.97	1.30	V
		$I_F = 1.0\text{A}, T_J = 125^\circ\text{C}$		0.72	-	V
		$I_F = 2.0\text{A}, T_J = 125^\circ\text{C}$		0.81	0.91	V
	ES2JFS	$I_F = 1.0\text{A}, T_J = 25^\circ\text{C}$		1.11	-	V
		$I_F = 2.0\text{A}, T_J = 25^\circ\text{C}$		1.24	1.70	V
		$I_F = 1.0\text{A}, T_J = 125^\circ\text{C}$		0.86	-	V
		$I_F = 2.0\text{A}, T_J = 125^\circ\text{C}$		1.01	1.14	V
Reverse current @ rated $V_R$ <sup>(2)</sup>		$T_J = 25^\circ\text{C}$	$I_R$	-	1	$\mu\text{A}$
		$T_J = 125^\circ\text{C}$		-	25	$\mu\text{A}$
Reverse recovery time		$I_F = 0.5\text{A}, I_R = 1.0\text{A}, I_{rr} = 0.25\text{A}$	$t_{rr}$	-	35	ns
Junction capacitance	ES2BFS ES2DFS	1MHz, $V_R = 4.0\text{V}$	$C_J$	28	-	pF
	ES2GFS			27	-	pF
	ES2JFS			21	-	pF

**Notes:**

- (1) Pulse test with PW = 0.3ms
- (2) Pulse test with PW = 30ms

<b>ORDERING INFORMATION</b>		
<b>ORDERING CODE</b> <sup>(1)</sup>	<b>PACKAGE</b>	<b>PACKING</b>
ES2xFS M3G	SOD-128	3,500 / 7" reel
ES2xFS M2G	SOD-128	14,000 / 13" reel

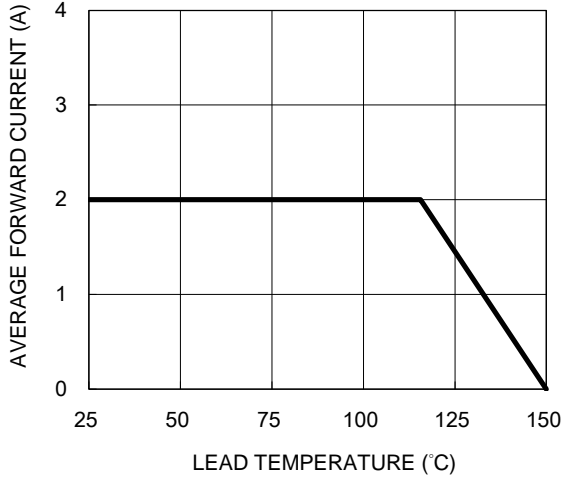
**Notes:**

- (1) "x" defines voltage from 100V(ES2BFS) to 600V(ES2JFS)

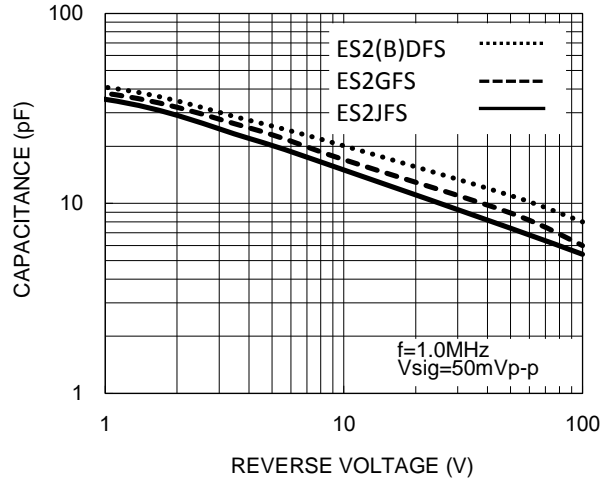
**CHARACTERISTICS CURVES**

( $T_A = 25^\circ\text{C}$  unless otherwise noted)

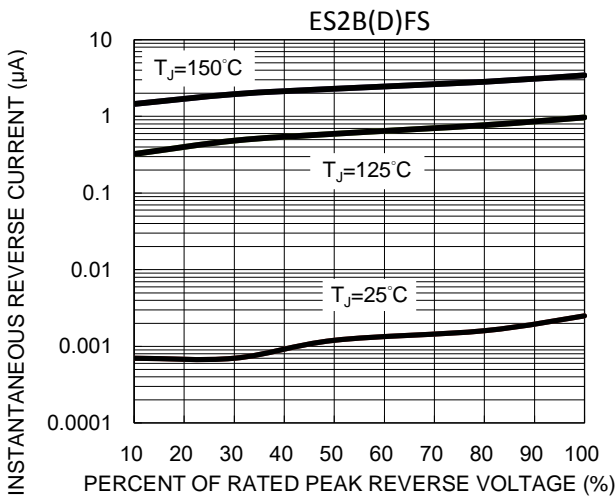
**Fig.1 Forward Current Derating Curve**



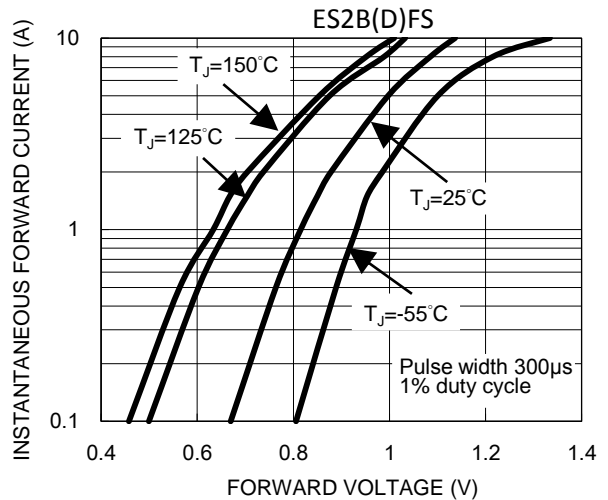
**Fig.2 Typical Junction Capacitance**



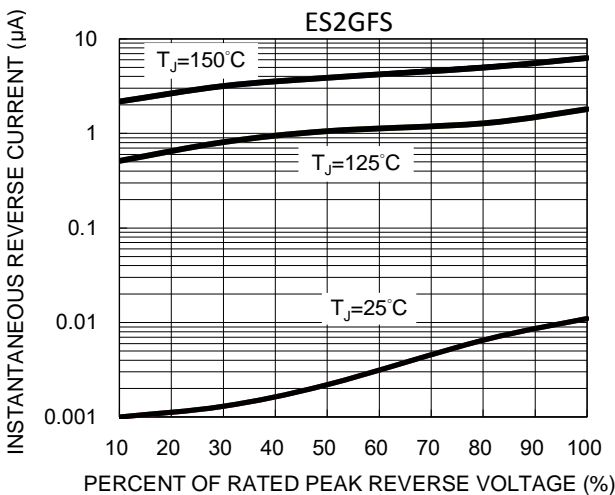
**Fig.3 Typical Reverse Characteristics**



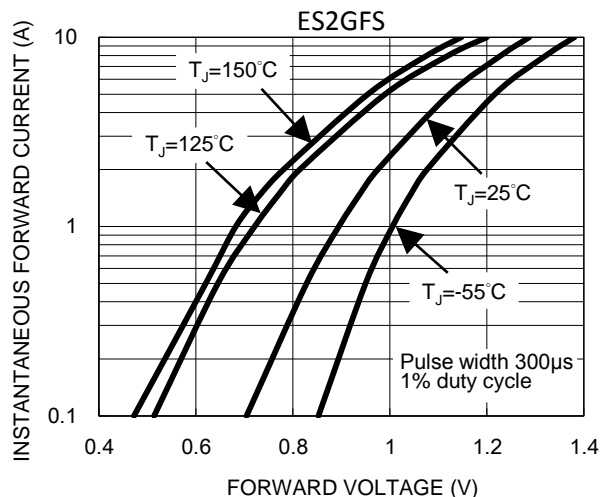
**Fig.4 Typical Forward Characteristics**



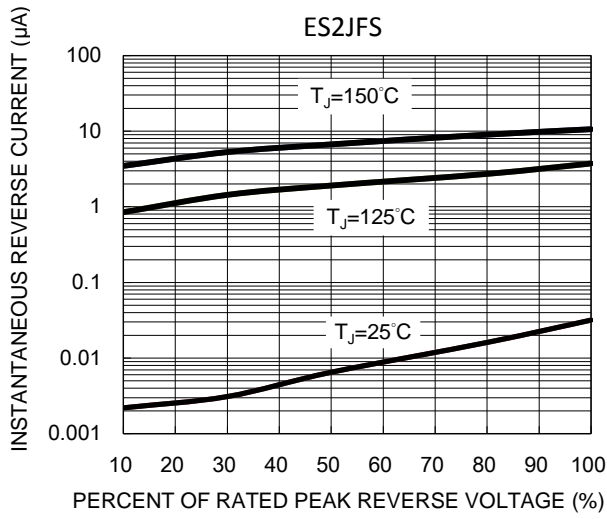
**Fig.5 Typical Reverse Characteristics**



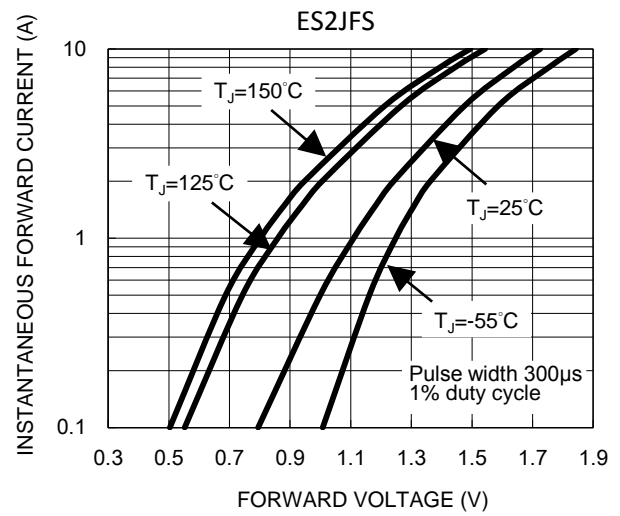
**Fig.6 Typical Forward Characteristics**



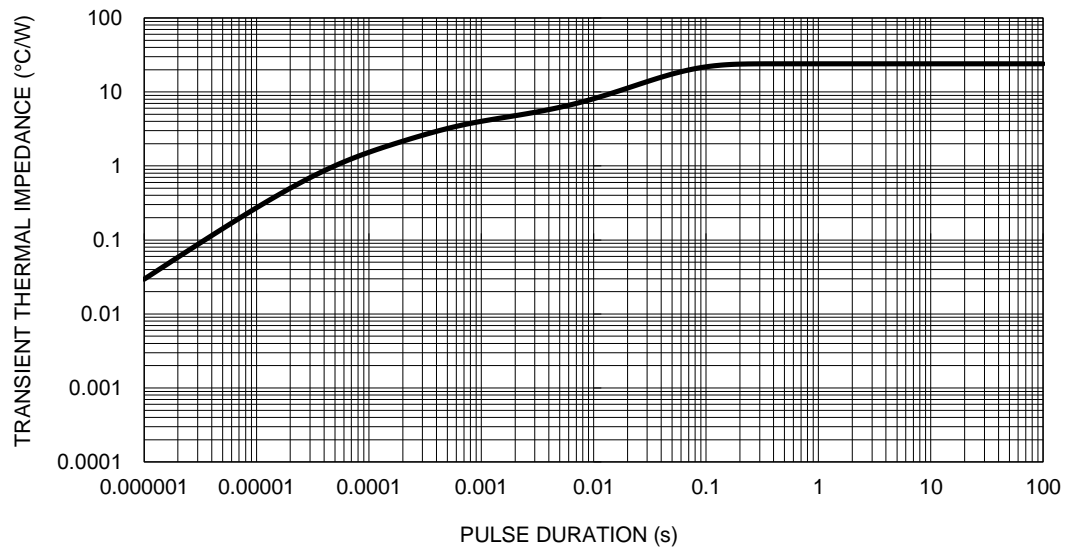
**Fig.7 Typical Reverse Characteristics**



**Fig.8 Typical Forward Characteristics**

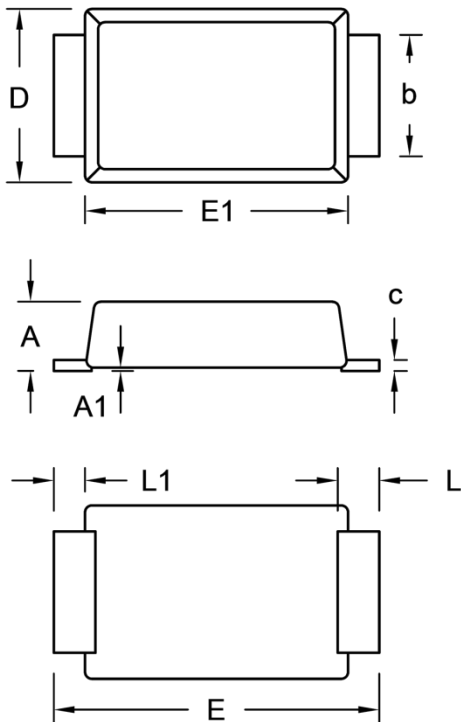


**Fig.9 Typical Transient Thermal Impedance**



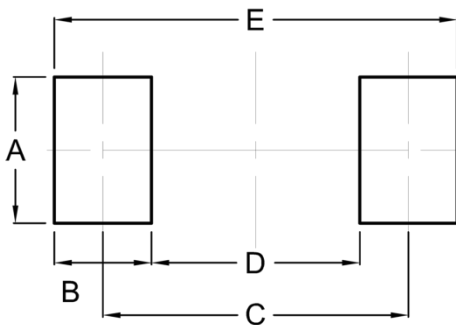
**PACKAGE OUTLINE DIMENSIONS**

SOD-128



DIM.	Unit (mm)		Unit (inch)	
	Min.	Max.	Min.	Max.
A	0.90	1.10	0.035	0.043
A1	0.00	0.10	0.000	0.004
b	1.60	1.90	0.063	0.075
c	0.10	0.22	0.004	0.009
D	2.30	2.70	0.091	0.106
E	4.40	5.00	0.173	0.197
E1	3.60	4.00	0.142	0.157
L	0.40	0.80	0.016	0.031
L1	0.30	0.60	0.012	0.024

**SUGGESTED PAD LAYOUT**



Symbol	Unit (mm)	Unit (inch)
A	2.10	0.083
B	1.40	0.055
C	4.40	0.173
D	3.00	0.118
E	5.80	0.228

**MARKING DIAGRAM**



P/N = Marking Code  
 YW = Date Code  
 F = Factory Code

## Notice

Specifications of the products displayed herein are subject to change without notice. TSC or anyone on its behalf, assumes no responsibility or liability for any errors or inaccuracies.

Purchasers are solely responsible for the choice, selection, and use of TSC products and TSC assumes no liability for application assistance or the design of Purchasers' products.

Information contained herein is intended to provide a product description only. No license, express or implied, to any intellectual property rights is granted by this document. Except as provided in TSC's terms and conditions of sale for such products, TSC assumes no liability whatsoever, and disclaims any express or implied warranty, relating to sale and/or use of TSC products including liability or warranties relating to fitness for a particular purpose, merchantability, or infringement of any patent, copyright, or other intellectual property right.

The products shown herein are not designed for use in medical, life-saving, or life-sustaining applications. Customers using or selling these products for use in such applications do so at their own risk and agree to fully indemnify TSC for any damages resulting from such improper use or sale.

# Mouser Electronics

Authorized Distributor

Click to View Pricing, Inventory, Delivery & Lifecycle Information:

[Taiwan Semiconductor:](#)

[ES2DFS M3G](#) [ES2GFS M3G](#) [ES2JFS M3G](#) [ES2BFS M3G](#) [ES2BFS](#) [ES2DFS](#) [ES2GFS](#) [ES2JFS](#)